

To: All Plan Holders of Record

From: CT Consultants, Inc.
For the Owner

Re: *Addendum No. 2*
Rock Swale Sewer Improvements Phase 1
City of Marion

Date: November 14, 2024

This Addendum forms a part of the contract documents and modifies the original bidding documents dated October 2024 and all previous addenda, if any. Acknowledge receipt of this addendum in the space provided in the bid forms. Failure to do so may subject the bidder to disqualification.

QUESTIONS & ANSWERS (INCLUDES PRE-BID MEETING SUMMARY & SIGN IN)

- Q1. Are Build American Buy American (BABA) guidelines required for material procurement?
A1. No. Project is federally funded but does NOT require materials to meet the specific guidelines in the BABA Act.
- Q2. Is access to hydrants permitted and who is responsible to pay for the water used?
A2. All Contractor's may contact the local Aqua Ohio contact Don Scott who will be able to provide provisions, protocols, and cost associated with hydrants and the subsequent water use. The Contractor is solely responsible to determine and coordinate their source for water necessary to complete their work and no additional payment will be made for the any time or costs associated with this work.
- Q3. Will Contractor's have access to GIS or any sewer mapping?
A3. Atlas maps are included as a part of this addendum and are to be used for reference only. The sewer alignments on the drawings were surveyed and in general reflect the location of manholes and the alignment of the sewer.
- Q4. Was any flow monitoring performed and how were the flows determined in the 330130.03 Sewer Flow Control?
A4. The flows were obtained from a calibrated hydraulic and hydrologic (H&H) model that was completed by a separate consultant under a different project. This data utilized flow monitoring at the upstream and downstream end of this sewer. Flows are based on the average dry-weather flow in the sewer and the project peak flow observed in the model between MH1 and MH12A.

Q5. Is it anticipated that bypass pumping is necessary for dry weather and more notably will be necessary for wet-weather flows?

A5. The Contractor is responsible to determine the ultimate means and methods they are able to safely and effectively install the specified improvements within put causing additional damage within the sewer they are working in or causing disturbances to the flow or sewer directly up or downstream of the proposed work that of which may cause basement backups, flooding out of manholes, or buildup of debris that restricts flow within the sewer.

If the Contractor does not believe bypass pumping is necessary, they may elect to temporarily plug or dam flow upstream of the work while doing improvements. Similar to bypass pumping, temporary plugs or damming shall not cause any disturbances to the flow or sewer directly up or downstream of the proposed work that of which may cause basement backups, flooding out of manholes, or buildup of debris that restricts flow within the sewer. Any buildup or damage that may occur due to this will be the responsibility of the Contractor to clean and remove and/or remediate at their cost.

Q6. Is there consideration to altering the method of payment for bypass pumping?

A6. Bypass pumping pay items have been removed and added under Part 1 General Items in the Prices to Include. The Contractor is responsible to determine their means and methods for maintaining or bypassing flow for during the course of all work and costs associated with the noted flow management or bypass shall be incorporated into all pay items.

Q7. Will alternative manhole types and methods of installation be allowed in lieu of the specified manholes?

A7. Any modification that differs from the specified manhole improvements or manhole replacement types shall require approval by the Engineer. Any modification to manhole improvements or other sewer improvements must meet at minimum the equivalent specified design criteria, match the general intent of the noted improvement, and not require any additional work not currently specified in order to install such alternative. If additional work is required that is not currently specified or noted, then the Contractor shall include that in the cost of their alternative method (pending approval by the Engineer).

It is generally recommended to send any alternative means or methods prior to the opening of bids for approval for there is not implied or actual guarantee that alternative methods will be approved after the awarding for bid.

Q8. Will detours be allowed and who is responsible for implementing and maintaining?

A8. Yes, detours are permitted, but will still need to be approved by the Engineer prior to implementing. The Contractor is responsible for implementing and maintaining detours and any other traffic control devices or methods necessary to complete their work.

Addendum No. 2

Date: November 14, 2024

Page 3

Q9. Is Channeline GRP panels an accepted manufacturer for the slip lining?

A9. Yes.

Q10. Is there access to CCTV videos, PACP and MACP Logs, and Laser Profiling?

A10. Yes. See links:

CCTV

https://www.ctconsultants.com/bid_documents/242139/CCTV%20and%20Manhole%20Inspections/Manhole%20Inspections/

Laser Profiling – Summary of Work Item 1.4 A. 2

https://www.ctconsultants.com/bid_documents/242139/Reference%20Documents%20-%20Summary%20of%20Work%20-%20Item%201.4%20A.%202/

PACP – Summary of Work Item 1.4 A. 2

https://www.ctconsultants.com/bid_documents/242139/CCTV%20and%20Manhole%20Inspections/CCTV/

MACP -- Summary of Work Item 1.4 A. 3

https://www.ctconsultants.com/bid_documents/242139/CCTV%20and%20Manhole%20Inspections/Manhole%20Inspections/

Soil Borings – Summary of Work Item 1.4 A. 1 - Forthcoming

Q11. Will the Contractor be permitted to work continuously beyond normal work hours (7AM-7PM)?

A11. Yes, but the Contractor will still be required to formally submit a schedule for work with start and stop times and dates for such work. All work outside of the normal work hours will require approval by the Owner

Q12. Will road closures and detours be permitted?

A12. Yes. All detour plans will need to be designed in accordance with the bid documents and ODOT regulations. The Contractor will need to submit their plan to the Owner for approval prior to implementation. The Contractor is also responsible for all costs necessary to implement road closures and detour routes. An road closure shall allow for local traffic to be able to access any homes or businesses within the road closure limits.

Q13. What is the maintenance bond length for the project?

A13. Two (2) years. See Specific Project Requirements, Item 4.

Q14. Do the pumps for bypassing have to be noise attenuating?

A14. No, unless they are located within 500' of a residential property.

Addendum No. 2

Date: November 14, 2024

Page 4

Q15 Would you consider Quadex Quad-Plug as an approved equal per Section 330130.81 Part 2.9-B?

A15. No.

Q16. Would you consider Quadex Hyperform an approved equal per Section 330130.81 Part 2.9-C?

A16. Yes.

Q17. Would you consider the Quadex I&I Guard Family as approved grouts per Section 330130.63 Part 2.1?

A17. Yes.

Q18. Would you consider United Felts an approved CIPP Liner manufacturer per section 330130.72?

A18. Yes.

BID DOCUMENTS

Replace Prices to Include, Pages BD.9A to BD.16A, with the enclosed Prices to Include, Pages BD.9B to BD.15B.

BID FORMS

Replace Bid Form, Pages BF.9 to BF.11, with the enclosed Bid Form, Pages BF.9A to BF.11A. A pay item “Void Fill and Seal, As Per Plan” has been added to Alternates A, B, and C.

PREVAILING WAGES

Section 8, Prevailing Wage Rates - **Replace** the Wage Rate Schedule with the following:

Heavy and Highway – Decision No. OH20240001, Modification No. 9, dated 11/08/2024

Bidders shall utilize this revised decision when compiling their Bid.

MD/TM:mep

Enclosures

H:\2024\242139\SPEC\Addenda\Addendum 02\Addendum 02.Doc

Pre-Bid Meeting Summary

CT JOB#: 242019

PROJECT: Roch Swale Sewer Improvements Phase I

OWNER: City of Marion

LOCATION: City of Marion, Marion County, Ohio

OPINION OF PROBABLE CONSTRUCTION COST: Base - \$400,000 Alternates - \$2,500,000

BID OPENING DATE: Thursday, December 5, 2024 at 12:00 PM in Council Chambers

COMPLETION DATE: December 19, 2025

MEETING INFORMATION: November 7, 2024 @ 10:30 AM Location: Marion City Hall

CONTRACT HIGHLIGHTS:

All questions during bidding should be addressed to Mr. Tim McLaughlin P.E. Questions during meeting (to be answered formally through addendum). Request that all questions asked today be submitted via email to ensure they are answered properly.

AGENDA:

1. Introductions – CT team/Marion Staff; introductions around the room
2. Description of Project:
 - a. The project is for improvements of the 72” double-wall brick combined sewer and corresponding brick wall manholes along Holland Road. The project includes a Base Bid with three (3) Alternates:
 - i. Base Bid: Manhole Rehabilitation Improvements
 1. Manhole Improvement Schedule
 2. Special Deduct
 - ii. Alternate A: Slip-lining and Manhole Improvements
 1. GRP Slip Lining
 - iii. Alternate B: Cured-in-Place-Pipe (CIPP) Lining and Manhole Improvements
 1. CIPP in accordance with ASCE MOP 145
 - iv. Alternate C: Miscellaneous Sewer Improvement
 1. PWP requirements
 - b. Alternates A, B, and C have a fixed budget (\$2,500,000) that the Contractor shall submit a Quantity and Unit Prices (Labor, Material, Total Unit Price and Item Total) for the pay items identified within each Alternate bid. Unit prices provided for the specified pay items (Alternates A and B) or proposed pay items (Alternate C) in each Alternate will be reviewed by the Owner to assess the length of improvements that will be able to be completed within the allotted budget for those Alternates

- c. The Contractor may bid on any and all Alternates and is only required to bid on the Base Bid and at least one (1) of the Alternates. Only one (1) Alternate will be awarded if acceptable bids are received.
- d. The Contractor will be required after the contract is awarded and executed to develop and submit a Project Work Plan (PWP) that includes the following elements:

3. General Items

- a. Working Hours (730-730)
- b. Funding (WWIG)
 - i. Prevailing Wage Requirements
 - ii. BABA Requirements
- c. Subcontractors
 - i. BF.3 Subcontractors
- d. Alternative materials
- e. Change Orders
 - i. Must be approved by OWNER
- f. Addendums
- g. Project Requirements
 - i. Must be registered contractor with City of Marion
 - ii. Shop Drawings shall be submitted to ENGINEER for review and approval
 - iii. Submittals (Summary of Work)
 - iv. Inspection must be scheduled 48 hours in advance
 - v. Maintenance Bond

4. Reference Documents

- a. MACP Logs
- b. PACP Logs
- c. Laser Profiling Cross Sections
- d. Geotech Soil Borings (forthcoming)
- e. Original As Builts

QUESTIONS FROM BIDDERS

- Q1. Are Build American Buy American (BABA) guidelines required for material procurement?
- A1. No. Project is federally funded but does NOT require materials to meet the specific guidelines in the BABA Act.
- Q2. Is access to hydrants permitted and who is responsible to pay for the water used?
- A2. All Contractor's may contact the local Aqua Ohio contact Don Scott who will be able to provide provisions, protocols, and cost associated with hydrants and the subsequent water use. The Contractor is solely responsible to determine and coordinate their source for water necessary to complete their work and no additional payment will be made for the any time or costs associated with this work.
- Q3. Will Contractor's have access to GIS or any sewer mapping?
- A3. Atlas maps are included as a part of this addendum and are to be used for reference only. The sewer alignments on the drawings were surveyed and in general reflect the location of manholes and the alignment of the sewer.
- Q4. Was any flow monitoring performed and how were the flows determined in the 330130.03 Sewer Flow Control?
- A4. The flows were obtained from a calibrated hydraulic and hydrologic (H&H) model that was completed by separate consultant under a different project. This data utilized flow monitoring at the upstream and downstream end of this sewer. Flows are based on the average dry-weather flow in the sewer and the project peak flow observed in the model between MH1 and MH12A.
- Q5. Is it anticipated that bypass pumping is necessary for dry weather and more notably will be necessary for wet-weather flows?
- A5. The Contractor is responsible to determine the ultimate means and methods they are able to safely and effectively install the specified improvements within put causing additional damage within the sewer they are working in or causing disturbances to the flow or sewer directly up or downstream of the proposed work that of which may cause basement backups, flooding out of manholes, or buildup of debris that restricts flow within the sewer.

If the Contractor does not believe bypass pumping is necessary, they may elect to temporarily plug or dam flow upstream of the work while doing improvements. Similar to bypass pumping, temporary plugs or damming shall not cause any disturbances to the flow or sewer directly up or downstream of the proposed work that of which may cause basement backups, flooding out of manholes, or buildup of debris that restricts flow within the sewer. Any buildup or

damage that may occur due to this will be the responsibility of the Contractor to clean and remove and/or remediate at their cost.

- Q6. Is there consideration to altering the method of payment for bypass pumping?
- A6. Bypass pumping pay items have been removed and added under Part 1 General Items in the Prices to Include. The Contractor is responsible to determine their means and methods for maintaining or bypassing flow for during the course of all work and costs associated with the noted flow management or bypass shall be incorporated into all pay items.
- Q7. Will alternative manhole types and methods of installation be allowed in lieu of the specified manholes?
- A7. Any modification that differs from the specified manhole improvements or manhole replacement types shall require approval by the Engineer. Any modification to manhole improvements or other sewer improvements must meet at minimum the equivalent specified design criteria, match the general intent of the noted improvement, and not require any additional work not currently specified in order to install such alternative. If additional work is required that is not currently specified or noted, then the Contractor shall include that in the cost of their alternative method (pending approval by the Engineer.

It is generally recommended to send any alternative means or methods prior to the opening of bids for approval for there is not implied or actual guarantee that alternative methods will be approved after the awarding for bid.

- Q8. Will detours be allowed and who is responsible for implementing and maintaining?
- A8. Yes, detours are permitted, but will still need to be approved by the Engineer prior to implementing. The Contractor is responsible for implementing and maintaining detours and any other traffic control devices or methods necessary to complete their work.
- Q9. Is Channeline GRP panels an accepted manufacturer for the slip lining?
- A9. Yes.
- Q10. Is their access to CCTV videos, PACP and MACP Logs, and Laser Profiling?
- A10. Yes. See links:

PACP:

https://www.ctconsultants.com/bid_documents/242139/CCTV%20and%20Manhole%20Inspections/CCTV/

MACP

https://www.ctconsultants.com/bid_documents/242139/CCTV%20and%20Manhole%20Inspections/Manhole%20Inspections/

CCTV:

NEED TO ADD

Laser Profiling

https://www.ctconsultants.com/bid_documents/242139/Reference%20Documents%20-%20Summary%20of%20Work%20-%20Item%201.4%20A.%20/

SIGN IN:

Name	Company	Email	Phone
Tim McLaughlin	CT Consultants	tmclaughlin@ctconsultants.com	440-530-2352
Tony Mancari	CT Consultants	tmancari@ctconsultants.com	440-867-8200
Scott Bishop	City of Marion	sbishop@marionohio.org	740-387-2240
Jeff Shetler	City of Marion	jshetler@marionohio.org	740-387-2240
Phil Wright	Marion County Sanitary	pwright@co.marion.oh.us	740-223-4131
William Long	Inliner	William.long@pariscorp.com	614-653-2432
Ted Lindsley	Rain for Rent	tlindsley@rainforrent.com	419-277-9618
Garth Stevens	Marra Services	garth@marrainc.com	216-361-9977
Brain Gaffey	Blue Tank and Pump	bgaffey@bluetankandpump.com	614-800-1353
Mike Smith	Blue Tank and Pump	msmith@bluetankandpump.com	614-800-3851

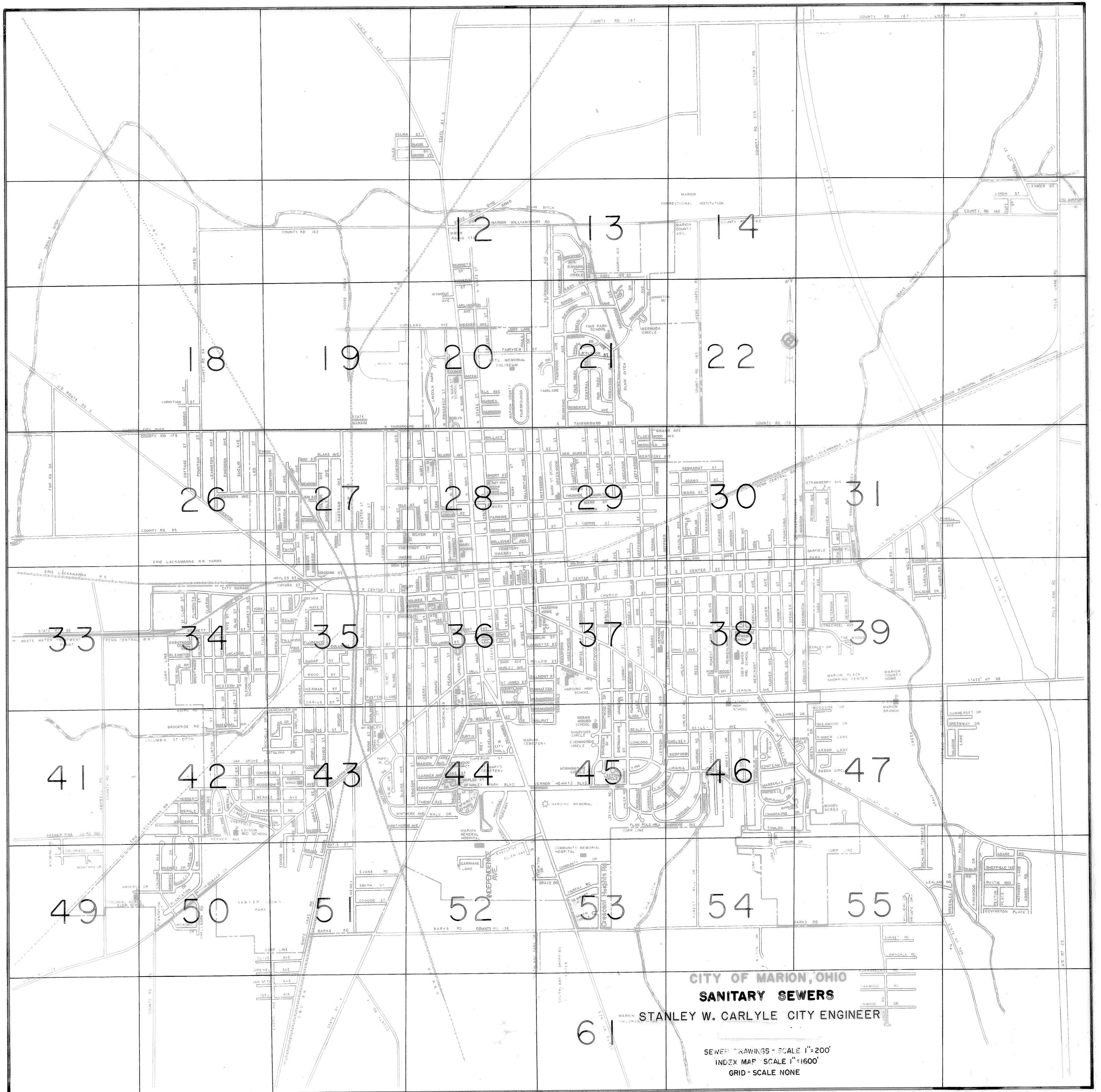

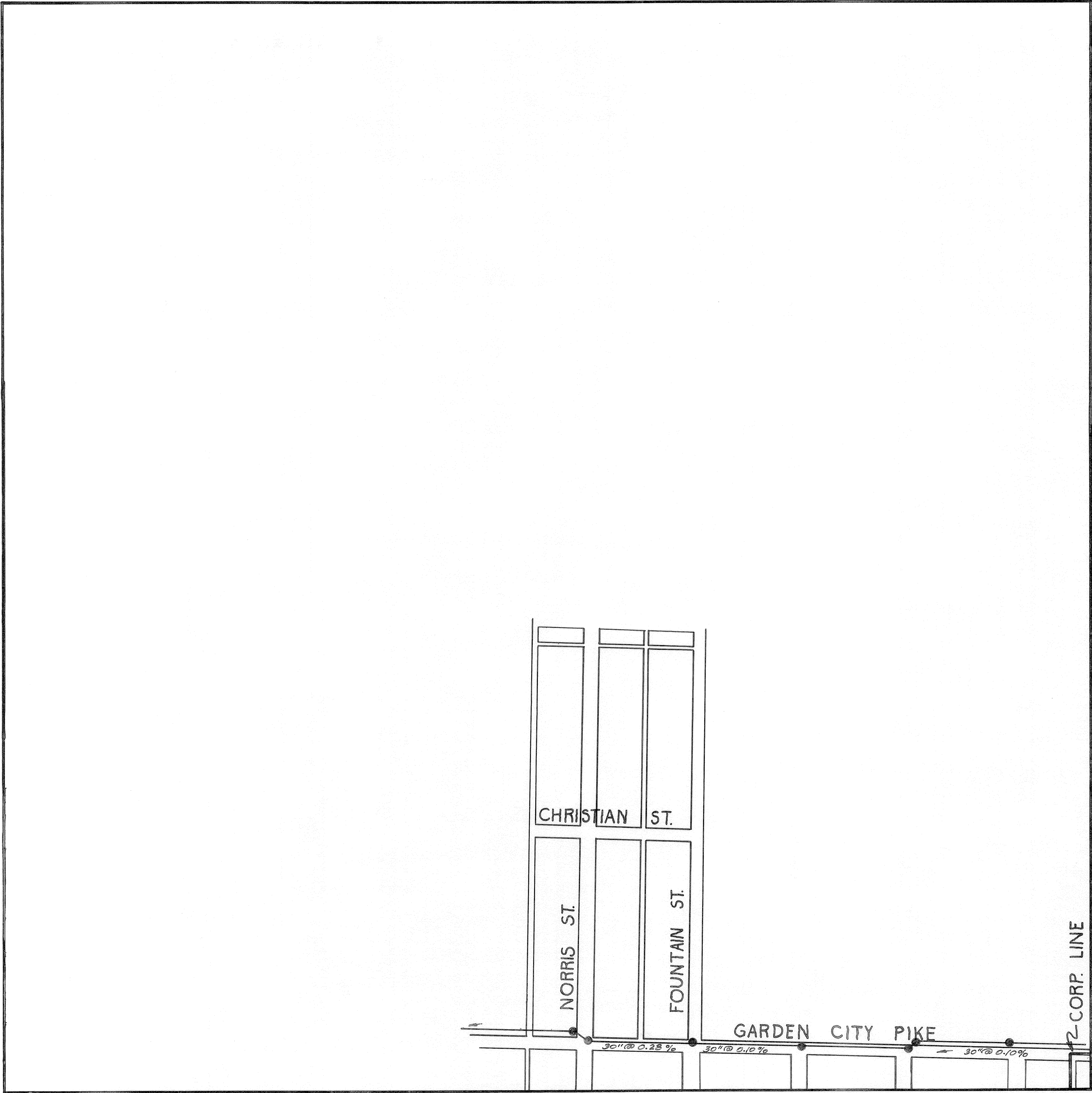

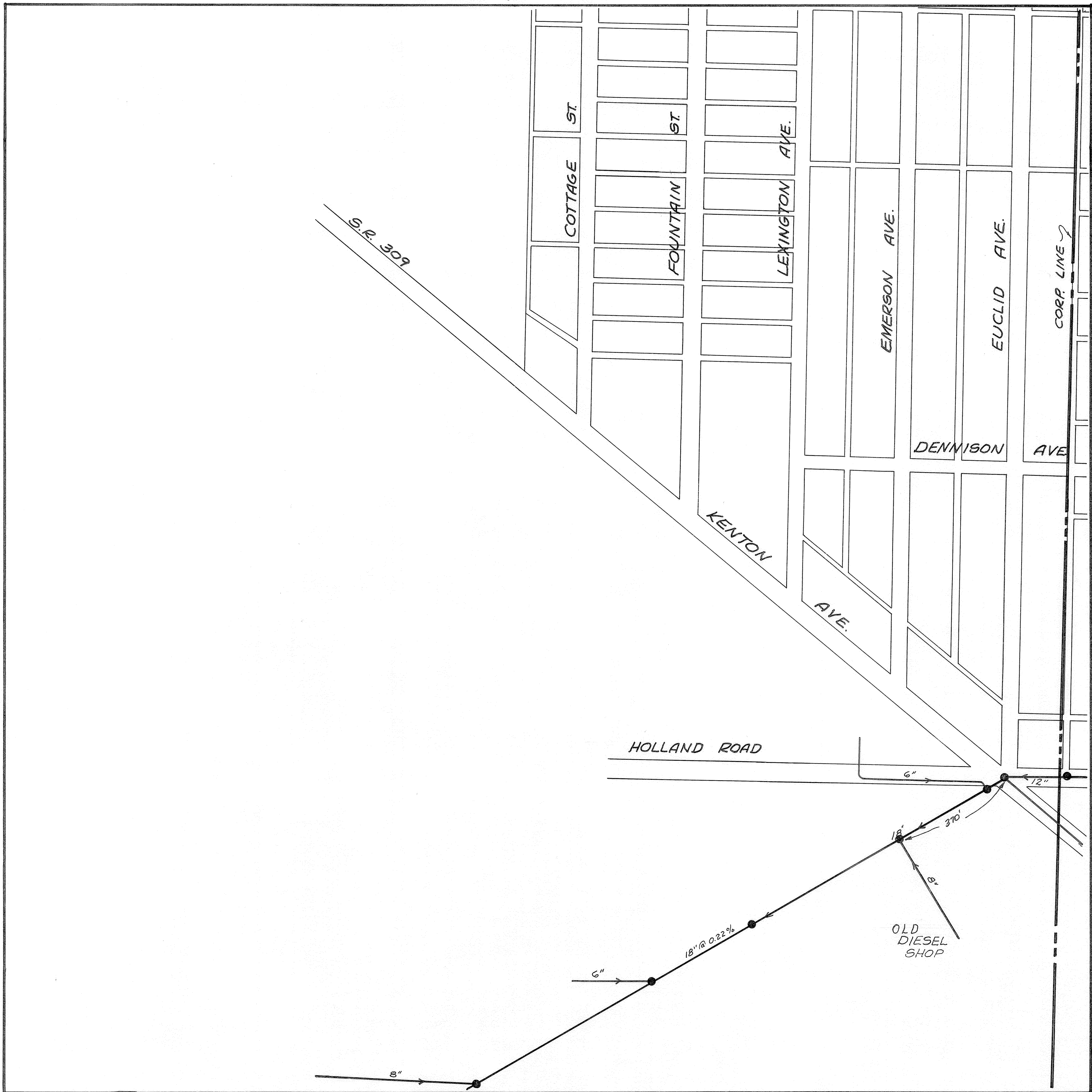

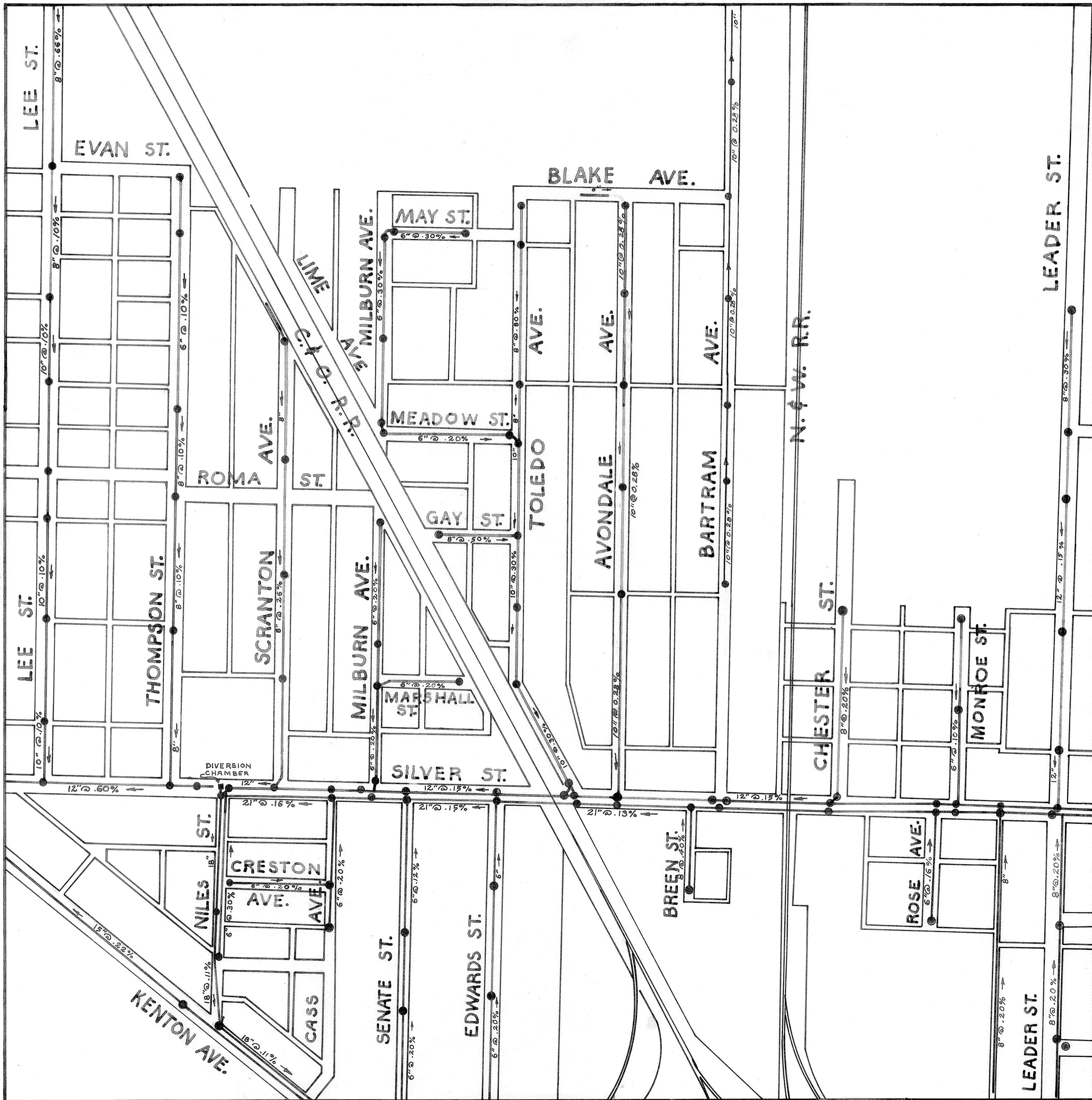

WHIRLPOOL
CORP

S.R. 95

PENN.-CENTRAL R.R.

BENNETT ST.

CO. RD. 101

CAMPBELL ROAD

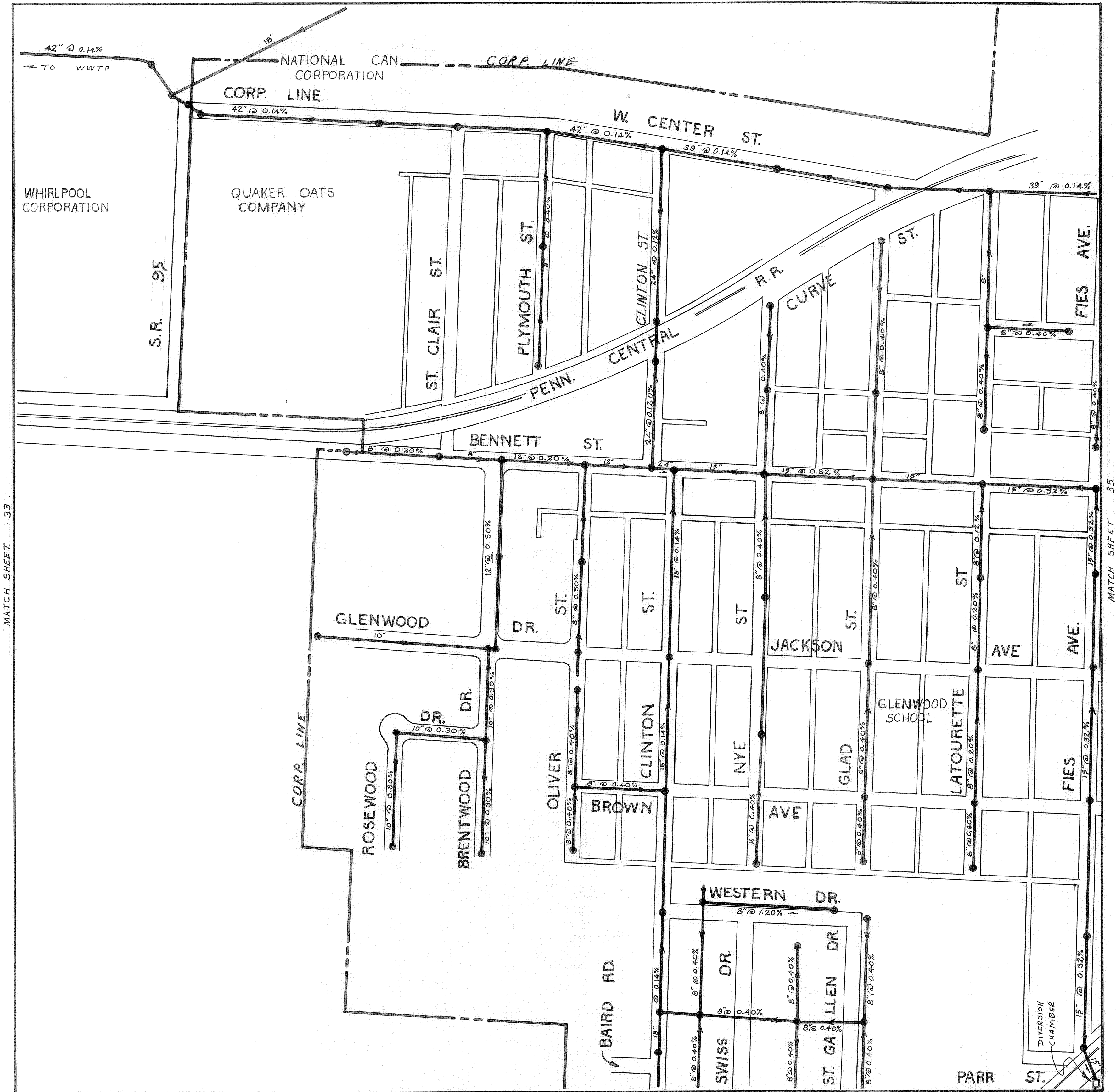

MATCH SHEET 33

MATCH SHEET 35



MATCH SHEET 34

MATCH SHEET 36

CWV

PRICES TO INCLUDE

PART 1 - GENERAL

Any work shown on the plans or required in the specifications but not paid for separately as a bid item shall be included in the cost of other bid items. The amount bid for each Bid Item shall include the following:

- 1.1 All labor, materials, tools, equipment, and transportation necessary for the proper execution of the work in accordance with the Contract Documents.
- 1.2 All assistance required by the Engineer to verify compliance with the Contract Documents, including measuring for final pay quantities.
- 1.3 Project coordination and scheduling.
- 1.4 Detailed breakdown of lump sum bid items as requested by the Engineer.
- 1.5 All provisions necessary to protect workers, the general public, and property along the work in accordance with the Contract Documents.
- 1.6 Protection and/or replacement of existing property corner monuments.
- 1.7 Record drawings of the installed location of all underground electrical conduit, sewers, tees, wyes, laterals, etc.
- 1.8 Materials testing.
- 1.9 Reimbursement to Owner for costs of re-inspection or re-testing of any work not installed in compliance with the Contract Documents.
- 1.10 Construction staking of the improvements.
- 1.11 Bonds and Insurances
- 1.12 Mobilization and setup of laydown and storage areas for equipment, materials, tools, and other items necessary for construction of improvements.
- 1.13 Preconstruction video to document existing surface conditions prior to construction.
- 1.14 Maintaining traffic in accordance with ODOT Item 614 and the Ohio Manual of Uniform Traffic Control Devices, including all equipment, materials, and labor necessary to implement necessary devices. This includes any coordination and permitting associated with required detours during the course of construction.
- 1.15 Seeding & Mulching including grading, topsoil, seed, mulch, fertilizer, lime, watering & mowing.
- 1.16 All erosion control measures in accordance with the Contract Documents.
- 1.17 Shoring system design, material, and implementation
- 1.18 All submittals and design noted as required within the Summary of Work
- 1.19 Management of flows, including any and all equipment, materials, labor, and or appurtenances necessary to implement bypass pumping, for the installation of any and all improvements

These items shall cover both all work within the base bid and alternative bid that is awarded. The Contractor shall include these costs in the items associated with each alternative bid they submit for. It shall be noted that only one alternative bid will be selected along with the base bid and if the Contractor submits bids for multiple alternatives, each alternative will include these items plus the cost of the items associated with the Base Bid.

PART 2 - ITEMS

BASE BID – MANHOLE IMPROVEMENTS

All work proposed by this contract shall be quantified and paid for in accordance with the pertinent O.D.O.T. specification except as specifically altered by other provisions of this contract.

2.1 (604) MANHOLE REHABILITATION, CLEANING, REPAIRS, AND LINING, AS PER PLAN

Method of Measurement

The method of measurement shall be per each manhole to be repaired and rehabilitated as detailed and prescribed in the “Manhole Improvement Schedule” in the detailed drawings. No additional payment shall be made for any diameter or net area that exceeds a noted diameters within the schedule or variations in depth measured in the field by the Contractor.

Basis of Payment

The unit price paid shall include sewage flow control; cleaning, grouting and injection materials, lining of manhole, chimney seals, and the furnishing of labor, materials, tools and appurtenances necessary to complete the work as specified or as shown. The liner thickness shall be per the approved manufacturer’s recommendations. Any additional rehabilitation such as replacement of bricks or manhole patching necessary to complete the specified improvements that is not currently identified in the drawings shall be included within this item.

2.2 (611) MANHOLE, ADJUSTED TO GRADE, METHOD D.1, (BRICK), AS PER PLAN

The work, method of construction and materials for various street castings adjusted to grade shall be in accordance with ODOT Item 611 with the following modifications:

1. Metal adjusting rings or castings shall not be used. Existing risers shall be removed during the casting adjustment.
2. Brick used shall be clay or shale brick meeting the requirements of ASTM C32 sewer brick, Grade SM.
3. Concrete brick or masonry block shall not be used.
4. The height limitation for additional compensation shall be revised from one (1) foot to two (2) feet.
5. Type QC MS concrete shall be used for fill around all castings.
6. All costs for work and material associated with incorporating a new style casting designated by the City which may include steel plates, corbelling, and/or shifting the casting to its proper location shall be included in this Item.

Method of Measurement

The quantity to be paid for of each manholes adjusted to grade to be paid for shall be the actual number adjusted to grade in accordance with the contract, contract drawings and these specifications.

Adjusting to grade of items proposed for new or replaced construction as part of the project will not be measured and shall be paid for in the cost of installation of that item.

Basis of Payment

The unit price stipulated, each, for manholes adjusted to grade to be paid for under this Item shall be full compensation for furnishing and placing all material including removal, cleaning, storage and resetting of salvaged casting or new casting; pavement saw cutting, resetting of loose brick work if needed, 3/4-inch steel plates, and furnishing of all labor, tools, and necessary appurtenances to complete the work as specified or as shown on the contract drawings.

2.3 (611) SANITARY MANHOLE, ALL SIZES AND TYPES, AS PER PLAN

Method of Measurement

The number of each Type “E” manholes or manhole constructed using an access tee and riser with concrete collar (see construction detail “Access Riser & Reinforcement Installation”) to be paid for shall be the actual number furnished and built in place in accordance with the contract drawings and with these specifications.

Basis of Payment

The unit price bid for sanitary structures shall be irrespective of the depth of the manhole structures, and shall include the furnishing and construction in place of the manholes and junction chambers complete with excavation foundation; backfill; frame and cover; steps; concrete; steel reinforcement; lining material; bricks; mortar; plastering; precast manhole sections; access tee with riser pipe; concrete collar; transition; flexible joints; furnishing, installing and operating necessary pumps, pipes and appurtenances necessary for flow bypassing and/or trench dewatering granular backfill under proposed or existing pavements, walks, drives, existing drainage structures, and disposal of all undesirable material; testing and inspections; and the furnishing of all labor, materials, tools and appliances necessary to complete the work as specified or as shown. Adjustments in final casting elevations of plus or minus one (1) foot shall be included in the price for each structure.

The unit price shall also include the furnishing of all labor, materials, tools and equipment necessary to install and safely remove construction pits and pipe bracing as designated in the Detailed Drawings. Engineering details and plans associated with the submittals for these items shall be included in this pay item.

2.4 (611) 72 INCH SANITARY SEWER, ADDITIONAL FOOTAGE, CONTINGENCY, AS PER PLAN, AS DIRECTED

The work, method of construction and materials for sewer construction shall be in accordance with ODOT Item 611 with the modifications shown on the improvement plans and detailed in the specifications.

Method of Measurement

The quantity of sewer to be paid for shall be determined for gravity sewers by the linear feet difference in horizontal stationing from the tie in location at the manhole to the location where the sewer is joined with the existing brick sewer by concrete collar. If the sewer is joined between two sections of pipe, the difference in horizontal stationing from each concrete collar where the new point joins to the existing brick sewer shall be used to determine the linear feet installed.

Basis of Payment

The unit price stipulated per lineal foot for sewer pipe of the various sizes and types specified shall be irrespective of class of pipe and depth and if not called out as a separate pay item, shall be full compensation for maintenance of traffic for the duration of the project; earth and/or rock excavation for the pipe and foundation for same, including clearing and grubbing; removal of all materials necessary for placing the pipe, the complete removal hauling, and disposal of the existing sewer, manholes and catch basins except materials listed separately; furnishing and placing granular or concrete bedding and special backfill as required, testing of compaction, constructing and subsequently removing all necessary boring and receiving pits, cofferdams, cribs, sheeting and shoring; furnishing, installing and operating necessary pumps, pipes and appurtenances necessary for flow bypassing and/or trench dewatering; sealing or banding all pipe joints where required; furnishing and installing of the pipe jointing materials and all necessary plugs, bulkheads, bends, fittings, specials and branches of a type at least equal to the conduit of which it becomes part; furnishing and installing concrete encasements, boring and steel casing pipe where required; protection, verification and/or replacement of all existing utilities, i.e., gas mains, gas connections water mains (including hydrants and their connections to the main), water connections, water wells, septic tanks, sanitary sewers, sanitary connections, storm sewers, storm connections, curb drains, catch basins, culverts, electric or telephone underground cables and/or underground connections if damaged by the Contractor; protection of existing trees or vegetation; joining of the pipe to existing and proposed manholes, catch basins, structures, and other appurtenances as required whether temporary or permanent; leakage testing or internal videotaping; disposal of all surplus and unsuitable materials; furnishing and installing temporary stone trench topping of pavement and driveways; removal and replacement of poles, posts, signs, mailboxes, paper boxes, fences, landscape timbers, guardrails, sign wiring, fixtures and other appurtenances; removal and replacement of any damaged curbing, sidewalk, driveways, parking lots and roadways as directed by the Engineer; and the furnishing of all labor, tools, materials and equipment necessary to complete the work as specified or as shown.

2.5 (SPC) TYPE "C" PAVEMENT REPLACEMENT (ASPHALT), ROADWAY, AS PER PLAN

Method of Measurement

The method of measurement shall be as per ODOT 253 or 255 as applicable with the exception that lengths used for calculation of each individual repair area shall not exceed the maximum pay length indicated on the drawings.

Basis of Payment

The basis of payment shall be as per ODOT 253 or 255 as applicable with the following additions:

The unit price shall also include saw cutting; integral or non-integral curb removal; integral curb replacement; furnishing, installation, maintenance, removal, and disposal of temporary road materials or temporary pavement courses; preparation for permanent pavement courses; and any additional expenses for cold weather protection.

2.6 (603) 66 INCH - 84 INCH SANITARY SEWER HEAVY CLEANING, AS PER PLAN

Method of Measurement

The quantity to be paid shall be the number of linear feet cleaned per the specifications measured along the centerline of the pipe. Starting and end points shall be field determined and agreed upon by the Engineer and Contractor prior to commencement of cleaning.

Basis of Payment

The unit prices for the various sizes of pipes shall include furnishing water, cleaning equipment, root removal, the complete removal and disposal of debris as per NASSCO guidelines for heavy cleaning of sewers. This item shall include pre and post cleaning CCTV per NASSCO guidelines. Any section that is reviewed by the Engineer and determined to not be completing cleaned shall be recleaned and televised at no additional cost to the Owner.

2.7 (603) 72 INCH CURED-IN-PLACE PIPE LINING, AS PER PLAN

Method of Measurement

The quantity to be paid shall be the number of linear feet installed per the specifications measured inside wall to inside wall of manholes for the mainline. This pay item is for a 72" Egg sewer that has noted variations in height to width ratio. Any variation between MH1 to MH12, whether less or greater in total perimeter of or shape of the each cross section of sewer, shall not have any modification in price and the Contractor shall account for the variations when determining their unit cost.

Basis of Payment

The unit prices for the various thicknesses of liner pipe shall include sewer cleaning, measurements of existing pipe size and length to verify plan notes, determination of live connections, sewage flow control not included in other pay items, all liner system materials, installation, processing and cooling, sealing of liner at manholes, testing, post-installation video recording, cleanup, restoration, and the furnishing of all labor, material, tools and appurtenances necessary to complete the work in accordance with these specifications, the manufacturer's recommendations, or as shown. The minimum thickness of the liner material shall be as specified.

2.8 (603) 72 INCH SLIP LINING, AS PER PLAN

Method of Measurement

The quantity to be paid shall be the number of linear feet installed per the specifications measured inside wall to inside wall of manholes for the mainline. This pay item is for a 72" Egg sewer that has noted variations in height to width ratio. Any variation between MH1 to MH12, whether less or

greater in total perimeter or shape of each cross section of sewer, shall not have any modification in price and the Contractor shall account for the variations when determining their unit cost.

Basis of Payment

The unit prices for the various thicknesses of liner pipe shall include sewer cleaning, measurements of existing pipe size and length to verify plan notes, determination of live connections, sewage flow control not included in other pay items, all liner system materials, installation, processing and cooling (where necessary), sealing of liner at manholes, testing, post-installation video recording, cleanup, restoration, and the furnishing of all labor, material, tools and appurtenances necessary to complete the work in accordance with these specifications, the manufacturer's recommendations, or as shown. The minimum thickness of the liner material shall be as specified.

2.9 (SPC) MISCELLANEOUS SEWER IMPROVEMENT, AS PER PLAN

Method of Measurement

This item is designated for an alternative sewer improvement by the Contractor that is not explicitly specified in Alternative 1 or Alternative 2. The Contractor shall as a part of submitting a bid for this item provide the materials, means, and methods for installation of the proposed rehabilitation system. The item shall be paid for by per linear foot based on the horizontal stationing of from which the improvements start to where they are completed.

Basis of Payment

For interior rehabilitation based methods, the Contractor shall submit the unit prices for the various thicknesses of liner pipe shall include sewer cleaning, surface preparation, measurements of existing pipe size and length to verify plan notes, determination of live connections, sewage flow control not included in other pay items, all liner system materials, installation, processing and cooling (where necessary), sealing of liner at manholes, reinforcement, testing, post-installation video recording, cleanup, restoration, and the furnishing of all labor, material, tools and appurtenances necessary to complete the work in accordance with these specifications, the manufacturer's recommendations, or as shown. The minimum thickness of the liner material shall be as specified.

For any replacement or methods that requires excavation outside of installation access points, the Contractor shall submit a unit price stipulated per lineal foot for sewer pipe of the various sizes and types specified shall be irrespective of class of pipe and depth and if not called out as a separate pay item, shall be full compensation for maintenance of traffic for the duration of the project; earth and/or rock excavation for the pipe and foundation for same, including clearing and grubbing; removal of all materials necessary for placing the pipe, the complete removal, hauling, and disposal of the existing sewer, manholes and catch basins except materials listed separately; furnishing and placing granular or concrete bedding and special backfill as required, testing of compaction, constructing and subsequently removing all necessary boring and receiving pits, cofferdams, cribs, sheeting and shoring; furnishing, installing and operating necessary pumps, pipes and appurtenances necessary for flow bypassing and/or trench dewatering; sealing or banding all pipe joints where required; furnishing and installing of the pipe jointing materials and all necessary plugs, bulkheads, bends, fittings, specials and branches of a type at least equal to the conduit of which it becomes part; furnishing and installing concrete encasements, boring and steel casing pipe where required; protection, verification and/or replacement of all existing utilities, i.e., gas mains, gas connections water mains (including hydrants and their connections to the main), water

connections, water wells, septic tanks, sanitary sewers, sanitary connections, storm sewers, storm connections, curb drains, catch basins, culverts, electric or telephone underground cables and/or underground connections if damaged by the Contractor; protection of existing trees or vegetation; joining of the pipe to existing and proposed manholes, catch basins, structures, and other appurtenances as required whether temporary or permanent; leakage testing or internal videotaping; disposal of all surplus and unsuitable materials; furnishing and installing temporary stone trench topping of pavement and driveways; removal and replacement of poles, posts, signs, mailboxes, paper boxes, fences, landscape timbers, guardrails, sign wiring, fixtures and other appurtenances; removal and replacement of any damaged curbing, sidewalk, driveways, parking lots and roadways as directed by the Engineer; and the furnishing of all labor, tools, materials and equipment necessary to complete the work as specified or as shown.

2.10 (SPC) VOID FILL AND SEAL, AS PER PLAN

Method of Measurement

The quantity to be paid shall be for each individual location where injection of material to fill and seal the void is required. The amount of material shall to be paid under one (1) fill and seal shall be any space that requires filling within a 6' radius from the point of injection.

Basis of Payment

The unit price shall be irrespective of the depth of pipe and location of the void between manholes; equipment, tools, materials, and personal necessary to preform OSHA permitted confined spaced entries; all pumping required for adequate handling of flow bypassing, underground water and/or surface water; equipment and material required to fill voids from the within or above pipe; site cleanup; cutting of excess material after curing; removal, hauling, and disposing of excess void fill and sealant to an approved waste facility; pre and post construction video of each stretch of sewer in accordance with NASSCO PACP guidelines; photo/video documentation of joints prior to construction, during injection, after curing, and after restoration of surface; and the furnishing of all labor, materials, tools and appurtenances necessary to complete the work as specified or as shown.

**Proposal to City of Marion
 For Rock Swale Sewer Improvements Phase 1
 Alternate A - Slip-Lining and Manhole Improvements
 Project No. 242139**

REF. NO.	DESCRIPTION	QTY.	MEASURE UNITS	UNIT PRICE LABOR	UNIT PRICE MATERIAL	TOTAL UNIT PRICE	ITEM TOTAL
1	(SPC) 72 INCH SLIP LINING, AS PER PLAN	1.00	FT	\$ _____	\$ _____	\$ _____	\$ _____
2	(SPC) VOID FILL AND SEAL, AS PER PLAN	4.00	EACH	\$ _____	\$ _____	\$ _____	\$ _____
3	(680) BYPASS PUMPING, AS PER PLAN	1.00	DAY	\$ _____	\$ _____	\$ _____	\$ _____
INFORMAL TOTAL BID						\$ _____	

**Proposal to City of Marion
 For Rock Swale Sewer Improvements Phase 1
 Alternate B - Cured-in-Place (CIPP) Lining and Manhole Improvements
 Project No. 242139**

REF. NO.	DESCRIPTION	QTY.	MEASURE UNITS	UNIT PRICE LABOR	UNIT PRICE MATERIAL	TOTAL UNIT PRICE	ITEM TOTAL
1	(SPC) VOID FILL AND SEAL, AS PER PLAN	4.00	EACH	\$ _____	\$ _____	\$ _____	\$ _____
2	(SPC) 72 INCH CURED-IN-PLACE PIPE LINING, AS PER PLAN	1.00	FT	\$ _____	\$ _____	\$ _____	\$ _____
3	(680) BYPASS PUMPING, AS PER PLAN	1.00	DAY	\$ _____	\$ _____	\$ _____	\$ _____
INFORMAL TOTAL BID							\$ _____

**Proposal to City of Marion
For Rock Swale Sewer Improvements Phase 1
Alternate C - Alternative Means or Replacement
Project No. 242139**

REF. NO.	DESCRIPTION	QTY.	MEASURE UNITS	UNIT PRICE LABOR	UNIT PRICE MATERIAL	TOTAL UNIT PRICE	ITEM TOTAL
1	(SPC) VOID FILL AND SEAL, AS PER PLAN	4.00	EACH	\$ _____	\$ _____	\$ _____	\$ _____
2	(SPC) MISCELLANEOUS SEWER IMPROVEMENT, AS PER PLAN	1.00	FT	\$ _____	\$ _____	\$ _____	\$ _____
3	(680) BYPASS PUMPING, AS PER PLAN	1.00	DAY	\$ _____	\$ _____	\$ _____	\$ _____
INFORMAL TOTAL BID							\$ _____

"General Decision Number: OH20240001 11/08/2024

Superseded General Decision Number: OH20230001

State: Ohio

Construction Types: Heavy and Highway

Counties: Ohio Statewide.

Heavy and Highway Construction Projects

Note: Contracts subject to the Davis-Bacon Act are generally required to pay at least the applicable minimum wage rate required under Executive Order 14026 or Executive Order 13658. Please note that these Executive Orders apply to covered contracts entered into by the federal government that are subject to the Davis-Bacon Act itself, but do not apply to contracts subject only to the Davis-Bacon Related Acts, including those set forth at 29 CFR 5.1(a)(1).

Table with 2 columns: Contract conditions and applicable Executive Order (14026 or 13658) and wage requirements.

The applicable Executive Order minimum wage rate will be adjusted annually. If this contract is covered by one of the Executive Orders and a classification considered necessary for performance of work on the contract does not appear on this wage determination, the contractor must still submit a conformance request.

Additional information on contractor requirements and worker protections under the Executive Orders is available at http://www.dol.gov/whd/govcontracts.

Table with 2 columns: Modification Number and Publication Date.

BROH001-001 06/01/2023

DEFIANCE, FULTON (Excluding Fulton, Amboy & Swan Creek Townships), HENRY (Excluding Monroe, Bartlow, Liberty, Washington, Richfield, Marion, Damascus & Townships & that part of Harrison Township outside corporate limits of city of Napoleon), PAULDING, PUTNAM and WILLIAMS COUNTIES

Table with 3 columns: Job Classification, Rates, and Fringes.

BROH001-004 06/01/2023

Table with 3 columns: Job Classification, Rates, and Fringes.

BROH003-002 06/01/2023

FULTON (Townships of Amboy, Swan Creek & Fulton), HENRY (Townships of Washington, Damascus, Richfield, Bartlow, Liberty, Harrison, Monroe, & Marion), LUCAS and WOOD (Townships of Perrysburg, Ross, Lake, Troy, Freedom, Montgomery, Webster, Center, Portage, Middleton, Plain, Liberty, Henry, Washington, Weston, Milton, Jackson & Grand Rapids) COUNTIES

Table with 3 columns: Job Classification, Rates, and Fringes.

BROH005-003 06/01/2020

CUYAHOGA, LORAIN & MEDINA (Hinckley, Granger, Brunswick, Liverpool, Montville, York, Homer, Harrisville, Chatham, Litchfield & Spencer Townships and the city of Medina)

Rates Fringes

BRICKLAYER

BRICKLAYERS; CAULKERS; CLEANERS; POINTERS; & STONEMASONS.....	\$ 36.64	17.13
SANDBLASTERS.....	\$ 36.39	17.13
SEWER BRICKLAYERS & STACK BUILDERS.....	\$ 36.64	17.13
SWING SCAFFOLDS.....	\$ 37.14	17.13

BROH006-005 06/01/2023

CARROLL, COLUMBIANA (Knox, Butler, West & Hanover Townships), STARK & TUSCARAWAS

Rates Fringes

Bricklayer, Stonemason.....	\$ 32.40	19.30
-----------------------------	----------	-------

BROH007-002 06/01/2023

LAWRENCE

Rates Fringes

Bricklayer, Stonemason.....	\$ 32.40	19.30
-----------------------------	----------	-------

BROH007-005 06/01/2023

PORTAGE & SUMMIT

Rates Fringes

BRICKLAYER.....	\$ 32.40	19.30
-----------------	----------	-------

BROH007-010 06/01/2023

PORTAGE & SUMMIT

Rates Fringes

MASON - STONE.....	\$ 32.40	19.30
--------------------	----------	-------

BROH008-001 06/01/2023

COLUMBIANA (Salem, Perry, Fairfield, Center, Elk Run, Middleton, & Unity Townships and the city of New Waterford), MAHONING & TRUMBULL

Rates Fringes

BRICKLAYER.....	\$ 32.40	19.30
-----------------	----------	-------

BROH009-002 06/01/2023

BELMONT & MONROE COUNTIES and the Townships of Warren & Mt. Pleasant and the Village of Dillonvale in JEFFERSON COUNTY

Rates Fringes

Bricklayer, Stonemason.....	\$ 32.40	19.30
Refractory.....	\$ 31.45	19.01

BROH010-002 06/01/2023

COLUMBIANA (St. Clair, Madison, Wayne, Franklin, Washington, Yellow Creek & Liverpool Townships) & JEFFERSON (Brush Creek & Saline Townships)

Rates Fringes

Bricklayer, Stonemason.....	\$ 32.40	19.30
-----------------------------	----------	-------

BROH014-002 06/01/2023

HARRISON & JEFFERSON (Except Mt. Pleasant, Warren, Brush Creek, Saline & Salineville Townships & the Village of Dillonvale)

Rates Fringes

Bricklayer, Stonemason.....	\$ 32.40	19.30
-----------------------------	----------	-------

BROH016-002 06/01/2023

ASHTABULA, GEAUGA, and LAKE COUNTIES

Rates Fringes

Bricklayer, Stonemason.....	\$ 32.40	19.30
-----------------------------	----------	-------

BROH018-002 06/01/2023

BROWN, BUTLER, CLERMONT, HAMILTON, PREBLE (Gasper, Dixon, Israel, Lanier, Somers & Gratis Townships) & WARREN COUNTIES:

	Rates	Fringes
Bricklayer, Stonemason.....	\$ 32.40	19.30

BROH0022-004 06/01/2023

CHAMPAIGN, CLARK, CLINTON, DARKE, GREENE, HIGHLAND, LOGAN, MIAMI, MONTGOMERY, PREBLE (Jackson, Monroe, Harrison, Twin, Jefferson & Washington Townships) and SHELBY COUNTIES

	Rates	Fringes
Bricklayer, Stonemason.....	\$ 32.40	19.30

BROH0032-001 06/01/2023

GALLIA & MEIGS

	Rates	Fringes
Bricklayer, Stonemason.....	\$ 32.40	19.30

BROH0035-002 06/01/2023

ALLEN, AUGLAIZE, MERCER and VAN WERT COUNTIES

	Rates	Fringes
Bricklayer, Stonemason.....	\$ 32.40	19.30

BROH0039-002 06/01/2023

ADAMS & SCIOTO

	Rates	Fringes
Bricklayer, Stonemason.....	\$ 32.40	19.30

BROH0040-003 06/01/2023

ASHLAND, CRAWFORD, HARDIN, HOLMES, MARION, MORROW, RICHLAND, WAYNE and WYANDOT (Except Crawford, Ridge, Richland & Tymochtee Townships) COUNTIES

	Rates	Fringes
Bricklayer, Stonemason.....	\$ 32.40	19.30

FOOTNOTE: Layout Man and Sawman rate: \$1.00 per hour above journeyman rate.
Free standing stack work ground level to top of stack;
Sandblasting and laying of carbon masonry material in swing stage and/or scaffold; Ramming and spading of plastics and gunniting: \$1.50 per hour above journeyman rate.
"Hot" work: \$2.50 above journeyman rate.

BROH0044-002 06/01/2023

	Rates	Fringes
Bricklayer, Stonemason COSHOCKTON, FAIRFIELD, GUERNSEY, HOCKING, KNOX, KICKING, MORGAN, MUSKINGUM, NOBLE (Beaver, Buffalo, Seneca & Wayne Townships) & PERRY COUNTIES:.....	\$ 32.40	19.30

BROH0045-002 06/01/2023

FAYETTE, JACKSON, PIKE, ROSS and VINTON COUNTIES

	Rates	Fringes
Bricklayer, Stonemason.....	\$ 35.39	17.47

BROH0046-002 06/01/2023

ERIE, HANCOCK, HURON, OTTAWA, SANDUSKY, SENECA, WOOD (Perry & Bloom Townships) and WYANDOT (Tymochtee, Crawford, Ridge & Richland Townships) COUNTIES & the Islands of Lake Erie north of Sandusky

	Rates	Fringes
Bricklayer, Stonemason.....	\$ 32.40	19.30

FOOTNOTE: Layout Man and Sawman rate: \$1.00 per hour above journeyman rate.
Free standing stack work ground level to top of stack;
Sandblasting and laying of carbon masonry material in swing stage and/or scaffold; Ramming and spading of plastics and gunniting: \$1.50 per hour above journeyman rate.
"Hot" work: \$2.50 above journeyman rate.

BROH0052-001 06/01/2023

ATHENS COUNTY

	Rates	Fringes
Bricklayer, Stonemason.....	\$ 32.40	19.30

BROH0052-003 06/01/2023

NOBLE (Brookfield, Noble, Center, Sharon, Olive, Enoch, Stock, Jackson, Jefferson & Elk Townships) and WASHINGTON COUNTIES

	Rates	Fringes
Bricklayer, Stonemason.....	\$ 32.40	19.30

BROH0055-003 06/01/2023

DELAWARE, FRANKLIN, MADISON, PICKAWAY and UNION COUNTIES

	Rates	Fringes
Bricklayer, Stonemason.....	\$ 32.40	19.30

CARP0003-004 05/01/2017

MAHONING & TRUMBULL

	Rates	Fringes
CARPENTER.....	\$ 26.20	17.42

CARP0069-003 05/01/2017

CARROLL, STARK, TUSCARAWAS & WAYNE

	Rates	Fringes
CARPENTER.....	\$ 25.98	15.98

CARP0069-006 05/01/2017

COSHOCTON, HOLMES, KNOX & MORROW

	Rates	Fringes
CARPENTER.....	\$ 24.04	15.29

CARP0171-002 05/01/2024

BELMONT, COLUMBIANA, HARRISON, JEFFERSON & MONROE

	Rates	Fringes
CARPENTER.....	\$ 31.82	25.11

CARP0200-002 05/01/2024

ADAMS, ATHENS, DELAWARE, FAIRFIELD, FAYETTE, FRANKLIN, GALLIA, GUERNSEY, HIGHLAND, HOCKING, JACKSON, LAWRENCE, LICKING, MADISON, MARION, MEIGS, MORGAN, MUSKINGUM, NOBLE, PERRY, PICKAWAY, PIKE, ROSS, SCIOTO, UNION, VINTON and WASHINGTON COUNTIES

	Rates	Fringes
CARPENTER.....	\$ 33.15	22.43
Diver.....	\$ 39.41	10.40
PILEDRIVERMAN.....	\$ 33.15	22.43

CARP0248-005 07/01/2008

LUCAS & WOOD

	Rates	Fringes
CARPENTER.....	\$ 27.27	14.58

CARP0248-008 07/01/2008

	Rates	Fringes
CARPENTER DEFIANCE, FULTON, HANCOCK, HENRY, PAULDING & WILLIAMS COUNTIES.....	\$ 23.71	13.28

CARP0254-002 05/01/2017

ASHTABULA, CUYAHOGA, GEauga & LAKE

	Rates	Fringes
CARPENTER.....	\$ 32.40	16.97

CARP0372-002 05/01/2024

ALLEN, AUGLAIZE, HARDIN, MERCER, PUTNAM & VAN WERT

	Rates	Fringes
--	-------	---------

CARPENTER.....	\$ 30.73	25.09

CARP0639-003 05/01/2017		
MEDINA, PORTAGE & SUMMIT		
	Rates	Fringes
CARPENTER.....	\$ 30.42	16.99

CARP0735-002 05/01/2024		
ASHLAND, ERIE, HURON, LORAIN & RICHLAND		
	Rates	Fringes
CARPENTER.....	\$ 33.43	22.31

CARP1311-001 05/01/2017		
BROWN, BUTLER, CHAMPAIGN, CLARK, CLERMONT, CLINTON, DARKE, GREENE, HAMILTON, LOGAN, MIAMI, MONTGOMERY, PREBLE, SHELBY & WARREN		
	Rates	Fringes
Carpenter & Piledrivermen.....	\$ 29.34	15.95
Diver.....	\$ 40.58	9.69

CARP1393-002 05/01/2024		
CRAWFORD, DEFIANCE, FULTON, HANCOCK, HENRY, LUCAS, OTTAWA, PAULDING, SANDUSKY, SENECA, WILLIAMS & WOOD		
	Rates	Fringes
Piledrivermen & Diver's Tender...\$	36.84	27.72

DIVERS - \$250.00 per day		

CARP1393-003 05/01/2024		
ALLEN, AUGLAIZE, HARDIN, MERCER, PUTNAM, VAN WERT & WYANDOT		
	Rates	Fringes
Piledrivermen & Diver's Tender...\$	34.68	27.60

DIVERS - \$250.00 per day		

CARP1871-006 05/01/2017		
BELMONT, HARRISON, & MONROE		
	Rates	Fringes
Diver, Wet.....	\$ 48.11	17.33
Piledrivermen; Diver, Dry.....	\$ 32.07	17.33

CARP1871-008 05/01/2017		
ASHLAND, ASHTABULA, CUYAHOGA, ERIE, GEAUGA, HURON, LAKE, LORAIN, MEDINA, PORTAGE, RICHLAND & SUMMIT		
	Rates	Fringes
Diver, Wet.....	\$ 45.80	18.84
Piledrivermen; Diver, Dry.....	\$ 30.53	18.84

CARP1871-014 05/01/2017		
CARROLL, STARK, TUSCARAWAS & WAYNE		
	Rates	Fringes
Diver, Wet.....	\$ 38.34	16.95
Piledrivermen; Diver, Dry.....	\$ 25.56	16.95

CARP1871-015 05/01/2017		
COSHOCOTON, HOLMES, KNOX & MORROW		
	Rates	Fringes
Diver, Wet.....	\$ 37.34	16.07
Piledrivermen; Diver, Dry.....	\$ 24.89	16.07

CARP1871-017 05/01/2017		
MAHONING & TRUMBULL		
	Rates	Fringes
Diver, Wet.....	\$ 40.65	17.62
Piledrivermen; Diver, Dry.....	\$ 27.10	17.62

CARP2235-012 01/01/2014		
COLUMBIANA & JEFFERSON		
	Rates	Fringes

PILEDRIVERMAN.....\$ 31.74 16.41

 CARP2239-001 07/01/2008

CRAWFORD, OTTAWA, SANDUSKY, SENECA & WYANDOT

Rates Fringes

CARPENTER.....\$ 23.71 13.28

 ELEC0008-002 05/29/2023

DEFIANCE, FULTON, HANCOCK, HENRY, LUCAS, OTTAWA, PAULDING, PUTNAM, SANDUSKY, SENECA, WILLIAMS & WOOD

Rates Fringes

CABLE SPLICER.....\$ 38.98 18.96
 ELECTRICIAN.....\$ 46.38 4.5%+21.96

 ELEC0032-003 06/01/2024

ALLEN, AUGLAIZE, HARDIN, LOGAN, MERCER, SHELBY, VAN WERT & WYANDOT (Crawford, Jackson, Marseilles, Mifflin, Ridgeland, Ridge & Salem Townships)

Rates Fringes

ELECTRICIAN.....\$ 35.17 22.92

 ELEC0038-002 04/29/2024

CUYAHOGA, GEAUGA (Bainbridge, Chester & Russell Townships) & LORAIN (Columbia Township)

Rates Fringes

ELECTRICIAN
 Excluding Sound &
 Communications Work.....\$ 45.23 23.88

FOOTNOTES;
 a. 6 Paid Holidays: New Year's Day; Memorial Day; July 4th; Labor Day; Thanksgiving Day; & Christmas Day
 b. 1 week's paid vacation for 1 year's service; 2 weeks' paid vacation for 2 or more years' service

 ELEC0038-008 04/24/2023

CUYAHOGA, GEAUGA (Bainbridge, Chester & Russell Townships) & LORAIN (Columbia Township)

Rates Fringes

Sound & Communication
 Technician
 Communications Technician...\$ 29.80 13.80
 Installer Technician.....\$ 28.55 13.76

FOOTNOTES;
 a. 6 Paid Holidays: New Year's Day; Memorial Day; July 4th; Labor Day; Thanksgiving Day; & Christmas Day
 b. 1 week's paid vacation for 1 year's service; 2 weeks' paid vacation for 2 or more years' service

 ELEC0064-003 11/27/2023

COLUMBIANA (Butler, Fairfield, Perry, Salem & Unity Townships) MAHONING (Austintown, Beaver, Berlin, Boardman, Canfield, Ellsworth, Coitsville, Goshen, Green, Jackson, Poland, Springfield & Youngstown Townships), & TRUMBULL (Hubbard & Liberty Townships)

Rates Fringes

ELECTRICIAN.....\$ 37.90 20.08

 ELEC0071-001 01/01/2024

ASHLAND, CHAMPAIGN, CLARK, COSHOCTON, CRAWFORD, DELAWARE, FAIRFIELD, FAYETTE, FRANKLIN, GUERNSEY, HIGHLAND, HOCKING, JACKSON (Coal, Jackson, Liberty, Milton, Washington & Wellston Townships), KNOX, LICKING, MADISON, MARION, MONROE, MORGAN, MORROW, MUSKINGUM, NOBLE, PERRY, PICKAWAY, PIKE (Beaver, Benton, Jackson, Mifflin, Pebble, Peepee, Perry & Seal Townships), RICHLAND, ROSS, TUSCARAWAS (Auburn, Bucks, Clay, Jefferson, Oxford, Perry, Salem, Rush, Washington & York Townships), UNION, VINTON (Clinton, Eagle, Elk, Harrison, Jackson, Richland & Swan Townships), and WASHINGTON COUNTIES

Rates Fringes

Line Construction
 Equipment Operators.....\$ 39.11 17.14
 Groundmen.....\$ 25.90 13.97
 Linemen & Cable Splicers...\$ 44.52 18.43

ELEC0071-004 01/01/2024

AUGLAIZE, CLINTON, DARKE, GREENE, LOGAN, MERCER, MIAMI, MONTGOMERY, PREBLE, and SHELBY COUNTIES

	Rates	Fringes
Line Construction		
Equipment Operator.....	\$ 39.11	17.14
Groundman.....	\$ 25.90	13.97
Lineman & Cable Splicers....	\$ 44.52	18.43

ELEC0071-005 01/01/2024

ASHTABULA, CUYAHOGA, GEAUGA, LAKE & LORAIN

	Rates	Fringes
LINE CONSTRUCTION: Equipment Operator		
DOT/Traffic Signal & Highway Lighting Projects...	\$ 37.43	26%+7.75
Municipal Power/Transit Projects.....	\$ 47.86	27%+7.65
LINE CONSTRUCTION: Groundman		
DOT/Traffic Signal & Highway Lighting Projects...	\$ 25.63	26%+7.75
Municipal Power/Transit Projects.....	\$ 31.91	27%+7.65
LINE CONSTRUCTION: Linemen/Cable Splicer		
DOT/Traffic Signal & Highway Lighting Projects...	\$ 42.20	26%+7.75
Municipal Power/Transit Projects.....	\$ 53.18	27%+7.65

ELEC0071-008 01/01/2024

COLUMBIANA, MAHONING, and TRUMBULL COUNTIES

	Rates	Fringes
Line Construction		
Equipment Operator.....	\$ 39.11	17.14
Groundman.....	\$ 25.90	13.97
Lineman & Cable Splicers....	\$ 44.52	18.43

ELEC0071-010 01/01/2024

	Rates	Fringes
Line Construction		
Equipment Operator.....	\$ 39.11	17.14
Groundman.....	\$ 25.90	13.97
Lineman & Cable Splicers....	\$ 44.52	18.43

ELEC0071-013 01/01/2024

BROWN, BUTLER, CLERMONT, HAMILTON, and WARREN COUNTIES

	Rates	Fringes
Line Construction		
Equipment Operator.....	\$ 39.11	17.14
Groundman.....	\$ 25.90	13.97
Lineman & Cable Splicers....	\$ 44.52	18.43

ELEC0071-014 01/01/2024

ADAMS, ATHENS, GALLIA, JACKSON (Bloomfield, Franklin, Hamilton, Lick, Jefferson, Scioto & Madison Townships), LAWRENCE, MEIGS, PIKE (Camp Creek, Marion, Newton, Scioto, Sunfish & Union Townships), SCIOTO & VINTON (Brown, Knox, Madison, Vinton & Wilkesville Townships)

	Rates	Fringes
Line Construction		
Equipment Operator.....	\$ 39.11	17.14
Groundman.....	\$ 25.90	13.97
Lineman & Cable Splicers....	\$ 44.52	18.43

ELEC0082-002 12/04/2023

CLINTON, DARKE, GREENE, MIAMI, MONTGOMERY, PREBLE & WARREN (Wayne, Clear Creek & Franklin Townships)

	Rates	Fringes
ELECTRICIAN.....	\$ 36.00	21.99

* ELEC0082-006 11/28/2022

CLINTON, DARKE, GREENE, MIAMI, MONTGOMERY, PREBLE & WARREN (Wayne, Clear Creek & Franklin Townships)

	Rates	Fringes
Sound & Communication Technician		
Cable Puller.....	\$ 13.10 **	4.76

Installer/Technician.....\$ 26.20 13.89

 ELEC0129-003 02/26/2024

LORAIN (Except Columbia Township) & MEDINA (Litchfield & Liverpool Townships)

	Rates	Fringes
ELECTRICIAN.....	\$ 41.40	18.36

 ELEC0129-004 02/26/2024

ERIE & HURON (Lyme, Ridgefield, Norwalk, Townsend, Wakeman, Sherman, Peru, Bronson, Hartland, Clarksfield, Norwich, Greenfield, Fairfield, Fitchville & New London Townships)

	Rates	Fringes
ELECTRICIAN.....	\$ 41.40	18.36

 ELEC0141-003 06/02/2024

BELMONT COUNTY

	Rates	Fringes
CABLE SPLICER.....	\$ 42.94	27.74
ELECTRICIAN.....	\$ 39.04	27.62

 ELEC0212-003 11/26/2018

BROWN, CLERMONT & HAMILTON

	Rates	Fringes
Sound & Communication Technician.....	\$ 24.35	10.99

 ELEC0212-005 06/03/2024

BROWN, CLERMONT, and HAMILTON COUNTIES

	Rates	Fringes
ELECTRICIAN.....	\$ 35.43	22.05

 * ELEC0245-001 08/26/2024

ALLEN, HARDIN, VAN WERT & WYANDOT (Crawford, Jackson, Marseilles, Mifflin, Richland, Ridge & Salem Townships)

	Rates	Fringes
Line Construction		
Equipment Operator.....	\$ 32.95	28%+7.85
Groundman Truck Driver.....	\$ 20.59	28%+7.85
Lineman.....	\$ 47.07	28%+7.85

FOOTNOTE: a. Half day's Paid Holiday: The last 4 hours of the workday prior to Christmas or New Year's Day

 ELEC0245-003 01/01/2024

DEFIANCE, FULTON, HANCOCK, HENRY, HURON, LUCAS, OTTAWA, PAULDING, PUTNAM, SANDUSKY, SENECA, WILLIAMS, and WOOD COUNTIES

	Rates	Fringes
Line Construction		
Cable Splicer.....	\$ 52.53	7.75+27%
Groundman/Truck Driver.....	\$ 19.99	7.75+27%
Heli-arc Welding.....	\$ 45.98	7.75+27%
Lineman.....	\$ 45.68	7.75+27%
Operator - Class 1.....	\$ 36.54	7.75+27%
Operator - Class 2.....	\$ 31.98	7.75+27%
Traffic Signal & Lighting Technician.....	\$ 41.11	7.75+27%

FOOTNOTE: a. 6 Observed Holidays: New Year's Day; Memorial Day; Independence Day; Labor Day; Thanksgiving Day; & Christmas Day. Employees who work on a holiday shall be paid at a rate of double their applicable classified straight-time rates for the work performed on such holiday.

 * ELEC0245-004 08/26/2024

ERIE COUNTY

	Rates	Fringes
Line Construction		
Cable Splicer.....	\$ 49.14	26.75%+6.75
Cablesplicer.....	\$ 54.13	28%7.85
Groundman/Truck Driver.....	\$ 20.59	28%7.85
Lineman.....	\$ 47.07	28%7.85
Operator - Class 1.....	\$ 36.70	28%7.85
Operator - Class 2.....	\$ 32.95	28%7.85

FOOTNOTE: a. 6 Observed Holidays: New Year's Day; Memorial Day; Independence Day; Labor Day; Thanksgiving Day; & Christmas Day. Employees who work on a holiday shall be paid at a rate of double their applicable classified straight-time rates for the work performed on such holiday.

 * ELEC0246-001 10/30/2023

	Rates	Fringes
ELECTRICIAN.....	\$ 46.75	32.99

FOOTNOTE: a. 1 1/2 Paid Holidays: The last scheduled workday prior to Christmas & 4 hours on Good Friday.

 * ELEC0306-005 05/27/2024

MEDINA (Brunswick, Chatham, Granger, Guilford, Harrisville, Hinckley, Homer, Lafayette, Medina, Montville, Sharon, Spencer, Wadsworth, Westfield & York Townships), PORTAGE (Atwater, Aurora, Brimfield, Deerfield, Franklin, Mantua, Randolph, Ravenna, Rootstown, Shalersville, Streetsboro & Suffield Townships), SUMMIT & WAYNE (Baughman, Canaan, Chester, Chippewa, Congress, Green, Milton, & Wayne Townships)

	Rates	Fringes
CABLE SPLICER.....	\$ 46.81	20.95
ELECTRICIAN.....	\$ 42.55	20.95

 ELEC0317-002 05/29/2023

GALLIA & LAWRENCE

	Rates	Fringes
CABLE SPLICER.....	\$ 32.68	18.13
ELECTRICIAN.....	\$ 37.15	28.48

 ELEC0540-005 01/01/2024

CARROLL (Northern half, including Fox, Harrison, Rose & Washington Townships), COLUMBIANA (Knox Township), HOLMES, MAHONING (Smith Township), STARK, TUSCARAWAS (North of Auburn, Clay, Rush & York Townships), and WAYNE (South of Baughman, Chester, Green & Wayne Townships) COUNTIES

	Rates	Fringes
ELECTRICIAN.....	\$ 36.96	28.18

 ELEC0573-003 05/27/2024

ASHTABULA (Colebrook, Wayne, Williamsfield, Orwell & Windsor Townships), GEAUGA (Auburn, Middlefield, Parkman & Troy Townships), MAHONING (Milton Township), PORTAGE (Charlestown, Edinburg, Freedom, Hiram, Nelson, Palmyra, Paris & Windham Townships), and TRUMBULL (Except Liberty & Hubbard Townships)

	Rates	Fringes
ELECTRICIAN.....	\$ 40.40	22.20

 ELEC0575-001 05/29/2023

ADAMS, FAYETTE, HIGHLAND, HOCKING, JACKSON (Bloomfield, Franklin, Hamilton, Jefferson, Lick, Madison, Scioto, Coal, Jackson, Liberty, Milton & Washington Townships), PICKAWAY (Deer Creek, Perry, Pickaway, Salt Creek & Wayne Townships), PIKE (Beaver, Benton, Jackson, Mifflin, Pebble, PeePee, Perry, Seal, Camp Creek, Newton, Scioto, Sunfish, Union & Marion Townships), ROSS, SCIOTO & VINTON (Clinton, Eagle, Elk, Harrison, Jackson, Richland & Swan Townships)

	Rates	Fringes
ELECTRICIAN.....	\$ 37.00	22.26

 ELEC0648-001 08/29/2023

BUTLER and WARREN COUNTIES (Deerfield, Hamilton, Harlan, Massie, Salem, Turtle Creek, Union & Washington Townships)

	Rates	Fringes
CABLE SPLICER.....	\$ 30.50	18.23
ELECTRICIAN.....	\$ 34.00	21.98

 ELEC0673-004 05/27/2024

ASHTABULA (Excluding Orwell, Colebrook, Williamsfield, Wayne & Windsor Townships), GEAUGA (Burton, Chardon, Claridon, Hambden, Huntsburg, Montville, Munson, Newbury & Thompson Townships) and LAKE COUNTIES

	Rates	Fringes
--	-------	---------

CABLE SPLICER.....	\$ 33.81	21.47
ELECTRICIAN.....	\$ 39.64	23.86

* ELEC0683-002 05/27/2024

CHAMPAIGN, CLARK, DELAWARE, FAIRFIELD, FRANKLIN, MADISON, PICKAWAY (Circleville, Darby, Harrison, Jackson, Madison, Monroe, Muhlenberg, Scioto, Walnut & Washington Townships), and UNION COUNTIES

	Rates	Fringes
CABLE SPLICER.....	\$ 41.50	24.19
ELECTRICIAN.....	\$ 40.50	25.20

ELEC0688-003 05/30/2022

ASHLAND, CRAWFORD, HURON (Richmond, New Haven, Ripley & Greenwich Townships), KNOX (Liberty, Clinton, Union, Howard, Monroe, Middleberry, Morris, Wayne, Berlin, Pike, Brown & Jefferson Townships), MARION, MORROW, RICHLAND and WYANDOT (Sycamore, Crane, Eden, Pitt, Antrim & Tymochtee Townships) COUNTIES

	Rates	Fringes
ELECTRICIAN.....	\$ 32.30	21.83

ELEC0972-002 06/01/2023

ATHENS, MEIGS, MONROE, MORGAN, NOBLE, VINTON (Brown, Knox, Madison, Vinton & Wilkesville Townships), and WASHINGTON COUNTIES

	Rates	Fringes
CABLE SPLICER.....	\$ 35.70	30.26
ELECTRICIAN.....	\$ 35.45	30.25

ELEC1105-001 05/29/2023

COSHOCTON, GUERNSEY, KNOX (Jackson, Clay, Morgan, Miller, Milford, Hilliar, Butler, Harrison, Pleasant & College Townships), LICKING, MUSKINGUM, PERRY, and TUSCARAWAS (Auburn, York, Clay, Jefferson, Rush, Oxford, Washington, Salem, Perry & Bucks Townships) COUNTIES

	Rates	Fringes
ELECTRICIAN.....	\$ 36.45	24.22

ENGI0018-003 05/01/2024

ASHTABULA, CUYAHOGA, ERIE, GEAUGA, LAKE, LORAIN, MEDINA, PORTAGE, and SUMMIT COUNTIES

	Rates	Fringes
POWER EQUIPMENT OPERATOR		
GROUP 1.....	\$ 45.63	16.41
GROUP 2.....	\$ 45.53	16.41
GROUP 3.....	\$ 44.49	16.41
GROUP 4.....	\$ 43.27	16.41
GROUP 5.....	\$ 37.98	16.41
GROUP 6.....	\$ 46.63	16.41
GROUP 7.....	\$ 46.63	16.41

OPERATING ENGINEER CLASSIFICATIONS

GROUP 1 - Air Compressor on Steel Erection; Barrier Moving Machine; Boiler Operator on Compressor or Generator when mounted on a Rig; Cableway; Combination Concrete Mixer & Tower; Concrete Plant (over 4 yd. Capacity); Concrete Pump; Crane (All Types, Including Boom Truck, Cherry Picker); Crane-Compact, Track or Rubber over 4,000 lbs. capacity; Cranes-Self Erecting, Stationary, Track or Truck (All Configurations); Derrick; Dragline; Dredge (Dipper, Clam or Suction); Elevating Grader or Euclid Loader; Floating Equipment (All Types); Gradall; Helicopter Crew (Operator-Hoist or Winch); Hoe (all types); Hoisting Engine on Shaft or Tunnel Work; Hydraulic Gantry (Lifting System); Industrial-Type Tractor; Jet Engine Dryer (D8 or D9) Diesel Tractor; Locomotive (Standard Gauge); Maintenance Operator Class A; Mixer, Paving (Single or Double Drum); Mucking Machine; Multiple Scraper; Piledriving Machine (All Types); Power Shovel; Prentice Loader; Quad 9 (Double Pusher); Rail Tamper (with auto lifting & aligning device); Refrigerating Machine (Freezer Operation); Rotary Drill, on Caisson work; Rough Terrain Fork Lift with Winch/Hoist; Side-Boom; Slip-Form Paver; Tower Derrick; Tree Shredder; Trench Machine (Over 24" wide); Truck Mounted Concrete Pump; Tug Boat; Tunnel Machine and/or Mining Machine; Wheel Excavator; and Asphalt Plant Engineer (Cleveland District Only).

GROUP 2 - Asphalt Paver; Automatic Subgrader Machine, Self-Propelled (CMI Type); Bobcat Type and/or Skid Steer Loader with Hoe Attachment Greater than 7,000 lbs.; Boring Machine More than 48"; Bulldozer; Endloader; Horizontal Directional Drill (Over 50,000 ft lbs thrust); Hydro

Milling Machine; Kolman-type Loader (production type-Dirt); Lead Greaseman; Lighting & Traffic Signal Installation Equipment (includes all groups or classifications); Material Transfer Equipment (Shuttle Buggy) Asphalt; Pettibone-Rail Equipment; Power Grader; Power Scraper; Push Cat; Rotomill (all), Grinders & Planers of All types; Trench Machine (24" wide & under); Vermeer type Concrete Saw; and Maintenance Operators (Portage and Summit Counties Only).

GROUP 3 - A-Frame; Air Compressor on Tunnel Work (low pressure); Asphalt Plant Engineer (Portage and Summit Counties Only); Bobcat-type and/or Skid Steer Loader with or without Attachments; Highway Drills (all types); Locomotive (narrow gauge); Material Hoist/Elevator; Mixer, Concrete (more than one bag capacity); Mixer, one bag capacity (Side Loader); Power Boiler (Over 15 lbs. Pressure) Pump Operator installing & operating Well Points; Pump (4" & over discharge); Roller, Asphalt; Rotovator (lime soil stabilizer); Switch & Tie Tampers (without lifting & aligning device); Utility Operator (Small equipment); Welding Machines; and Railroad Tie Inserter/Remover; Articulating/straight bed end dumps if assigned (minus \$4.00 per hour).

GROUP 4 - Backfiller; Ballast Re-locator; Bars, Joint & Mesh Installing Machine; Batch Plant; Boring Machine Operator (48" or less); Bull Floats; Burlap & Curing Machine; Concrete Plant (capacity 4 yd. & under); Concrete Saw (Multiple); Conveyor (Highway); Crusher; Deckhand; Farm-type Tractor with attachments (highway); Finishing Machine; Fireperson, Floating Equipment (all types); Forklift; Form Trencher; Hydro Hammer expect masonry; Hydro Seeder; Pavement Breaker; Plant Mixer; Post Driver; Post Hole Digger (Power Auger); Power Brush Burner; Power Form Handling Equipment; Road Widening Trencher; Roller (Brick, Grade & Macadam); Self-Propelled Power Spreader; Self-Propelled Power Subgrader; Steam Fireperson; Tractor (Pulling Sheepfoot, Roller or Grader); and Vibratory Compactor with Integral Power.

GROUP 5 - Compressor (Portable, Sewer, Heavy & Highway); Drum Fireperson (Asphalt Plant); Generator; Masonry Fork Lift; Inboard-Outboard Motor Boat Launch; Oil Heater (asphalt plant); Oiler/Helper; Power Driven Heater; Power Sweeper & Scrubber; Pump (under 4" discharge); Signalperson; Tire Repairperson; VAC/ALLS; Cranes - Compact, track or rubber under 4,000 pound capacity; fueling and greasing; and Chainmen.

GROUP 6 - Master Mechanic & Boom from 150 to 180.

GROUP 7 - Boom from 180 and over.

ENGI0018-004 05/01/2024

ADAMS, ALLEN, ASHLAND, ATHENS, AUGLAIZE, BELMONT, BROWN, BUTLER, CARROLL, CHAMPAIGN, CLARK, CLERMONT, CLINTON, COSHOCTON, CRAWFORD, DARKE, DEFIANCE, DELAWARE, FAIRFIELD, FAYETTE, FRANKLIN, FULTON, GALLIA, GREENE, GUERNSEY, HAMILTON, HANCOCK, HARDIN, HARRISON, HENRY, HIGHLAND, HOCKING, HOLMES, HURON, JACKSON, JEFFERSON, KNOX, LAWRENCE, LICKING, LOGAN, LUCAS, MADISON, MARION, MEIGS, MERCER, MIAMI, MONROE, MONTGOMERY, MORGAN, MORROW, MUSKINGUM, NOBLE, OTTAWA, PAULDING, PERRY, PICKAWAY, PIKE, PREBLE, PUTNAM, RICHLAND, ROSS, SANDUSKY, SCIOTO, SENECA, SHELBY, STARK, TUSCARAWAS, UNION, VAN WERT, VINTON, WARREN, WASHINGTON, WAYNE, WILLIAMS, WOOD, and YANDOT COUNTIES

	Rates	Fringes
POWER EQUIPMENT OPERATOR		
GROUP 1.....	\$ 44.14	16.41
GROUP 2.....	\$ 44.02	16.41
GROUP 3.....	\$ 42.98	16.41
GROUP 4.....	\$ 41.80	16.41
GROUP 5.....	\$ 36.34	16.41
GROUP 6.....	\$ 45.14	16.41
GROUP 7.....	\$ 45.14	16.41

OPERATING ENGINEER CLASSIFICATIONS

GROUP 1 - Air Compressor on Steel Erection; Barrier Moving Machine; Boiler Operator on Compressor or Generator when mounted on a Rig; Cableway; Combination Concrete Mixer & Tower; Concrete Plant (over 4 yd. Capacity); Concrete Pump; Crane (All Types, Including Boom Truck, Cherry Picker); Crane-Compact, Track or Rubber over 4,000 lbs. capacity; Cranes-Self Erecting, Stationary, Track or Truck (All Configurations); Derrick; Dragline; Dredge (Dipper, Clam or Suction); Elevating Grader or Euclid Loader; Floating Equipment (All Types); Gradall; Helicopter Crew (Operator-Hoist or Winch); Hoe (all types); Hoisting Engine on Shaft or Tunnel Work; Hydraulic Gantry (Lifting System); Industrial-Type Tractor; Jet Engine Dryer (D8 or D9) Diesel Tractor; Locomotive (Standard Gauge); Maintenance Operator Class A; Mixer, Paving (Single or Double Drum); Mucking Machine; Multiple Scraper; Piledriving Machine (All Types); Power Shovel; Prentice Loader; Quad 9 (Double Pusher); Rail Tamper (with auto lifting & aligning device); Refrigerating Machine (Freezer Operation); Rotary Drill, on Caisson work; Rough Terrain Fork Lift with Winch/Hoist; Side-Boom; Slip-Form Paver;

Tower Derrick; Tree Shredder; Trench Machine (Over 24" wide); Truck Mounted Concrete Pump; Tug Boat; Tunnel Machine and/or Mining Machine; and Wheel Excavator.

GROUP 2 - Asphalt Paver; Automatic Subgrader Machine, Self-Propelled (CMI Type); Bobcat Type and/or Skid Steer Loader with Hoe Attachment Greater than 7,000 lbs.; Boring Machine More than 48"; Bulldozer; Endloader; Hydro Milling Machine; Horizontal Directional Drill (over 50,000 ft. lbs. thrust); Kolman-type Loader (production type-Dirt); Lead Greaseman; Lighting & Traffic Signal Installation Equipment (includes all groups or classifications); Material Transfer Equipment (Shuttle Buggy) Asphalt; Pettibone-Rail Equipment; Power Grader; Power Scraper; Push Cat; Rotomill (all), Grinders & Planers of All types; Trench Machine (24" wide & under); and Vermeer type Concrete Saw.

GROUP 3 - A-Frame; Air Compressor on Tunnel Work (low pressure); Asphalt Plant Engineer; Bobcat-type and/or Skid Steer Loader with or without Attachments; Highway Drills (all types); Locomotive (narrow gauge); Material Hoist/Elevator; Mixer, Concrete (more than one bag capacity); Mixer, one bag capacity (Side Loader); Power Boiler (Over 15 lbs. Pressure) Pump Operator installing & operating Well Points; Pump (4" & over discharge); Railroad Tie Inserter/Remover; Roller, Asphalt; Rotovator (lime soil stabilizer); Switch & Tie Tampers (without lifting & aligning device); Utility Operator (Small equipment); and Welding Machines; Articulating/straight bed end dumps if assigned (minus \$4.00 per hour).

GROUP 4 - Backfiller; Ballast Re-locator; Bars, Joint & Mesh Installing Machine; Batch Plant; Boring Machine Operator (48" or less); Bull Floats; Burlap & Curing Machine; Concrete Plant (capacity 4 yd. & under); Concrete Saw (Multiple); Conveyor (Highway); Crusher; Deckhand; Farm-type Tractor with attachments (highway); Finishing Machine; Fireperson, Floating Equipment (all types); Fork Lift; Form Trencher; Hydro Hammer expect masonary; Hydro Seeder; Pavement Breaker; Plant Mixer; Post Driver; Post Hole Digger (Power Auger); Power Brush Burner; Power Form Handling Equipment; Road Widening Trencher; Roller (Brick, Grade & Macadam); Self-Propelled Power Spreader; Self-Propelled Power Subgrader; Steam Fireperson; Tractor (Pulling Sheepfoot, Roller or Grader); and Vibratory Compactor with Integral Power.

GROUP 5 - Compressor (Portable, Sewer, Heavy & Highway); Drum Fireperson (Asphalt Plant); Generator; Masonary Forklift; Inboard-Outboard Motor Boat Launch; Oil Heater (asphalt plant); Oiler/Helper; Power Driven Heater; Power Sweeper & Scrubber; Pump (under 4" discharge); Signalperson; Tire Repairperson; VAC/ALLS; Cranes - Compact, track or rubber under 4,000 pound capacity; fueling and greasing; and Chainmen.

GROUP 6 - Master Mechanic & Boom from 150 to 180.

GROUP 7 - Boom from 180 and over.

ENGI0066-023 06/01/2023

COLUMBIANA, MAHONING & TRUMBULL COUNTIES

	Rates	Fringes
POWER EQUIPMENT OPERATOR		
ASBESTOS; HAZARDOUS/TOXIC WASTE PROJECTS		
GROUP 1 - A & B.....	\$ 44.63	24.30
ASBESTOS; HAZARDOUS/TOXIC WASTE PROJECTS		
GROUP 2 - A & B.....	\$ 44.30	24.30
ASBESTOS; HAZARDOUS/TOXIC WASTE PROJECTS		
GROUP 3 - A & B.....	\$ 38.47	24.30
ASBESTOS; HAZARDOUS/TOXIC WASTE PROJECTS		
GROUP 4 - A & B.....	\$ 34.52	24.30
ASBESTOS; HAZARDOUS/TOXIC WASTE PROJECTS		
GROUP 5 - A & B.....	\$ 31.13	24.30
HAZARDOUS/TOXIC WASTE PROJECTS		
GROUP 1 - C & D.....	\$ 40.91	24.30
HAZARDOUS/TOXIC WASTE PROJECTS		
GROUP 2 - C & D.....	\$ 40.61	24.30
HAZARDOUS/TOXIC WASTE PROJECTS		
GROUP 3 - C & D.....	\$ 35.27	24.30
HAZARDOUS/TOXIC WASTE PROJECTS		
GROUP 4 - C & D.....	\$ 31.65	24.30
HAZARDOUS/TOXIC WASTE PROJECTS		
GROUP 5 - C & D.....	\$ 28.53	24.30
ALL OTHER WORK		
GROUP 1.....	\$ 37.19	24.30
ALL OTHER WORK		
GROUP 2.....	\$ 36.92	24.30
ALL OTHER WORK		
GROUP 3.....	\$ 32.06	24.30
ALL OTHER WORK		

GROUP 4.....	\$ 28.77	24.30
ALL OTHER WORK		
GROUP 5.....	\$ 25.94	24.30

GROUP 1 - Rig, Pile Driver or Caisson Type; & Rig, Pile Hydraulic Unit Attached

GROUP 2 - Asphalt Heater Planer; Backfiller with Drag Attachment; Backhoe; Backhoe with Shear attached; Backhoe-Rear Pivotal Swing; Batch Plant-Central Mix Concrete; Batch Plant, Portable concrete; Berm Builder-Automatic; Boat Derrick; Boat-Tug; Boring Machine Attached to Tractor; Bullclam; Bulldozer; C.M.I. Road Builder & Similar Type; Cable Placer & Layer; Carrier-Straddle; Carryall-Scraper or Scoop; Chicago Boom; Compactor with Blade Attached; Concrete Saw (Vermeer or similar type); Concrete Spreader Finisher; Combination, Bidwell Machine; Crane; Crane-Electric Overhead; Crane-Rough Terrain; Crane-Side Boom; Crane-Truck; Crane-Tower; Derrick-Boom; Derrick-Car; Digger-Wheel (Not trencher or road widener); Double Nine; Drag Line; Dredge; Drill-Kenny or Similar Type; Easy Pour Median Barrier Machine (or similar type); Electromatic; Frankie Pile; Gradall; Grader; Gurry; Self-Propelled; Heavy Equipment Robotics Operator/Mechanic; Hoist-Monorail; Hoist-Stationary & Mobile Tractor; Hoist, 2 or 3 drum; Horizontal Directional Drill Operator; Jackall; Jumbo Machine; Kocal & Kuhlman; Land-Seagoing Vehicle; Loader, Elevating; Loader, Front End; Loader, Skid Steer; Locomotive; Mechanic/Welder; Metro Chip Harvester with Boom; Mucking Machine; Paver-Asphalt Finishing Machine; Paver-Road Concrete; Paver-Slip Form (C.M.I. or similar); Place Crete Machine with Boom; Post Driver (Carrier mounted); Power Driven Hydraulic Pump & Jack (When used in Slip Form or Lift Slab Construction); Pump Crete Machine; Regulator-Ballast; Hydraulic Power Unit not attached to Rig for Pile Drillings; Rigs-Drilling; Roto Mill or similar Full Lane (8' Wide & Over); Roto Mill or similar type (Under 8'); Shovel; Slip Form Curb Machine; Speedwing; Spikemaster; Stonecrusher; Tie Puller & Loader; Tie Tamper; Tractor-Double Boom; Tractor with Attachments; Truck-Boom; Truck-Tire; Trench Machine; Tunnel Machine (Mark 21 Java or similar); & Whirley (or similar type)

GROUP 3 - Asphalt Plant; Bending Machine (Pipeline or similar type); Boring machine, Motor Driven; Chip Harvester without Boom; Cleaning Machine, Pipeline Type; Coating Machine, Pipeline Type; Compactor; Concrete Belt Placer; Concrete Finisher; Concrete Planer or Asphalt; Concrete Spreader; Elevator; Fork Lift (Home building only); Fork lift & Lulls; Fork Lift Walk Behind (Hoisting over 1 buck high); Form Line Machine; Grease Truck operator; Grout Pump; Gunnite Machine; Horizontal Directional Drill Locator; Single Drum Hoist with or without Tower; Huck Bolting Machine; Hydraulic Scaffold (Hoisting building materials); Paving Breaker (Self-propelled or Ridden); Pipe Dream; Pot Fireperson (Power Agitated); Refrigeration Plant; Road Widener; Roller; Sasgen Derrick; Seeding Machine; Soil Stabilizer (Pump type); Spray Cure Machine, Self-Propelled; Straw Blower Machine; Sub-Grader; Tube Finisher or Broom C.M.I. or similar type; & Tugger Hoist

GROUP 4 - Air Curtain Destructor & Similar Type; Batch Plant-Job Related; Boiler Operator; Compressor; Conveyor; Curb Builder, self-propelled; Drill Wagon; Generator Set; Generator-Steam; Heater-Portable Power; Hydraulic Manipulator Crane; Jack-Hydraulic Power driven; Jack-Hydraulic (Railroad); Ladavator; Minor Machine Operator; Mixer-Concrete; Mulching Machine; Pin Puller; Power Broom; Pulverizer; Pump; Road Finishing Machine (Pull Type); Saw-Concrete-Self-Propelled (Highway Work); Signal Person; Spray Cure Machine-Motor Powered; Stump Cutter; Tractor; Trencher Form; Water Blaster; Steam Jenny; Syphon; Vibrator-Gasoline; & Welding Machine

GROUP 5 - Brakeperson; Fireperson; & Oiler

IRON0017-002 05/01/2024

ASHTABULA (North of Route 6, starting at the Geauga County Line, proceeding east to State Route 45), CUYAHOGA, ERIE (Eastern 2/3), GEAUGA, HURON (East of a line drawn from the north border through Monroeville & Willard), LAKE, LORAIN, MEDINA (North of Old Rte. #224), PORTAGE (West of a line from Middlefield to Shalersville to Deerfield), and SUMMIT (North of Old Rte. #224, including city limits of Barberton) COUNTIES

Rates Fringes

IRONWORKER		
Ornamental, Reinforcing, & Structural.....	\$ 36.83	29.01

IRON0017-010 05/01/2024

ASHTABULA (Eastern part from Lake Erie on the north to route #322 on the south to include Conneaut, Kingsville, Sheffield, Denmark, Dorset, Cherry Valley, Wayne, Monroe, Pierpont, Richmond, Andover & Williamsfield Townships)

Rates Fringes

IRONWORKER

Structural, including metal building erection & Reinforcing.....	\$ 36.83	29.01
--	----------	-------

IRON0044-001 06/01/2022

ADAMS (Western Part), BROWN, BUTLER (Southern Part), CLERMONT, CLINTON (South of a line drawn from Blanchester to Lynchburg), HAMILTON, HIGHLAND (Excluding eastern one-fifth & portion of county inside lines drawn from Marshall to Lynchburg from the northern county line through E. Monroe to Marshall) and WARREN (South of a line drawn from Blanchester through Morrow to the west county line) COUNTIES

Rates Fringes

IRONWORKER, REINFORCING.....	\$ 32.37	22.30
Beyond 30-mile radius of Hamilton County Courthouse..	\$ 28.67	21.20
Up to & including 30-mile radius of Hamilton County Courthouse.....	\$ 27.60	20.70

IRON0044-002 06/01/2024

CLINTON (South of a line drawn from Blanchester to Lynchburg), HAMILTON, HIGHLAND (Excluding eastern one-fifth & portion of county inside lines drawn from Marshall to Lynchburg from the northern county line through E. Monroe to Marshall) & WARREN (South of a line drawn from Blanchester through Morrow to the west county line)

Rates Fringes

IRONWORKER		
Fence Erector.....	\$ 33.60	23.00
Ornamental; Structural.....	\$ 35.37	23.00

IRON0055-003 07/01/2024

CRAWFORD (Area Between lines drawn from where Hwy #598 & #30 meet through N. Liberty to the northern border & from said Hwy junction point due west to the border), DEFIANCE (S. of a line drawn from where Rte. #66 meets the northern line through Independence to the eastern county border), ERIE (Western 1/3), FULTON, HANCOCK, HARDIN (North of a line drawn from Maysville to a point 4 miles south of the northern line on the eastern line), HENRY, HURON (West of a line drawn from the northern border through Monroeville & Willard), LUCAS, OTTAWA, PUTNAM (East of a line drawn from the northern border down through Miller City to where #696 meets the southern border), SANDUSKY, SENECA, WILLIAMS (East of a line drawn from Pioneer through Stryker to the southern border), WOOD & WYANDOT (North of Rte. #30)

Rates Fringes

IRONWORKER		
Fence Erector.....	\$ 26.40	24.62
Flat Road Mesh.....	\$ 29.77	21.30
Tunnels & Caissons Under Pressure.....	\$ 29.77	21.30
All Other Work.....	\$ 35.50	29.20

IRON0147-002 06/01/2024

ALLEN (Northern half), DEFIANCE (Northern part, excluding south of a line drawn from where Rte. #66 meets the northern line through Independence to the eastern county border), MERCER (Northern half), PAULDING, PUTNAM (Western part, excluding east of a line drawn from the northern border down through Miller City to where #696 meets the southern border), VAN WERT, and WILLIAMS (Western part, excluding east of a line drawn from Pioneer through Stryker to the southern border) COUNTIES

Rates Fringes

IRONWORKER.....	\$ 34.20	26.39
-----------------	----------	-------

IRON0172-002 06/01/2024

CHAMPAIGN (Eastern one-third), CLARK (Eastern one-fourth), COSHOCTON (West of a line beginning at the northwestern county line going through Walhonding & Tunnel Hill to the southern county line), CRAWFORD (South of Rte. #30), DELAWARE, FAIRFIELD, FAYETTE, FRANKLIN, HARDIN (Excluding a line drawn from Roundhead to Maysville), HIGHLAND (Eastern one-fifth), HOCKING, JACKSON (Northern half), KNOX, LICKING, LOGAN (Eastern one-third), MADISON, MARION, MORROW, MUSKINGUM (West of a line starting at Adams Mill going to Adamsville & going from Adamsville through Blue Rock to the southern border), PERRY, PICKAWAY, PIKE (Northern half), ROSS, UNION, VINTON and WYANDOT (South of Rte. #30) COUNTIES

Rates Fringes

IRONWORKER.....	\$ 36.77	22.85
-----------------	----------	-------

IRON0207-004 06/01/2024

ASHTABULA (Southern part starting at the Geauga County line), COLUMBIANA (E. of a line from Damascus to Highlandtown), MAHONING (N. of Old Route #224), PORTAGE (E. of a line from Middlefield to Shalersville to Deerfield) & TRUMBULL

	Rates	Fringes
IRONWORKER		
Layout; Sheeter.....	\$ 35.83	27.41
Ornamental; Reinforcing;		
Structural.....	\$ 34.83	27.41
Ornamental; Reinforcing.....	\$ 28.92	25.61

IRON0290-002 06/01/2024

ALLEN (Southern half), AUGLAIZE, BUTLER (North of a line drawn from east to the west county line going through Oxford, Darrown & Woodsdale), CHAMPAIGN (Excluding east of a line drawn from Catawla to the point where #68 intersects the northern county line), CLARK (Western two-thirds), CLINTON (Excluding south of a line drawn from Blanchester to Lynchburg), DARKE, GREENE, HIGHLAND (Inside lines drawn from Marshall to Lynchburg & from the northern county line through East Monroe to Marshall), LOGAN (West of a line drawn from West Liberty to where the northern county line meets the western county line of Hardin), MERCER (Southern half), MIAMI, MONTGOMERY, PREBLE, SHELBY & WARREN (Excluding south of a line drawn from Blanchester through Morrow to the western county line) COUNTIES

	Rates	Fringes
IRONWORKER.....	\$ 35.39	24.35

IRON0549-003 12/01/2022

BELMONT, GUERNSEY, HARRISON, JEFFERSON, MONROE & MUSKINGUM (Excluding portion west of a line starting at Adams Mill going to Adamsville and going from Adamsville through Blue Rock to the south border)

	Rates	Fringes
IRONWORKER.....	\$ 35.19	25.66

IRON0550-004 05/01/2024

ASHLAND, CARROLL, COLUMBIANA (W. of a line from Damascus to Highlandtown), COSHOCTON (E. of a line beginning at NW Co. line going through Walhonding & Tunnel Hill to the South Co. line), HOLMES, HURON (S. of Old Rte. #224), MAHONING (S. of Old Rte. #224), MEDINA (S. of Old Rte. #224), PORTAGE (S. of Old Rte. #224), RICHLAND, STARK, SUMMIT (S. of Old Rte. #224, Excluding city limits of Barberton), TUSCARAWAS, & WAYNE

	Rates	Fringes
Ironworkers:Structural, Ornamental and Reinforcing.....	\$ 34.70	22.88

IRON0769-004 06/01/2024

ADAMS (Eastern Half), GALLIA, JACKSON (Southern Half), LAWRENCE & SCIOTO

	Rates	Fringes
IRONWORKER.....	\$ 37.66	29.24

IRON0787-003 06/01/2024

ATHENS, MEIGS, MORGAN, NOBLE, and WASHINGTON COUNTIES

	Rates	Fringes
IRONWORKER.....	\$ 33.00	24.25

LABO0265-008 05/01/2024

	Rates	Fringes
LABORER		
ASHTABULA, ERIE, HURON, LORAIN, LUCAS, MAHONING, MEDINA, OTTAWA, PORTAGE, SANDUSKY, STARK, SUMMIT, TRUMBULL & WOOD COUNTIES		
GROUP 1.....	\$ 35.05	13.70
GROUP 2.....	\$ 35.22	13.70
GROUP 3.....	\$ 35.55	13.70
GROUP 4.....	\$ 36.00	13.70
CUYAHOGA AND GEAUGA COUNTIES ONLY: SEWAGE PLANTS, WASTE PLANTS, WATER TREATMENT FACILITIES, PUMPING STATIONS, & ETHANOL PLANTS CONSTRUCTION.....	\$ 37.66	13.70
CUYAHOGA, GEAUGA & LAKE		

COUNTIES		
GROUP 1.....	\$ 36.28	13.70
GROUP 2.....	\$ 36.45	13.70
GROUP 3.....	\$ 36.78	13.70
GROUP 4.....	\$ 37.23	13.70
REMAINING COUNTIES OF OHIO		
GROUP 1.....	\$ 35.52	14.45
GROUP 2.....	\$ 35.69	14.45
GROUP 3.....	\$ 36.02	14.45
GROUP 4.....	\$ 36.47	14.45

LABORER CLASSIFICATIONS

GROUP 1 - Asphalt Laborer; Carpenter Tender; Concrete Curing Applicator; Dump Man (Batch Truck); Guardrail and Fence Installer; Joint Setter; Laborer (Construction); Landscape Laborer; Mesh Handlers & Placer; Right-of-way Laborer; Riprap Laborer & Grouter; Scaffold Erector; Seal Coating; Surface Treatment or Road Mix Laborer; Sign Installer; Slurry Seal; Utility Man; Bridge Man; Handyman; Waterproofing Laborer; Flagperson; Hazardous Waste (level D); Diver Tender; Zone Person & Traffic Control

GROUP 2 - Asphalt Raker; Concrete Puddler; Kettle Man Pipeline); Machine Driven Tools (Gas, Electric, Air); Mason Tender; Brick Paver; Mortar Mixer; Power Buggy or Power Wheelbarrow; Paint Striper; Sheeting & Shoring Man; Surface Grinder Man; Plastic Fusing Machine Operator; Pug Mill Operator; & Vacuum Devices (wet or dry); Rodding Machine Operator; Diver; Screwman or Paver; Screed Person; Water Blast, Hand Held Wand; Pumps 4" & Under (Gas, Air or Electric) & Hazardous Waste (level C); Air Track and Wagon Drill; Bottom Person; Cofferdam (below 25 ft. deep); Concrete Saw Person; Cutting with Burning Torch; Form Setter; Hand Spiker (Railroad); Pipelayer; Tunnel Laborer (without air) & Caisson; Underground Person (working in Sewer and Waterline, Cleaning, Repairing & Reconditioning); Sandblaster Nozzle Person; & Hazardous Waste (level B)

GROUP 3 - Blaster; Mucker; Powder Person; Top Lander; Wrencher (Mechanical Joints & Utility Pipeline); Yarner; Hazardous Waste (level A); Concrete Specialist; Concrete Crew in Tunnels (With Air-pressurized - \$1.00 premium); Curb Setter & Cutter; Grade Checker; Utility Pipeline Tapper; Waterline; and Caulker

GROUP 4 - Miner (With Air-pressurized - \$1.00 premium); & Gunite Nozzle Person

TUNNEL LABORER WITH AIR-PRESSURIZED ADD \$1.00 TO BASE RATE

SIGNAL PERSON WILL RECEIVE THE RATE EQUAL TO THE RATE PAID THE LABORER CLASSIFICATION FOR WHICH HE OR SHE IS SIGNALING.

PAIN006-002 05/01/2023

ASHTABULA, CUYAHOGA, GEAUGA, LAKE, LORAIN, PORTAGE (N. of the East-West Turnpike) & SUMMIT (N. of the East-West Turnpike)

Rates	Fringes
-------	---------

PAINTER

COMMERCIAL NEW WORK; REMODELING; & RENOVATIONS		
GROUP 1.....	\$ 30.75	18.95
GROUP 2.....	\$ 31.15	18.95
GROUP 3.....	\$ 31.45	18.95
GROUP 4.....	\$ 37.01	18.95
COMMERCIAL REPAINT		
GROUP 1.....	\$ 29.25	18.95
GROUP 2.....	\$ 29.65	18.95
GROUP 3.....	\$ 29.95	18.95

PAINTER CLASSIFICATIONS - COMMERCIAL NEW WORK; REMODELING; & RENOVATIONS

GROUP 1 - Brush; & Roller

GROUP 2 - Sandblasting & Buffing

GROUP 3 - Spray Painting; Closed Steel Above 55 feet; Bridges & Open Structural Steel; Tanks - Water Towers; Bridge Painters; Bridge Riggers; Containment Builders

GROUP 4 - Bridge Blaster

PAINTER CLASSIFICATIONS - COMMERCIAL REPAINT

GROUP 1 - Brush; & Roller

GROUP 2 - Sandblasting & Buffing

GROUP 3 - Spray Painting

PAIN007-002 07/01/2024

FULTON, HENRY, LUCAS, OTTAWA (Excluding Allen, Bay, Bono, Catawba Island, Clay Center, Curtice, Danbury, Eagle Beach, Elliston, Elmore, Erie, Fishback, Gem Beach & Genova) & WOOD

Rates	Fringes
-------	---------

PAINTER

NEW COMMERCIAL WORK

GROUP 1.....	\$ 31.84	20.79
GROUP 2.....	\$ 32.84	20.79
GROUP 3.....	\$ 32.84	20.79
GROUP 4.....	\$ 32.84	20.79
GROUP 5.....	\$ 32.84	20.79
GROUP 6.....	\$ 32.84	20.79
GROUP 7.....	\$ 32.84	20.79
GROUP 8.....	\$ 32.84	20.79
GROUP 9.....	\$ 32.84	20.79

REPAINT IS 90% OF JR

PAINTER CLASSIFICATIONS

GROUP 1 - Brush; Spray & Sandblasting Pot Tender

GROUP 2 - Refineries & Refinery Tanks; Surfaces 30 ft. or over where material is applied to or labor performed on above ground level (exterior), floor level (interior)

GROUP 3 - Swing Stage & Chair

GROUP 4 - Lead Abatement

GROUP 5 - All Methods of Spray

GROUP 6 - Solvent-Based Catalized Epoxy Materials of 2 or More Component Materials, to include Solvent-Based Conversion Varnish (excluding water based)

GROUP 7 - Spray Solvent Based Material; Sand & Abrasive Blasting

GROUP 8 - Towers; Tanks; Bridges; Stacks Over 30 Feet

GROUP 9 - Epoxy Spray (excluding water based)

PAIN0012-008 05/01/2019

BUTLER COUNTY

Rates Fringes

PAINTER

GROUP 1.....	\$ 21.95	10.20
GROUP 2.....	\$ 25.30	10.20
GROUP 3.....	\$ 25.80	10.20
GROUP 4.....	\$ 26.05	10.20
GROUP 5.....	\$ 26.30	10.20

PAINTER CLASSIFICATIONS

GROUP 1: Bridge Equipment Tender; Bridge/Containment Builder

GROUP 2: Brush & Roller

GROUP 3: Spray

GROUP 4: Sandblasting; & Waterblasting

GROUP 5: Elevated Tanks; Steeplejack Work; Bridge; & Lead Abatement

PAIN0012-010 05/01/2019

BROWN, CLERMONT, CLINTON, HAMILTON & WARREN

Rates Fringes

PAINTER

HEAVY & HIGHWAY BRIDGES-
GUARDRAILS-LIGHTPOLES-
STRIPING

Bridge Equipment Tender and Containment Builder....	\$ 21.95	10.20
Bridges when highest point of clearance is 60 feet or more; & Lead Abatement Projects.....	\$ 26.30	10.20
Brush & Roller.....	\$ 25.30	10.20
Sandblasting & Hopper Tender; Water Blasting....	\$ 26.05	10.20
Spray.....	\$ 25.80	10.20

PAIN0093-001 12/01/2023

ATHENS, GUERNSEY, HOCKING, MONROE, MORGAN, NOBLE and WASHINGTON COUNTIES

Rates Fringes

PAINTER

Bridges; Locks; Dams; Tension Towers; & Energized Substations.....	\$ 35.45	23.69
Power Generating Facilities.	\$ 32.30	23.69

PAIN0249-002 05/01/2024

CLARK, DARKE, GREENE, MIAMI, MONTGOMERY & PREBLE

	Rates	Fringes
PAINTER		
GROUP 1 - Brush & Roller....	\$ 27.15	13.64
GROUP 2 - Swing, Scaffold Bridges; Structural Steel; Open Acid Tank; High Tension Electrical Equipment; & Hot Pipes.....	\$ 27.15	13.64
GROUP 3 - Spray; Sandblast; Steamclean; Lead Abatement.....	\$ 27.90	13.64
GROUP 4 - Steeplejack Work..	\$ 28.10	13.64
GROUP 5 - Coal Tar.....	\$ 28.65	13.64
GROUP 6 - Bridge Equipment Tender & or Containment Builder.....	\$ 35.86	13.64
GROUP 7 - Tanks, Stacks & Towers.....	\$ 31.09	13.64
GROUP 8 - Bridge Blaster, Rigger.....	\$ 38.86	13.64

PAIN0356-002 09/01/2009

KNOX, LICKING, MUSKINGUM, and PERRY

	Rates	Fringes
PAINTER		
Bridge Equipment Tenders and Containment Builders....	\$ 27.93	7.25
Bridges; Blasters; and Riggers.....	\$ 34.60	7.25
Brush and Roller.....	\$ 20.93	7.25
Sandblasting; Steam Cleaning; Waterblasting; and Hazardous Work.....	\$ 25.82	7.25
Spray.....	\$ 21.40	7.25
Structural Steel and Swing Stage.....	\$ 25.42	7.25
Tanks; Stacks; and Towers..	\$ 28.63	7.25

PAIN0438-002 12/01/2023

BELMONT, HARRISON and JEFFERSON COUNTIES

	Rates	Fringes
PAINTER		
Bridges, Locks, Dams, Tension Towers & Energized Substations.....	\$ 36.09	19.49
Power Generating Facilities.	\$ 32.94	19.49

PAIN0476-001 06/01/2024

COLUMBIANA, MAHONING, and TRUMBULL COUNTIES

	Rates	Fringes
PAINTER		
GROUP 1.....	\$ 28.39	17.14
GROUP 2.....	\$ 35.02	17.14
GROUP 3.....	\$ 28.60	17.14
GROUP 4.....	\$ 28.89	17.14
GROUP 5.....	\$ 29.04	17.14
GROUP 6.....	\$ 29.29	17.14
GROUP 7.....	\$ 30.39	17.14

PAINTER CLASSIFICATIONS:

GROUP 1: Painters, Brush & Roller

GROUP 2: Bridges

GROUP 3: Structural Steel

GROUP 4: Spray, Except Bar Joist/Deck

GROUP 5: Epoxy/Mastic; Spray- Bar Joist/Deck; Working Above
50 Feet; and Swingstages

GROUP 6: Tanks; Sandblasting

GROUP 7: Towers; Stacks

PAIN0555-002 11/01/2023

ADAMS, HIGHLAND, JACKSON, PIKE & SCIOTO

	Rates	Fringes
PAINTER		
GROUP 1.....	\$ 32.18	20.29
GROUP 2.....	\$ 33.81	20.29
GROUP 3.....	\$ 35.44	20.29
GROUP 4.....	\$ 38.63	20.29

PAINTER CLASSIFICATIONS

GROUP 1 - Containment Builder

GROUP 2 - Brush; Roller; Power Tools, Under 40 feet

GROUP 3 - Sand Blasting; Spray; Steam Cleaning; Pressure Washing; Epoxy & Two Component Materials; Lead Abatement; Hazardous Waste; Toxic Materials; Bulk & Storage Tanks of 25,000 Gallon Capacity or More; Elevated Tanks

GROUP 4 - Stacks; Bridges

PAIN0639-001 05/01/2011

	Rates	Fringes
Sign Painter & Erector.....	\$ 20.61	3.50+a+b+c

FOOTNOTES: a. 7 Paid Holidays: New Year's Day; Memorial Day; July 4th; Labor Day; Thanksgiving Day; Christmas Day & 1 Floating Day
 b. Vacation Pay: After 1 year's service - 5 days' paid vacation; After 2, but less than 10 years' service - 10 days' paid vacation; After 10, but less than 20 years' service - 15 days' paid vacation; After 20 years' service - 20 days' paid vacation
 c. Funeral leave up to 3 days maximum paid leave for death of mother, father, brother, sister, spouse, child, mother-in-law, father-in-law, grandparent and inlaw provided employee attends funeral

PAIN0788-002 06/01/2024

ASHLAND, CRAWFORD, ERIE, HANCOCK, HURON, MARION, MORROW, OTTAWA (Allen, Bay, Bono, Catawba Island, Clay Center, Curtice, Danbury, Eagle Beach, Elliston, Elmore, Erie, Fishback, Gem Beach & Genoa), RICHLAND, SANDUSKY, SENECA & WYANDOT

	Rates	Fringes
PAINTER		
Brush & Roller.....	\$ 29.13	17.52
Structural Steel.....	\$ 30.73	17.52

WINTER REPAINT: Between December 1 to March 31 - 90%JR

\$.50 PER HOUR SHALL BE ADDED TO THE RATE OF PAY FOR THE CLASSIFICATION OF WORK:

While working swingstage, boatswain chair, needle beam and horizontal cable. While operating sprayguns, sandblasting, cobblasting and high pressure waterblasting (4000psi).

\$1.00 PER HOUR SHALL BE ADDED TO THE RATE OF PAY FOR THE CLASSIFICATION OF WORK:

For the application of catalized epoxy, including latex epoxy that is deemed hazardous, lead abatement, or for work or material where special precautions beyond normal work duties must be taken. For working on stacks, tanks, and towers over 40 feet in height.

PAIN0813-005 12/01/2008

GALLIA, LAWRENCE, MEIGS & VINTON

	Rates	Fringes
PAINTER		
Base Rate.....	\$ 24.83	10.00
Bridges, Locks, Dams & Tension Towers.....	\$ 27.83	10.00

PAIN0841-001 06/01/2023

MEDINA, PORTAGE (South of and including Ohio Turnpike), and SUMMIT (South of and including Ohio Turnpike) COUNTIES

	Rates	Fringes
Painters:		
GROUP 1.....	\$ 30.18	15.50
GROUP 2.....	\$ 30.83	15.50
GROUP 3.....	\$ 30.93	15.50
GROUP 4.....	\$ 31.03	15.50
GROUP 5.....	\$ 31.43	15.50
GROUP 6.....	\$ 39.20	11.75
GROUP 7.....	\$ 31.68	15.50

PAINTER CLASSIFICATIONS:

GROUP 1 - Brush, Roller & Paperhanger

GROUP 2 - Epoxy Application

GROUP 3 - Swing Scaffold, Bosum Chair, & Window Jack

GROUP 4 - Spray Gun Operator of Any & All Coatings

GROUP 5 - Sandblast, Painting of Standpipes, etc. from Scaffolds, Bridge Work and/or Open Structural Steel, Standpipes and/or Water Towers

GROUP 6 - Public & Commerce Transportation, Steel or Galvanized, Bridges, Tunnels & Related Support Items (concrete)

GROUP 7 - Synthetic Exterior, Drywall Finisher and/or Taper, Drywall Finisher and Follow-up Man Using Automatic Tools

PAIN0841-002 06/01/2023

CARROLL, COSHOCTON, HOLMES, STARK, TUSCARAWAS & WAYNE

Rates Fringes

PAINTER

Bridges; Towers, Poles & Stacks; Sandblasting Steel; Structural Steel & Metalizing.....	\$ 31.43	15.50
Brush & Roller.....	\$ 30.18	15.50
Spray; Tank Interior & Exterior.....	\$ 31.03	15.50

PAIN1020-002 07/01/2024

ALLEN, AUGLAIZE, CHAMPAIGN, DEFIANCE, HARDIN, LOGAN, MERCER, PAULDING, PUTNAM, SHELBY, VAN WERT, and WILLIAMS COUNTIES

Rates Fringes

PAINTER

Brush & Roller.....	\$ 26.54	17.66
Drywall Finishing & Taping..	\$ 27.29	17.66
Lead Abatement.....	\$ 28.29	17.66
Spray, Sandblasting Pressure Cleaning, & Refinery.....	\$ 27.29	17.66
Swing Stage, Chair, Spiders, & Cherry Pickers...	\$ 26.79	17.66
Wallcoverings.....	\$ 27.29	17.66

All surfaces 40 ft. or over where material is applied to or labor performed on, above ground level (exterior), floor level (interior) - \$.50 premium

Applying Coal Tar Products - \$1.00 premium

PAIN1275-002 05/01/2024

DELAWARE, FAIRFIELD, FAYETTE, FRANKLIN, MADISON, PICKAWAY, ROSS & UNION

Rates Fringes

PAINTER

Bridges.....	\$ 36.26	14.91
Brush; Roller.....	\$ 30.65	14.91
Sandblasting; Steamcleaning; Waterblasting (3500 PSI or Over)& Hazardous Work.....	\$ 31.35	14.91
Spray.....	\$ 31.15	14.91
Stacks; Tanks; & Towers.....	\$ 33.46	14.91
Structural Steel & Swing Stage.....	\$ 29.50	14.91

PLAS0109-001 06/01/2024

MEDINA, PORTAGE, STARK, and SUMMIT COUNTIES

Rates Fringes

PLASTERER.....	\$ 31.70	23.63
----------------	----------	-------

PLAS0109-003 06/01/2024

CARROLL, HOLMES, TUSCARAWAS, and WAYNE COUNTIES

Rates Fringes

PLASTERER.....	\$ 31.70	23.63
----------------	----------	-------

PLAS0132-002 07/01/2024

BROWN, BUTLER, CLERMONT, HAMILTON, HIGHLAND, WARREN COUNTIES

Rates Fringes

PLASTERER.....	\$ 30.40	16.54
----------------	----------	-------

PLAS0404-002 05/01/2018

ASHTABULA, CUYAHOGA, GEAUGA, AND LAKE COUNTIES

Rates Fringes

PLASTERER.....	\$ 29.63	17.11
----------------	----------	-------

PLAS0404-003 05/01/2018

LORAIN COUNTY

	Rates	Fringes
PLASTERER.....	\$ 28.86	17.11

PLAS0526-022 05/01/2018		
COLUMBIANA, MAHONING, and TRUMBULL COUNTIES		
	Rates	Fringes
PLASTERER.....	\$ 28.86	17.11

PLAS0526-023 05/01/2018		
BELMONT, HARRISON, and JEFFERSON COUNTIES		
	Rates	Fringes
PLASTERER.....	\$ 28.21	17.11

PLAS0886-001 07/01/2024		
FULTON, HANCOCK, HENRY, LUCAS, PUTNAM, and WOOD COUNTIES		
	Rates	Fringes
PLASTERER.....	\$ 33.73	23.25

PLAS0886-003 07/01/2024		
	Rates	Fringes
PLASTERER.....	\$ 33.73	23.25

PLAS0886-004 07/01/2024		
	Rates	Fringes
PLASTERER.....	\$ 33.73	23.25

PLUM0042-002 07/01/2024		
ASHLAND, CRAWFORD, ERIE, HURON, KNOX, LORAIN, MORROW, RICHLAND & WYANDOT		
	Rates	Fringes
Plumber, Pipefitter, Steamfitter.....	\$ 40.62	25.67

PLUM0050-002 07/01/2024		
DEFIANCE, FULTON, HANCOCK, HENRY, LUCAS, OTTAWA, PAULDING, PUTNAM, SANDUSKY, SENECA, WILLIAMS & WOOD		
	Rates	Fringes
Plumber, Pipefitter, Steamfitter.....	\$ 49.70	30.76

PLUM0055-003 05/01/2024		
ASHTABULA, CUYAHOGA, GEAUGA, LAKE, MEDINA (N. of Rte. #18 & Smith Road) & SUMMIT (N. of Rte. #303, including the corporate limits of the city of Hudson)		
	Rates	Fringes
PLUMBER.....	\$ 42.36	29.90

PLUM0083-001 07/01/2023		
BELMONT & MONROE (North of Rte. #78)		
	Rates	Fringes
Plumber and Steamfitter.....	\$ 35.94	37.35

* PLUM0094-002 05/01/2024		
CARROLL (Northern Half), STARK, and WAYNE COUNTIES		
	Rates	Fringes
PLUMBER/PIPEFITTER.....	\$ 45.23	24.89

PLUM0120-002 04/29/2024		
ASHTABULA, CUYAHOGA, GEAUGA, LAKE, LORAIN (the C.E.I. Power House in Avon Lake), MEDINA (N. of Rte. #18) & SUMMIT (N. of #303)		
	Rates	Fringes
PIPEFITTER.....	\$ 47.07	28.15

PLUM0162-002 06/01/2024		
CHAMPAIGN, CLARK, CLINTON, DARKE, FAYETTE, GREENE, MIAMI, MONTGOMERY & PREBLE		

Rates	Fringes
Plumber, Pipefitter, Steamfitter.....\$ 43.05	27.18

PLUM0168-002 06/01/2024	

MEIGS, MONROE (South of Rte. #78), MORGAN (South of Rte. #78)
& WASHINGTON

Rates	Fringes
PLUMBER/PIPEFITTER.....\$ 39.43	37.29

PLUM0189-002 06/01/2024	

DELAWARE, FAIRFIELD, FRANKLIN, HOCKING, LICKING, MADISON,
MARION, PERRY, PICKAWAY, ROSS & UNION

Rates	Fringes
Plumber, Pipefitter, Steamfitter.....\$ 43.25	26.94

PLUM0219-002 06/01/2024	

MEDINA (Rte. #18 from eastern edge of Medina Co., west to
eastern corporate limits of the city of Medina, & on the county
road from the west corporate limits of Medina running due west
to and through community of Risley to the western edge of
Medina County - All territory south of this line), PORTAGE, and
SUMMIT (S. of Rte. #303) COUNTIES

Rates	Fringes
Plumber and Steamfitter.....\$ 45.37	27.64

PLUM0392-002 06/01/2024	

BROWN, BUTLER, CLERMONT, HAMILTON & WARREN

Rates	Fringes
PLUMBER/PIPEFITTER.....\$ 40.65	26.75

PLUM0396-001 06/01/2024	

COLUMBIANA (Excluding Washington & Yellow Creek Townships &
Liverpool Twp. - Secs. 35 & 36 - West of County Road #427),
MAHONING and TRUMBULL COUNTIES

Rates	Fringes
PLUMBER/PIPEFITTER.....\$ 38.45	28.96

PLUM0495-002 06/01/2024	

CARROLL (Rose, Monroe, Union, Lee, Orange, Perry & Loudon
Townships), COLUMBIANA (Washington & Yellow Creek Townships &
Liverpool Township, Secs. 35 & 36, West of County Rd. #427),
COSHOCTON, GUERNSEY, HARRISON, HOLMES, JEFFERSON, MORGAN (South
to State Rte. #78 & from McConnelsville west on State Rte. #37
to the Perry County line), MUSKINGUM, NOBLE, and TUSCARAWAS
COUNTIES

Rates	Fringes
Plumber, Pipefitter, Steamfitter.....\$ 37.82	36.70

PLUM0577-002 06/01/2024	

ADAMS, ATHENS, GALLIA, HIGHLAND, JACKSON, LAWRENCE, PIKE,
SCIOTO & VINTON

Rates	Fringes
Plumber, Pipefitter, Steamfitter.....\$ 41.65	27.48

PLUM0776-002 07/01/2024	

ALLEN, AUGLAIZE, HARDIN, LOGAN, MERCER, SHELBY and VAN WERT
COUNTIES

Rates	Fringes
Plumber, Pipefitter, Steamfitter.....\$ 42.07	29.35

TEAM0377-003 05/01/2024	

STATEWIDE, EXCEPT CUYAHOGA, GEAUGA & LAKE

Rates	Fringes
-------	---------

TRUCK DRIVER		
GROUP 1.....	\$ 32.54	16.80
GROUP 2.....	\$ 32.96	16.80

TRUCK DRIVER CLASSIFICATIONS

GROUP 1 - Asphalt Distributor; Batch; 4- Wheel Service; 4-Wheel Dump; Oil Distributor & Tandem

GROUP 2 - Tractor-Trailer Combination: Fuel; Pole Trailer; Ready Mix; Semi-Tractor; & Asphalt Oil Spraybar Man When Operated From Cab; 5 Axles & Over; Belly Dump; End Dump; Articulated Dump; Heavy Duty Equipment; Low Boy; & Truck Mechanic

TEAM0436-002 05/01/2024

CUYAHOGA, GEauga & LAKE

	Rates	Fringes
TRUCK DRIVER		
GROUP 1.....	\$ 32.25	18.95
GROUP 2.....	\$ 33.75	18.95

GROUP 1: Straight & Dump, Straight Fuel

GROUP 2: Semi Fuel, Semi Tractor, Euclids, Darts, Tank, Asphalt Spreaders, Low Boys, Carry-All, Tourna-Rockers, Hi-Lifts, Extra Long Trailers, Semi-Pole Trailers, Double Hook-Up Tractor Trailers including Team Track & Railroad Siding, Semi-Tractor & Tri-Axle Trailer, Tandem Tractor & Tandem Trailer, Tag Along Trailer, Expandable Trailer or Towing Requiring Road Permits, Ready-Mix (Agitator or Non-Agitator), Bulk Concrete Driver, Dry Batch Truck, Articulated End Dump

WELDERS - Receive rate prescribed for craft performing operation to which welding is incidental.

** Workers in this classification may be entitled to a higher minimum wage under Executive Order 14026 (\$17.20) or 13658 (\$12.90). Please see the Note at the top of the wage determination for more information. Please also note that the minimum wage requirements of Executive Order 14026 are not currently being enforced as to any contract or subcontract to which the states of Texas, Louisiana, or Mississippi, including their agencies, are a party.

Note: Executive Order (EO) 13706, Establishing Paid Sick Leave for Federal Contractors applies to all contracts subject to the Davis-Bacon Act for which the contract is awarded (and any solicitation was issued) on or after January 1, 2017. If this contract is covered by the EO, the contractor must provide employees with 1 hour of paid sick leave for every 30 hours they work, up to 56 hours of paid sick leave each year. Employees must be permitted to use paid sick leave for their own illness, injury or other health-related needs, including preventive care; to assist a family member (or person who is like family to the employee) who is ill, injured, or has other health-related needs, including preventive care; or for reasons resulting from, or to assist a family member (or person who is like family to the employee) who is a victim of, domestic violence, sexual assault, or stalking. Additional information on contractor requirements and worker protections under the EO is available at <https://www.dol.gov/agencies/whd/government-contracts>.

Unlisted classifications needed for work not included within the scope of the classifications listed may be added after award only as provided in the labor standards contract clauses (29CFR 5.5 (a) (1) (iii)).

The body of each wage determination lists the classification and wage rates that have been found to be prevailing for the cited type(s) of construction in the area covered by the wage determination. The classifications are listed in alphabetical order of "identifiers" that indicate whether the particular rate is a union rate (current union negotiated rate for local), a survey rate (weighted average rate) or a union average rate (weighted union average rate).

Union Rate Identifiers

A four letter classification abbreviation identifier enclosed in dotted lines beginning with characters other than "SU" or "UAVG" denotes that the union classification and rate were prevailing for that classification in the survey. Example: PLUM0198-005 07/01/2014. PLUM is an abbreviation identifier of the union which prevailed in the survey for this classification, which in this example would be Plumbers. 0198 indicates the local union number or district council number where applicable, i.e., Plumbers Local 0198. The next number, 005 in the example, is an internal number used in processing the wage determination. 07/01/2014 is the effective date of the most current negotiated rate, which in this example is July 1,

2014.

Union prevailing wage rates are updated to reflect all rate changes in the collective bargaining agreement (CBA) governing this classification and rate.

Survey Rate Identifiers

Classifications listed under the "SU" identifier indicate that no one rate prevailed for this classification in the survey and the published rate is derived by computing a weighted average rate based on all the rates reported in the survey for that classification. As this weighted average rate includes all rates reported in the survey, it may include both union and non-union rates. Example: SULA2012-007 5/13/2014. SU indicates the rates are survey rates based on a weighted average calculation of rates and are not majority rates. LA indicates the State of Louisiana. 2012 is the year of survey on which these classifications and rates are based. The next number, 007 in the example, is an internal number used in producing the wage determination. 5/13/2014 indicates the survey completion date for the classifications and rates under that identifier.

Survey wage rates are not updated and remain in effect until a new survey is conducted.

Union Average Rate Identifiers

Classification(s) listed under the UAVG identifier indicate that no single majority rate prevailed for those classifications; however, 100% of the data reported for the classifications was union data. EXAMPLE: UAVG-OH-0010 08/29/2014. UAVG indicates that the rate is a weighted union average rate. OH indicates the state. The next number, 0010 in the example, is an internal number used in producing the wage determination. 08/29/2014 indicates the survey completion date for the classifications and rates under that identifier.

A UAVG rate will be updated once a year, usually in January of each year, to reflect a weighted average of the current negotiated/CBA rate of the union locals from which the rate is based.

State Adopted Rate Identifiers

Classifications listed under the "SA" identifier indicate that the prevailing wage rate set by a state (or local) government was adopted under 29 C.F.R. 1.3(g)-(h). Example: SAME2023-007 01/03/2024. SA reflects that the rates are state adopted. ME refers to the State of Maine. 2023 is the year during which the state completed the survey on which the listed classifications and rates are based. The next number, 007 in the example, is an internal number used in producing the wage determination. 01/03/2024 reflects the date on which the classifications and rates under the "SA" identifier took effect under state law in the state from which the rates were adopted.

WAGE DETERMINATION APPEALS PROCESS

1.) Has there been an initial decision in the matter? This can be:

- * an existing published wage determination
- * a survey underlying a wage determination
- * a Wage and Hour Division letter setting forth a position on a wage determination matter
- * a conformance (additional classification and rate) ruling

On survey related matters, initial contact, including requests for summaries of surveys, should be with the Wage and Hour National Office because National Office has responsibility for the Davis-Bacon survey program. If the response from this initial contact is not satisfactory, then the process described in 2.) and 3.) should be followed.

With regard to any other matter not yet ripe for the formal process described here, initial contact should be with the Branch of Construction Wage Determinations. Write to:

Branch of Construction Wage Determinations
Wage and Hour Division
U.S. Department of Labor
200 Constitution Avenue, N.W.
Washington, DC 20210

2.) If the answer to the question in 1.) is yes, then an interested party (those affected by the action) can request review and reconsideration from the Wage and Hour Administrator (See 29 CFR Part 1.8 and 29 CFR Part 7). Write to:

Wage and Hour Administrator
U.S. Department of Labor
200 Constitution Avenue, N.W.
Washington, DC 20210

The request should be accompanied by a full statement of the interested party's position and by any information (wage payment data, project description, area practice material, etc.) that the requestor considers relevant to the issue.

3.) If the decision of the Administrator is not favorable, an interested party may appeal directly to the Administrative Review Board (formerly the Wage Appeals Board). Write to:

Administrative Review Board
U.S. Department of Labor
200 Constitution Avenue, N.W.
Washington, DC 20210

4.) All decisions by the Administrative Review Board are final.

=====

END OF GENERAL DECISION"