

VILLAGE OF WILLIAMSBURG

CLERMONT COUNTY, OHIO

TOLLGATE ROAD WATER MAIN IMPROVEMENTS

242074

INDEX OF SHEETS		
NO.	DWG NAME	SHEET NAME
1	TTL	TITLE
2	NOTES	GENERAL NOTES
3	DET-1	DETAILS & LEGEND
4	PNP1	PLAN & PROFILE 10+00 - 13+75
5	PNP2	PLAN & PROFILE 13+75 - 18+50
6	PNP3	PLAN & PROFILE 18+50 - 23+25
7	PNP4	PLAN & PROFILE 23+25 - 28+00
8	PNP5	PLAN & PROFILE 28+00 - 32+75
9	PNP6	PLAN & PROFILE 32+75 - 35+35

VILLAGE OF WILLIAMSBURG OFFICIALS

MAYOR
JIM WEAVER

VILLAGE ADMINISTRATOR
ANDREW GEPHARDT

CITY COUNCIL MEMBERS

JACOB SIMPSON

KATIE KING

MARK HERREN

JOHN POPE

RANDY MERCER

TIM WOOD

VILLAGE SOLICITOR
CHRISTOPHER MOORE

PUBLIC WORKS SUPERVISOR
KYLE CRIBBET

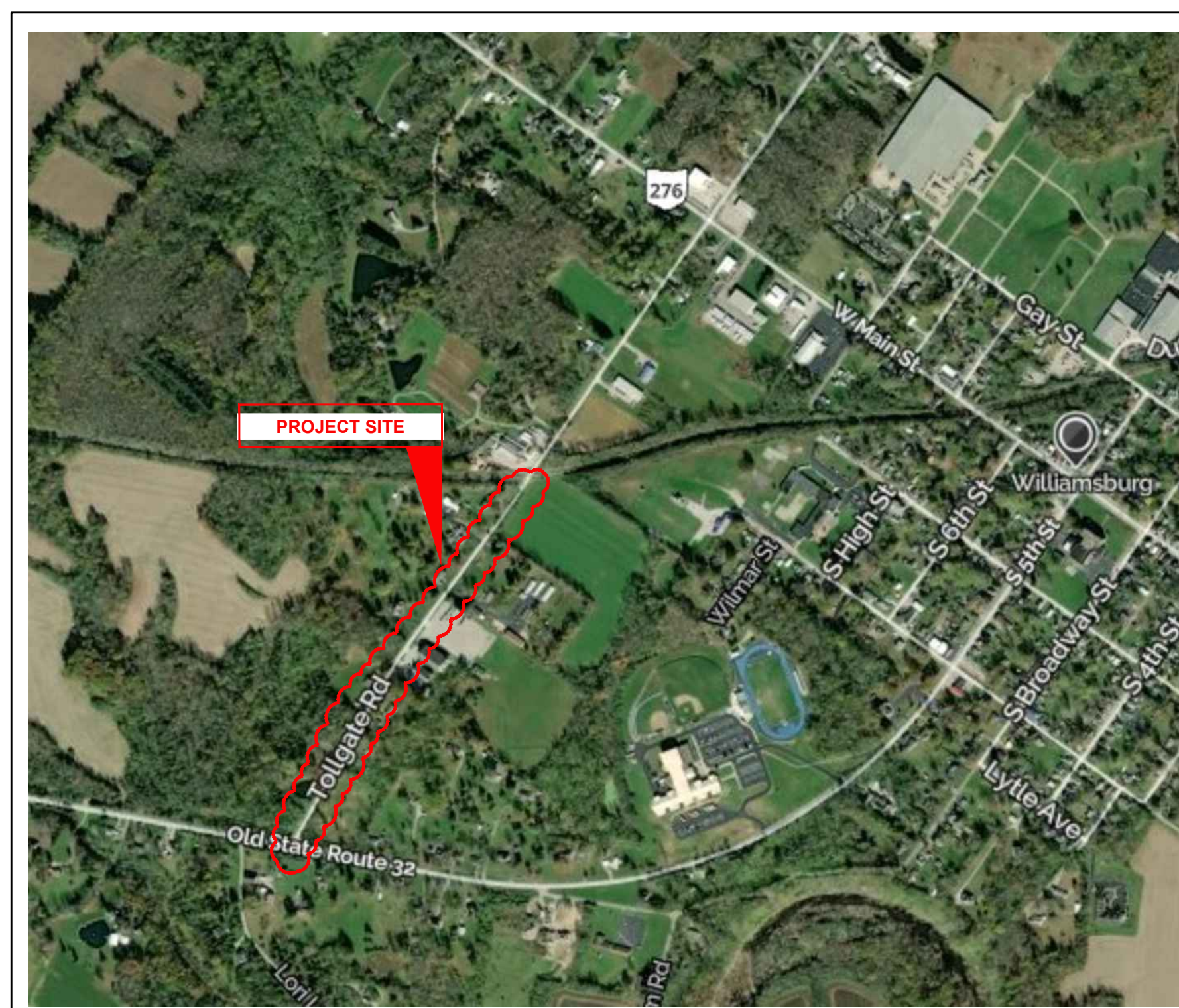

VICINITY MAP

O.D.O.T. SPECIFICATIONS

THE LATEST STANDARD SPECIFICATIONS OF THE OHIO DEPARTMENT OF TRANSPORTATION AND THE CLERMONT COUNTY ENGINEER'S OFFICE, INCLUDING CHANGES AND SUPPLEMENTAL SPECIFICATIONS THERETO AND THE VILLAGE OF WILLIAMSBURG REQUIREMENTS SHALL GOVERN THIS IMPROVEMENT.

SOURCE OF BOUNDARY INFORMATION

THE BOUNDARY INFORMATION SHOWN ON THESE PLANS IS BASED UPON G.I.S. MAPPING AND DOES NOT REPRESENT AN ACTUAL FIELD BOUNDARY SURVEY BY CT CONSULTANTS, INC.

APPROVALS:

Jim Weaver
JIM WEAVER - MAYOR 11/18/24
DATE

Andrew Gephardt
ANDREW GEPHARDT - VILLAGE ADMINISTRATOR 11-18-24
DATE

OFFICE:

VILLAGE OF WILLIAMSBURG
107 WEST MAIN STREET
WILLIAMSBURG, OH 45176

(513) 724-6107 PHONE

ENGINEER:

CT CONSULTANTS, INC.
INTEGRITY TOWER BLDG.
4420 COOPER ROAD
CINCINNATI, OHIO 45242

(513) 791-1700 PHONE
(513) 791-1936 FAX



1-800-362-2764
CALL TWO WORKING DAYS BEFORE YOU DIG
(NON MEMBERS MUST BE CALLED DIRECTLY)

- UNDERGROUND BUILDING SERVICE UTILITY LINES ARE NOT SHOWN ON THE PLANS. THE CONTRACTOR SHALL BE RESPONSIBLE FOR LOCATING, MAINTAINING AND REPLACING AS NECESSARY TO ENSURE CONTINUAL SERVICE TO BUILDINGS.
- THE CONTRACTOR IS RESPONSIBLE TO CALL OHIO UTILITIES PROTECTION SERVICE @ 1-800-362-2764, THREE WORKING DAYS PRIOR TO CONSTRUCTION.



SHAWN RIGGS

P.E. No. 81714



2161 CHAMBER CENTER DRIVE
FORT MITCHELL, KENTUCKY 41017
TEL: (609) 325-9594
WWW.VERDANTAS.COM

TOLLGATE ROAD WATER MAIN REPLACEMENT

- VILLAGE OF WILLIAMSBURG -
CLERMONT, OHIO 45176

TITLE SHEET

PROJECT NO.	242074
DISCIPLINE	CIVIL
SHEET NAME	TTL
SHEET	OF
1	9

MATERIALS AND SPECIFICATIONS

UNLESS OTHERWISE SPECIFIED, ALL MATERIALS SHALL BE NEW AND BOTH WORKMANSHIP AND MATERIALS SHALL BE OF PREMIUM QUALITY, PROPER AND SUFFICIENT FOR THE PURPOSE CONTEMPLATED. THE CONTRACTOR SHALL FURNISH, IF SO REQUIRED, SATISFACTORY EVIDENCE AS TO TYPE AND QUALITY OF MATERIALS AND WORKMANSHIP.

ALL ITEMS OF EQUIPMENT AND/OR MATERIAL PROPOSED BY THE CONTRACTOR FOR SUBSTITUTIONS MUST BE APPROVED BY THE ENGINEER IN WRITING AND SHALL BE EQUAL OR SUPERIOR TO THE ITEMS SPECIFIED IN THE CONTRACT DOCUMENTS. IF SAID SUBSTITUTION PROPOSED BY THE CONTRACTOR FOR A SPECIFIED ITEM REQUIRES ENGINEERING REVISIONS, THE TOTAL EXPENSE OF SAID REVISIONS SHALL BE PAID BY THE CONTRACTOR.

ANY ITEMS OF LABOR AND MATERIALS REQUIRED BUT NOT SHOWN AS A SEPARATE PAY ITEM IN THE PROPOSAL SHALL BE FURNISHED AND INSTALLED AS INCIDENTAL TO THE CONTRACT, EXCEPT AS NOTED IN THE PLANS AND SPECIFICATIONS.

PERMITS
THE VILLAGE HAS RECEIVED PLAN APPROVAL FROM THE OHIO EPA AND HAS OBTAINED THE ROW PERMIT FROM THE CLERMONT COUNTY ENGINEER'S OFFICE.

RESPONSIBILITY
IT SHALL BE THE RESPONSIBILITY OF THE CONTRACTOR TO PERFORM HIS WORK IN SUCH A MANNER AS NOT TO DAMAGE OR DESTROY ANY EXISTING FEATURE, (I.E. EXISTING INLETS, CONDUITS, ETC.) WHICH IS NOT MARKED FOR REPLACEMENT OR REMOVAL. IF ANY SUCH DAMAGE DOES OCCUR DUE TO THE OPERATIONS OF THE CONTRACTOR, HE SHALL REPLACE THE DAMAGED PORTION AT HIS EXPENSE.

THE CONTRACTOR SHALL EXERCISE DUE CARE DURING CONSTRUCTION SO AS NOT TO DESTROY ANY TREES, PLANTS, SHRUBS OR STRUCTURES OUTSIDE OF THE INDICATED WORK LIMITS AND THOSE NOT SPECIFICALLY MARKED FOR REMOVAL OR RELOCATION WITHIN THE WORK LIMITS.

IN SOME INSTANCES, THE CONTRACTOR WILL BE REQUIRED TO EXCAVATE UNDER AND AROUND THE EXISTING UTILITIES. EXTREME CARE SHOULD BE USED NOT TO DAMAGE THE UTILITY DURING THIS OPERATION.

WATER POLLUTION, SOIL EROSION AND SILTATION CONTROL
THE CONTRACTOR SHALL TAKE EXTREME CARE TO PREVENT UNNECESSARY EROSION, WATER POLLUTION AND SILTATION AT ALL POINTS OF THE PROJECT. TEMPORARY SEEDING AND MULCHING; STRAW BALES, SLOPE DRAINS, ETC., SHALL BE USED AS NECESSARY OR AS DIRECTED BY THE ENGINEER.

COST OF EQUIPMENT AND MATERIAL REQUIRED TO PERFORM THIS WORK SHALL BE INCIDENTAL TO THE OVERALL BID PRICE.

MAINTAINING WATER SERVICE
IT IS THE CONTRACTOR'S RESPONSIBILITY TO MAINTAIN ADEQUATE WATER SUPPLY TO CONSUMERS AND FOR FIRE-FIGHTING PURPOSES. THE CONTRACTOR MUST SCHEDULE HIS OPERATIONS TO ENSURE THAT WATER SERVICES AND FIRE HYDRANTS WILL NOT BE OUT OF SERVICE FOR MORE THAN THE LENGTH OF TIME WHICH, IN THE OPINION OF THE ENGINEER, IS REQUIRED FOR MAKING NECESSARY CONNECTIONS.

CONSTRUCTION LAYOUT STAKES
THE CONTRACTOR SHALL BE RESPONSIBLE FOR THE CONSTRUCTION LAYOUT STAKES FOR THIS PROJECT.

DUST CONTROL
DUST SHALL BE KEPT TO A MINIMUM. COST OF EQUIPMENT AND MATERIAL REQUIRED TO PERFORM THIS ITEM SHALL BE INCIDENTAL TO THE OVERALL BID PRICE.

TRENCH EXCAVATION

EXCAVATION SHALL BE LIMITED TO THE RIGHTS OF WAY AND EASEMENTS OF LANDS CONTROLLED BY THE OWNER.

THE LENGTH OF TRENCH TO BE OPENED OR THE AREA OF THE SURFACE TO BE DISTURBED AT ANY ONE TIME WILL BE LIMITED WITH REGARD TO BOTH EXPEDITIOUS CONSTRUCTION AND TO THE CONVENIENCE AND COMFORT OF THE PUBLIC RESIDING IN THE NEIGHBORHOOD OR FREQUENTING STREETS ADJACENT TO OR ALONG THE EXCAVATION, UNLESS OTHERWISE SPECIFICALLY PERMITTED BY THE ENGINEER. THE FOLLOWING LIMITATIONS TO LENGTH OF OPERATIONS WILL BE IMPOSED.

1) PLACEMENT OF PROPOSED CONDUIT AND BACKFILL MATERIAL SHALL FOLLOW AS CLOSELY AS POSSIBLE BEHIND EXCAVATION OPERATIONS. THE LENGTH OF TRENCH, WHICH IS OPEN AT ANY ONE TIME, SHALL BE HELD TO A MINIMUM AND SHALL AT ALL TIMES BE SUBJECT TO THE APPROVAL OF THE ENGINEER.

2) IN PUBLIC AREAS, ALL UNCOMPLETED MAIN LINE, SERVICE LINE AND MANHOLE EXCAVATION, BACKFILL AND TEMPORARY SURFACING SHALL NOT EXCEED 100 FEET OR AS DIRECTED BY THE ENGINEER.

IF FOR ANY REASON THE WORK IS STOPPED ON THE WHOLE OR ANY PART OF THE TRENCH AND THE SAME IS LEFT OPEN FOR AN UNREASONABLE LENGTH OF TIME IN ADVANCE OF THE CONSTRUCTION OF THE CONDUIT, THE CONTRACTOR SHALL, WHEN SO DIRECTED, REFILL SUCH TRENCH OR PART THEREOF AND TEMPORARILY RESTORE THE SAME AT HIS OWN EXPENSE AND HE SHALL NOT AGAIN OPEN SUCH TRENCH OR PART THEREOF UNTIL HE IS READY TO PROCEED WITH THE CONSTRUCTION OF THE WORK.

ALL EXCAVATIONS WITHIN PUBLIC AREA LIMITS SHALL BE COMPLETELY CLOSED AT ALL TIMES WHEN THERE IS A DELAY IN THE PROGRESS OF THE WORK.

CONTINGENCY QUANTITIES

THE CONTRACTOR SHALL NOT ORDER MATERIALS OR PERFORM WORK FOR PLAN ITEMS SET UP TO BE USED "AS DIRECTED BY THE ENGINEER" UNLESS AUTHORIZED BY THE ENGINEER. THE ACTUAL WORK LOCATIONS AND QUANTITIES USED AT THE ENGINEER'S DISCRETION SHALL BE MADE A MATTER OF RECORD BY INCORPORATION INTO THE FINAL CHANGE ORDER GOVERNING COMPLETION OF THIS PROJECT.

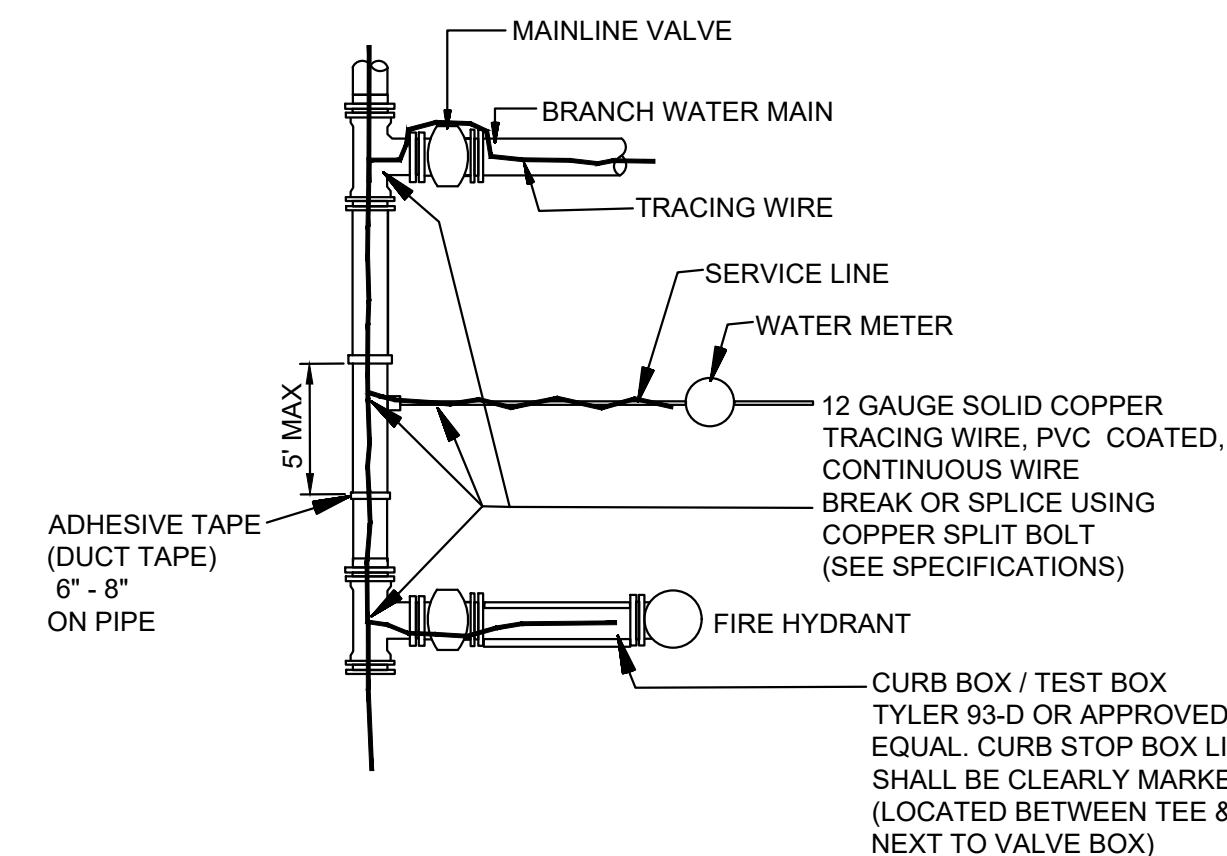

DUCTILE IRON AND PVC PIPE WITH DUCTILE IRON FITTINGS

TRACING WIRE DETAIL

MONUMENTS - BENCHMARKS

IT SHALL BE THE CONTRACTOR'S RESPONSIBILITY TO PRESERVE ALL EXISTING SURVEY MONUMENTATION AND BENCHMARKS. ANY MONUMENTATION (IRON PINS, CONCRETE MONUMENTS, ETC.), WHICH MAY BE DISTURBED DURING CONSTRUCTION, SHALL BE REFERENCED AND REPLACED UPON PROJECT COMPLETION. ALL MONUMENTATION REPLACED SHALL BE OF THE SAME MATERIAL AS ORIGINAL MONUMENT AND SHALL BE REPLACED WITHIN CUSTOMARY LIMITS OF ACCURACY. UNDER THE DIRECTION OF A REGISTERED LAND SURVEYOR. FOR U.S.S. MONUMENTS AND/OR BENCHMARKS WHICH MAY BE DISTURBED DURING CONSTRUCTION, THE APPROPRIATE AGENCY SHALL BE GIVEN ADEQUATE PRIOR NOTIFICATION TO ALLOW PROPER REFERENCES AND RELOCATION OF THE MONUMENTS TO BE DONE BY THE AGENCY INVOLVED.

UTILITIES

UTILITIES DATA IS BASED UPON INFORMATION PROVIDED BY OTHERS OR AS AVAILABLE IN PUBLIC RECORDS AND HAS NOT BEEN VERIFIED BY THE ENGINEER. THE ENGINEER OR THE OWNER IS NOT RESPONSIBLE OR LIABLE FOR DATA SUPPLIED BY OTHERS.

UTILITIES NOT UNDERGROUND, AND PRIVATE SEPTIC SYSTEMS IN SINGLE OR DOUBLE FAMILY DWELLINGS UTILIZED FOR ONLY THAT DWELLING AND NOT CONNECTED TO ANY OTHER SYSTEM ARE NOT INCLUDED ON THE PLAN.

WITHIN 10 DAYS OF THE AWARD OF THE CONTRACT, THE OWNER SHALL NOTIFY ALL UTILITIES OF THE NAME, ADDRESS AND PHONE NUMBER OF THE CONTRACTOR. THE CONTRACTOR SHALL NOTIFY THE REGISTERED UNDERGROUND UTILITY PROTECTION SERVICE AND NON-MEMBER OWNERS OF THE STARTING DATE AT LEAST TWO WORKING DAYS PRIOR TO STARTING WORK. THE UTILITY SHALL MARK, STAKE OR OTHERWISE DESIGNATE THE LOCATION OF THE UNDERGROUND FACILITIES WITHIN 48 HOURS OF RECEIVING THE CONTRACTOR'S NOTICE OF A STARTING DATE. THE MARKING OR LOCATING SHALL BE COORDINATED TO STAY APPROXIMATELY TWO DAYS AHEAD OF THE PLANNED CONSTRUCTION.

DURING CONSTRUCTION, THE CONTRACTOR SHALL REPORT IMMEDIATELY TO THE OWNERS OF THE UNDERGROUND FACILITIES ANY BREAK OR LEAK IN THE FACILITIES, OR ANY DENT, GOUGE, GROOVE OR OTHER DAMAGE. THE CONTRACTOR SHALL NOTIFY NEARBY OCCUPANTS OF ANY EMERGENCY SITUATION THAT MAY ARISE.

THE CONTRACTOR SHALL BE RESPONSIBLE FOR COORDINATING ALL UTILITY ACTIVITIES AND SCHEDULES.

SOIL CONDITIONS / WATER TABLE

THE CONTRACTOR IS RESPONSIBLE FOR EXAMINING / TESTING / DETERMINING SITE CONDITIONS AS IT RELATES TO SOIL CONDITIONS AND GROUND WATER TABLE. THE CONTRACTOR IS RESPONSIBLE FOR STABILIZING ALL TRENCH WORK, USING TEMPORARY SHORING (TRENCH BOXES OR OTHER) IF NECESSARY TO CONSTRUCT THE IMPROVEMENTS. THE CONTRACTOR IS ALSO RESPONSIBLE FOR PUMPING / DEWATERING TRENCHES, IF NECESSARY.

PAYMENT FOR THE WORK DESCRIBED ABOVE SHALL BE INCLUDED IN THE UNIT PRICE BID FOR THE PERTINENT CONDUIT ITEMS.

SEED, MULCH & FERTILIZER, AS PER PLAN

ALL SEEDING, MULCHING AND FERTILIZING SHALL BE DONE TO DAMAGED AREAS WITHIN THE CONSTRUCTION LIMITS, INCIDENTAL TO THE PROJECT. ALL DAMAGED AREAS REQUIRING RESTORATION OUTSIDE OF THE CONSTRUCTION LIMITS SHALL BE DONE AT THE EXPENSE OF THE CONTRACTOR.

THE ENGINEER SHALL DETERMINE ALL AREAS REQUIRING SEEDING, MULCHING AND FERTILIZER PERTINENT TO THIS CONTRACT.

AIR COCKS

AIR COCKS SHALL BE PROVIDED AND INSTALLED WHERE SHOWN ON THE PLANS AND OTHER HIGH SPOTS THAT MAY OCCUR IN LAYING OF PIPE. THE CONTRACTOR WILL INSTALL AIR COCKS IN P.V.C. PIPE. THE COST SHALL BE INCLUDED IN THE CONTRACT PRICE FOR BID ITEM 1100, WATER LINES, INSTALLATION.

MAINTENANCE OF TRAFFIC

THE CONTRACTOR SHALL MAINTAIN TRAFFIC AT ALL TIMES IN ACCORDANCE WITH THE REQUIREMENTS OF ODOT SPEC. 614 AND O.M.U.T.C.D.

THE CONTRACTOR SHALL MAINTAIN ALTERNATING TWO WAY TRAFFIC ON ALL STREETS DURING CONSTRUCTION IN AREAS OF ANY TEMPORARY LANE CLOSURES. ALL LANE CLOSURES MUST BE APPROVED BY THE COUNTY ENGINEER'S OFFICE PRIOR TO BEGINNING CONSTRUCTION. SPECIFIC ATTENTION WILL BE DIRECTED TOWARD THE PROPER USE OF FLAGGERS, LIGHTS, DRUMS, AND TEMPORARY PAVEMENT MARKINGS (IF NECESSARY). THE CONTRACTOR SHALL FURNISH, ERECT AND MAINTAIN ALL NECESSARY SIGNS, AND PROVIDE TEMPORARY STRIPING (IF NECESSARY). THE CONTRACTOR SHALL ALSO PROVIDE ALL PLATING, TEMPORARY PAVEMENT AND TRAFFIC CONTROL MEASURES NECESSARY TO MAINTAIN TRAFFIC. ALL COSTS FOR TRAFFIC MAINTENANCE SHALL BE INCLUDED IN THE LUMP SUM UNIT BID FOR "MAINTENANCE OF TRAFFIC".

MAINTENANCE OF TRAFFIC SHALL BE ONGOING THROUGH THE PROJECT, INCLUDING ALL PERIODS OF INACTIVITY BY THE CONTRACTOR, UNTIL FINAL ACCEPTANCE OF THE PROJECT.

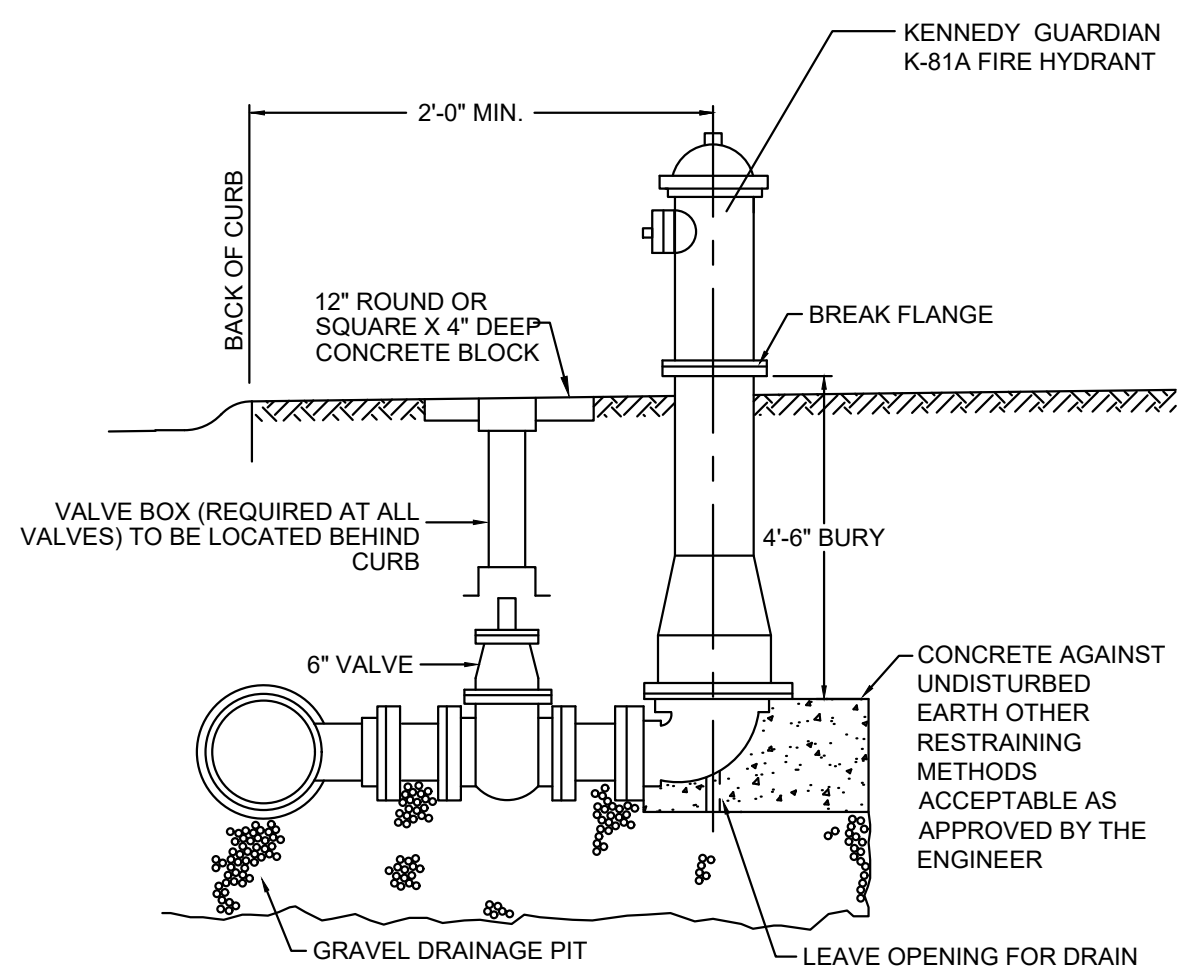

- FIRE HYDRANT DETAILS**
1. DIA.-MAIN VALVE OPENING 5 1/4"
 2. DIA.-PUMPER CONNECTION I.D. 4 1/2" O.D. 5 3/4"
 3. DIA.-HOSE CONNECTIONS TWO 2 1/2"
 4. THREAD TYPE NATIONAL STANDARD - NO THREAD EXPOSED TO WATER (STORZ CONNECTION FOR PUMPER NOZZLE) PENTAGON
 5. SHAPE-CAPS & OPERATING NUT TOP 1 3/8", BOTTOM 1 3/8"
 6. DIMENSIONS-OPERATING NUT LEFT (COUNTER CLOCKWISE)
 7. DIRECTION OF OPENING LEFT (COUNTER CLOCKWISE)
 8. COLOR TO BE PAINTED RED
 9. VALVE SEAT MACHINED BRONZE
 10. BARREL TWO PIECE WITH BREAK AWAY FEATURE
 11. TOP DRY
 12. BEARING ANTI-FRICTION THRUST BEARING
 13. SPACING BETWEEN HYDRANTS 300' MAX. (400' MAX. FOR RESIDENTIAL)

FIRE HYDRANT AND VALVE ASSEMBLY

ALL OPEN TRENCHES FOR WATERMANS SHALL BE PROPERLY DELINEATED FROM THE TRAVELED ROADWAY BY REFLECTIVE DRUMS. TRENCHES SHALL EITHER BE BACKFILLED OR COVERED FOR ANY EXTENDED PERIODS OF NO CONSTRUCTION.

MAINTENANCE OF EXISTING ROADWAY/DRIVEWAYS

THE CONTRACTOR WILL BE RESPONSIBLE FOR MAINTAINING THE EXISTING ROADWAYS AND DRIVEWAYS IN GOOD CONDITION WITH RESPECT TO BOTH SAFETY AND SMOOTHNESS OF TRAVEL AS LONG AS IT IS NEEDED FOR MAINTENANCE OF TRAFFIC. THE COST OF ADDITIONAL WORK AND MATERIAL NECESSARY TO REPAIR AND MAINTAIN THE EXISTING ROADWAYS SHALL BE INCIDENTAL TO THE CONTRACT.

CONSTRUCTION SCHEDULE

IN DETAILING THE CONSTRUCTION SCHEDULE, THE CONTRACTOR SHALL PROVIDE THE LEAST POSSIBLE INCONVENIENCE TO THE PUBLIC DURING CONSTRUCTION. WORK SHALL NOT PROCEED ON THE PROJECT UNTIL SUCH TIME AS THE SCHEDULE IS APPROVED BY BOTH THE VILLAGE ENGINEER AND THE VILLAGE ADMINISTRATOR.

ACCESS TO PROPERTY

THE CONTRACTOR SHALL GIVE WRITTEN NOTICE TO ALL RESIDENTS AND BUSINESSES AND GIVE A COPY OF SAID WRITTEN NOTICE TO THE PROJECT INSPECTOR 48 HOURS PRIOR TO BEING ALLOWED TO COMMENCE WORK WHICH WOULD INVOLVE BLOCKING ACCESS TO SAID PROPERTY.

GENERAL NOTES

1- THE EXISTING WATER MAIN ELEVATION AND LOCATION AT THE CONNECTION POINT WITH THE PROPOSED MAIN WAS ASSUMED AND HAS NOT BEEN FIELD VERIFIED. PRIOR TO COMMENCEMENT OF ANY WATER MAIN WORK, THE CONTRACTOR SHALL DIG A TEST HOLE AT THE CONNECTION POINT TO LOCATE EXISTING WATER MAIN AS TO LOCATION AND ELEVATION. THE EXISTING WATER MAIN LOCATION MAY REQUIRE SOME FIELD ADJUSTMENT TO THE PROPOSED WATER MAIN INCLUDING ADJUSTING THE DEPTH OF THE PROPOSED WATER MAIN. COST OF DOING THE ABOVE SHALL BE INCIDENTAL TO THE PERTINENT WATER MAIN ITEM.

2- COST OF TRIMMING OR CLEARING ANY TREES, BUSHES, ETC. SHALL BE INCIDENTAL TO THE OVERALL CONTRACT PRICE AND SHALL BE APPROVED BY THE VILLAGE OF WILLIAMSBURG AND THE PROPERTY OWNER.

3- THE UTILITY INFORMATION SHOWN ON THE PLANS IS BASED ON INFORMATION RECEIVED FROM OTHERS AND HAS NOT BEEN VERIFIED BY THE ENGINEER OR OWNER. IT SHALL BE THE RESPONSIBILITY OF THE CONTRACTOR TO VERIFY THE LOCATION OF THE UTILITIES AND TO COORDINATE ANY IMPACT CAUSED BY THE PROPOSED WORK WITH ALL UTILITY OWNERS AND/OR THEIR CONTRACTORS. THE CONTRACTOR WILL BE REQUIRED TO DIG TEST HOLES AT ALL UTILITY CROSSINGS TO LOCATE THE UTILITY AS TO BOTH LOCATION AND ELEVATION AND WILL BE REQUIRED TO REALIGN AND ADJUST THE ELEVATION OF THE PROPOSED WATER MAIN TO AVOID THE UTILITY. COST OF ALL THE ABOVE SHALL BE INCIDENTAL TO THE OVERALL CONTRACT PRICE.

4-WATERLINES CROSSING UNDER OR OVER SEWER LINES (DEFINED AS ANY SANITARY/COMBINED SEWER, SEPTIC TANK OR SUBSOIL TREATMENT SYSTEM) MUST MAINTAIN A MINIMUM VERTICAL CLEARANCE OF 18" AND ONE FULL LENGTH OF PIPE SHALL BE LOCATED SO BOTH JOINTS ARE AS FAR FROM THE SEWER AS POSSIBLE. SPECIAL STRUCTURAL SUPPORT FOR THE WATER AND SEWER PIPES MAY BE REQUIRED.

5- CONTRACTOR IS RESPONSIBLE FOR EXPOSING UNDERGROUND UTILITIES AS DIRECTED BY THE ENGINEER, OR THE VILLAGE OF WILLIAMSBURG PRIOR TO CONSTRUCTION TO VERIFY EXACT DEPTHS OF UTILITIES. COST SHALL BE INCIDENTAL TO THE OVERALL CONTRACT.

6- CONTRACTOR IS RESPONSIBLE FOR KEEPING FIELD NOTES THAT PROVIDE SUFFICIENT DATA FOR PREPARING "RECORD DRAWINGS" UPON COMPLETION OF CONSTRUCTION.

7- ALL WATER MAIN CONSTRUCTION SHALL CONFORM TO COUNTY AND VILLAGE SPECIFICATIONS. CONTRACTOR IS RESPONSIBLE FOR OBTAINING A CURRENT COPY OF THE STANDARD DRAWINGS AND SPECIFICATIONS.

8- COST OF ALL TRENCHING, PIPE RESTRAINT MATERIALS, AIR COCKS, PIPE BEDDING, BACKFILL, REMOVAL AND REPLACEMENT OF LANDSCAPING/ SIGNS SHALL BE PART OF THE COST OF INSTALLING THE WATER MAIN.

9- COST OF ALL REMOVAL AND REPLACEMENT OF LANDSCAPING/YARD RESTORATION AND SIGNS SHALL BE PART OF THE COST OF INSTALLING THE SERVICE LINE.

10- THE PROPOSED WATER MAIN SHALL BE PVC C-900 DR 18.

11- PROPOSED WATER MAIN SHALL BE THOROUGHLY CLEANED, FLUSHED, AND DISINFECTED, AS PER THE VILLAGE OF WILLIAMSBURG SPECIFICATIONS.

12- PRESSURE TESTING SHALL BE DONE AS PER THE VILLAGE OF WILLIAMSBURG SPECIFICATIONS.

IN GENERAL, UNLESS SPECIFICALLY SET FORTH HEREIN, THE WORK AND MATERIALS SHALL CONFORM TO THE APPLICABLE DIVISIONS AND PARAGRAPHS OF THE MOST CURRENT EDITIONS OF THE: STATE OF OHIO DEPARTMENT OF TRANSPORTATION CONSTRUCTION AND MATERIAL SPECIFICATIONS AND "STANDARD CONSTRUCTION DRAWINGS AND SPECIFICATIONS" ALONG WITH THE CLERMONT COUNTY WATER DEPT. AND THE VILLAGE OF WILLIAMSBURG SPECIFICATIONS AND REQUIREMENTS.

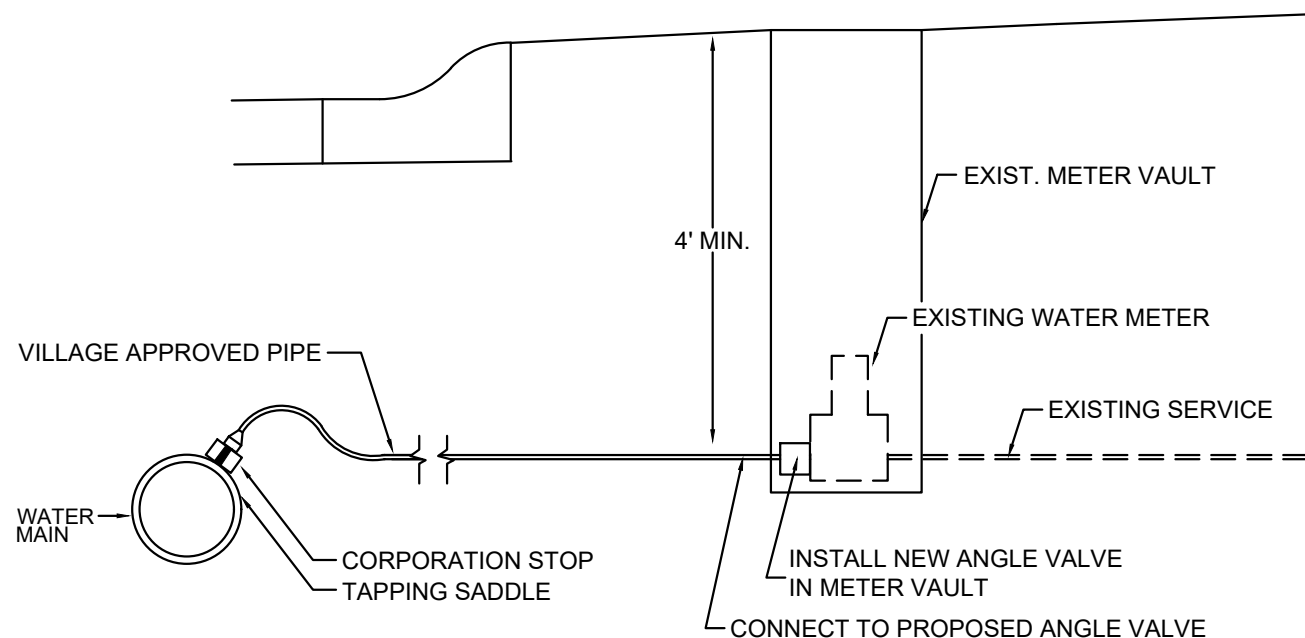

- NOTES:**
1. SERVICE LINES FROM THE WATER MAIN TO THE CURB STOP SHALL BE PVC C901 (250 P.S.I.), INSTALLED AT LEAST 4 FT. BELOW PAVEMENT SURFACE OR FINISHED GRADE.
 2. SERVICE LINES FROM THE CURB STOP TO THE EXISTING METER SHALL TYPE K COPPER LINE.

14- THE PROPOSED WATER MAIN SHALL HAVE A HORIZONTAL SEPARATION OF AT LEAST 3'-0" (MEASURED FROM OUTSIDE OF PIPE TO OUTSIDE OF PIPE) FROM ANY GAS MAIN.

15- A 10' MINIMUM LATERAL SEPARATION BETWEEN WATER MAINS AND SEWERS (DEFINED AS ANY SANITARY/COMBINED SEWER, SEPTIC TANK OR SUBSOIL TREATMENT SYSTEM) AND SEWER MANHOLES, MEASURED FROM THE OUTSIDE DIAMETER TO OUTSIDE, MUST BE MAINTAINED, UNLESS OTHERWISE INDICATED ON THE PLANS.

16- AFTER PROPOSED WATER MAIN IS TESTED AND APPROVED, THE EXISTING WATER MAIN SHALL REMAIN IN SERVICE UNTIL SUCH TIME THAT ALL NEW WATER SERVICES HAVE BEEN CONNECTED AND APPROVED. THEN AT SUCH TIME THE EXISTING WATER MAIN SHALL BE PLUGGED AND ABANDONED.

17- ALL IMPACTED STORM SEWER RECONSTRUCTION ITEMS SHALL CONFORM WITH THE LATEST STANDARD DRAWINGS AND SPECIFICATIONS OF THE VILLAGE OF WILLIAMSBURG, CLERMONT COUNTY AND O.D.O.T.

18- THE CONTRACTOR SHALL COORDINATE WITH THE VILLAGE OF WILLIAMSBURG FOR FIELD INSPECTIONS.

19- PROPOSED SERVICES SHALL CONSIST OF FURNISHING AND INSTALLING 3/4" TYPE K COPPER OR 1-1/2" CTS PLASTIC SERVICE BRANCHES, AND SHALL INCLUDE NEW TAPPING SADDLES, COMPRESSION FITTINGS, CORPORATION STOPS, AND TRACER WIRE AS SHOWN ON THE PLANS.

20- REPLACE AND RECONNECT SERVICE LINE. INCLUDES THE LABOR, EQUIPMENT, EXCAVATION, BEDDING, BACKFILL AND YARD RESTORATION TO INSTALL THE SERVICE LINE AT THE LOCATIONS SHOWN ON THE PLANS OR AS DIRECTED, IN ACCORDANCE WITH THE DETAILS ON THIS SHEET, SPECIFICATIONS AND STANDARD DRAWINGS, COMPLETE AND READY FOR USE. LEAD SERVICE LINES ENCOUNTERED BY THE EXCAVATION SHALL BE REPLACED FROM THE MAIN TO AND INCLUDING THE METER VAULT AND METER SETTING. PAID EACH (EA).

21- THE LOCATION OF UTILITIES SHOWN IN PROFILE IS APPROXIMATE AND BASED ON AN ASSUMED UNIFORM COVER. THE UTILITY LOCATION IN THE FIELD MAY VARY AS TO LOCATION AND DEPTH. THE CONTRACTOR SHALL BECOME FULLY RESPONSIBLE TO COORDINATE WITH ALL UTILITY OWNERS AND THEIR CONTRACTORS TO VERIFY THE LOCATION AND DEPTH OF THEIR UTILITY SERVICES. COST OF DOING SO SHALL BE INCIDENTAL TO THE OVERALL CONTRACT.

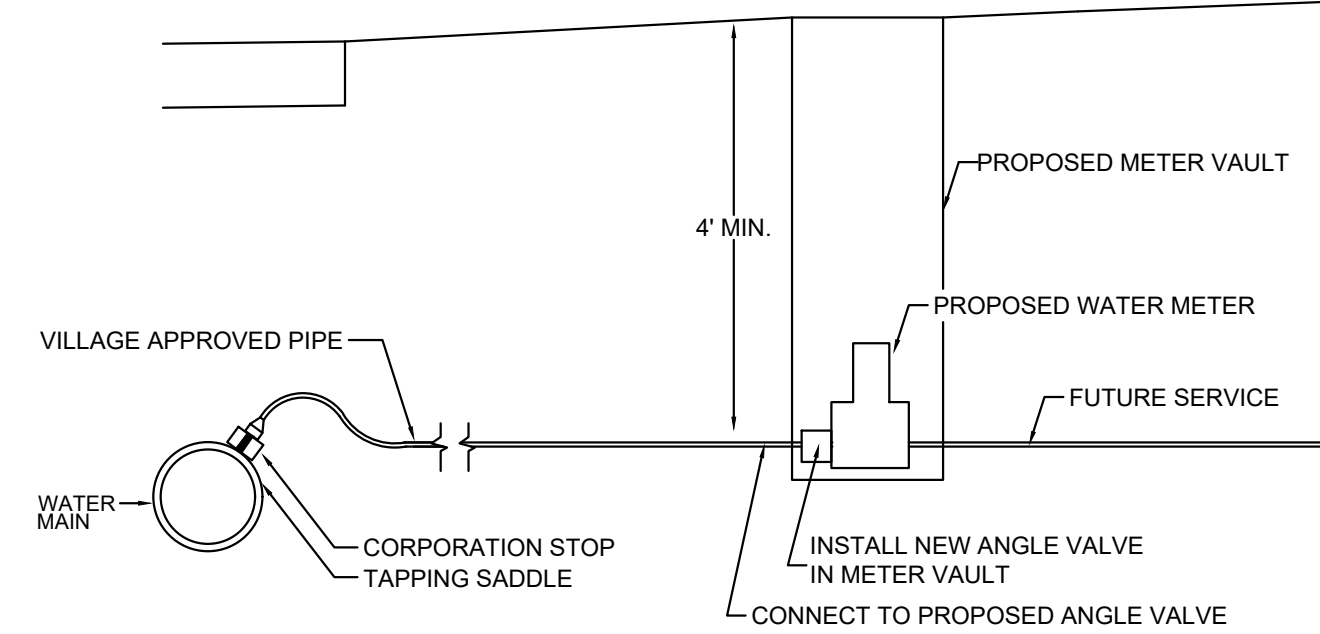

WATER MAIN AND RESIDENTIAL SERVICE CONNECTION (3/4") (STA. APPROX 13+94.50)

- NOTES:**
1. SERVICE LINES FROM THE WATER MAIN TO THE CURB STOP SHALL BE PVC C901 (250 P.S.I.), INSTALLED AT LEAST 4 FT. BELOW PAVEMENT SURFACE OR FINISHED GRADE.
 2. SERVICE LINES FROM THE CURB STOP TO THE EXISTING METER SHALL TYPE K COPPER LINE.



ISSUED FOR:	BID NO.	REVISION	DATE
ISSUE DATE: JANUARY 2025			
SCALE: AS SHOWN			
DESIGNED BY: JCOR			
DRAWN BY: AWAL			
CHECKED BY: SRIG			

TOLLGATE ROAD WATER MAIN REPLACEMENT - VILLAGE OF WILLIAMSBURG - CLERMONT, OHIO 45176

GENERAL NOTES & DETAILS

PROJECT NO. **242074**

DISCIPLINE **CIVIL**

SHEET NAME **NOTES**

SHEET	OF
2	9

2161 CHAMBER CENTER DRIVE
FORT MITCHELL, KENTUCKY 41017
TEL: (609) 325-0684
WWW.VERDANTAS.COM

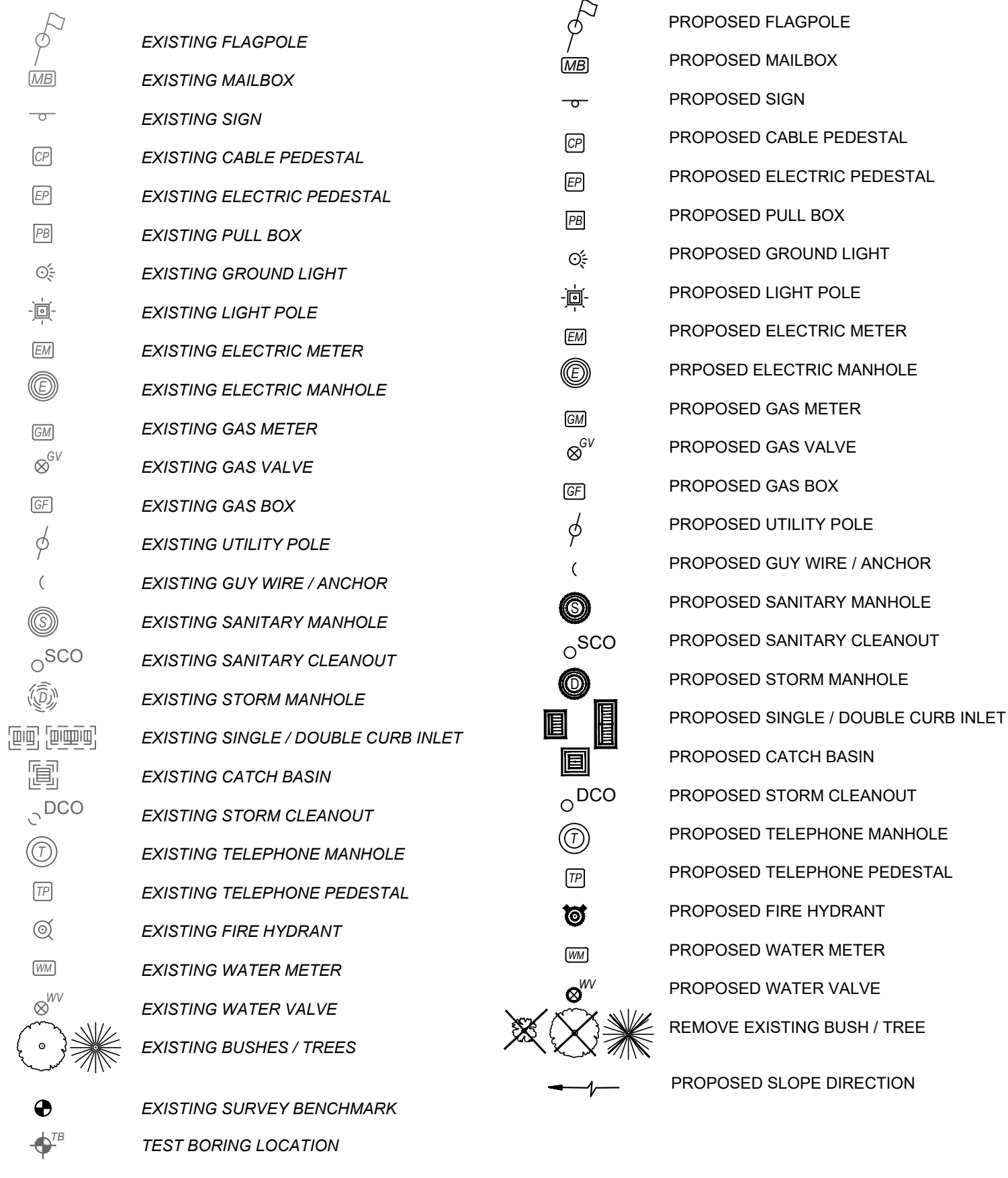
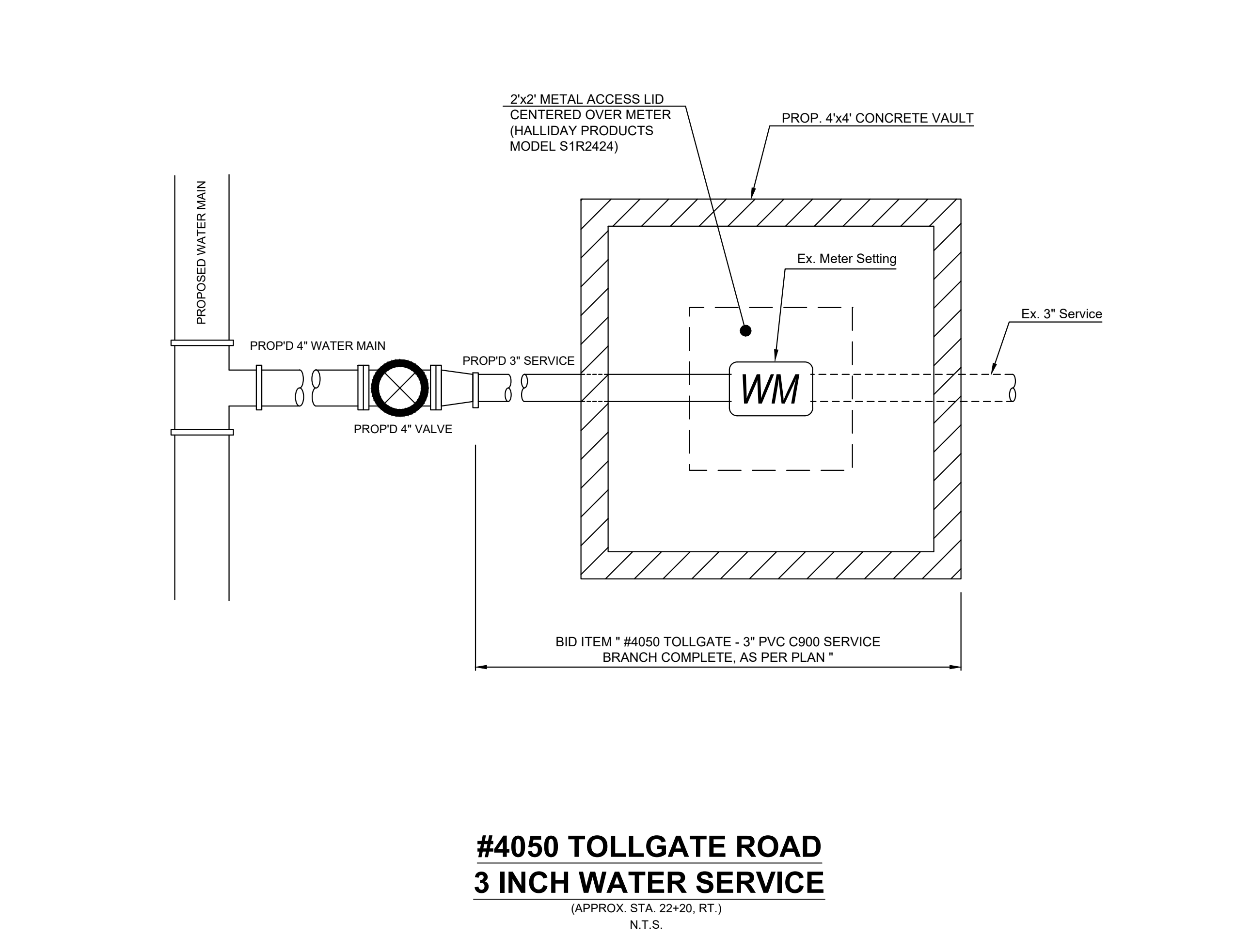
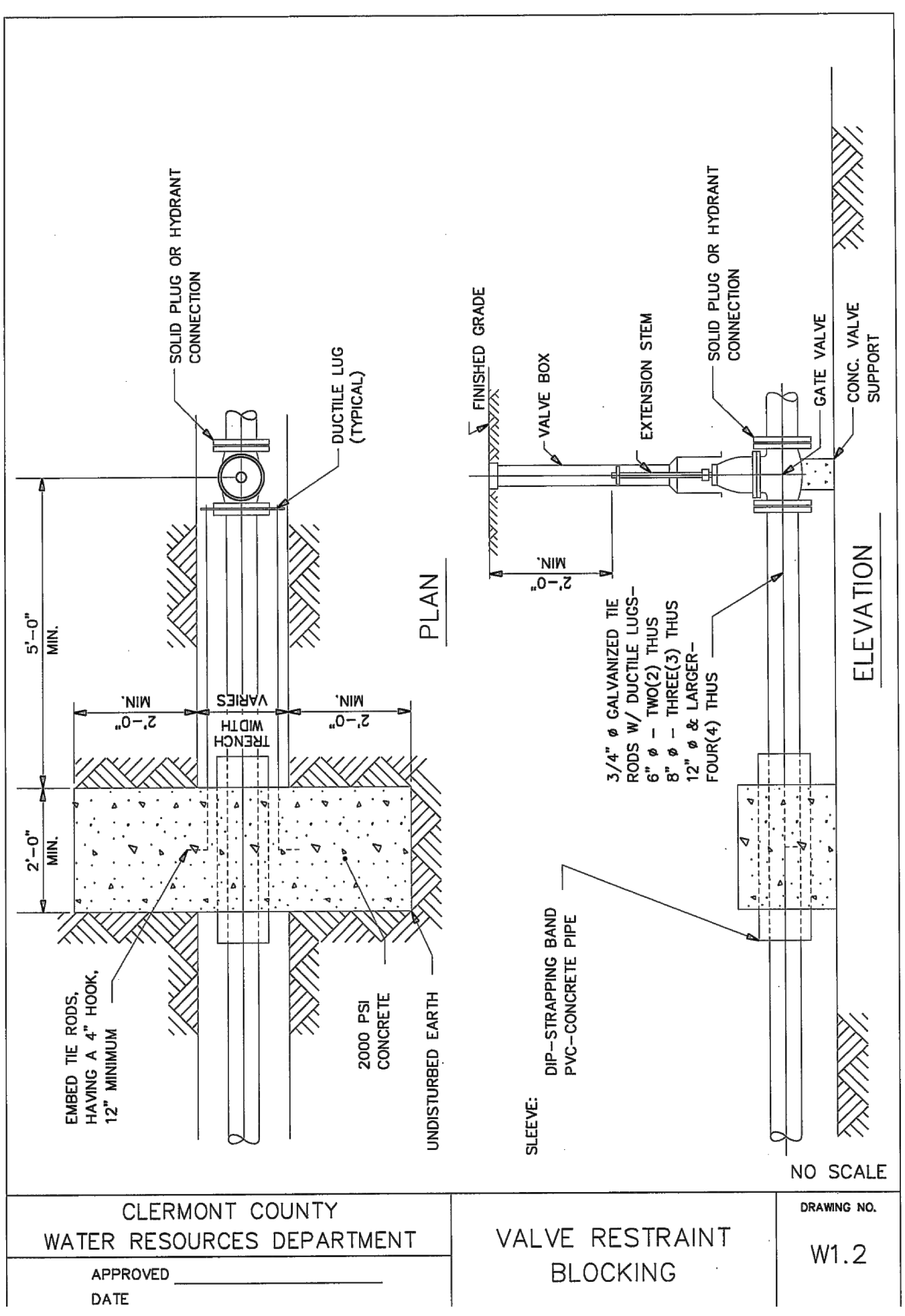
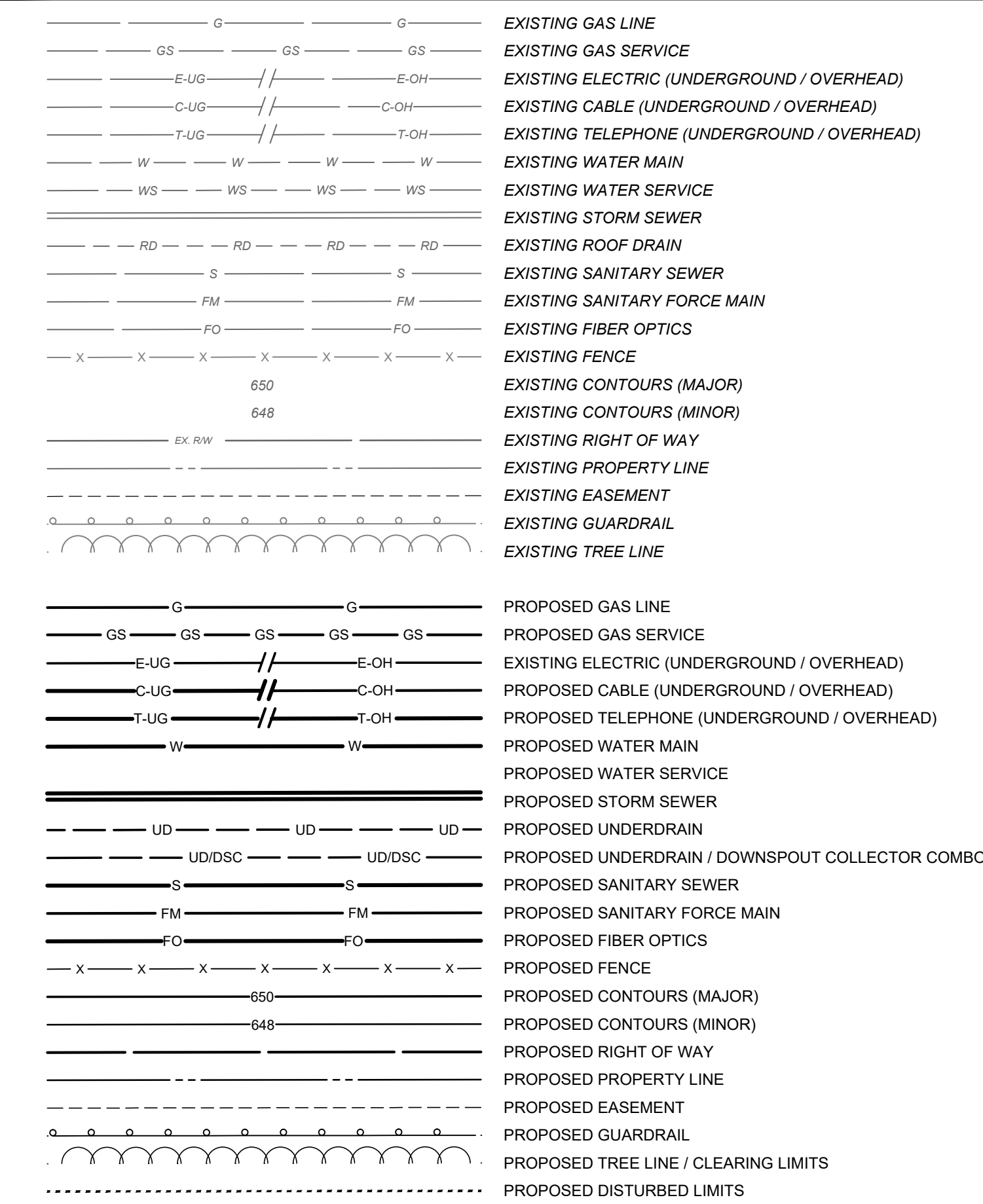
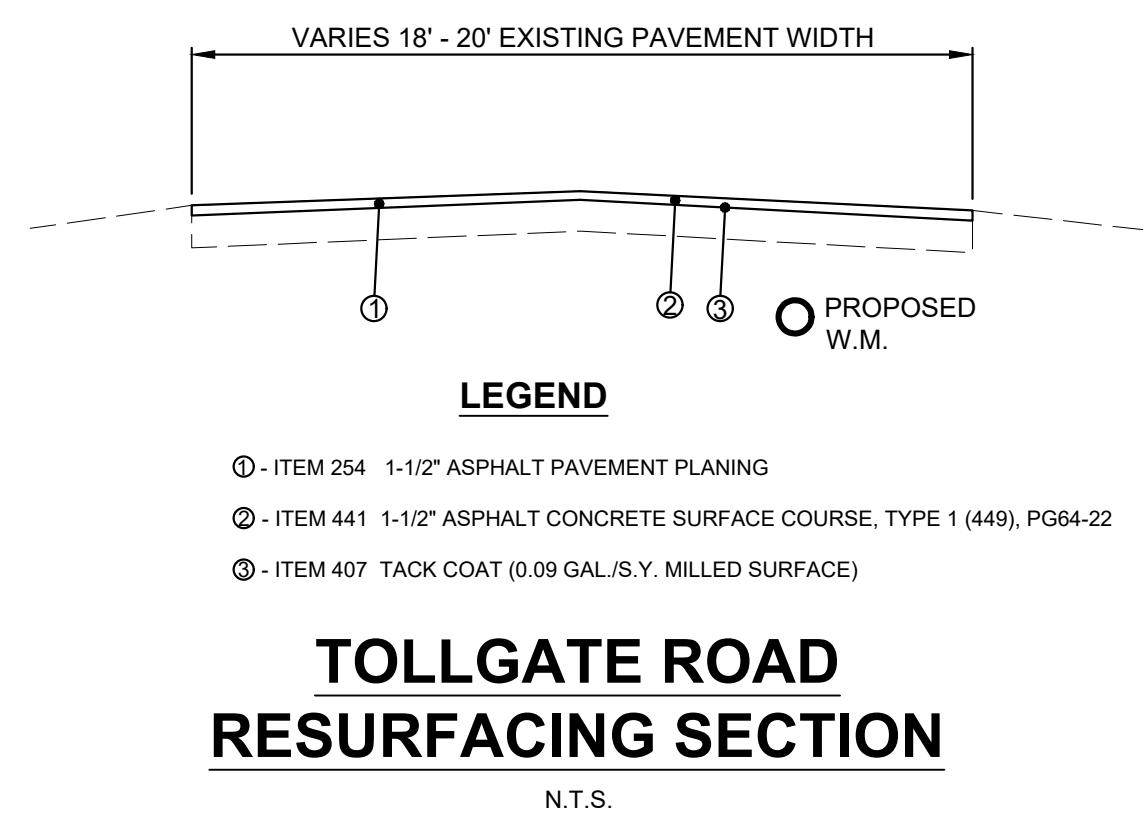
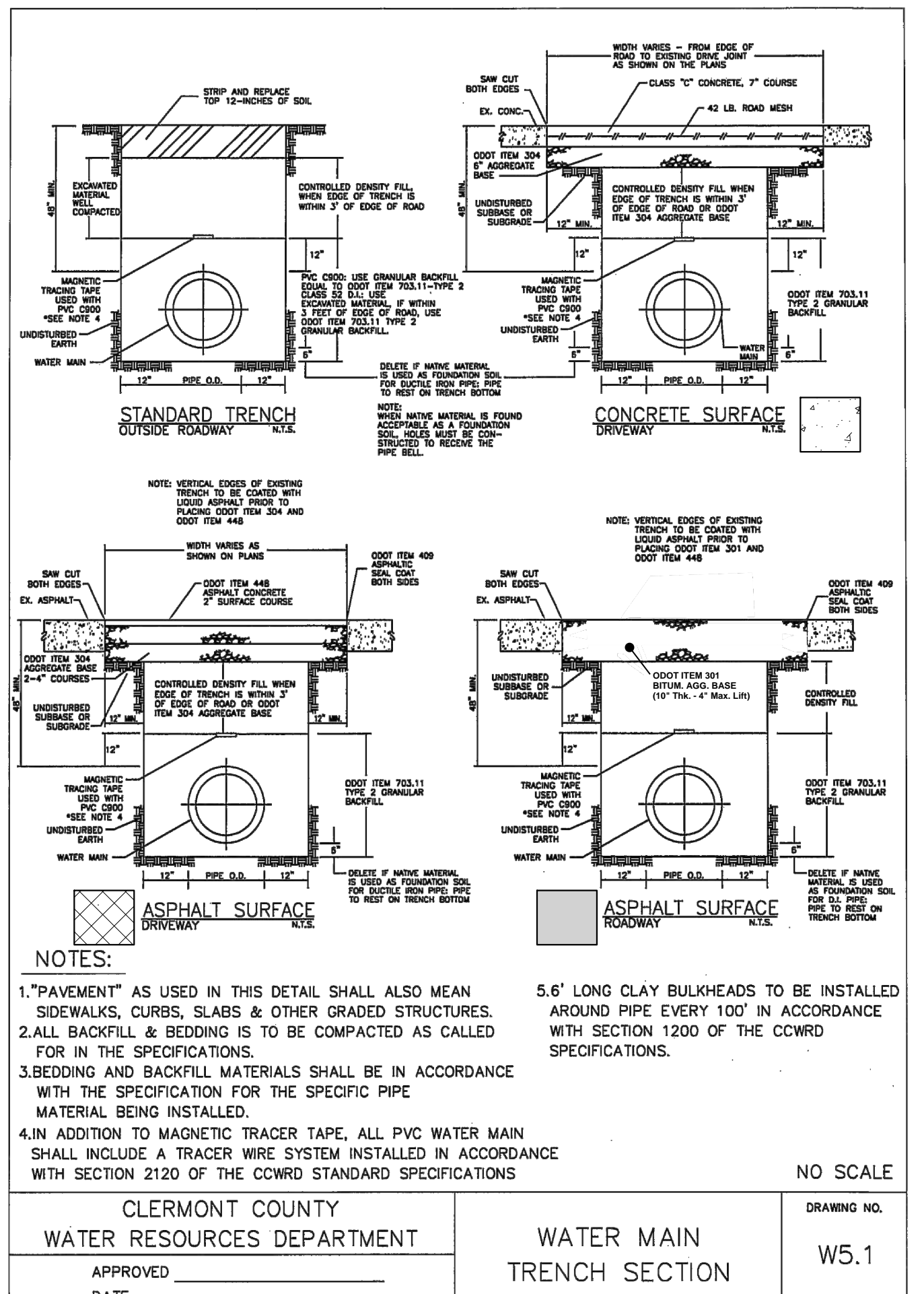
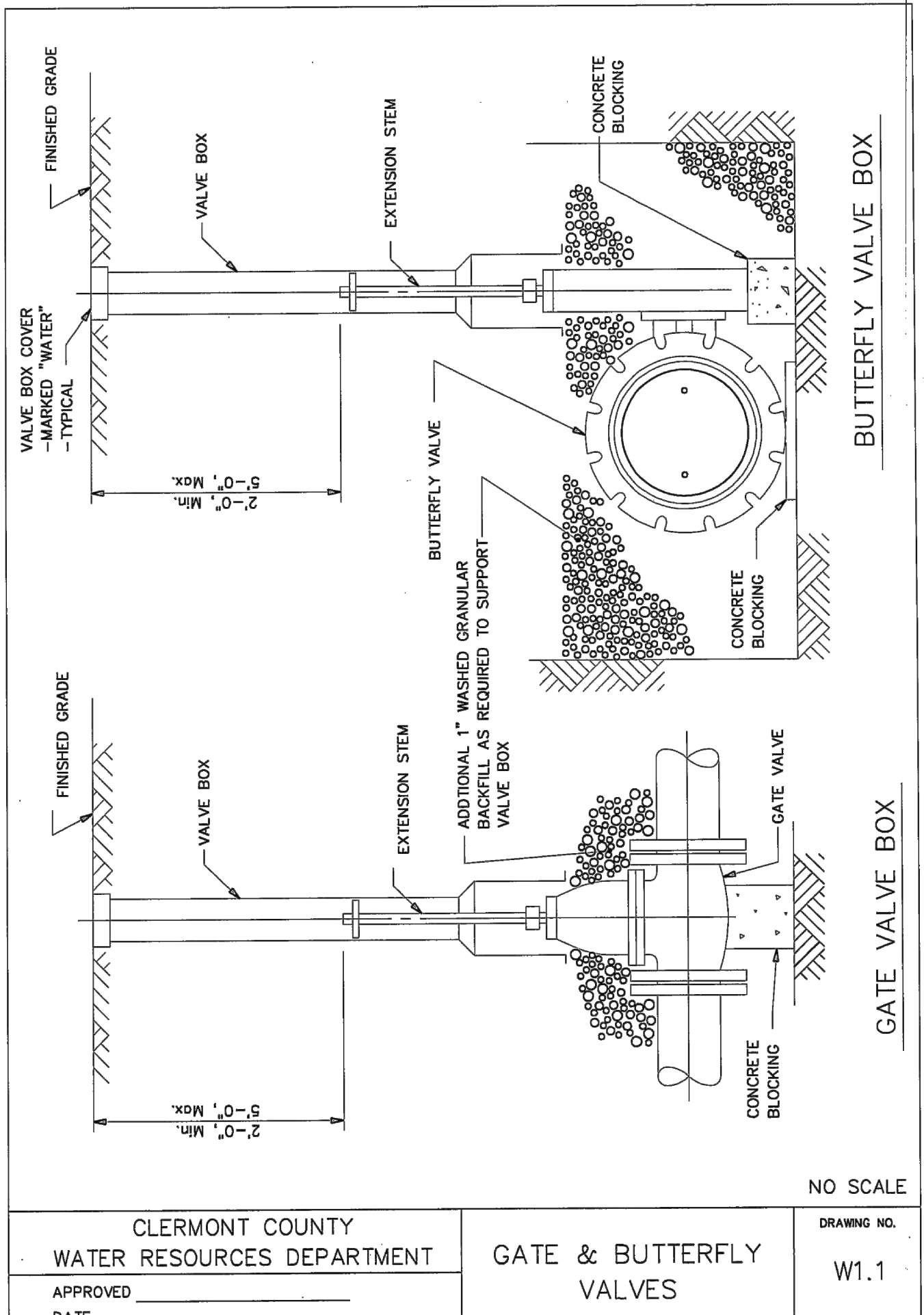

verdantas
2161 CHAMBER CENTER DRIVE
FORT MITCHELL, KENTUCKY 41017
TEL: (609) 325-0544
WWW.VERDANTAS.COM

**TOLLGATE ROAD WATER MAIN
REPLACEMENT
- VILLAGE OF WILLIAMSBURG -
CLERMONT, OHIO 45176**

DETAILS AND LEGEND

ISSUED FOR:	BID	NO	REVISION	DATE
ISSUE DATE: JANUARY 2025	242074			
SCALE: AS SHOWN				
DESIGNED BY: JCOR				
DRAWN BY: AWAL				
CHECKED BY: SRIS				

PROJECT NO.
242074

DISCIPLINE
CIVIL

SHEET NAME
DET-01

SHEET **3** OF **9**

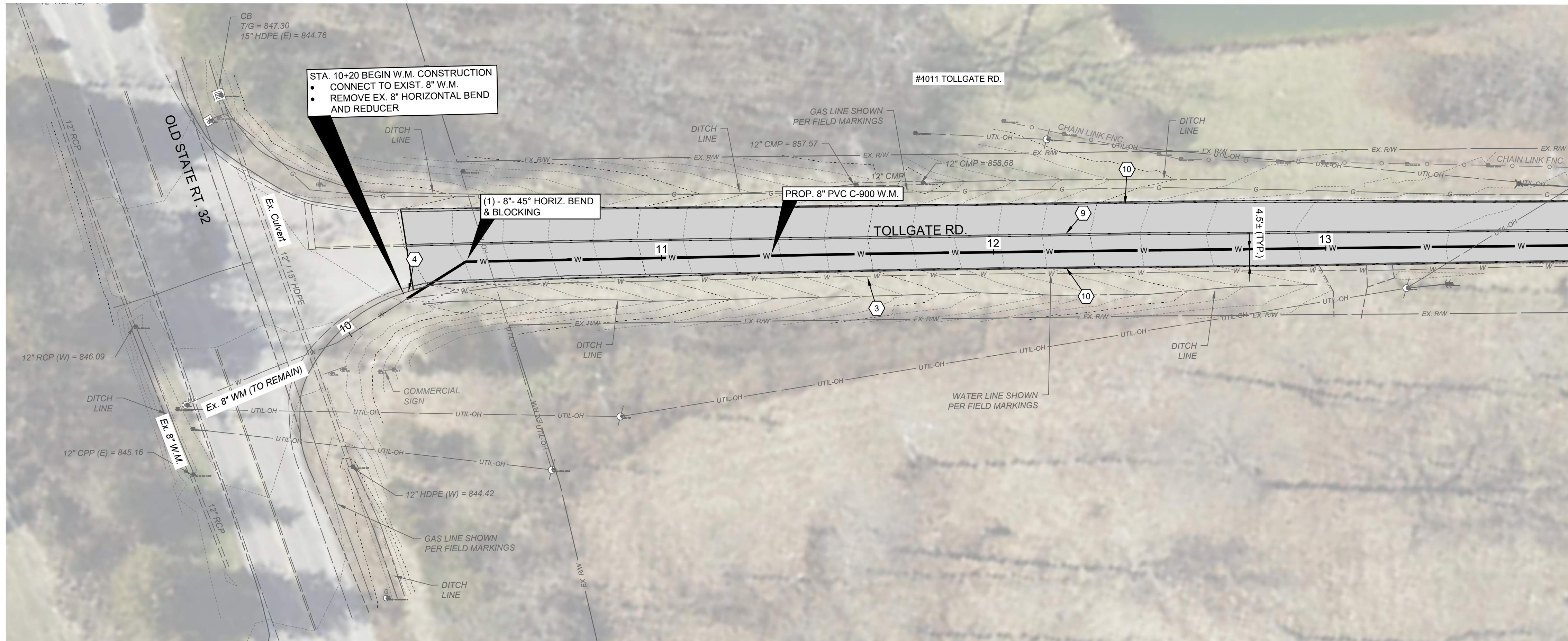

MATCH LINE 13+75

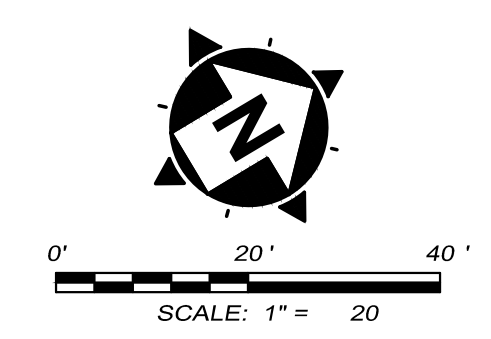

CONSTRUCTION NOTES

- 1 DO NOT DISTURB
- 2 MAINTAIN MANAGEABLE VERTICAL CLEARANCE BETWEEN THE PROPOSED WATER MAIN AND THE EXISTING STORM SEWER, WATER MAIN, TELEPHONE DUCTS, AND GAS MAIN. CONTRACTOR TO EXCAVATE & VERIFY ACTUAL LOCATION, SIZE AND ELEVATION OF EXISTING UTILITY PRIOR TO BEGINNING WATER MAIN CONSTRUCTION. THE CONTRACTOR SHALL NOTIFY THE ENGINEER PRIOR TO CONSTRUCTION OF ANY POTENTIAL CONFLICT. NO ADDITIONAL PAYMENT WILL BE MADE FOR THIS WORK AND THE COST SHALL BE INCLUDED IN THE BID ITEM FOR WATER MAIN.
- 3 PLUG AND ABANDON EXISTING WATER MAIN.
- 4 CONNECT TO EXISTING WATER MAIN. VERIFY ACTUAL ELEVATION PRIOR TO CONSTRUCTION.
- 5 PROPOSED FIRE HYDRANT ASSEMBLY, VALVE AND BLOCKING PER PLAN DETAIL SHEET. COORDINATE LOCATION WITH VILLAGE. ANCHOR VALVE TO TEE. WHEN REPLACING EXISTING HYDRANT, REMOVE AND SALVAGE EXISTING FIRE HYDRANT AND VALVE, RETURN TO VILLAGE WATER DEPT.
- 6 REMOVE AND REPLACE SERVICE LINE FROM THE NEW MAIN TO THE EXISTING WATER METER PER PLAN DETAIL SHEET 2. VILLAGE WILL RECONNECT NEW 3/4\"/>

HATCH LEGEND

- 2\"/>
- TREE REMOVED (INCIDENTAL TO CONTRACT)

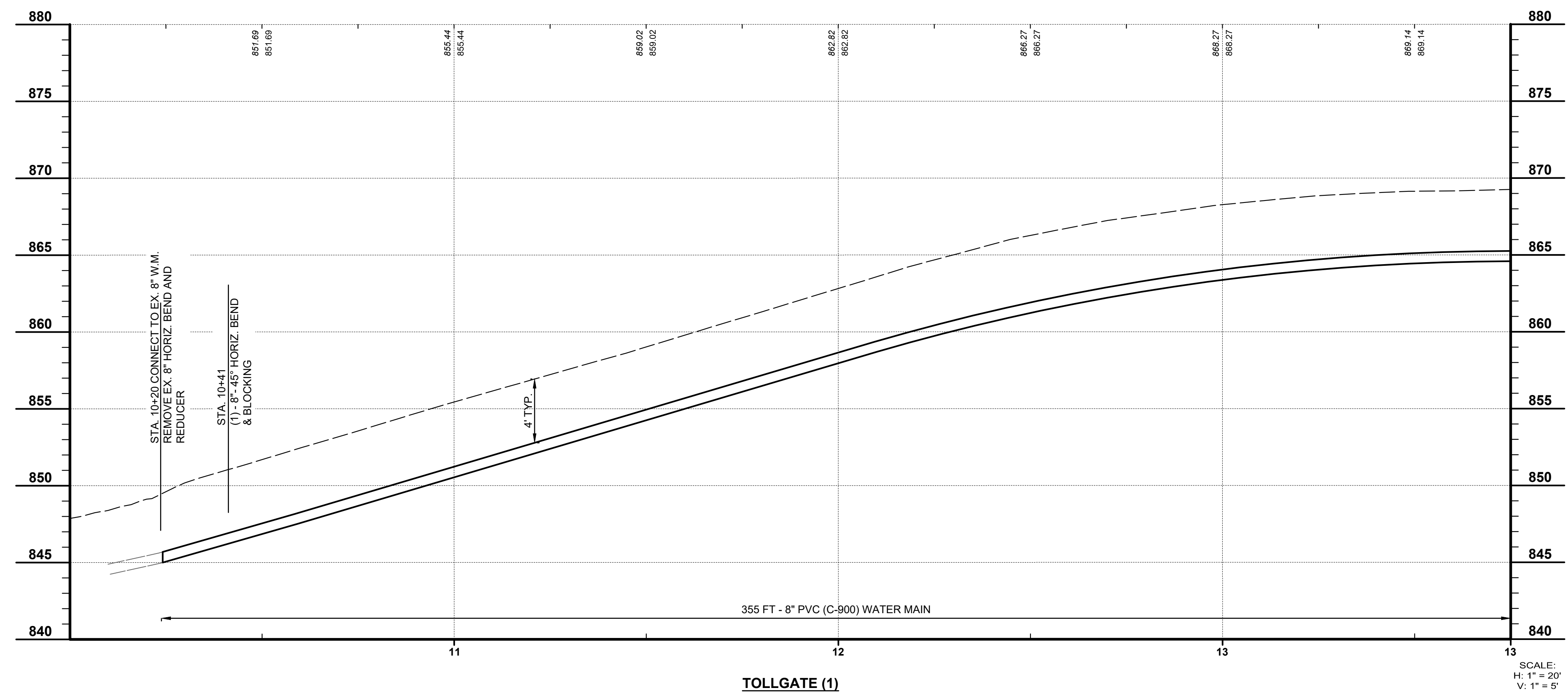

TOLLGATE (1)

SCALE:
H: 1" = 20'
V: 1" = 5'



ISSUED FOR:	BID NO.	DATE
ISSUE DATE: JANUARY 2025		
SCALE: AS SHOWN		
DESIGNED BY: JCOR		
DRAWN BY: AWAL		
CHECKED BY: SRIG		

TOLLGATE ROAD WATER MAIN REPLACEMENT
 - VILLAGE OF WILLIAMSBURG - CLEMMONT, OHIO 45176
PLAN AND PROFILE STA. 10+00 TO STA. 13+75

PROJECT NO. 242074	
DISCIPLINE CIVIL	
SHEET NAME PNP-01	
SHEET 4	OF 9

H:\2024\242074\DWG\B\EST\3_242074_PlanSet.dwg - PNP - 1/23/2025 4:36:45 PM - JAMES CORNELL

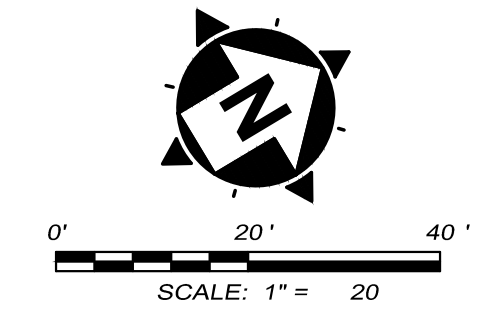
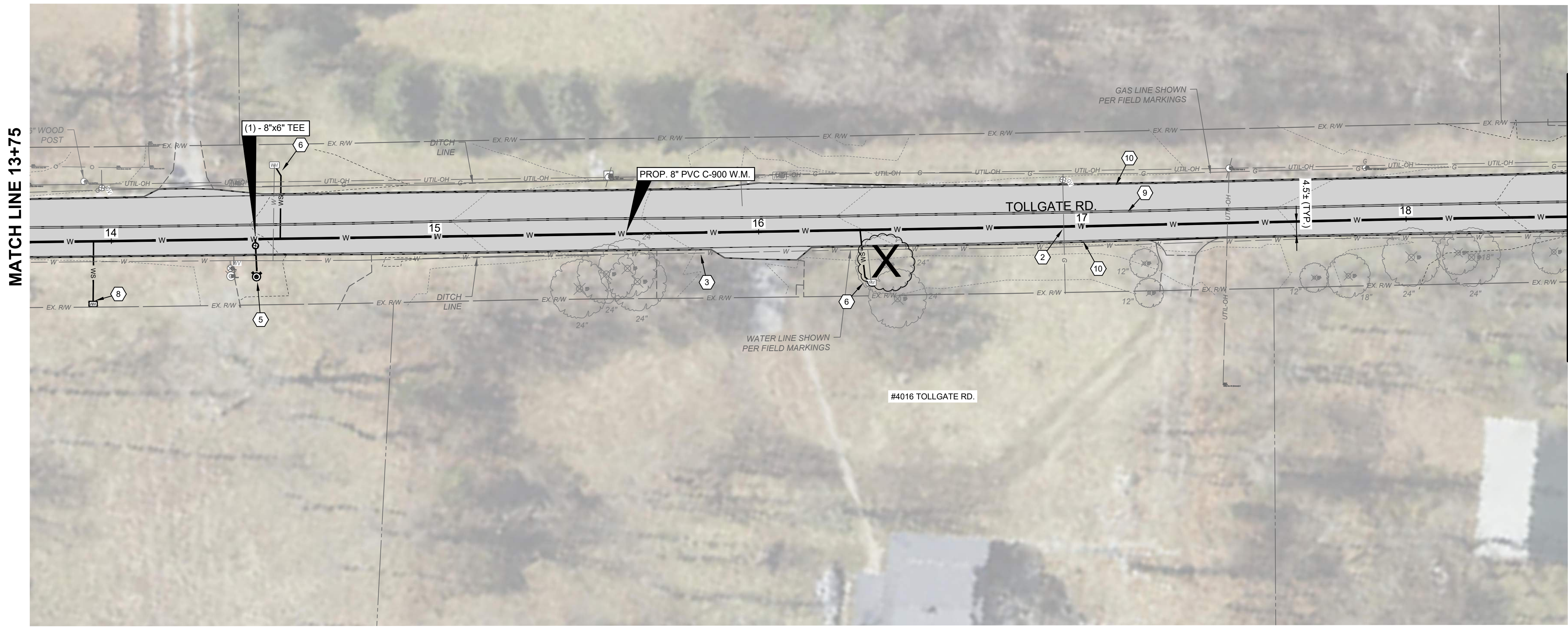

- CONSTRUCTION NOTES**
- 1 DO NOT DISTURB
 - 2 MAINTAIN MANAGEABLE VERTICAL CLEARANCE BETWEEN THE PROPOSED WATER MAIN AND THE EXISTING STORM SEWER, WATER MAIN, TELEPHONE DUCTS, AND GAS MAIN. CONTRACTOR TO EXCAVATE & VERIFY ACTUAL LOCATION, SIZE AND ELEVATION OF EXISTING UTILITY PRIOR TO BEGINNING WATER MAIN CONSTRUCTION. THE CONTRACTOR SHALL NOTIFY THE ENGINEER PRIOR TO CONSTRUCTION OF ANY POTENTIAL CONFLICT. NO ADDITIONAL PAYMENT WILL BE MADE FOR THIS WORK AND THE COST SHALL BE INCLUDED IN THE BID ITEM FOR WATER MAIN.
 - 3 PLUG AND ABANDON EXISTING WATER MAIN.
 - 4 CONNECT TO EXISTING WATER MAIN. VERIFY ACTUAL ELEVATION PRIOR TO CONSTRUCTION.
 - 5 PROPOSED FIRE HYDRANT ASSEMBLY, VALVE AND BLOCKING PER PLAN DETAIL SHEET. COORDINATE LOCATION WITH VILLAGE. ANCHOR VALVE TO TEE. WHEN REPLACING EXISTING HYDRANT, REMOVE AND SALVAGE EXISTING FIRE HYDRANT AND VALVE. RETURN TO VILLAGE WATER DEPT.
 - 6 REMOVE AND REPLACE SERVICE LINE FROM THE NEW MAIN TO THE EXISTING WATER METER PER PLAN DETAIL SHEET 2. VILLAGE WILL RECONNECT NEW 3/4" SERVICE LINE TO THE METER.
 - 7 REMOVE AND REPLACE 1-1/2" SERVICE LINE FROM THE NEW MAIN TO THE EXISTING WATER METER PER PLAN DETAIL SHEET 2. AND RECONNECT NEW SERVICE LINE TO EXISTING METER
 - 8 INSTALL NEW 3/4" COPPER SERVICE LINE. VILLAGE TO INSTALL SHUT OFF AND METER PIT
 - 9 ITEM 644 - 6" DOUBLE YELLOW CENTER LINE
 - 10 ITEM 644 - 4" WHITE EDGE LINE
 - 11 ITEM 644 - R/R SYMBOL

- HATCH LEGEND**
- 2" PROPOSED PAVEMENT MILLING AND RESURFACING - SEE DETAIL SHEET 3: RESURFACING SECTION
 - TREE REMOVED (INCIDENTAL TO CONTRACT)

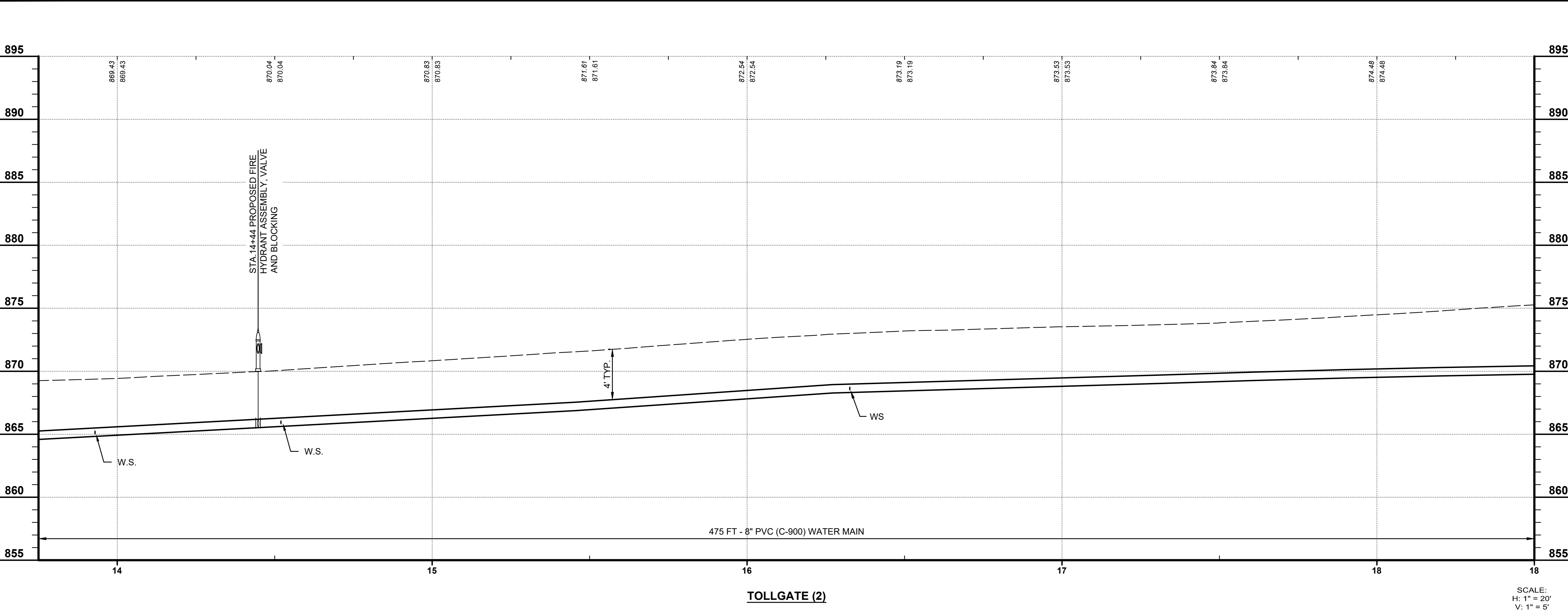

ISSUED FOR:	BID	NO	REVISION	DATE
ISSUE DATE:	JANUARY 2025			
SCALE:	AS SHOWN			
DESIGNED BY:	JCOR			
DRAWN BY:	AWAL			
CHECKED BY:	SRIG			

TOLLGATE ROAD WATER MAIN REPLACEMENT
 - VILLAGE OF WILLIAMSBURG - CLEERMONT, OHIO 45176

PLAN AND PROFILE
 STA. 13+75 TO STA. 18+00

PROJECT NO.	242074
DISCIPLINE	CIVIL
SHEET NAME	PNP-02
SHEET	OF
5	9

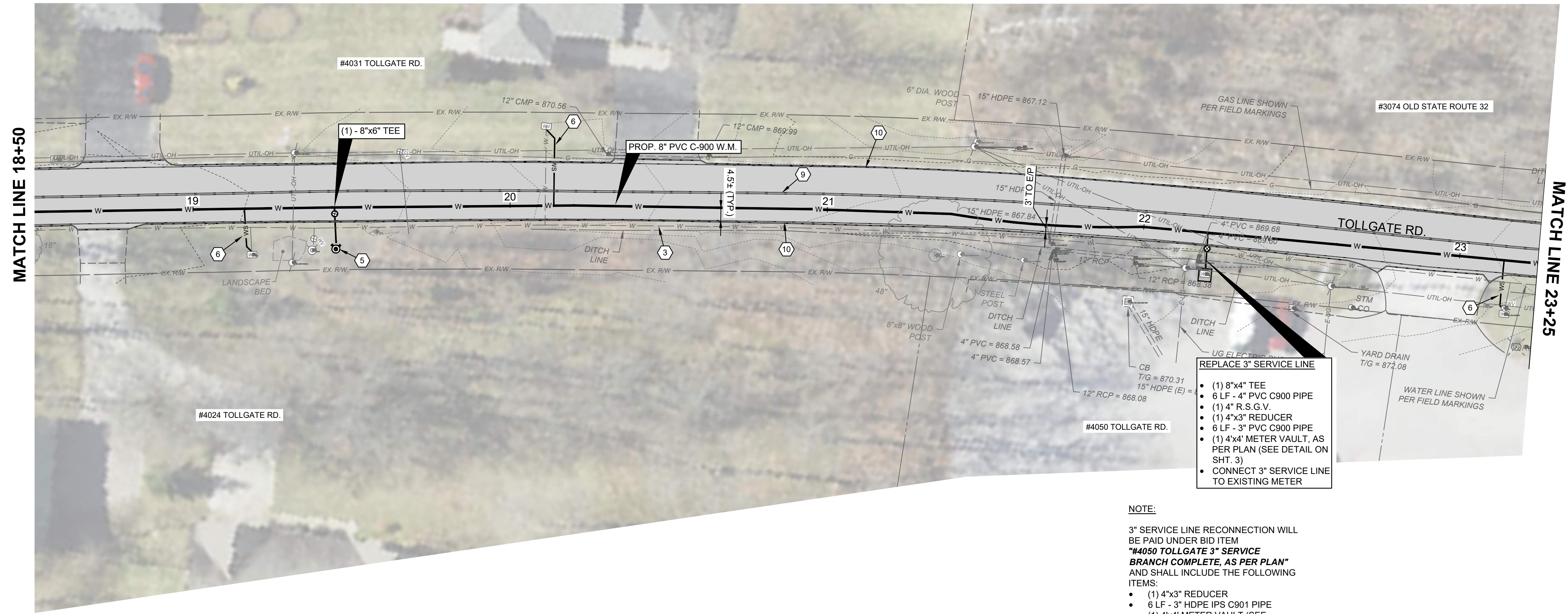

NOTE:
 3\"/>

- CONSTRUCTION NOTES**
- 1 DO NOT DISTURB
 - 2 MAINTAIN MANAGEABLE VERTICAL CLEARANCE BETWEEN THE PROPOSED WATER MAIN AND THE EXISTING STORM SEWER, WATER MAIN, TELEPHONE DUCTS, AND GAS MAIN. CONTRACTOR TO EXCAVATE & VERIFY ACTUAL LOCATION, SIZE AND ELEVATION OF EXISTING UTILITY PRIOR TO BEGINNING WATER MAIN CONSTRUCTION. THE CONTRACTOR SHALL NOTIFY THE ENGINEER PRIOR TO CONSTRUCTION OF ANY POTENTIAL CONFLICT. NO ADDITIONAL PAYMENT WILL BE MADE FOR THIS WORK AND THE COST SHALL BE INCLUDED IN THE BID ITEM FOR WATER MAIN.
 - 3 PLUG AND ABANDON EXISTING WATER MAIN.
 - 4 CONNECT TO EXISTING WATER MAIN. VERIFY ACTUAL ELEVATION PRIOR TO CONSTRUCTION.
 - 5 PROPOSED FIRE HYDRANT ASSEMBLY, VALVE AND BLOCKING PER PLAN DETAIL SHEET. COORDINATE LOCATION WITH VILLAGE. ANCHOR VALVE TO TEE WHEN REPLACING EXISTING HYDRANT, REMOVE AND SALVAGE EXISTING FIRE HYDRANT AND VALVE, RETURN TO VILLAGE WATER DEPT.
 - 6 REMOVE AND REPLACE SERVICE LINE FROM THE NEW MAIN TO THE EXISTING WATER METER PER PLAN DETAIL SHEET 2. VILLAGE WILL RECONNECT NEW 3\"/>

HATCH LEGEND

	2\"/>
	TREE REMOVED (INCIDENTAL TO CONTRACT)

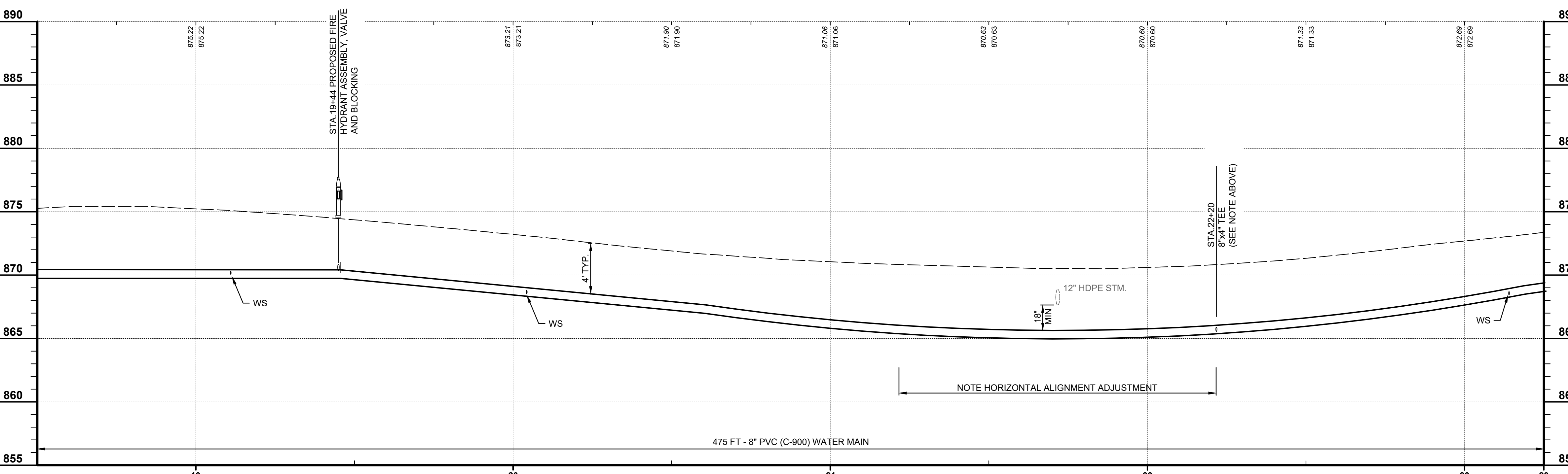

SCALE:
 H: 1\"/>



ISSUED FOR:	BID	DATE	REVISION	NO
ISSUE DATE:	JANUARY 2025			
SCALE:	AS SHOWN			
DESIGNED BY:	JCOR			
DRAWN BY:	AWAL			
CHECKED BY:	SRIG			

TOLLGATE ROAD WATER MAIN REPLACEMENT
 - VILLAGE OF WILLIAMSBURG -
 CLEERMONT, OHIO 45176

PLAN AND PROFILE
 STA. 18+50 TO STA. 23+25

PROJECT NO.	242074
DISCIPLINE	CIVIL
SHEET NAME	PNP-03
SHEET	6
OF	9

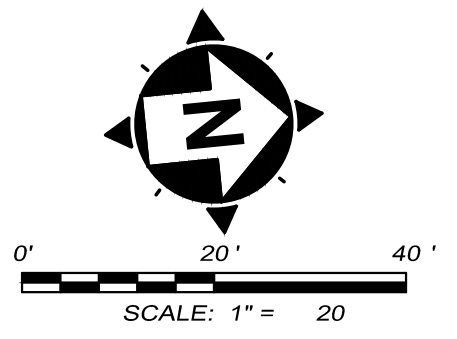
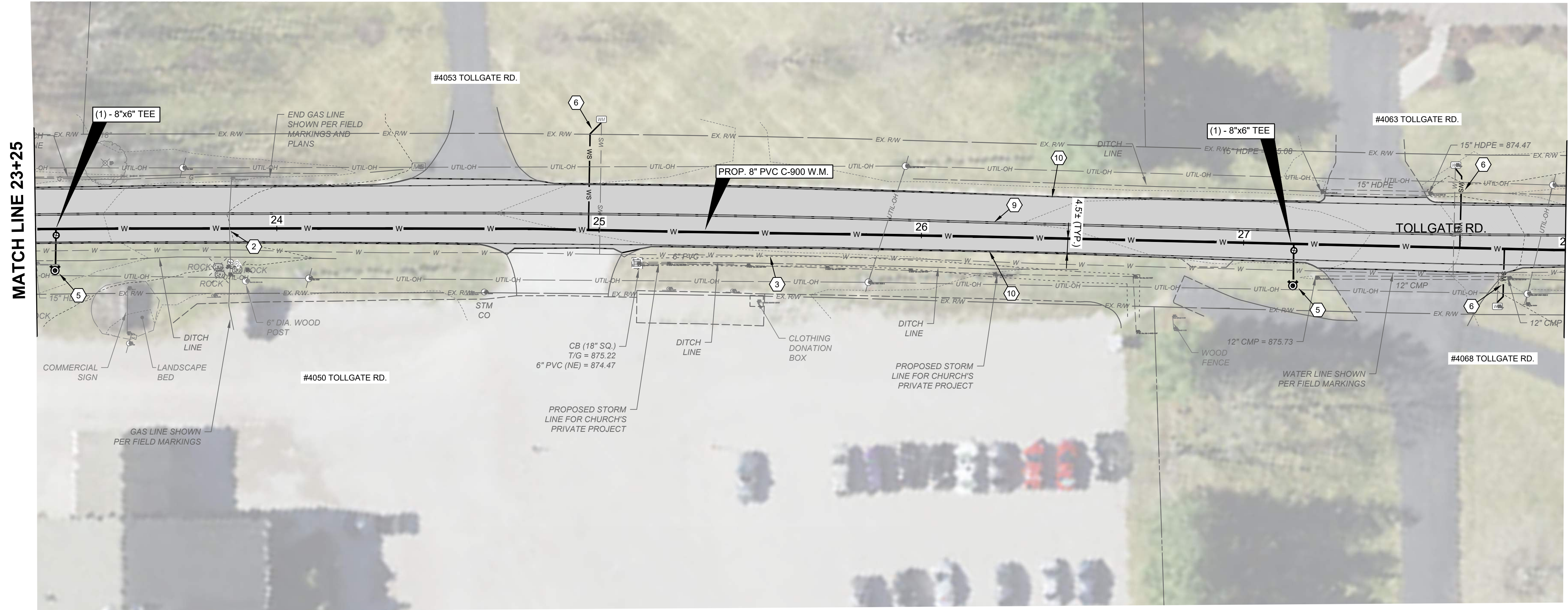

SCALE: 1" = 20'

CONSTRUCTION NOTES

- 1 DO NOT DISTURB
- 2 MAINTAIN MANAGEABLE VERTICAL CLEARANCE BETWEEN THE PROPOSED WATER MAIN AND THE EXISTING STORM SEWER, WATER MAIN, TELEPHONE DUCTS, AND GAS MAIN. CONTRACTOR TO EXCAVATE & VERIFY ACTUAL LOCATION, SIZE AND ELEVATION OF EXISTING UTILITY PRIOR TO BEGINNING WATER MAIN CONSTRUCTION. THE CONTRACTOR SHALL NOTIFY THE ENGINEER PRIOR TO CONSTRUCTION OF ANY POTENTIAL CONFLICT. NO ADDITIONAL PAYMENT WILL BE MADE FOR THIS WORK AND THE COST SHALL BE INCLUDED IN THE BID ITEM FOR WATER MAIN.
- 3 PLUG AND ABANDON EXISTING WATER MAIN.
- 4 CONNECT TO EXISTING WATER MAIN. VERIFY ACTUAL ELEVATION PRIOR TO CONSTRUCTION.
- 5 PROPOSED FIRE HYDRANT ASSEMBLY, VALVE AND BLOCKING PER PLAN DETAIL SHEET. COORDINATE LOCATION WITH VILLAGE. ANCHOR VALVE TO TEE. WHEN REPLACING EXISTING HYDRANT, REMOVE AND SALVAGE EXISTING FIRE HYDRANT AND VALVE, RETURN TO VILLAGE WATER DEPT.
- 6 REMOVE AND REPLACE SERVICE LINE FROM THE NEW MAIN TO THE EXISTING WATER METER PER PLAN DETAIL SHEET 2. VILLAGE WILL RECONNECT NEW 3/4" SERVICE LINE TO THE METER.
- 7 REMOVE AND REPLACE 1-1/2" SERVICE LINE FROM THE NEW MAIN TO THE EXISTING WATER METER PER PLAN DETAIL SHEET 2. AND RECONNECT NEW SERVICE LINE TO EXISTING METER
- 8 INSTALL NEW 3/4" COPPER SERVICE LINE. VILLAGE TO INSTALL SHUT OFF AND METER PIT
- 9 ITEM 644 - 6" DOUBLE YELLOW CENTER LINE
- 10 ITEM 644 - 4" WHITE EDGE LINE
- 11 ITEM 644 - R/R SYMBOL

HATCH LEGEND

- 2" PROPOSED PAVEMENT MILLING AND RESURFACING - SEE DETAIL SHEET 3: RESURFACING SECTION
- TREE REMOVED (INCIDENTAL TO CONTRACT)

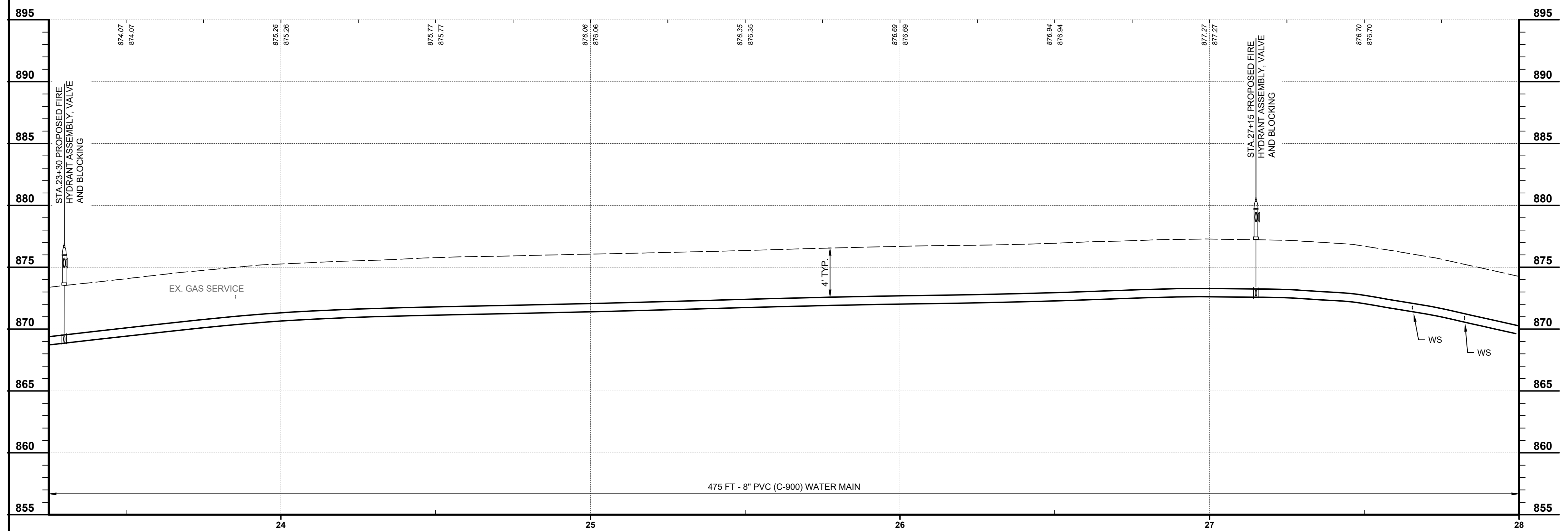

TOLLGATE (4)

SCALE:
H: 1" = 20'
V: 1" = 5'



ISSUED FOR:	BID	NO.	REVISION	DATE
ISSUE DATE:	JANUARY 2025			
SCALE:	AS SHOWN			
DESIGNED BY:	JCOR			
DRAWN BY:	AWAL			
CHECKED BY:	SRIG			

TOLLGATE ROAD WATER MAIN REPLACEMENT
- VILLAGE OF WILLIAMSBURG -
CLERMONT, OHIO 45176

PLAN AND PROFILE
STA. 23+25 TO STA. 28+00

PROJECT NO.	242074
DISCIPLINE	CIVIL
SHEET NAME	PNP-04
SHEET	7
OF	9

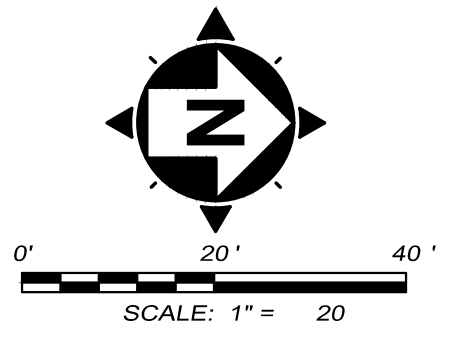
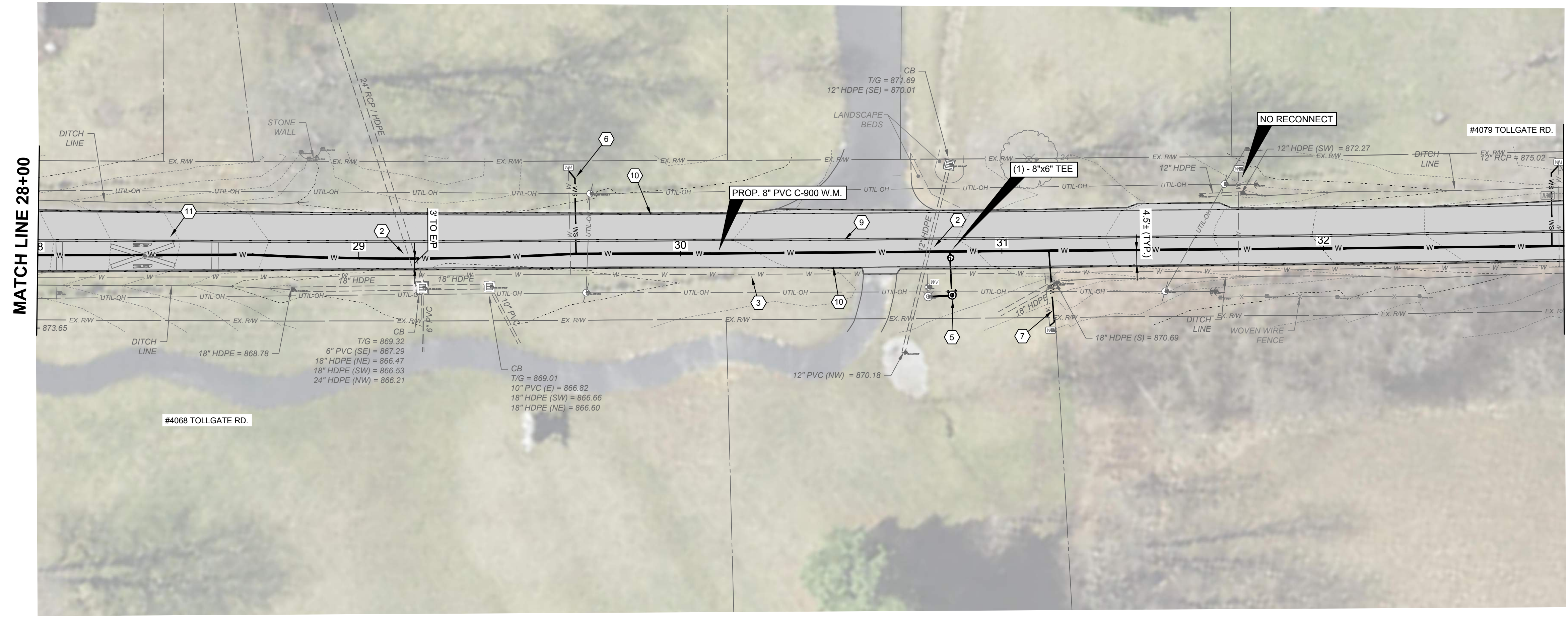

- CONSTRUCTION NOTES**
- 1 DO NOT DISTURB
 - 2 MAINTAIN MANAGEABLE VERTICAL CLEARANCE BETWEEN THE PROPOSED WATER MAIN AND THE EXISTING STORM SEWER, WATER MAIN, TELEPHONE DUCTS, AND GAS MAIN. CONTRACTOR TO EXCAVATE & VERIFY ACTUAL LOCATION, SIZE AND ELEVATION OF EXISTING UTILITY PRIOR TO BEGINNING WATER MAIN CONSTRUCTION. THE CONTRACTOR SHALL NOTIFY THE ENGINEER PRIOR TO CONSTRUCTION OF ANY POTENTIAL CONFLICT. NO ADDITIONAL PAYMENT WILL BE MADE FOR THIS WORK AND THE COST SHALL BE INCLUDED IN THE BID ITEM FOR WATER MAIN.
 - 3 PLUG AND ABANDON EXISTING WATER MAIN.
 - 4 CONNECT TO EXISTING WATER MAIN. VERIFY ACTUAL ELEVATION PRIOR TO CONSTRUCTION.
 - 5 PROPOSED FIRE HYDRANT ASSEMBLY, VALVE AND BLOCKING PER PLAN DETAIL SHEET. COORDINATE LOCATION WITH VILLAGE. ANCHOR VALVE TO TEE. WHEN REPLACING EXISTING HYDRANT, REMOVE AND SALVAGE EXISTING FIRE HYDRANT AND VALVE. RETURN TO VILLAGE WATER DEPT.
 - 6 REMOVE AND REPLACE SERVICE LINE FROM THE NEW MAIN TO THE EXISTING WATER METER PER PLAN DETAIL SHEET 2. VILLAGE WILL RECONNECT NEW 3/4\"/>
 - 7 REMOVE AND REPLACE 1-1/2\"/>
 - 8 INSTALL NEW 3/4\"/>
 - 9 ITEM 644 - 6\"/>
 - 10 ITEM 644 - 4\"/>
 - 11 ITEM 644 - R/R SYMBOL

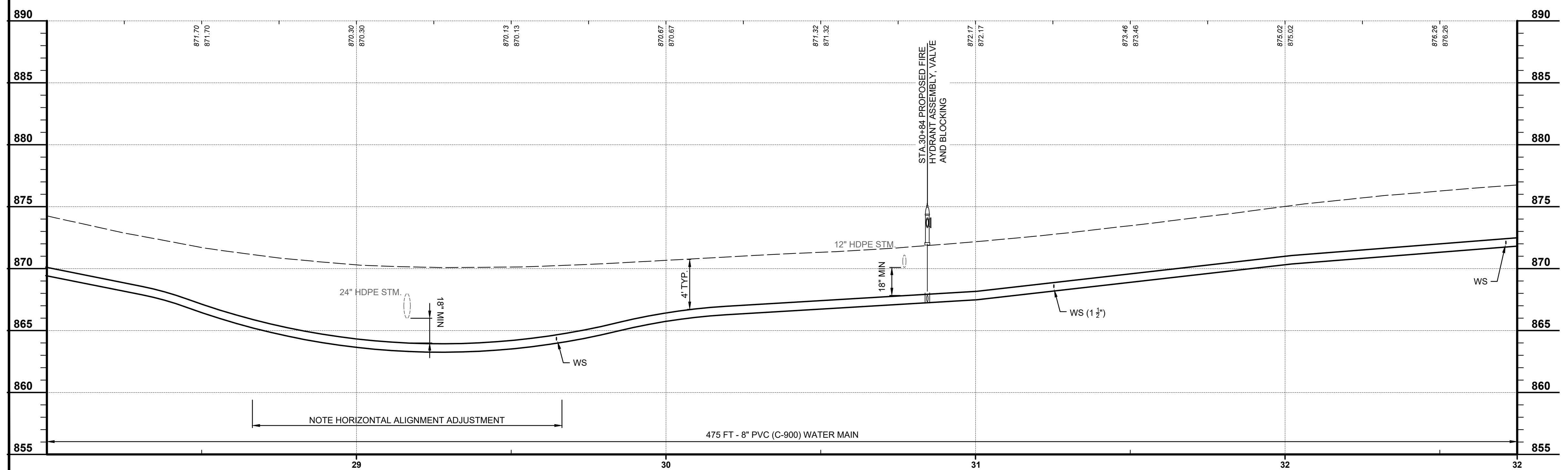
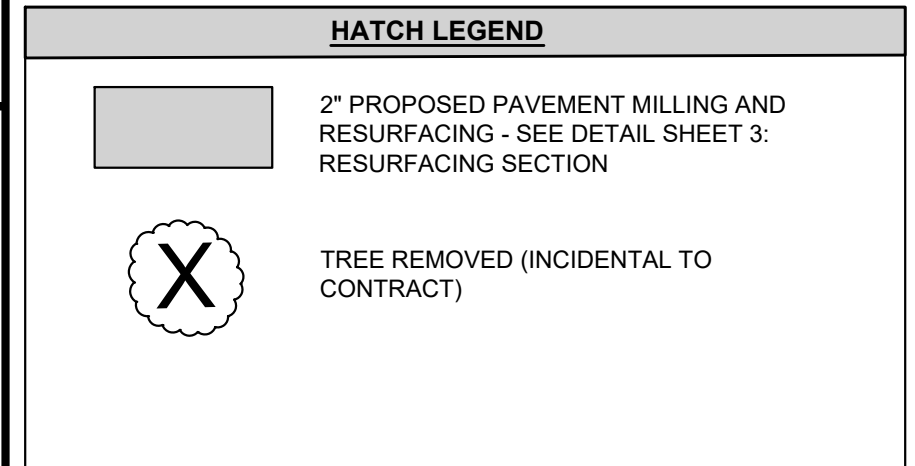

SCALE:
H: 1" = 20'
V: 1" = 5'



2161 CHAMBER CENTER DRIVE
FORT MITCHELL, KENTUCKY 41017
TEL: (609) 325-0544
WWW.VERDANTAS.COM

ISSUED FOR:	BID NO.	DATE	REVISION
ISSUE DATE: JANUARY 2025			
SCALE: AS SHOWN			
DESIGNED BY: JCOR			
DRAWN BY: AWAL			
CHECKED BY: SRIG			

TOLLGATE ROAD WATER MAIN REPLACEMENT - VILLAGE OF WILLIAMSBURG - CLEMONT, OHIO 45176

PLAN AND PROFILE STA. 28+00 TO STA. 32+75

PROJECT NO. 242074	
DISCIPLINE CIVIL	
SHEET NAME PNP-01	
SHEET 8	OF 9

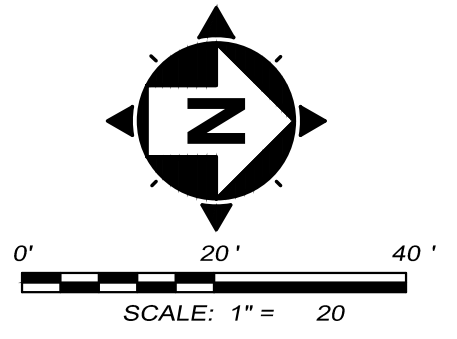
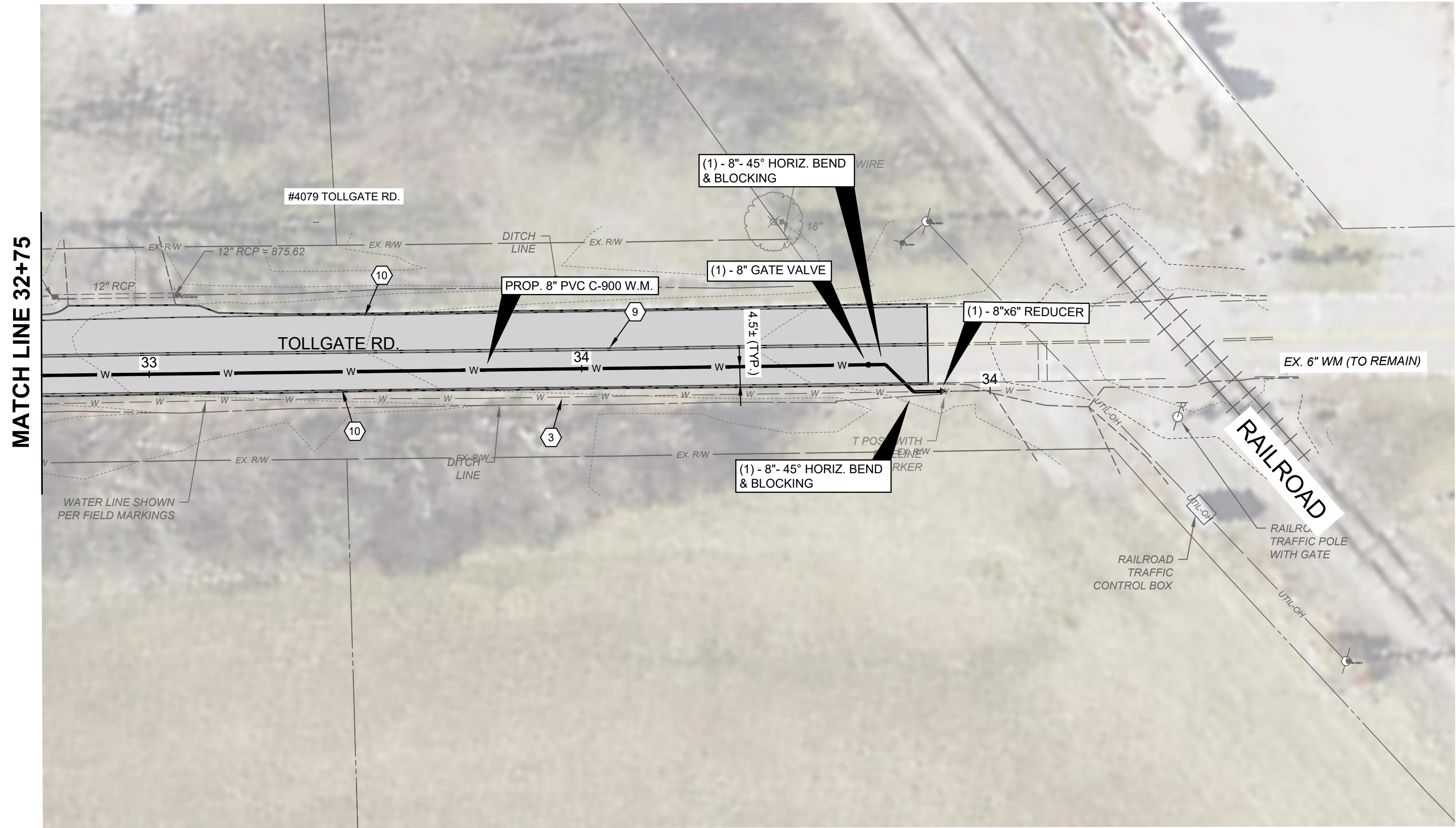

CONSTRUCTION NOTES

- 1 DO NOT DISTURB
- 2 MAINTAIN MANAGEABLE VERTICAL CLEARANCE BETWEEN THE PROPOSED WATER MAIN AND THE EXISTING STORM SEWER, WATER MAIN, TELEPHONE DUCTS, AND GAS MAIN. CONTRACTOR TO EXCAVATE & VERIFY ACTUAL LOCATION, SIZE AND ELEVATION OF EXISTING UTILITY PRIOR TO BEGINNING WATER MAIN CONSTRUCTION. THE CONTRACTOR SHALL NOTIFY THE ENGINEER PRIOR TO CONSTRUCTION OF ANY POTENTIAL CONFLICT. NO ADDITIONAL PAYMENT WILL BE MADE FOR THIS WORK AND THE COST SHALL BE INCLUDED IN THE BID ITEM FOR WATER MAIN.
- 3 PLUG AND ABANDON EXISTING WATER MAIN.
- 4 CONNECT TO EXISTING WATER MAIN. VERIFY ACTUAL ELEVATION PRIOR TO CONSTRUCTION.
- 5 PROPOSED FIRE HYDRANT ASSEMBLY, VALVE AND BLOCKING PER PLAN DETAIL SHEET. COORDINATE LOCATION WITH VILLAGE. ANCHOR VALVE TO TEE. WHEN REPLACING EXISTING HYDRANT, REMOVE AND SALVAGE EXISTING FIRE HYDRANT AND VALVE. RETURN TO VILLAGE WATER DEPT.
- 6 REMOVE AND REPLACE SERVICE LINE FROM THE NEW MAIN TO THE EXISTING WATER METER PER PLAN DETAIL SHEET 2. VILLAGE WILL RECONNECT NEW 3/4" SERVICE LINE TO THE METER.
- 7 REMOVE AND REPLACE 1-1/2" SERVICE LINE FROM THE NEW MAIN TO THE EXISTING WATER METER PER PLAN DETAIL SHEET 2. AND RECONNECT NEW SERVICE LINE TO EXISTING METER
- 8 INSTALL NEW 3/4" COPPER SERVICE LINE. VILLAGE TO INSTALL SHUT OFF AND METER PIT
- 9 ITEM 644 - 6" DOUBLE YELLOW CENTER LINE
- 10 ITEM 644 - 4" WHITE EDGE LINE
- 11 ITEM 644 - R/R SYMBOL

HATCH LEGEND

- 2" PROPOSED PAVEMENT MILLING AND RESURFACING - SEE DETAIL SHEET 3: RESURFACING SECTION
- TREE REMOVED (INCIDENTAL TO CONTRACT)

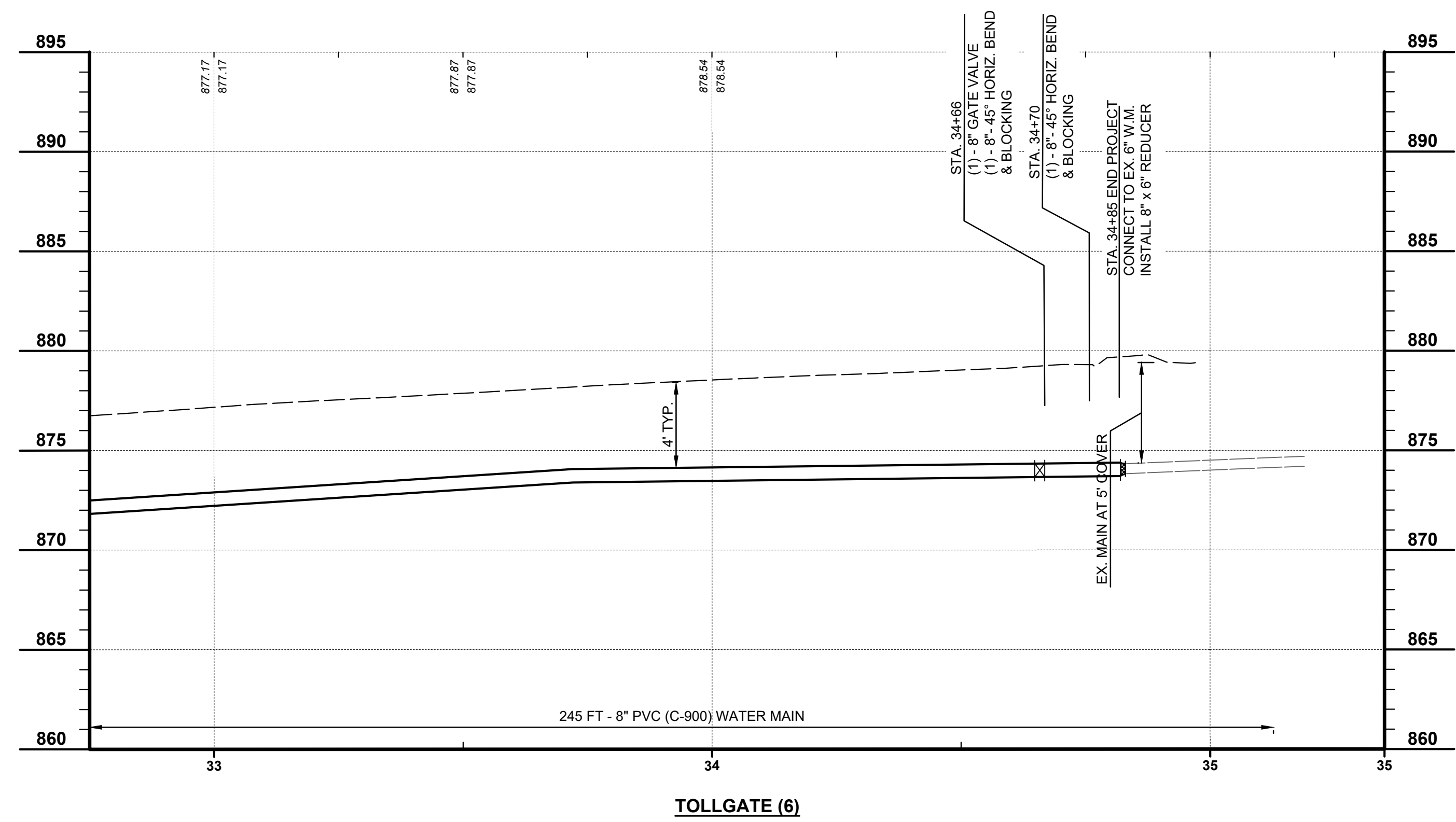

SCALE:
H: 1" = 20'
V: 1" = 5'



ISSUED FOR:	BID NO.	REVISION	DATE
ISSUE DATE: JANUARY 2025			
SCALE: AS SHOWN			
DESIGNED BY: JCOR			
DRAWN BY: AWAL			
CHECKED BY: SRIG			

TOLLGATE ROAD WATER MAIN REPLACEMENT
- VILLAGE OF WILLIAMSBURG -
CLERMONT, OHIO 45176

PLAN AND PROFILE
STA. 32+75 TO STA. 35+35

PROJECT NO.	242074
DISCIPLINE	CIVIL
SHEET NAME	PNP-01
SHEET	9
OF	9