

CITY OF WOODLAWN
HAMILTON COUNTY, OHIO
GLENDALE-MILFORD
SIDEWALK IMPROVEMENTS
241608

MAYOR
BRIAN K. POOLE
VILLAGE MANAGER
TIMOTHY ENGEL
VILLAGE COUNCIL
ESTER BOYD
ROSEMARY BROWN
PAMELA FITZGERALD
ROBERT LAWSON
CYNDI CHANDLER
MICHELLE STAR

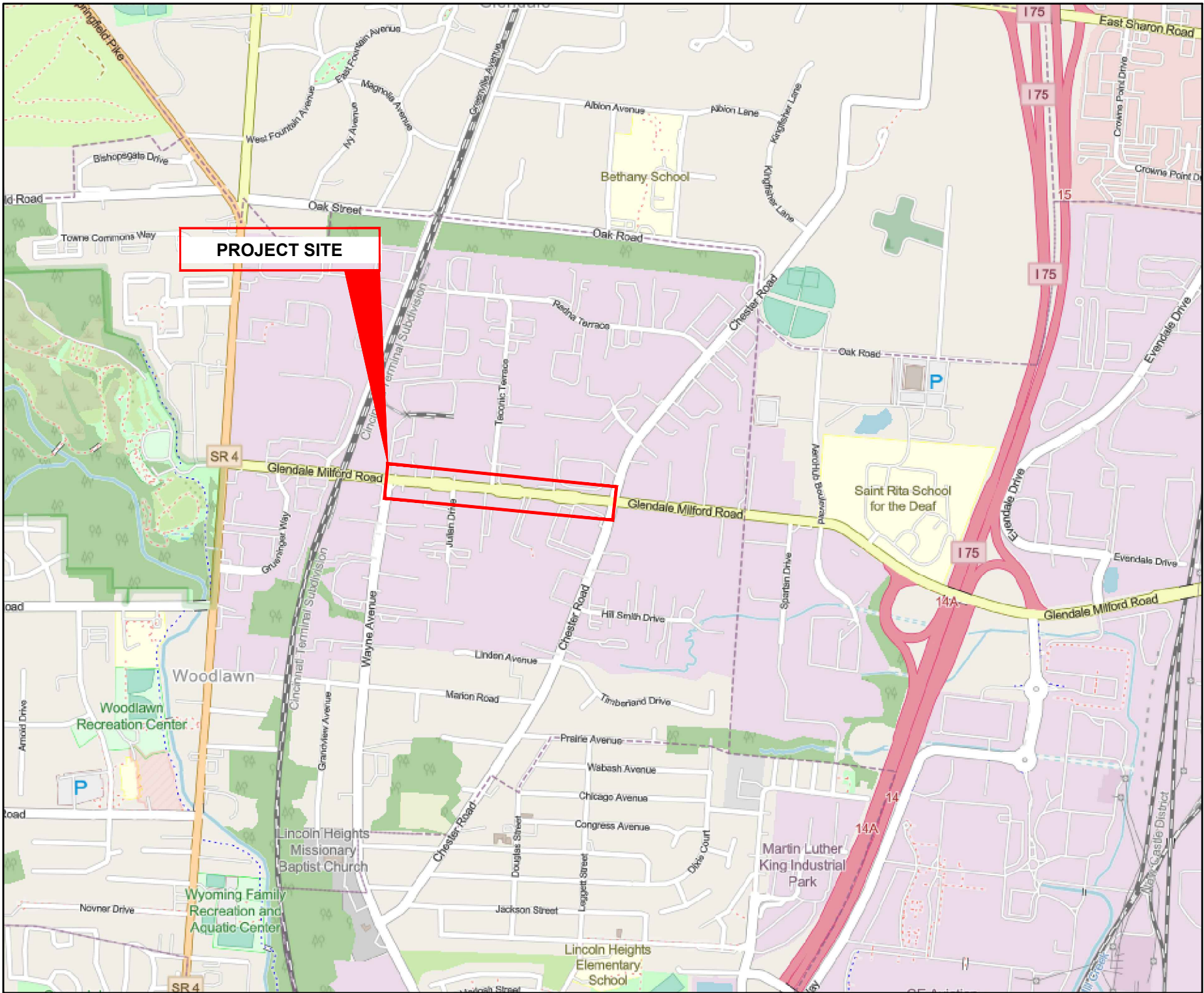

VICINITY MAP

ODOT STANDARD DRAWINGS
THE CURRENT EDITION OF THE ODOT STANDARD
DRAWINGS ARE HEREBY MADE PART OF THESE PLANS.

PROJECT SPECIFICATIONS
IN GENERAL, THE PROJECT SPECIFICATIONS CONFORM TO THE
JANUARY 1, 2023 STANDARD SPECIFICATIONS OF THE STATE OF OHIO,
DEPARTMENT OF TRANSPORTATION, INCLUDING CHANGES AND
SUPPLEMENTAL SPECIFICATIONS THERETO.
THE PROJECT SPECIFICATIONS, UNDER SEPERATE COVER,
PREPARED BY VERDANTAS SHALL GOVERN ALL
WORK AND MATERIALS FOR THIS PROJECT.

UNDERGROUND UTILITIES
Contact Two Working Days
Before You Dig

Sheet List Table	
NO.	SHEET NAME
1	TITLE
2	GENERAL NOTES
3	LAYOUT PLAN STA. 36+00 - STA. 44+50
4	LAYOUT PLAN STA. 44+50 - STA. 53+50
5	LAYOUT PLAN STA. 53+50 - STA. 58+00
6	DRIVEWAY PROFILES
7	TURN DOWN SLAB SECTION VIEWS
8	SITE DETAILS

ODOT SCD REFERENCES		
BP-5.1	CONCRETE CURBS AND COMBINED CURB AND GUTTER	1/17/2025
BP-7.1	NEW CURB RAMPS	1/17/2025

MORK LACHNIET

P.E. 71746



NO.	REVISION	DATE





**GLENDALE-MILFORD
SIDEWALK IMPROVEMENTS 2025
- THE VILLAGE OF WOODLAWN -**

TITLE

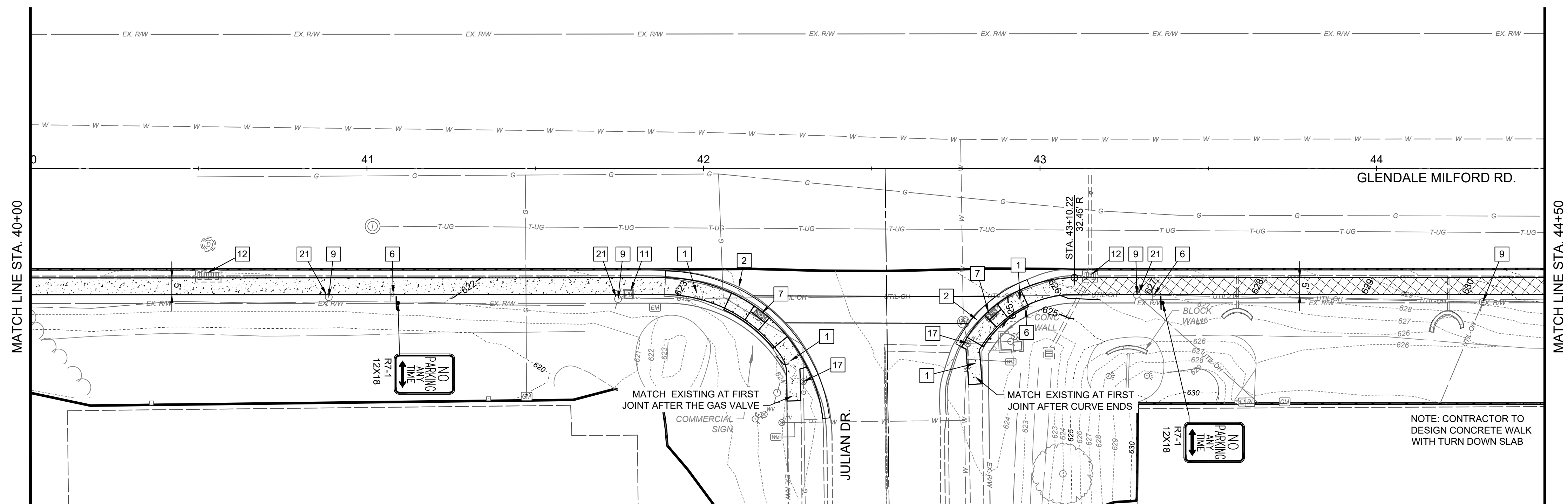
PROJECT NO. 241608	
DISCIPLINE CIVIL	
SHEET NAME TTL	
SHEET 1	OF 8

GENERAL NOTES	GENERAL NOTES	MAINTENANCE OF TRAFFIC NOTES	HATCH LEGEND	SYMBOL LEGEND	
<div><div>1. UNLESS SPECIFICALLY SET FORTH HEREIN, ALL CONSTRUCTION AND MATERIALS SHALL CONFORM TO THESE PLANS AND SPECIFICATIONS, THE LATEST EDITION OF THE STATE OF OHIO DEPARTMENT OF TRANSPORTATION CONSTRUCTION AND MATERIAL SPECIFICATIONS.</div><div>2. EXPANSION MATERIAL FOR CONCRETE SIDEWALKS, DRIVEWAY APRONS, CURBS, AND GUTTERS SHALL BE FLEXIBLE FOAM MATERIAL, IN ACCORDANCE WITH THE ODOT CMS ITEM 705.03, INSTALLED PER THE FOLLOWING CONDITIONS:<div><div>A. AT ALL FIXED OBJECTS (I.E. UTILITY COVERS, VALVES, MANHOLES, ETC.) WHERE NEW CONCRETE ABUTS EXISTING CONCRETE</div><div>B. AT ALL RIGID STRUCTURES (I.E. DRIVES, CURBS, STEPS, ETC.) PAYMENT FOR THIS ITEM AND ZIP STRIPS INCLUDED IN THE PERTINENT CONCRETE PAVEMENT UNIT PRICE.</div><div>C. AT ALL STREET INTERSECTIONS AT THE POINT OF CURVATURE OF THE TURNING RADI ENTERING THE INTERSECTION.</div><div>D. NO CONCRETE SHALL BE LEFT ABOVE THE EXPANSION MATERIAL OR ACROSS THE JOINT AT ANY POINT. ANY CONCRETE SPANNING THE ENDS OF THE JOINT NEXT TO THE FORMS SHALL BE CAREFULLY CUT AWAY AFTER THE FORMS ARE REMOVED. BEFORE THE PAVEMENT IS OPENED TO TRAFFIC, THE GROOVE ABOVE THE EXPANSION JOINT MATERIAL SHALL BE CLEANED AND SEALED WITH JOINT SEALING MATERIAL.</div></div></div><div><div>3. ANY AND ALL AREAS DISTURBED BY THE CONTRACTOR SHALL BE RESTORED TO THEIR ORIGINAL CONDITION OR REPLACED WITH NEW MATERIALS TO THE SATISFACTION OF THE VILLAGE. YARDS SHALL BE SEEDED AND MULCHED PER ITEM 659, YARDS ARE TO BE RESTORED WITHIN 7 DAYS OF DEMUING.</div><div>4. ALL APPLICABLE REQUIREMENTS OF THE OEPA GENERAL CONSTRUCTION STORM WATER PERMIT SHALL BE FOLLOWED BY THE CONTRACTOR SHOULD THE PROJECT REQUIRE DISTURBANCE OF 1 ACRE OR MORE. REGARDLESS OF THE AMOUNT OF LAND DISTURBED, GOOD HOUSEKEEPING MEASURES AND SPILL PREVENTION AND CONTAINMENT PRACTICES SHALL BE UTILIZED FOR THE PROJECT.</div><div>5. RIGHT-OF-WAY AND PROPERTY LINES SHOWN ARE PLOTTED FROM CINCINNATI AREA G.I.S. MAPPING AND ARE APPROXIMATE AND NOT THE RESULT OF A FIELD BOUNDARY SURVEY.</div><div>6. THE CONTRACTOR SHALL LIMIT THEIR WORK AREA TO THE EASEMENTS AND RIGHTS-OF-WAY SHOWN ON THESE PLANS UNLESS WRITTEN PERMISSION IS GIVEN BY THE PROPERTY OWNER AND APPROVED BY THE VILLAGE OF WOODLAWN.</div><div>7. ALL OSHA, STATE AND LOCAL SAFETY REGULATIONS SHALL BE FOLLOWED DURING CONSTRUCTION.</div><div>8. RELOCATION OR REINSTALLATION OF EXISTING MAIL BOXES, FENCES, PRIVATE LANDSCAPE LIGHTS, PRIVATE SIGNS, STREET SIGNS, RESTORATION OF LANDSCAPING AND TREATMENT OF EXISTING WALLS WHERE A PORTION HAS BEEN REMOVED SHALL BE INCIDENTAL TO CLEARING AND GRUBBING.</div><div>9. NO CONSTRUCTION SHALL COMMENCE UNTIL ALL COUNTY, STATE AND VILLAGE OF WOODLAWN PERMITS HAVE BEEN ISSUED, AS REQUIRED. THE CONTRACTOR SHALL PAY ALL CHARGES AND FEES ASSOCIATED WITH THE PERMITS.</div><div>10. THE CONTRACTOR SHALL COORDINATE ALL WORK WITHIN THE PUBLIC RIGHT OF WAY WITH THE VILLAGE OF WOODLAWN. LOCAL TRAFFIC MUST BE MAINTAINED AT ALL TIMES DURING CONSTRUCTION UNLESS OTHERWISE NOTED IN THESE PLANS.</div></div><div><div>MATERIALS AND SPECIFICATIONS</div><div>UNLESS OTHERWISE SPECIFIED, ALL MATERIALS SHALL BE NEW, AND BOTH WORKMANSHIP AND MATERIALS SHALL BE OF PREMIUM QUALITY, PROPER AND SUFFICIENT FOR THE PURPOSE INDICATED. THE CONTRACTOR SHALL FURNISH, UPON REQUEST, SATISFACTORY EVIDENCE AS TO TYPE AND QUALITY OF MATERIALS AND WORKMANSHIP.</div><div>ALL ITEMS AND/OR MATERIAL PROPOSED BY THE CONTRACTOR FOR SUBSTITUTIONS MUST BE APPROVED BY THE ENGINEER AND OWNER IN WRITING AND SHALL BE EQUAL OR SUPERIOR TO THE ITEMS SPECIFIED IN THE CONTRACT DOCUMENTS. IF SAID SUBSTITUTION PROPOSED BY THE CONTRACTOR FOR A SPECIFIED ITEM REQUIRES ENGINEERING REVISIONS, THE TOTAL EXPENSE OF SAID REVISIONS SHALL BE PAID BY THE CONTRACTOR.</div><div>ANY ITEMS OF LABOR AND MATERIALS REQUIRED BUT NOT SHOWN AS A SEPARATE PAY ITEM IN THE PROPOSAL SHALL BE FURNISHED AND INSTALLED AS INCIDENTAL TO THE CONTRACT, EXCEPT AS NOTED IN THE PLANS AND SPECIFICATIONS.</div></div><div><div>TESTING</div><div>THE CONTRACTOR SHALL INCLUDE THE COST OF ALL REQUIRED TESTS IN THE UNIT PRICE BID FOR THE PERTINENT ITEM AND NO SEPARATE COMPENSATION IS TO BE MADE FOR SAID TESTING.</div></div><div><div>VILLAGE OWNED TRAFFIC SIGNS, POSTS, SIGNALS, AND POLES</div><div>TRAFFIC SIGNS, POSTS, SIGNAL EQUIPMENT AND POLES THAT ARE TO BE REMOVED AND ARE IN SALVAGEABLE CONDITION SHALL BE CAREFULLY REMOVED, CLEANED AND DELIVERED TO THE VILLAGE MAINTENANCE GARAGE FOR INSPECTION AND STORAGE. ANY ADDITIONAL DAMAGE DUE TO IMPROPER REMOVAL OR HANDLING OF THE ITEM THEY SHALL BE REPLACED BY THE CONTRACTOR AT NO ADDITIONAL COST TO THE VILLAGE.</div></div><div><div>RESPONSIBILITY</div><div>IT SHALL BE THE RESPONSIBILITY OF THE CONTRACTOR TO PERFORM THEIR WORK IN SUCH A MANNER AS NOT TO DAMAGE OR DESTROY ANY EXISTING FEATURE, (I.E. EXISTING INLETS, CONDUITS, ETC.) WHICH IS NOT MARKED FOR REPLACEMENT OR REMOVAL. IF ANY SUCH DAMAGE DOES OCCUR DUE TO THE OPERATIONS OF THE CONTRACTOR, THEY SHALL REPLACE THE DAMAGED PORTION AT THEIR EXPENSE.</div><div>THE CONTRACTOR SHALL EXERCISE DUE CARE DURING CONSTRUCTION SO AS NOT TO DESTROY ANY TREES, PLANTS, SHRUBS OR STRUCTURES OUTSIDE OF THE INDICATED WORK LIMITS AND THOSE NOT SPECIFICALLY MARKED FOR REMOVAL OR RELOCATION WITHIN THE WORK LIMITS.</div><div>IN SOME INSTANCES, THE CONTRACTOR WILL BE REQUIRED TO EXCAVATE UNDER AND AROUND THE EXISTING UTILITIES. EXTREME CARE SHOULD BE USED NOT TO DAMAGE THE UTILITY DURING THIS OPERATION.</div></div><div><div>STORM WATER POLLUTION, EROSION CONTROL AND DUST CONTROL</div><div>THE CONTRACTOR SHALL TAKE EXTREME CARE AND UTILIZE BEST MANAGEMENT PRACTICES TO CONTROL SEDIMENT AND EROSION DURING THE PROJECT AND TO PREVENT UNNECESSARY EROSION AND SILTATION AT ALL POINTS OF THE PROJECT. TEMPORARY SEEDING AND MULCHING; STRAW BALES, SLOPE DRAINS, SILT FENCE, INLET PROTECTION, ETC., SHALL BE USED AS NECESSARY OR AS DIRECTED BY THE OWNER/ENGINEER, THE COST OF WHICH SHALL BE INCIDENTAL TO THE OVERALL CONTRACT PRICE.</div><div>DUST SHALL BE KEPT TO A MINIMUM. COST OF EQUIPMENT, WATER, LABOR AND MATERIAL, ETC. REQUIRED TO PERFORM DUST CONTROL SHALL BE INCIDENTAL TO THE OVERALL BID PRICE.</div></div></div>	<div><div>COORDINATION WITH OTHER CONTRACTORS</div><div>OTHER CONTRACTORS AND/OR UTILITY COMPANIES MAY BE WORKING IN THIS AREA CONCURRENT WITH THIS CONTRACT. THE CONTRACTOR SHALL COORDINATE WORK ACTIVITIES WITH ALL OTHER CONTRACTORS IN THE AREA.</div><div><div>DOWN TIME DUE TO FIELD CONFLICTS</div><div>DURING THE CONSTRUCTION ACTIVITIES OF THIS PROJECT, THERE MAY BE TIMES WHEN THE CONSTRUCTION IN SOME AREAS MAY NEED TO BE SUSPENDED PENDING RESPONSE ON, OR RESOLUTION TO AN ISSUE FROM THE OWNER AND/OR ENGINEER. THE CONTRACTOR, IN THIS CASE SHALL MOVE THE CREWS AND EQUIPMENT TO WORK IN A DIFFERENT AREA OR ON A DIFFERENT TASK. COST OF MOBILIZING AND DEMOBILIZING OF THE CONTRACTORS WORK CREWS AND EQUIPMENT INCLUDING "DOWNTIME" SHALL BE INCIDENTAL TO THE OVERALL BID PRICE FOR THIS PROJECT.</div></div></div> <div><div>UTILITY NOTES</div><div><div>1. THIS PLAN SHOWS THE APPROXIMATE LOCATION OF UNDERGROUND UTILITIES (GAS, WATER, STORM SEWER, SANITARY SEWER, TELEPHONE, ELECTRIC, ETC.). THE PREPARER DOES NOT GUARANTEE THEIR ACCURACY OR CORRECTNESS. THE UTILITY INFORMATION PROVIDED ON THE PLANS SHALL BE FIELD VERIFIED PRIOR TO CONSTRUCTION. THE CONTRACTOR SHALL BE RESPONSIBLE FOR MAINTAINING THE UTILITY AS WELL AS THE SERVICE LATERALS AT ALL TIMES DURING CONSTRUCTION. THE CONTRACTOR SHALL PRACTICE CARE DURING THE GRADING AND TRENCH EXCAVATION AND SHALL BE RESPONSIBLE FOR REPLACING ANY SERVICES THAT ARE DAMAGED DURING CONSTRUCTION AT THEIR EXPENSE.</div><div>2. PRIOR TO ANY EXCAVATION OVER AN EXISTING UTILITY LINE OR SERVICE, CONTRACTOR SHALL HAND EXCAVATE TO EXPOSE THE UTILITY AND DETERMINE LOCATION AND DEPTH. NOTIFY ENGINEER IMMEDIATELY OF ANY CONFLICTS.</div><div>3. TOPS OF EXISTING AND PROPOSED CASTING ELEVATIONS ARE SUBJECT TO FINAL ADJUSTMENTS AS APPROVED BY THE ENGINEER AND REQUIREMENTS OF UTILITY OWNER. THIS WORK WILL BE INCIDENTAL TO THE CONTRACT.</div><div>4. FORTY-EIGHT (48) HOURS BEFORE EXCAVATION IS TO COMMENCE, THE CONTRACTOR SHALL NOTIFY THE FOLLOWING AGENCIES: THE OHIO UTILITY PROTECTION SERVICE AND ALL OTHER UTILITIES THAT MAY HAVE UNDERGROUND UTILITIES INVOLVING THIS PROJECT AND ARE NON-MEMBERS OF OHIO UNDERGROUND PROTECTION.</div></div><div><div>DURING CONSTRUCTION, THE CONTRACTOR SHALL REPORT IMMEDIATELY TO THE OWNERS OF THE UNDERGROUND FACILITIES ANY BREAK OR LEAK IN THE FACILITIES, OR ANY DENT, GOUGE, GROOVE OR OTHER DAMAGE. THE CONTRACTOR SHALL NOTIFY NEARBY OCCUPANTS OF ANY EMERGENCY SITUATION THAT MAY ARISE.</div><div>THE CONTRACTOR SHALL BE RESPONSIBLE FOR COORDINATING ALL UTILITY ACTIVITIES AND SCHEDULES.</div></div><div><div>STORMWATER CONNECTIONS</div><div>EXISTING STORMWATER CONNECTION THAT ARE DISCOVERED OR INTERRUPTED DURING CONSTRUCTION SHALL BE RESTORED OR RE-DIRECTED TO THE NEAREST CATCH BASIN, OR OUTLET INTO THE NEAREST DRAINAGE SWALE OR PROVIDED WITH A CURB OPENING AS DIRECTED BY THE ENGINEER. THE REPLACEMENT SIZE AND SLOPE SHALL BE DETERMINED IN THE FIELD TO ENSURE POSITIVE DRAINAGE OUT OF THE PIPE.</div><div>CONTRACTOR SHALL BE REQUIRED TO MAINTAIN STORM AND SANITARY SEWER FLOW THROUGHOUT THE PROJECT, FOR THE DURATION OF CONSTRUCTION. ALL COST FOR THE ABOVE SHALL BE INCIDENTAL TO THE CONTRACT.</div></div><div><div>REVIEW OF DRAINAGE FACILITIES</div><div>BEFORE ANY WORK IS STARTED ON THE PROJECT AND AGAIN BEFORE FINAL ACCEPTANCE BY THE VILLAGE OF WOODLAWN, THE CONTRACTOR WITH THE OWNER AND ENGINEER OR FIELD INSPECTOR SHALL MAKE AN INSPECTION OF THE EXISTING SEWERS WITHIN THE WORK LIMITS WHICH ARE TO REMAIN IN SERVICE AND WHICH MAY BE AFFECTED BY THE WORK. THE CONDITION OF THE EXISTING CONDUITS AND THEIR APPURTENANCES SHALL BE DETERMINED FROM FIELD OBSERVATIONS. RECORDS OF THE INSPECTIONS SHALL BE KEPT IN WRITING BY THE CONTRACTOR.</div><div>ALL NEW CONDUITS, INLETS, CATCH BASINS, AND MANHOLES CONSTRUCTED AS A PART OF THE PROJECT SHALL BE FREE OF ALL FOREIGN MATTER AND IN A CLEAN CONDITION BEFORE THE PROJECT WILL BE ACCEPTED BY THE VILLAGE.</div><div>ALL EXISTING SEWERS INSPECTED INITIALLY BY THE ABOVE-MENTIONED PARTIES SHALL BE MAINTAINED AND LEFT IN A CONDITION REASONABLY COMPARABLE TO THAT DETERMINED BY THE ORIGINAL INSPECTION. ANY CHANGE IN THE CONDITION RESULTING FROM THE CONTRACTOR'S OPERATIONS SHALL BE CORRECTED BY THE CONTRACTOR TO THE SATISFACTION OF THE VILLAGE.</div><div>PAYMENT FOR ALL OPERATIONS DESCRIBED ABOVE SHALL BE INCIDENTAL TO THE CONTRACT.</div><div>THE FOLLOWING UTILITIES AND OWNERS ARE LOCATED WITHIN THE WORK LIMITS OF THIS PROJECT:</div><div><div><div>ELECTRIC</div><div>DUKE ENERGY 139 E. FOURTH STREET ROOM 467, ANNEX CINCINNATI, OH 45201 513-287-2689</div></div><div><div>SEWER</div><div>METROPOLITAN SEWER DISTRICT OF GREATER CINCINNATI 1600 GEST STREET CINCINNATI, OHIO 45204 513-557-7167</div></div><div><div>CABLE TV</div><div>CHARTER 10920 KENWOOD ROAD CINCINNATI, OHIO 45242 513-386-5918</div></div><div><div>WATER</div><div>GREATER CINCINNATI WATER WORKS 4747 SPRING GROVE AVENUE CINCINNATI, OHIO 45232 513-591-5007</div></div><div><div>STORM</div><div>VILLAGE OF WOODLAWN 10141 WOODLAWN AVE CINCINNATI, OHIO 45215 513-771-6130</div></div></div></div></div>	<div><div>ITEM 614, MAINTAINING TRAFFIC</div><div>THE MAINTENANCE OF TRAFFIC PROCEDURES SHALL MEET THE REQUIREMENTS AS INDICATED IN THE "OHIO MANUAL OF UNIFORM TRAFFIC CONTROL DEVICES FOR STREETS AND HIGHWAYS", CURRENT EDITION, THE PROPOSAL, THE SPECIFICATIONS, AND THESE PLANS. ANY VARIANCE FROM THESE REQUIREMENTS SHALL BE APPROVED IN ADVANCE BY THE ENGINEER IN WRITING.</div><div>THE CONTRACTOR SHALL MAINTAIN ACCESS TO LOCAL TRAFFIC (ACCESS TO RESIDENCES WITHIN CONSTRUCTION LIMITS) AT ALL TIMES. THE CONTRACTOR SHALL PROVIDE SUFFICIENT SIGN, WARNING LIGHTS, BARRICADES, OR OTHER NECESSARY DEVICES MAKE THE SITE SAFE TO THE TRAVELING PUBLIC.</div><div>SPECIFIC ATTENTION WILL BE DIRECTED TOWARD THE PROPER USE OF FLAGGERS, LIGHTS, DRUMS, AND TEMPORARY PAVEMENT MARKINGS. THE CONTRACTOR SHALL FURNISH, ERECT AND MAINTAIN ALL NECESSARY SIGNS, AND PROVIDE TEMPORARY STRIPING. ALL WORK ZONES SHALL CONFORM TO THE OHIO MANUAL OF UNIFORM CONTROL DEVICES. THE CONTRACTOR SHALL ALSO PROVIDE ALL PLATING, TEMPORARY PAVEMENT, TEMPORARY PAVEMENT MARKINGS, AND TRAFFIC CONTROL MEASURES NECESSARY TO MAINTAIN TRAFFIC. THE COST OF ALL TEMPORARY TRAFFIC CONTROL ITEMS NECESSARY TO SAFELY MAINTAIN TRAFFIC SHALL BE INCLUDED WITH PAYMENT FOR ITEM 614 MAINTAINING TRAFFIC.</div></div> <div><div>A. BEFORE WORK BEGINS, THE CONTRACTOR SHALL SUBMIT TO THE OWNER AND ENGINEER THE NAMES AND TELEPHONE NUMBERS OF PERSONS WHO CAN BE CONTACTED 24 HOURS A DAY BY THE VILLAGE OF WOODLAWN AND ALL INTERESTED POLICE AGENCIES. THESE PERSONS SHALL BE RESPONSIBLE FOR PLACING OR REPLACING NECESSARY TRAFFIC CONTROL DEVICES TO MAINTAIN THE TRAVELED PAVEMENT SAFELY.</div><div>B. TRAFFIC SHALL BE MAINTAINED AT ALL INTERSECTIONS AND DRIVES AT ALL TIMES, AND SHALL BE CONTROLLED WITH FLAGGERS AND TRAFFIC CONTROL DEVICES AS REQUIRED AND SHALL BE SUBJECT TO THE APPROVAL OF THE OWNER AND ENGINEER.</div><div>C. DRIVE CLOSURES THAT LIMIT TRAFFIC TO 1 WAY IS ALLOWABLE, AS NOTED BELOW FOR SPECIFIC TIMES, AND SHALL BE FLAGGED IN ACCORDANCE WITH THE OHIO MANUAL OF UNIFORM TRAFFIC CONTROL DEVICES.</div><div>D. LENGTH AND DURATION OF LANE CLOSURES AND RESTRICTIONS SHALL BE AT THE APPROVAL OF THE OWNER AND ENGINEER. IT IS THE INTENT TO MINIMIZE THE IMPACT TO THE TRAVELING PUBLIC. LANE CLOSURES OR RESTRICTIONS OVER SEGMENTS OF THE PROJECT IN WHICH NO WORK IS ANTICIPATED WITHIN A REASONABLE TIME FRAME, AS DETERMINED BY THE OWNER AND ENGINEER, SHALL NOT BE PERMITTED. THE LEVEL OF UTILIZATION OF MAINTENANCE OF TRAFFIC DEVICES SHALL BE COMMENSURATE WITH THE WORK IN PROGRESS.</div><div>E. IN ADDITION LANE CLOSURES ARE NOT ALLOWED OVERNIGHT. ANY COST FOR ITEMS NOT SPECIFICALLY NOTED UNDER THE MAINTENANCE OF TRAFFIC NOTE REQUIRED TO REOPEN LANS SHALL BE INCLUDED IN THE BID PRICE FOR ITEM 614 - MAINTENANCE OF TRAFFIC.</div></div> <div><div>THE CONTRACTOR SHALL OBEY ALL LOCAL LAWS AND ORDINANCES INCLUDING ANY NOISE RESTRICTIONS.</div><div>THE CONTRACTOR SHALL MAINTAIN TRAFFIC TO ALL ROADWAYS INTERSECTING THE CONSTRUCTION AREAS.</div><div>MAINTENANCE OF TRAFFIC SHALL BE ONGOING THROUGH THE PROJECT, INCLUDING ALL PERIODS OF INACTIVITY BY THE CONTRACTOR, UNTIL FINAL ACCEPTANCE OF THE PROJECT.</div></div> <div><div>THE CONTRACTOR SHALL NOTIFY AFFECTED PROPERTY OWNERS 48 HOURS IN ADVANCE BEFORE COMMENCING WORK.</div><div>TEMPORARY BLOCKING OF THE DRIVEWAY TO ANY PROPERTY DURING CONSTRUCTION IS ALLOWABLE (MAX. 96 HOURS). HOWEVER, ACCESS TO PROPERTIES FOR DELIVERIES, SERVICE, EMERGENCY VEHICLES, ETC., SHALL BE MAINTAINED AT ALL TIMES.</div></div>	<div><div>ITEM 608 - 5" CONCRETE SIDEWALK -SEE DETAIL SHEET</div><div>ITEM 608 - 9" CONCRETE DRIVEWAY APRON</div><div>12" HEAVY DUTY PAVEMENT REPLACEMENT</div><div>ITEM 608 - 6" CONCRETE WALK WITH TURN DOWN SLAB. (SEE DETAILS)</div></div> <div><div>PAVEMENT ITEM NOTES</div><div><div>GENERAL</div><div>EXCAVATION AND EMBANKMENT TO ESTABLISH SUBGRADE, SUBGRADE STABILIZATION AND PROOF ROLLING OF SUBGRADE OUTSIDE OF THE ASPHALT PLANNING AND OVERLAY SHALL ALL BE INCIDENTAL TO THE BID ITEMS. SUBSEQUENT HAUL OFF OR IMPORTING OF MATERIAL SHALL ALSO BE INCIDENTAL TO THE BID ITEMS.</div></div><div><div>ITEM 204 - SUBGRADE STABILIZATION WITH GEOGRID</div><div>THIS ITEM SHALL CONSIST OF OVER EXCAVATING POOR SOILS AND BACKFILLING THE AREAS WITH A COMBINATION OF STONE, GEOGRID MATERIAL AND ASPHALT PER THE DETAILS INDICATED IN THESE PLANS. DURING THE PROOF-ROLL TEST OF THE SUBGRADE THE ENGINEER SHALL MARK AREAS IN THE FIELD WHERE OBSERVED DEFLECTIONS EXCEED 0.5" OR CAUSE SUBSTANTIAL RUTTING OF THE SUBGRADE. THESE MARKINGS WILL BE FIELD MEASURED AND AGREED UPON PRIOR TO PERFORMING THE WORK. THE UNIT PRICE SHALL INCLUDE EXCAVATION AND REMOVAL OF POOR SOILS, BACKFILLING WITH 304 STONE AND COMPACTION OF SUCH ITEMS AND ITEM 301 PER THE DETAIL.</div><div>ITEM 204 - SUBGRADE STABILIZATION</div><div>THIS ITEM SHALL CONSIST OF OVER EXCAVATING POOR SOILS AND BACKFILLING THE AREAS WITH A COMBINATION OF STONE MATERIAL AND ASPHALT. DURING THE PROOF-ROLL TEST OF THE SUBGRADE THE ENGINEER SHALL MARK AREAS IN THE FIELD WHERE OBSERVED DEFLECTIONS EXCEED 0.5" OR CAUSE RUTTING OF THE SUBGRADE. THESE MARKINGS WILL BE FIELD MEASURED AND AGREED UPON PRIOR TO PERFORMING THE WORK. THE UNIT PRICE SHALL INCLUDE EXCAVATION AND REMOVAL OF POOR SOILS, BACKFILLING WITH 304 STONE AND COMPACTION OF SUCH ITEMS AND 8" OF ITEM 301 APPLIED IN 2 EQUAL LIFTS OF 4".</div></div><div><div>ITEM 451 - TYPICAL DRIVE APRON</div><div>THIS ITEMS SHALL CONSIST OF INSTALLING A DRIVEWAY APRON PER THE PROVIDED DETAILS. THE CONTRACTOR SHALL EXCAVATE THE AREA TO SUBGRADE THEN POUR A CONTINUOUS CURB OR CURB AND GUTTER, DEPENDING ON ADJACENT EXISTING/PROPOSED CURB, AND HAND REMOVE THE CURB PORTION OF IT TO PROVIDE THE DEPRESSED CURB AND GUTTER TYPICAL SECTION. ONCE THE TRANSITION PIECE HAS SUFFICIENTLY HARDENED THE REMAINDER OF THE CONCRETE BETWEEN THE DRIVE ASPHALT AND THE TRANSITION PIECE SHALL BE CONSTRUCTED. WHERE INDICATED FULL DEPTH PAVEMENT SHALL BE PROVIDED BETWEEN THE DRIVEWAY AND THE ASPHALT PAVEMENT. THE UNIT PRICE SHALL INCLUDE EXCAVATION, REMOVAL OF ASPHALT, COMPACTION, FORM WORK AND CONSTRUCTION JOINTING PER THE DETAIL.</div><div>ITEM 608 - CONCRETE WALK</div><div>THIS ITEM SHALL CONSIST OF INSTALLING A SIDEWALK PER THE PROVIDED DETAILS AND ODOT SPECIFICATIONS. THE CONTRACTOR SHALL EXCAVATE THE AREA TO SUBGRADE AND THEN TEST THE AREA TO ENSURE SOUNDNESS. FORMWORK SHALL BE ERECTED TO ENSURE LINE AND GRADE OF THE PROPOSED SIDEWALK AND THE SIDEWALK WILL BE POURED, FINISHED AND CURED. THE UNIT PRICE SHALL INCLUDE EXCAVATION, COMPACTION, FORM WORK, DOWEL BARS, CONSTRUCTION JOINTING, FINISHING AND CURING PER THE PROVIDED DETAILS AND SPECIFICATIONS.</div><div>ITEM 608 - CONCRETE WALK WITH TURN DOWN SLAB</div><div>THIS ITEM SHALL CONSIST OF INSTALLING A SIDEWALK PER THE PROVIDED DETAILS AND ODOT SPECIFICATIONS. THE CONTRACTOR SHALL EXCAVATE THE AREA TO SUBGRADE AND THEN TEST THE AREA TO ENSURE SOUNDNESS. FORMWORK SHALL BE ERECTED TO ENSURE LINE AND GRADE OF THE PROPOSED SIDEWALK AND THE SIDEWALK WILL BE POURED, FINISHED AND CURED. THE UNIT PRICE SHALL INCLUDE EXCAVATION, COMPACTION, FORM WORK, DOWEL BARS, CONSTRUCTION JOINTING, FINISHING AND CURING PER THE PROVIDED DETAILS AND SPECIFICATIONS</div></div><div><div>CONTINGENCY QUANTITIES</div><div>THE CONTRACTOR SHALL NOT ORDER MATERIALS OR PERFORM WORK FOR PLAN ITEMS SET UP TO BE USED BY THE ENGINEER UNLESS AUTHORIZED BY THE OWNER/ENGINEER. THE ACTUAL WORK LOCATIONS AND QUANTITIES USED AT THE FIELD INSPECTOR'S DISCRETION SHALL BE MADE A MATTER OF RECORD BY INCORPORATION INTO THE FINAL CHANGE ORDER GOVERNING COMPLETION OF THIS PROJECT.</div></div></div>	<div><div>EXISTING GAS LINE</div><div>EXISTING GAS SERVICE</div><div>EXISTING ELECTRIC (UNDERGROUND / OVERHEAD)</div><div>EXISTING CABLE (UNDERGROUND / OVERHEAD)</div><div>EXISTING TELEPHONE (UNDERGROUND / OVERHEAD)</div><div>EXISTING WATER MAIN</div><div>EXISTING WATER SERVICE</div><div>EXISTING STORM SEWER</div><div>EXISTING ROOF DRAIN</div><div>EXISTING SANITARY SEWER</div><div>EXISTING SANITARY FORCE MAIN</div><div>EXISTING FIBER OPTICS</div><div>EXISTING FENCE</div><div>EXISTING CONTOURS (MAJOR)</div><div>EXISTING CONTOURS (MINOR)</div><div>EXISTING RIGHT OF WAY</div><div>EXISTING PROPERTY LINE</div><div>EXISTING EASEMENT</div><div>EXISTING GUARDRAIL</div><div>EXISTING TREE LINE</div><div>PROPOSED GAS LINE</div><div>PROPOSED GAS SERVICE</div><div>EXISTING ELECTRIC (UNDERGROUND / OVERHEAD)</div><div>PROPOSED CABLE (UNDERGROUND / OVERHEAD)</div><div>PROPOSED TELEPHONE (UNDERGROUND / OVERHEAD)</div><div>PROPOSED WATER MAIN</div><div>PROPOSED WATER SERVICE</div><div>PROPOSED STORM SEWER</div><div>PROPOSED UNDERDRAIN</div><div>PROPOSED UNDERDRAIN / DOWNSPOUT COLLECTOR COMBO</div><div>PROPOSED SANITARY SEWER</div><div>PROPOSED SANITARY FORCE MAIN</div><div>PROPOSED FIBER OPTICS</div><div>PROPOSED FENCE</div><div>PROPOSED CONTOURS (MAJOR)</div><div>PROPOSED CONTOURS (MINOR)</div><div>PROPOSED RIGHT OF WAY</div><div>PROPOSED PROPERTY LINE</div><div>PROPOSED EASEMENT</div><div>PROPOSED GUARDRAIL</div><div>PROPOSED TREE LINE / CLEARING LIMITS</div><div>PROPOSED DISTURBED LIMITS</div><div>PROPOSED FLAGPOLE</div><div>PROPOSED MAILBOX</div><div>PROPOSED SIGN</div><div>PROPOSED CABLE PEDESTAL</div><div>PROPOSED ELECTRIC PEDESTAL</div><div>PROPOSED PULL BOX</div><div>PROPOSED GROUND LIGHT</div><div>PROPOSED LIGHT POLE</div><div>PROPOSED ELECTRIC METER</div><div>PRPOSED ELECTRIC MANHOLE</div><div>PROPOSED GAS METER</div><div>PROPOSED GAS VALVE</div><div>PROPOSED GAS BOX</div><div>PROPOSED UTILITY POLE</div><div>PROPOSED GUY WIRE / ANCHOR</div><div>PROPOSED SANITARY MANHOLE</div><div>PROPOSED SANITARY CLEANOUT</div><div>PROPOSED STORM MANHOLE</div><div>PROPOSED SINGLE / DOUBLE CURB INLET</div><div>PROPOSED CATCH BASIN</div><div>PROPOSED STORM CLEANOUT</div><div>PROPOSED TELEPHONE MANHOLE</div><div>PROPOSED TELEPHONE PEDESTAL</div><div>PROPOSED FIRE HYDRANT</div><div>PROPOSED WATER METER</div><div>PROPOSED WATER VALVE</div><div>REMOVE EXISTING BUSH / TREE</div><div>PROPOSED SLOPE DIRECTION</div><div>EXISTING SURVEY BENCHMARK</div><div>TEST BORING LOCATION</div></div>	<div><div>verdantas</div><div><div>DATE</div><div>REVISION</div><div>NO</div><div>BIDDING</div><div>ISSUED FOR:</div><div>ISSUE DATE:</div><div>SCALE:</div><div>DESIGNED BY:</div><div>DRAWN BY:</div><div>CHECKED BY:</div></div><div><div>PROJECT NO.</div><div>241608</div><div>DISCIPLINE</div><div>CIVIL</div><div>SHEET NAME</div><div>NOTES</div><div>SHEET</div><div>OF</div><div>2</div><div>8</div></div></div>



HATCH LEGEND	
	ITEM 608 - 5" CONCRETE SIDEWALK
	ITEM 608 - 9" CONCRETE DRIVEWAY APRON
	ITEM 451 - PAVEMENT PLANING (VARIABLE DEPTH)
	ITEM 608 - 6" CONCRETE WALK WITH TURN DOWN SLAB

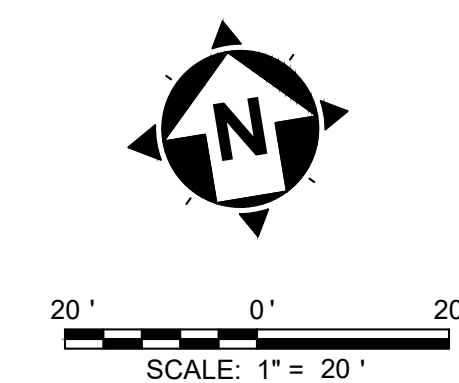



NOTE:

REPLACEMENT OF TYPE 2 CURB AND GUTTER SHALL BE OF INDIVIDUAL DAMAGED SECTIONS CUT AT JOINTS. EACH SECTION IS APPROXIMATELY 10'.

REPLACEMENT OF TYPE 6 CURB SHALL EXTEND 8' PAST THE
EDGE OF WALK IN DRIVEWAYS TO ALLOW A TRANSITION FROM
RAMP HEIGHT TO EXISTING CURB.

HATCH LEGEND

ITEM 608 - 5" CONCRETE SIDEWALK

ITEM 608 - 9" CONCRETE DRIVEWAY APRON

ITEM 451 - PAVEMENT PLANING (VARIABLE DEPTH)

ITEM 608 - 6" CONCRETE WALK WITH
TURN DOWN SLAB

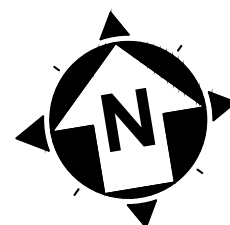

verdantas

ISSUED FOR:	BIDDING	NO	REVISION	DATE
ISSUE DATE:	1/22/26			XXXX/18
SCALE:	AS SHOWN			
DESIGNED BY:	AJAC			
DRAWN BY:	BHAU			
CHECKED BY:	MLAC			

**GLENDALE-MILFORD
SIDEWALK IMPROVEMENTS 2025
- THE VILLAGE OF WOODLAWN -**

LAYOUT PLAN STA. 53+50 - STA. 58+00

PROJECT NO.	
241608	
DISCIPLINE	
CIVIL	
SHEET NAME	
LAY3	
SHEET	OF
5	8

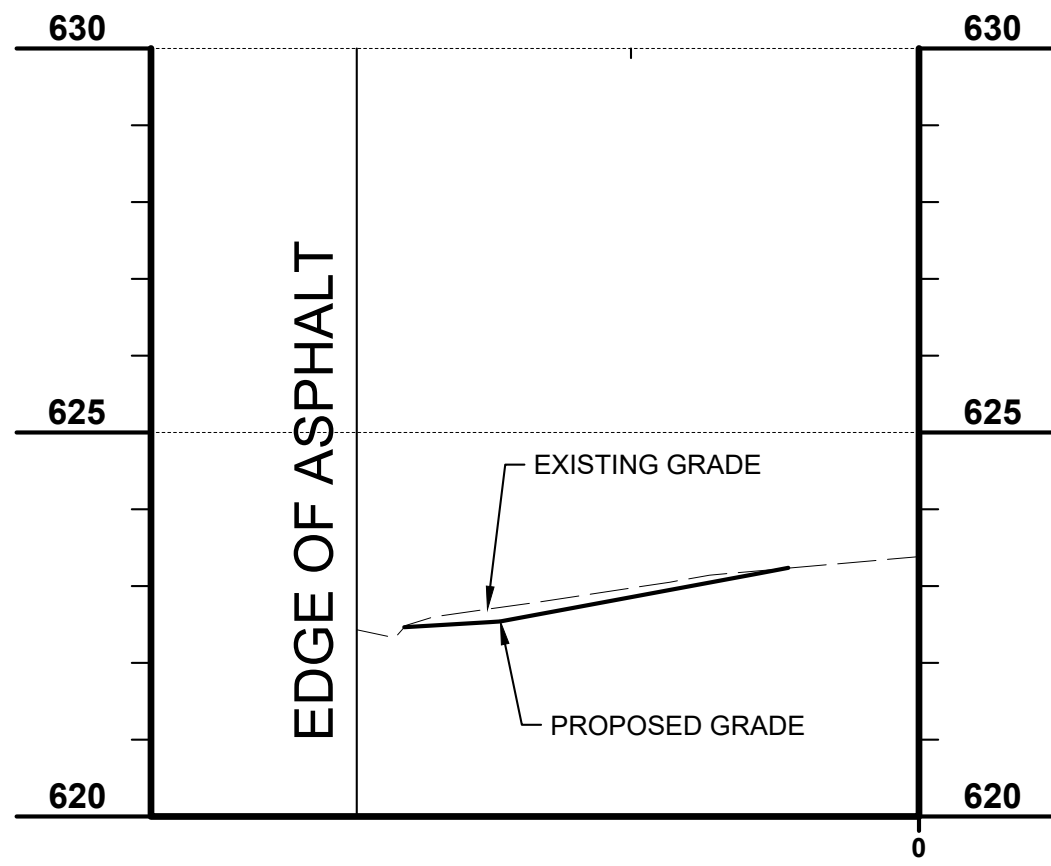

SHELL DRIVE 1

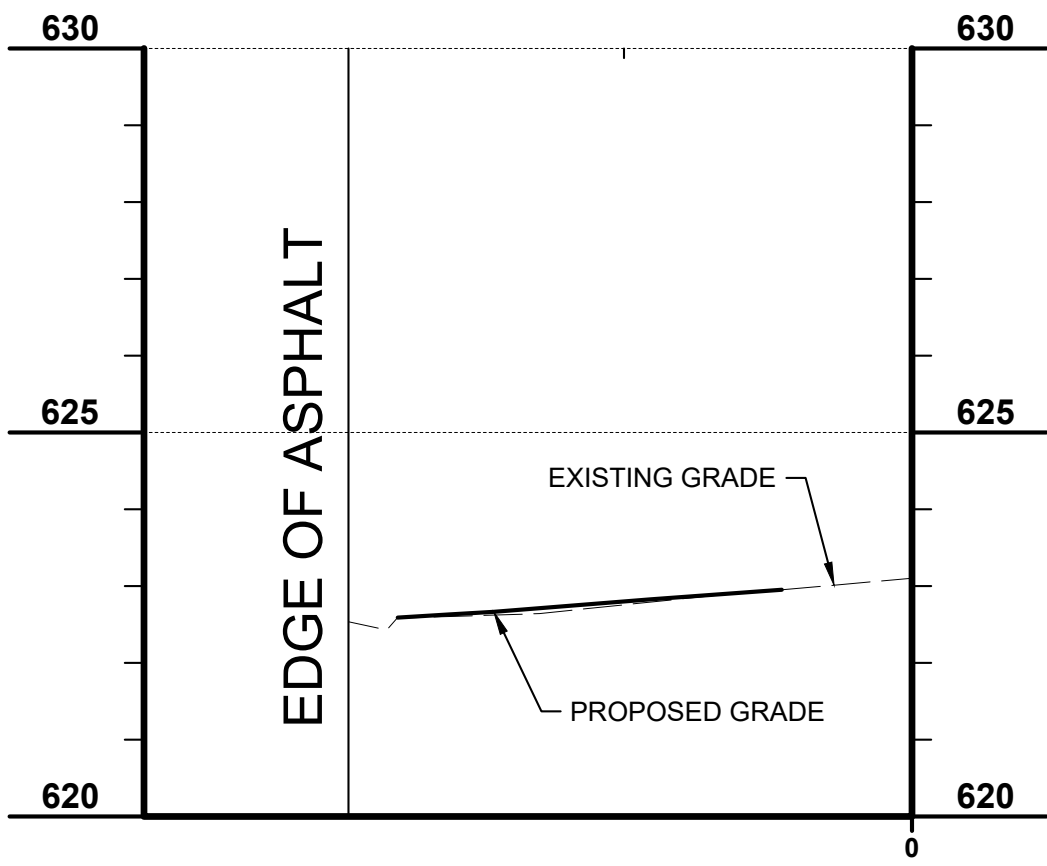

SHELL DRIVE 2

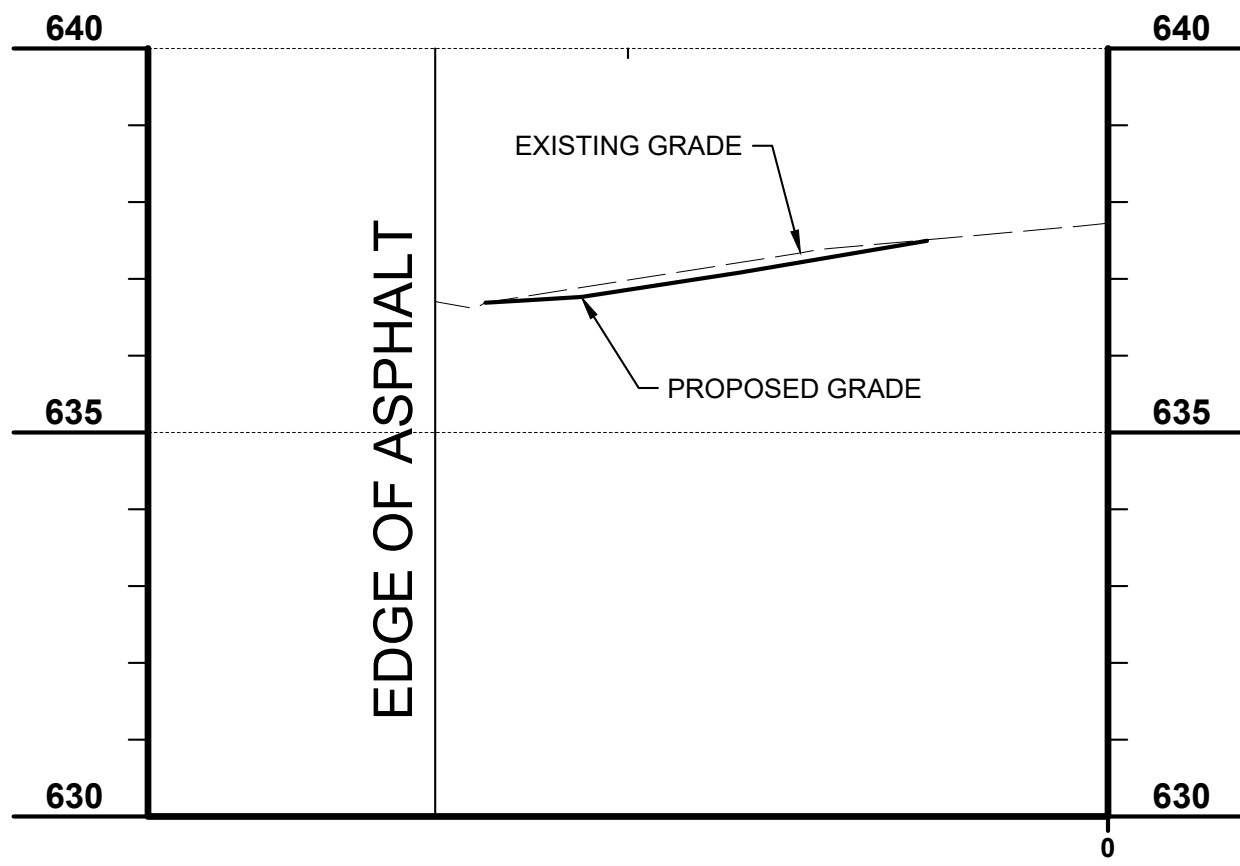

GLENDALE PLACE AMBULANCE

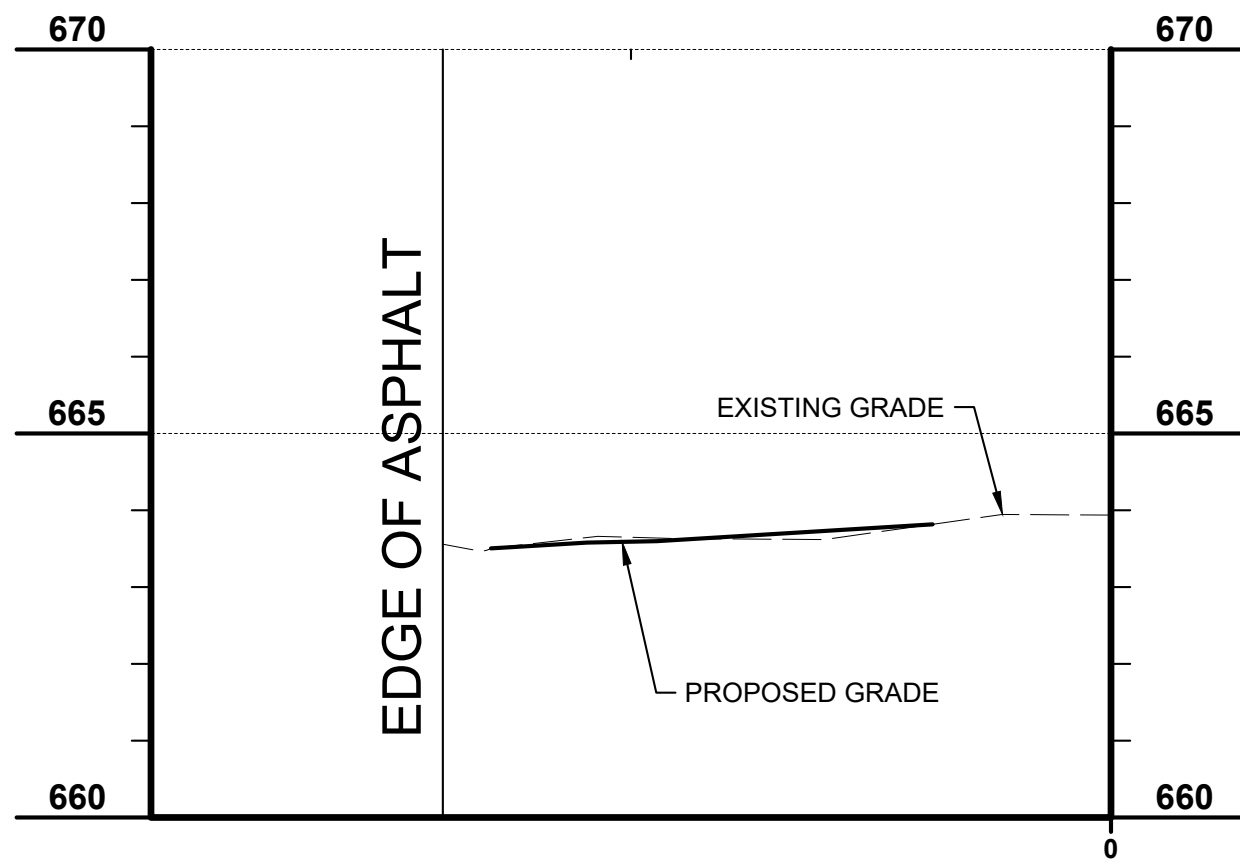

GLENDALE PLACE MAIN

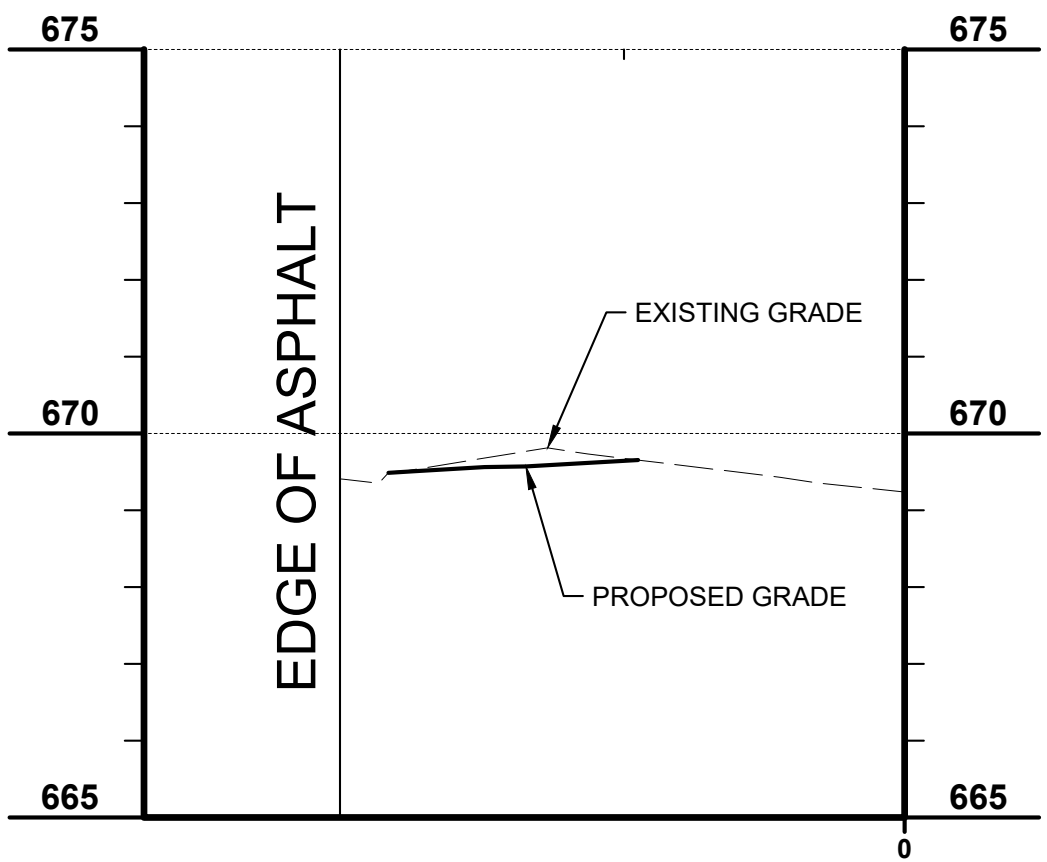

895 GLENDALE MILFORD

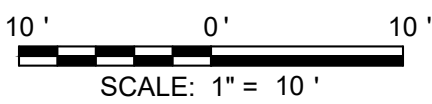

ISSUED FOR:	BIDDING	NO	REVISION	DATE
ISSUE DATE:	1/22/26	△		XXX/18
SCALE:	AS SHOWN			
DESIGNED BY:	AJAC			
DRAWN BY:	BHAU			
CHECKED BY:	MLAC			

GLENDALE-MILFORD
SIDEWALK IMPROVEMENTS 2025
- THE VILLAGE OF WOODLAWN -

DRIVEWAY PROFILES

PROJECT NO.	
241608	
DISCIPLINE	
CIVIL	
SHEET NAME	
PROF	
SHEET	OF
6	8

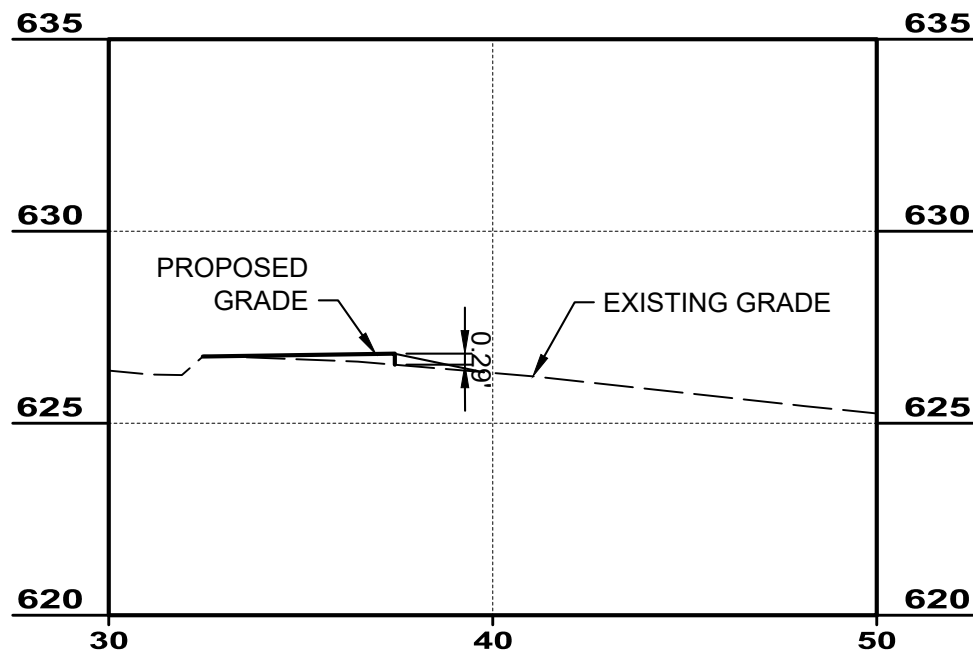

43+25.00

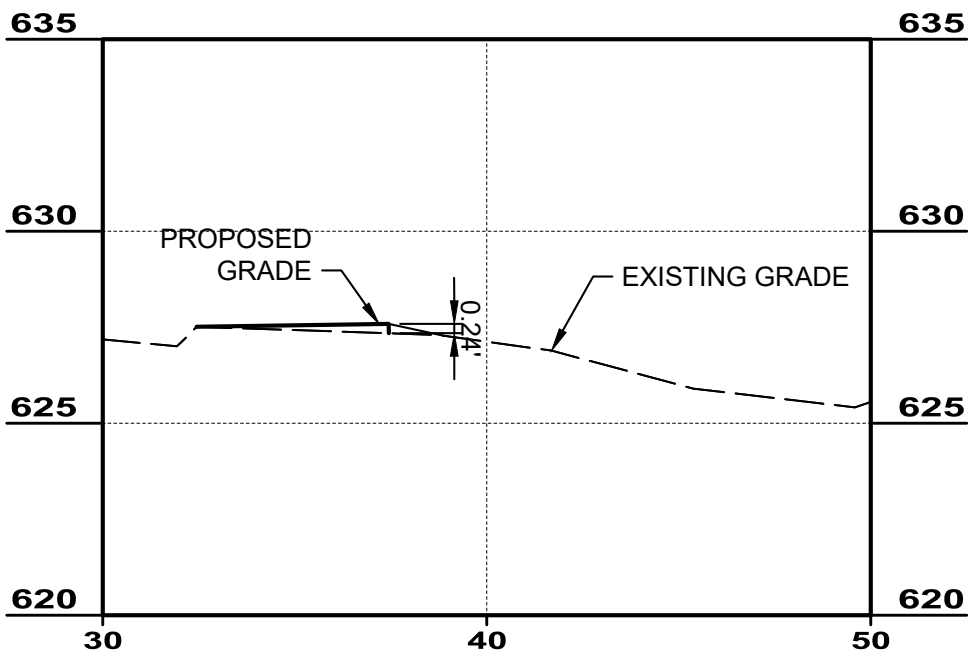

43+50.00

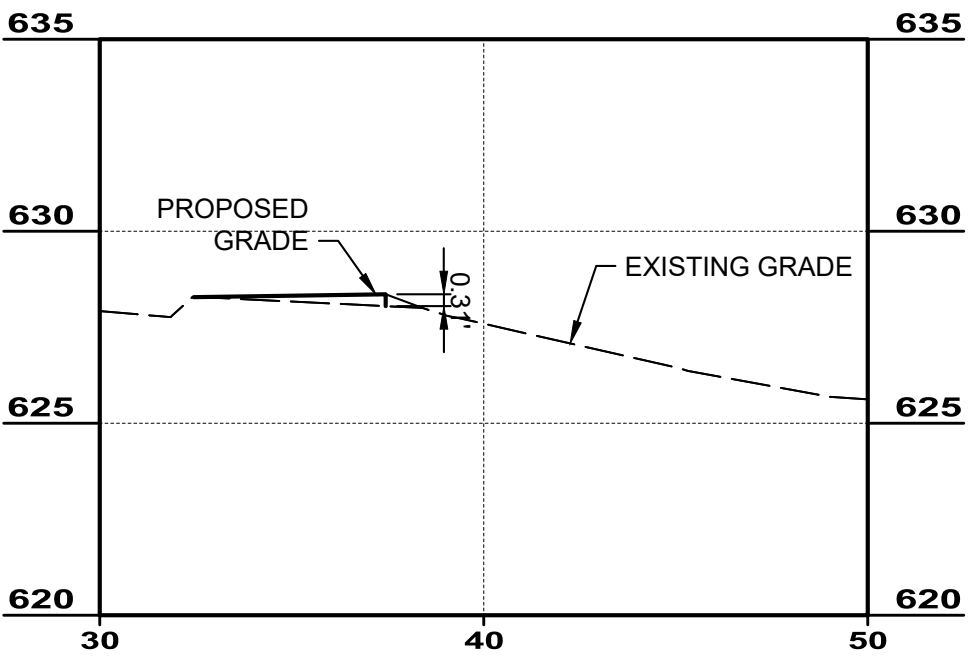

43+75.00

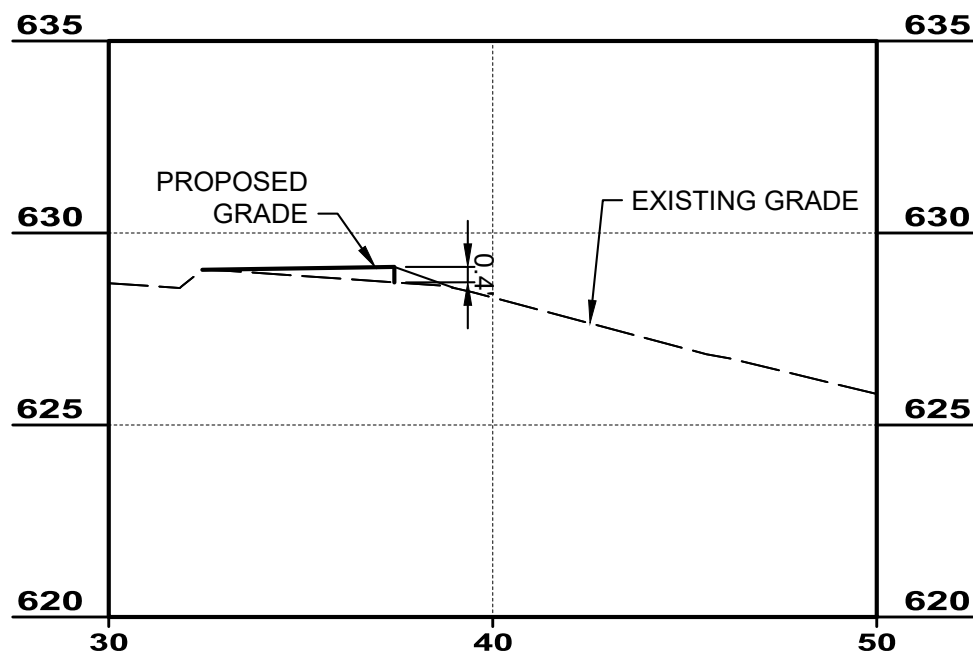

44+00.00

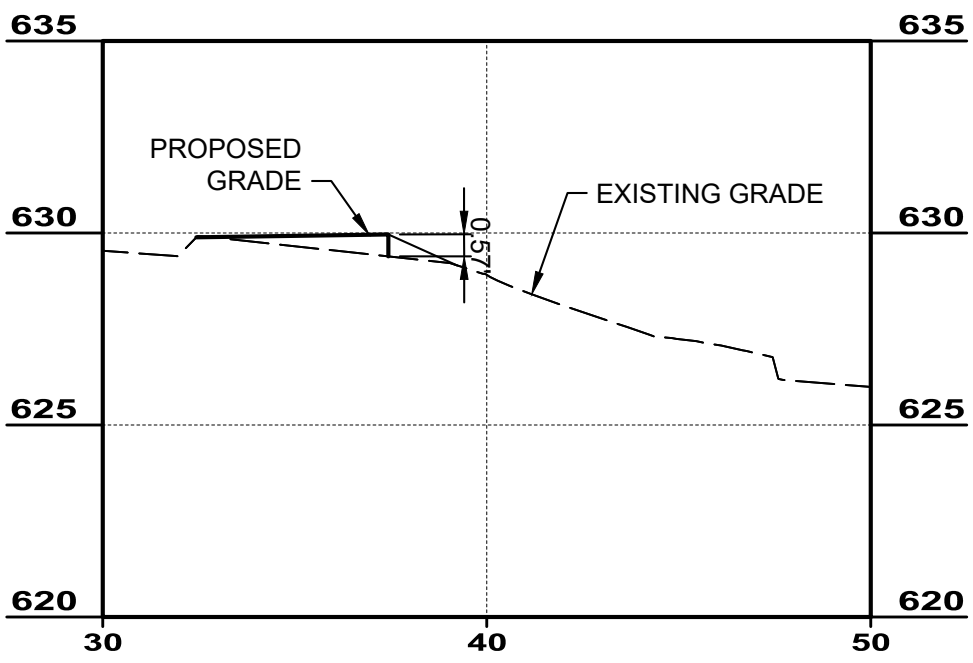

44+25.00

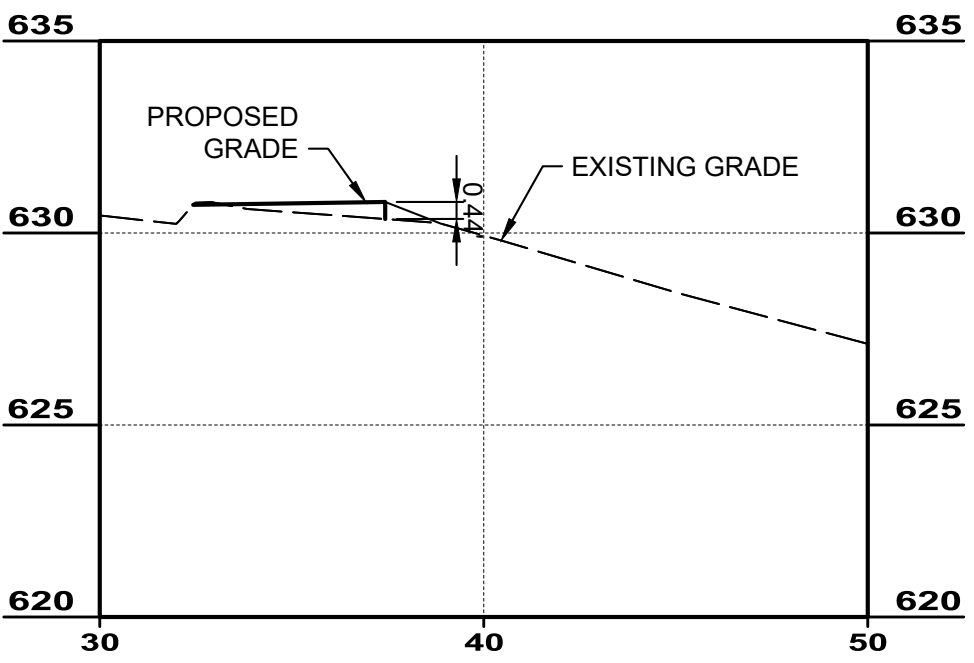

44+50.00

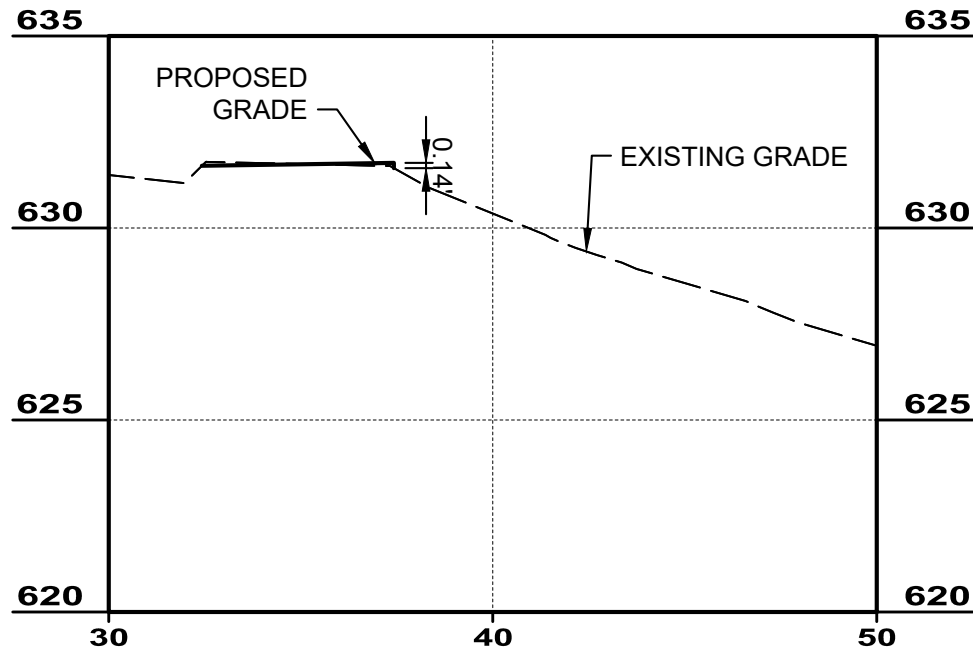

44+75.00

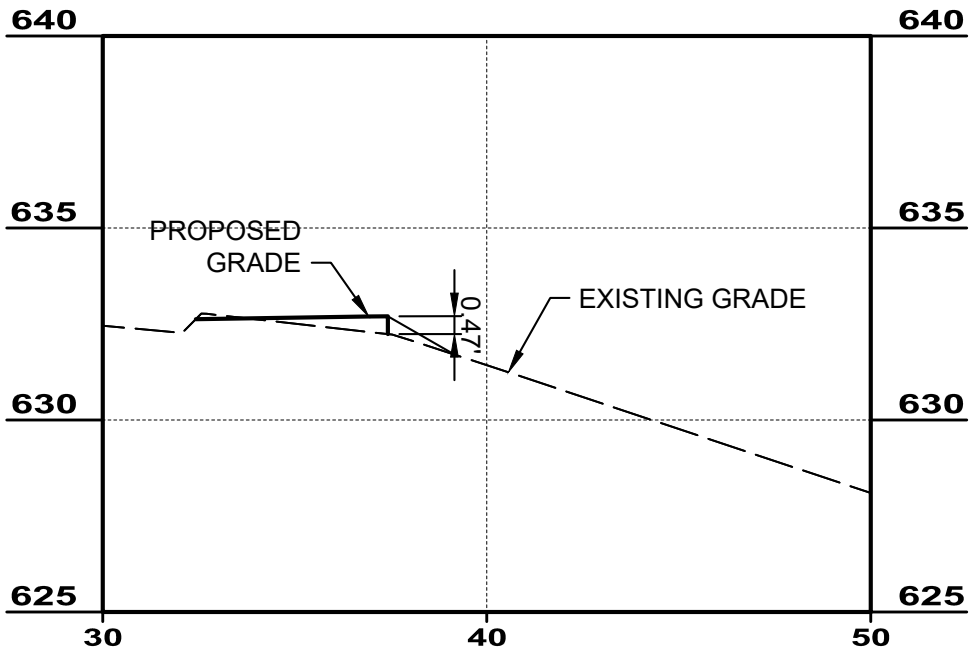

45+00.00

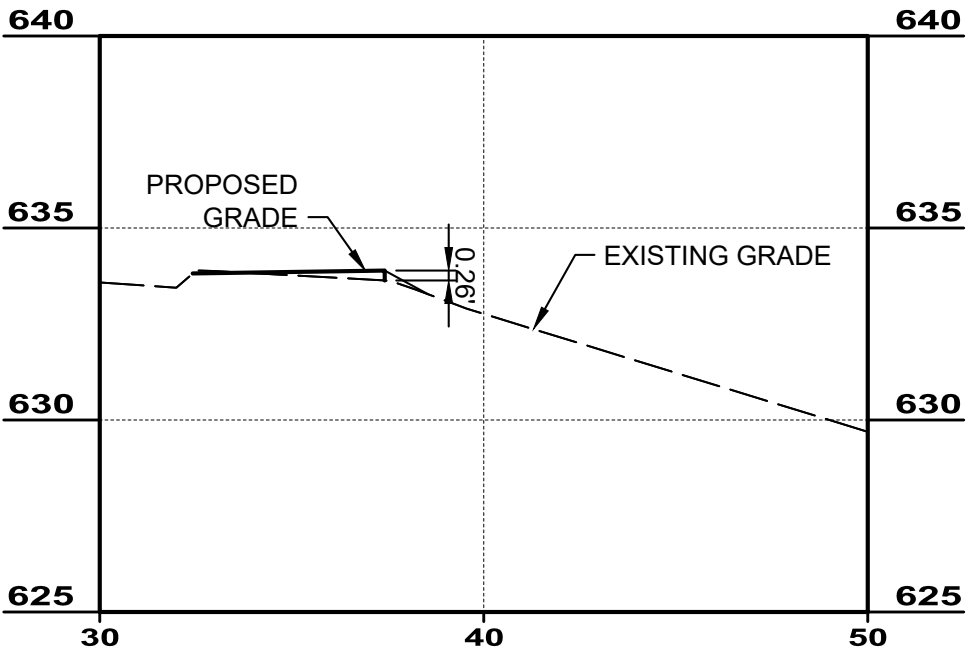

45+25.00

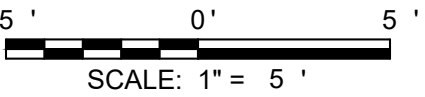

ISSUED FOR:	BIDDING	NO	REVISION	DATE
ISSUE DATE:	1/22/26			
SCALE:	AS SHOWN			
DESIGNED BY:	AJAC			
DRAWN BY:	BHAU			
CHECKED BY:	MLAC			

GLENDALE-MILFORD
SIDEWALK IMPROVEMENTS 2025
- THE VILLAGE OF WOODLAWN -

TURN DOWN SLAB SECTION VIEWS

PROJECT NO. 241608	
DISCIPLINE CIVIL	
SHEET NAME SECT	
SHEET 7	OF 8

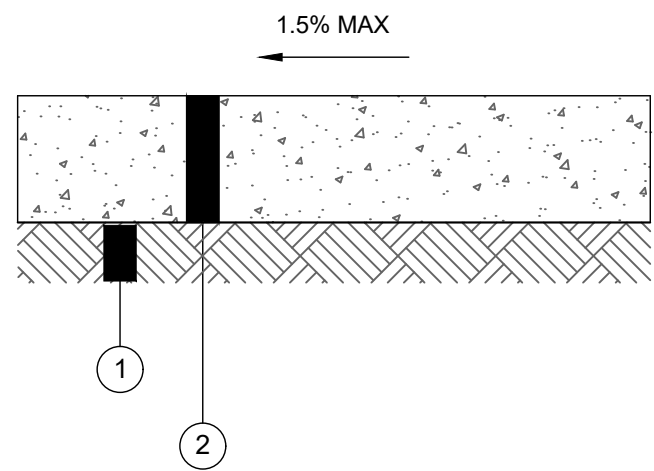

- 1 ITEM 204 - SUBGRADE COMPACTION
2 ITEM 604 - 5" CONCRETE WALK
- NOTE: CONSTRUCTION JOINTS TO BE SPACED 5' APART
EXPANSION JOINTS TO BE SPACED AT 50' APART

ITEM 608 - TYPICAL SIDEWALK

NTS

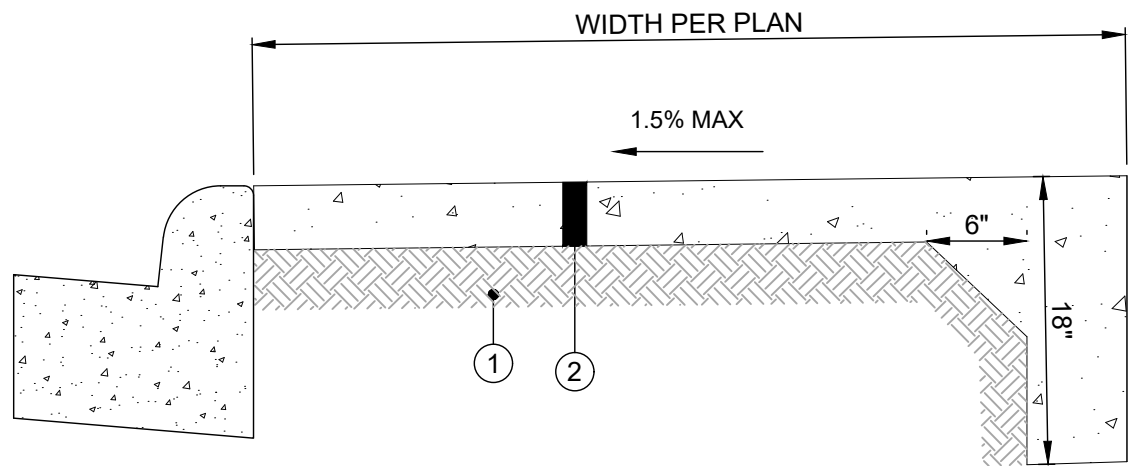

- 1 ITEM 204 - SUBGRADE COMPACTION
2 ITEM 604 - 6" CONCRETE WALK

NOTE: CONSTRUCTION JOINTS TO BE SPACED 5' APART
EXPANSION JOINTS TO BE SPACED AT 50' APART

ITEM 608 - 6" CONCRETE WALK WITH TURN DOWN SLAB

NTS

- 1 ITEM 441 - 1.25" - 4" ASPHALT CONCRETE SURFACE COURSE
2 2" - 3" MILLING
3 ITEM 204 - COMPACTED SUBGRADE

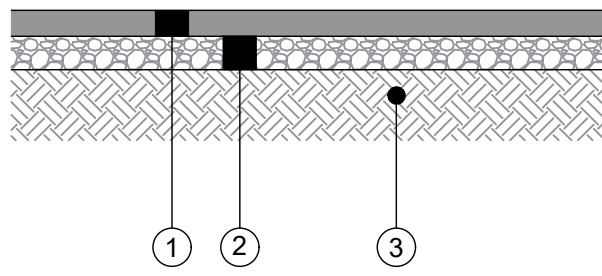

MILL AND OVERLAY COMMERCIAL ASPHALT SECTION

NTS

- 1 ITEM 441 - 1.5" ASPHALT CONCRETE SURFACE COURSE, TYPE 1 (448), PG 64-22
2 ITEM 441 - 2.5" ASPHALT CONCRETE INTERMEDIATE COURSE, TYPE 2 (448), PG 64-22
3 ITEM 301 - 4" ASPHALT CONCRETE BASE
4 ITEM 304 - 8" CRUSHED LIMESTONE AGGREGATE BASE
5 ITEM 204 - COMPACTED SUBGRADE

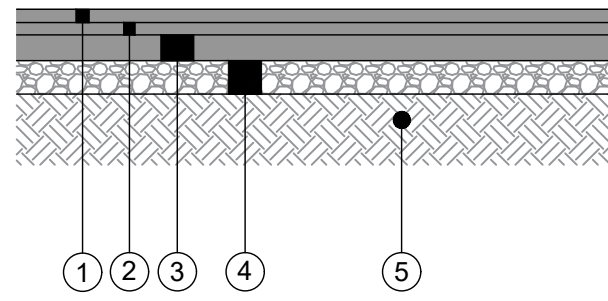

FULL DEPTH COMMERCIAL ASPHALT SECTION

NTS

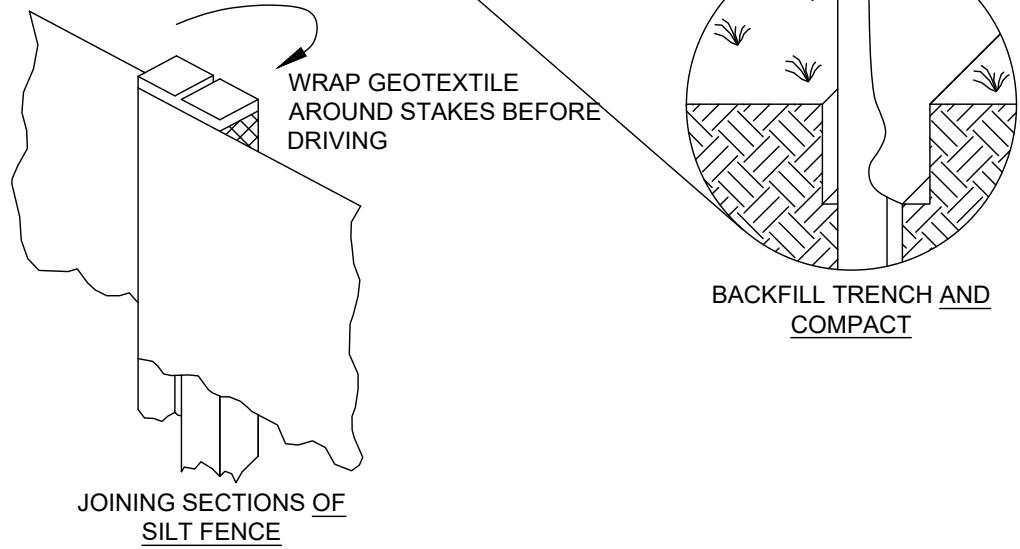
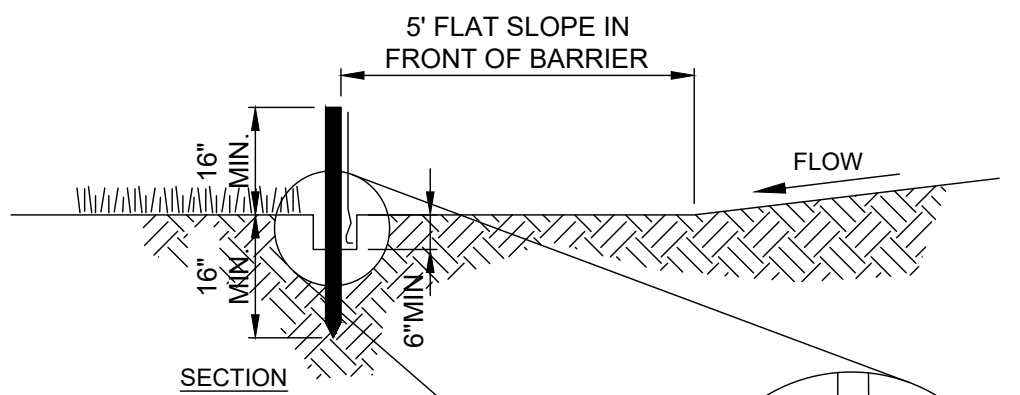
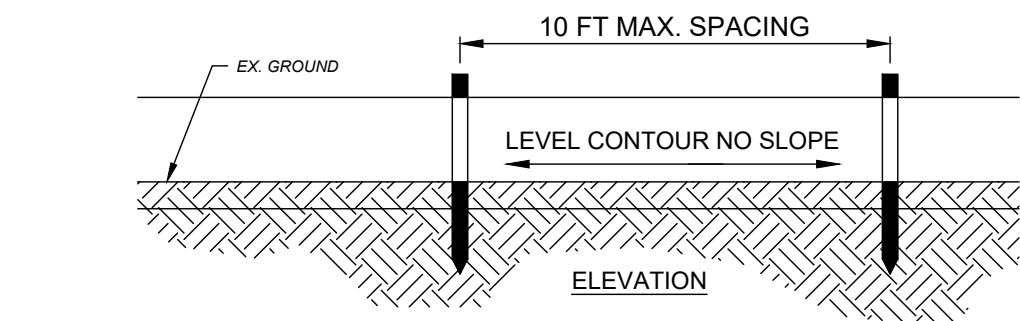

NOTES:

- PRESERVE VEGETATION FOR 5 FEET, OR AS MUCH AS POSSIBLE, UPSLOPE FROM THE SILT FENCE. IF VEGETATION IS REMOVED, IT SHALL BE RE-ESTABLISHED WITHIN 7 DAYS FROM SILT FENCE INSTALLATION.
- SILT FENCE SHALL ALLOW RUNOFF TO PASS ONLY AS DIFFUSE FLOW THROUGH THE GEOTEXTILE. PERFORM ONE OF THE FOLLOWING IF RUNOFF OVERTOPS THE SILT FENCE, FLOWS UNDER OR AROUND THE ENDS, OR IN ANY OTHER WAY BECOMES A CONCENTRATED FLOW:
 - CHANGE THE LAYOUT OF THE SILT FENCE.
 - REMOVE ACCUMULATED SEDIMENT.
 - INSTALL OTHER PRACTICES.

FABRIC PROPERTIES	VALUES	TEST METHOD
GRAB TENSILE STRENGTH	90 LB. MIN	ASTM D-1682
MULLEN BURST STRENGTH	190 PSI MIN	ASTM D-3786
SLURRY FLOW RATE	0.3 GAL./MIN./S.F. MAX.	
EQUIVALENT OPENING SIZE	40-80	US STD. SIEVE CW-02215
ULTRAVIOLET RADIATION STABILITY	90% MIN	ASTM-G-26

SILT FENCE

SCALE: NONE

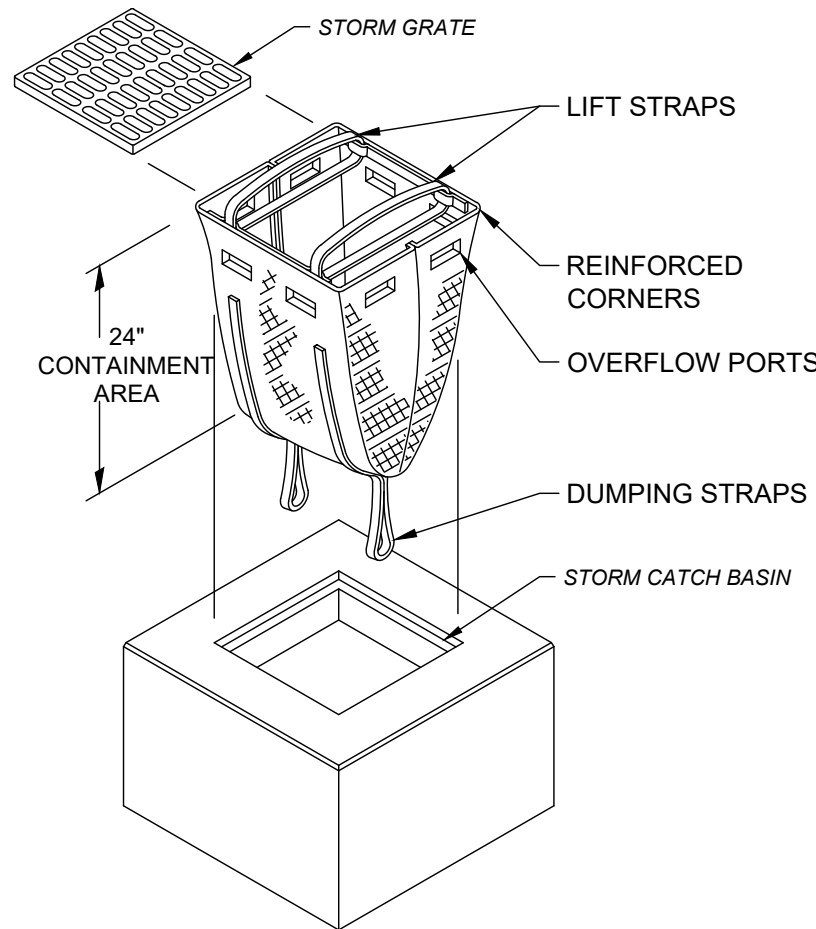

CATCH BASIN - ISOMETRIC VIEW

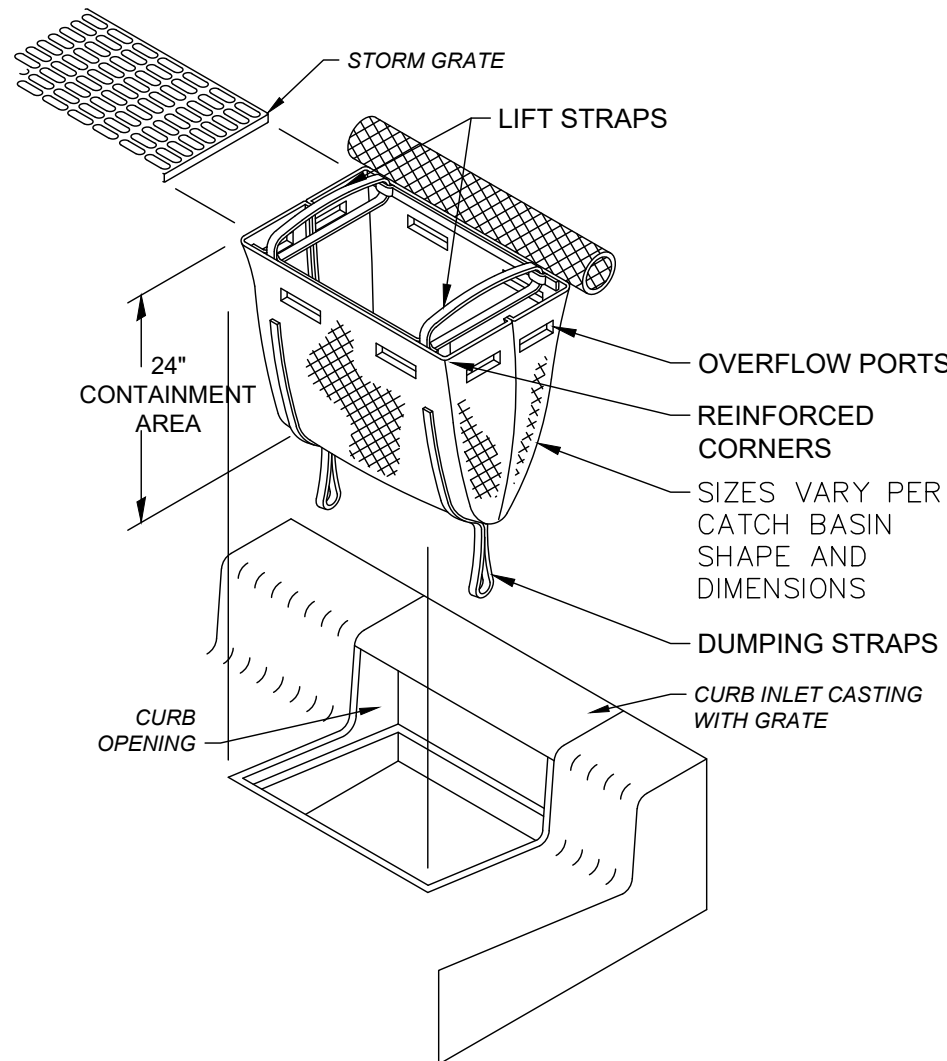

CURB INLET BASIN WITH GRATE

STORM DRAIN INLET PROTECTION DETAIL
SCALE: NONE

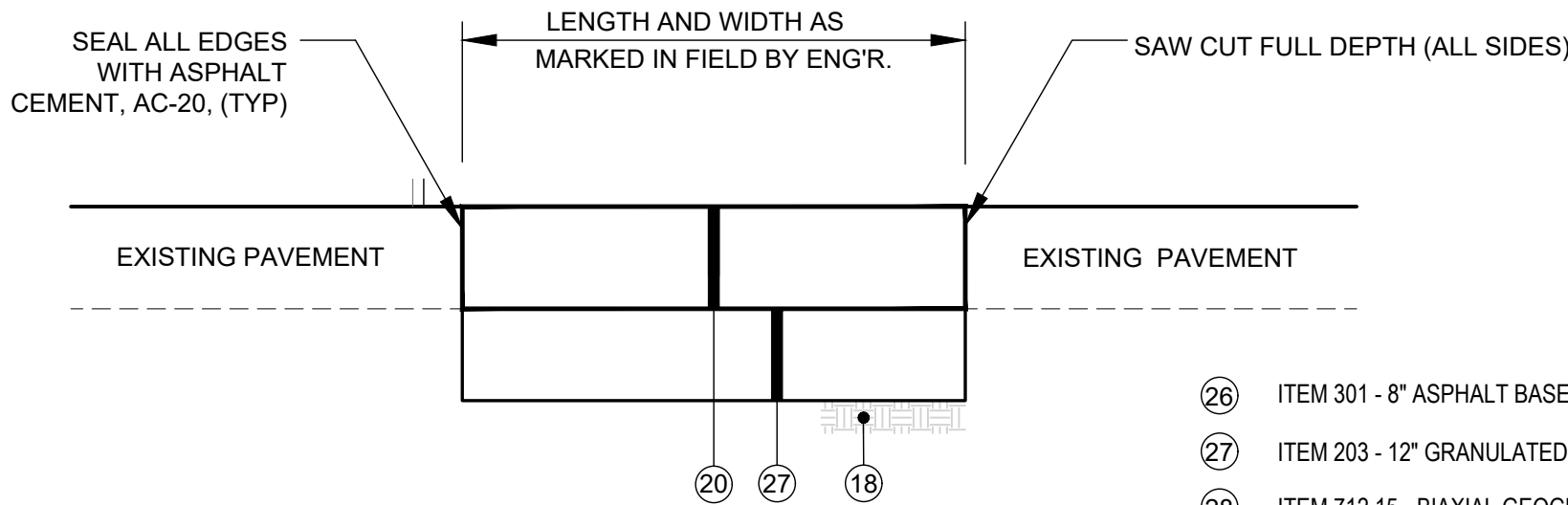

- 26 ITEM 301 - 8" ASPHALT BASE (2" - 4" LIFTS)
27 ITEM 203 - 12" GRANULATED EMBANKMENT TYPE B (2" - 6" LIFTS)
28 ITEM 712.15 - BIAXIAL GEOGRID

NOTES:

- THE FINAL AREAS TO BE REPAIRED UNDER THIS ITEM WILL BE DESIGNATED IN THE FIELD BY THE ENGINEER AND THE QUANTITY OF WORK TO BE COVERED UNDER THIS ITEM WILL BE BASED UPON MEASUREMENT OF THESE DESIGNATED AREAS.

ITEM 253 - PAVEMENT REPAIR

NTS

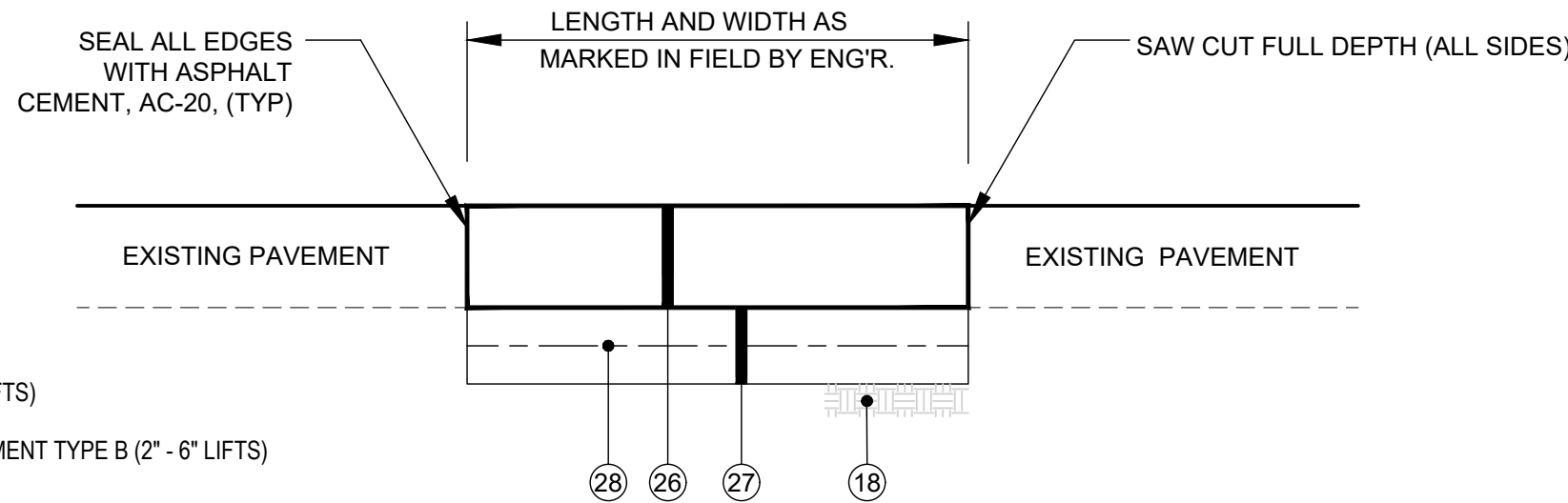

NOTES:

- THE FINAL AREAS TO BE REPAIRED UNDER THIS ITEM WILL BE DESIGNATED IN THE FIELD BY THE ENGINEER AND THE QUANTITY OF WORK TO BE COVERED UNDER THIS ITEM WILL BE BASED UPON MEASUREMENT OF THESE DESIGNATED AREAS.

ITEM 204 - SUBGRADE STABILIZATION WITH GEOGRID

NTS

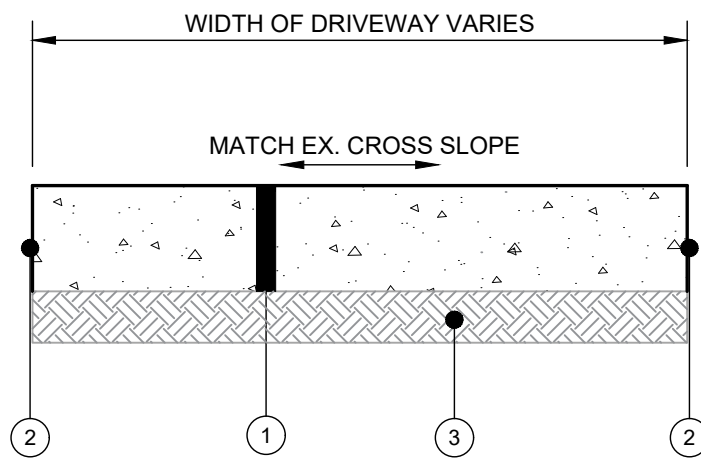

- 1 ITEM 452 - 9" NON-REINFORCED CONCRETE PAVEMENT
2 ITEM 423 - SEALED PAVEMENT EDGE
3 ITEM 204 - COMPACTED SUBGRADE

NOTES:

- THE BID ITEM IS AN ALL-INCLUSIVE COST FOR THE COMPLETE REMOVAL AND CONSTRUCTION OF THE DRIVEWAY SECTIONS AS NOTED IN THE PLANS.
 - THE INTENT IS FOR THE HORIZONTAL LOCATION TO MATCH THE EXISTING DRIVEWAY, UNLESS OTHERWISE NOTED. THE FINAL LOCATIONS, ETC., MAY BE REVIEWED BY THE ENGINEER WHO MAY ADJUST THE LOCATION AT HIS DISCRETION.
- * 1'-6" - 2'-6" TRANSITION FROM STANDARD CURB HEIGHT TO DEPRESSED CURB.

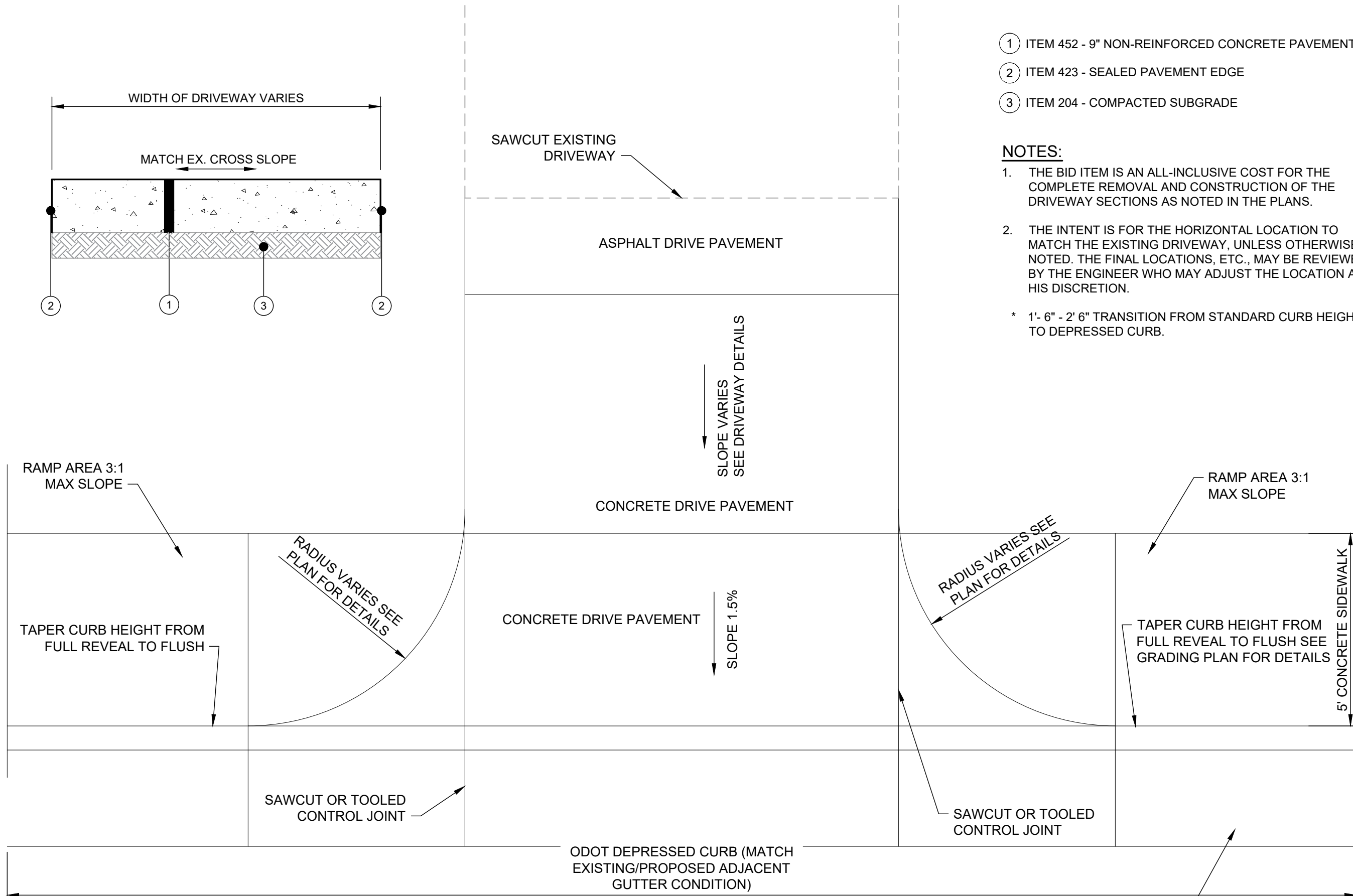

TYPICAL DRIVE WAY APRON

NTS

MATCH EXISTING/PROPOSED CURB TYPE

DATE	
REVISION	
NO	
BIDDING	
ISSUED FOR:	
ISSUE DATE:	1/22/26
SCALE:	AS SHOWN
DESIGNED BY:	AJAC
DRAWN BY:	BHAU
CHECKED BY:	MLAC

PROJECT NO.	241608
DISCIPLINE	CIVIL
SHEET NAME	DET
SHEET	8
OF	8