

CITY OF FORT THOMAS
CAMPBELL COUNTY, KENTUCKY

TOWER PARK -
TENNIS COURT IMPROVEMENTS

232586

CITY OF FORT THOMAS OFFICIALS
<div>MAYOR ERIC HAAS</div>
<div>CITY CLERK MELISSA BECKETT</div>
<div>CITY ADMINISTRATOR MATTHEW KREMER</div>
<div>CITY COUNCIL MEMBERS JEFF BEZOLD ADAM BLAU ANDY ELLISON LAUREN MCINTOSH BEN PENDERY ERIC STRANGE</div>
<div>GENERAL SERVICES DIRECTOR KEVIN BARBIAN</div>
<div>PUBLIC WORKS DIRECTOR TIM MATTINGLY</div>

INDEX OF SHEETS		
NO.	DWG NAME	SHEET NAME
1	TTL	TITLE SHEET
2	NOTES	NOTES & LEGEND
3	DTL-01	DETAIL SHEET-01
4	DTL-02	DETAIL SHEET-02
5	DTL-02	DETAIL SHEET-03
6	TRAIL-01	OUTER TRAIL IMPROVEMENTS SHEET - 01
7	TRAIL-02	OUTER TRAIL IMPROVEMENTS SHEET - 02
8	ACCESS-01	ACCESS PATH IMPROVEMENTS SHEET - 01
9	ACCESS-02	ACCESS PATH IMPROVEMENTS SHEET - 02
10	COURT-01	TENNIS COURT IMPROVEMENTS SHEET - 01

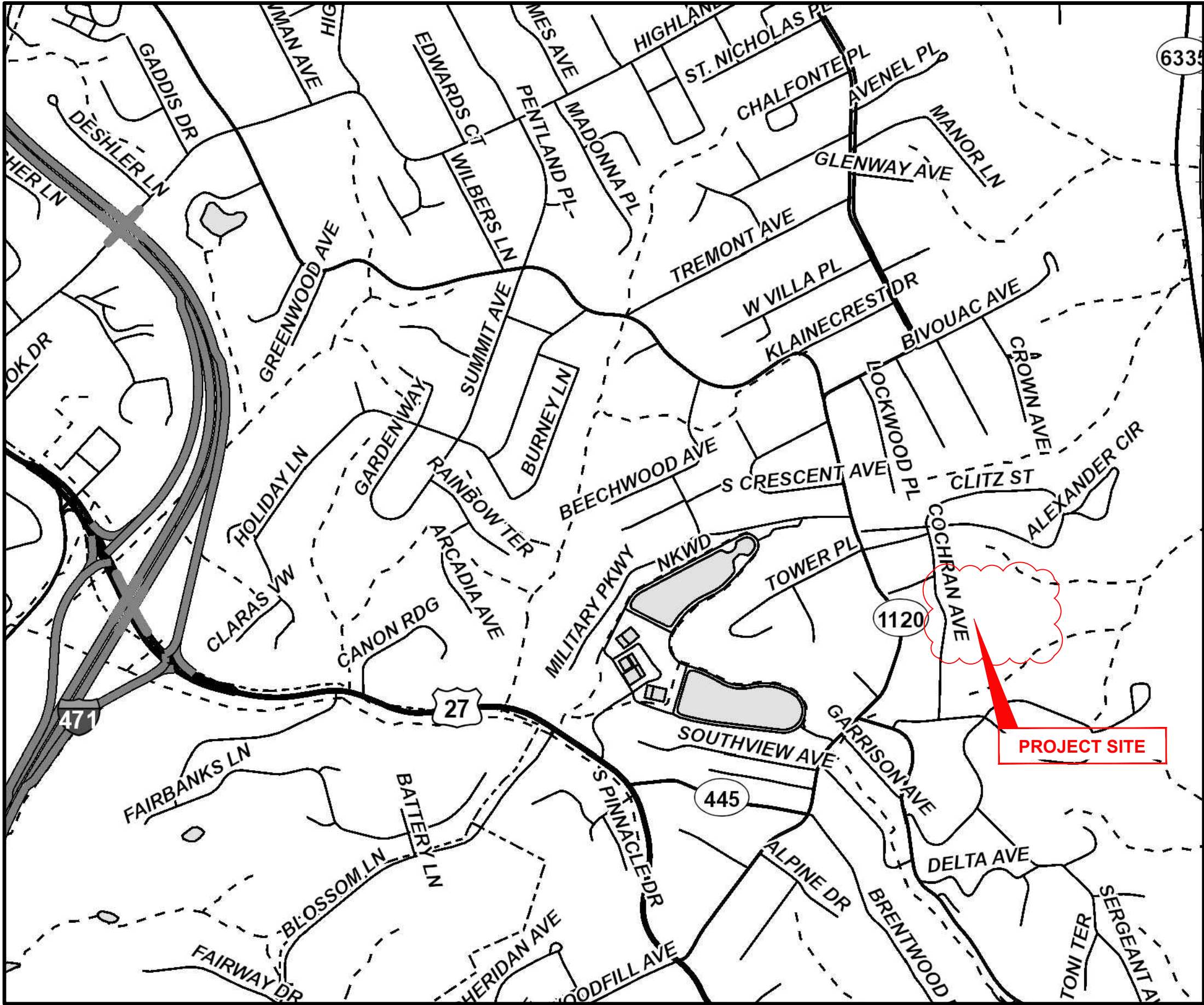

VICINITY MAP

K.T.C SPECIFICATIONS

THE LATEST STANDARD SPECIFICATIONS OF THE KENTUCKY TRANSPORTATION CABINET, INCLUDING CHANGES AND SUPPLEMENTAL SPECIFICATIONS THERETO.

SOURCE OF BOUNDARY INFORMATION

THE BOUNDARY INFORMATION SHOWN ON THESE PLANS IS BASED UPON CAMPBELL COUNTY G.I.S. MAPPING AND DOES NOT REPRESENT AN ACTUAL FIELD BOUNDARY SURVEY BY VERDANTAS LLC.

ROBERT K. SEITZINGER

P.E. #33805

verdantas

2161 CHAMBER CENTER DRIVE
FORT MITCHELL, KENTUCKY 41017
TEL: (609) 525-0944
WWW.VERDANTAS.COM

DATE					
REVISION					
NO					
BID	02/11/2025				
ISSUED FOR:					
ISSUE DATE:					
SCALE:					
DESIGNED BY:	RSEI				
DRAWN BY:	RSEI				
CHECKED BY:	FTWE				

TOWER PARK - TENNIS COURT
IMPROVEMENTS
CITY OF FORT THOMAS
- CAMPBELL COUNTY -

TITLE SHEET

PROJECT NO. 232586	
DISCIPLINE CIVIL	
SHEET NAME TTL	
SHEET 1	OF 10



[illegible]

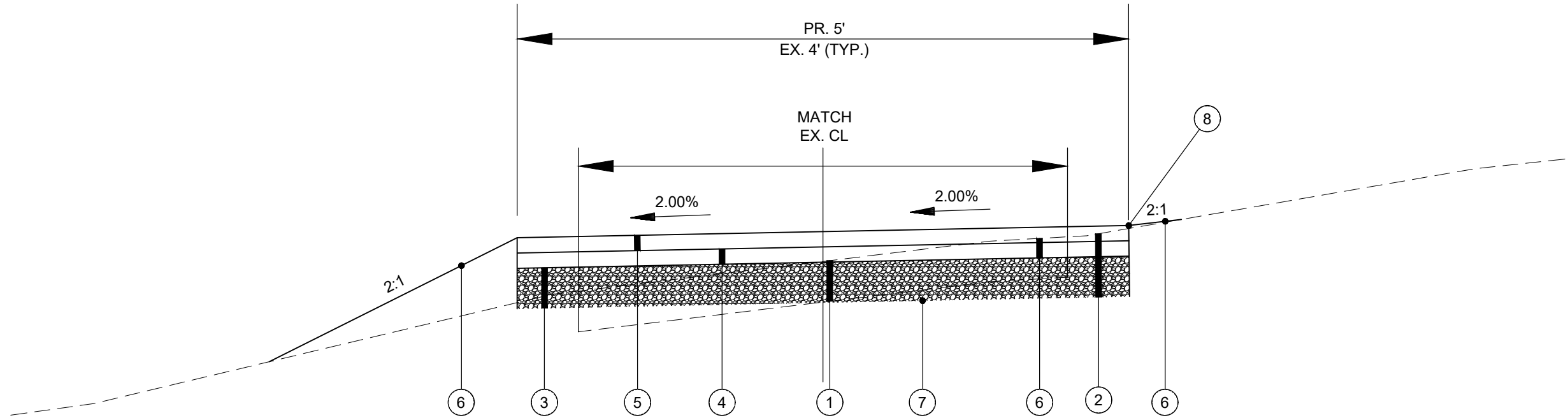

- 1 EXISTING GRAVEL PATH
2 ITEM 204 - EXCAVATION TO SUBGRADE (MAXIMUM DEPTH 7")
3 ITEM 302 - 4" STONE BASE.
4 ITEM 402 / 403 - 1-1/2" ASPHALT BASE COURSE
5 ITEM 402/403 - 1-1/2" ASPHALT SURFACE COURSE
6 ITEM SPL - YARD RESTORATION (TOPSOIL, SEED & MULCH)
7 ITEM 207 - SUBGRADE COMPACTION.
8 HOLD ELEVATION ON UPHILL SIDE OF PATH.

ASPHALT PATH
N.T.S.

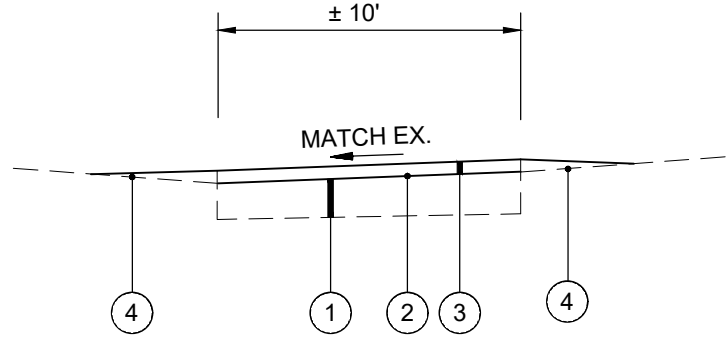

- 1 EXISTING ASPHALT PAVEMENT
2 ITEM 406 - TACK COAT @ 0.1 GAL/SY (INCIDENTAL TO ITEM 403)
3 ITEM 402/403 - 1 1/2" ASPHALT SURFACE COURSE
4 ITEM SPL - YARD RESTORATION (TOPSOIL, SEED & MULCH)

TYPICAL ASPHALT PAVEMENT OVERLAY
N.T.S.

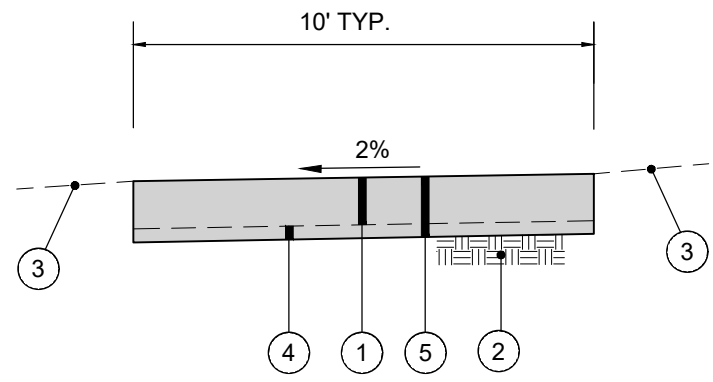

6" CONCRETE PAVEMENT REPLACEMENT
N.T.S.



- 1 ITEM 203 - REMOVE EXISTING PAVEMENT.
2 ITEM 207 - COMPACTED SUBGRADE
3 ITEM SPL - YARD RESTORATION (4" TOPSOIL, SEED AND MULCH) - KEEP TO A MINIMUM.
4 ITEM 204 - EXCAVATION TO PROPOSED SUBGRADE
5 ITEM 505 - 6" PORTLAND CEMENT CONCRETE PAVEMENT

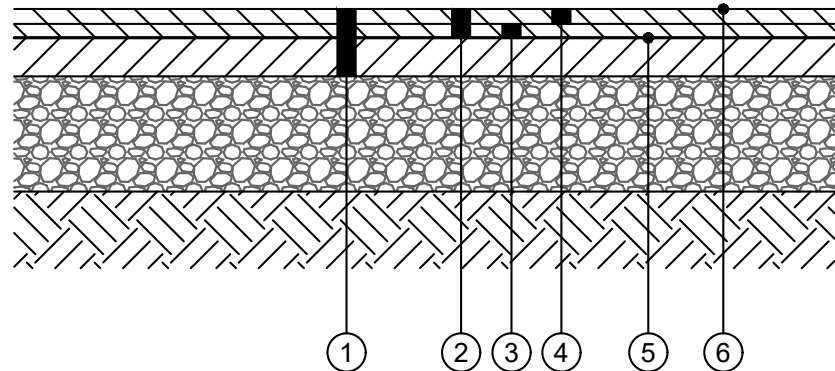

- 1 EXISTING ASPHALT COURT
2 ITEM 408 - 2" ASPHALT MILLING
3 ITEM 403 - 3/4" ASPHALT LEVELING COURSE
4 ITEM 403 - 1-1/4" ASPHALT SURFACE COURSE
5 ITEM 406 - NON-TRACKING TACK COAT INTERMEDIATE COURSE @ 0.1 GAL/ SY
6 ACRYLIC COLOR COATING FOR COURT SURFACE

2" ASPHALT COURT MILL & OVERLAY DETAIL
NTS

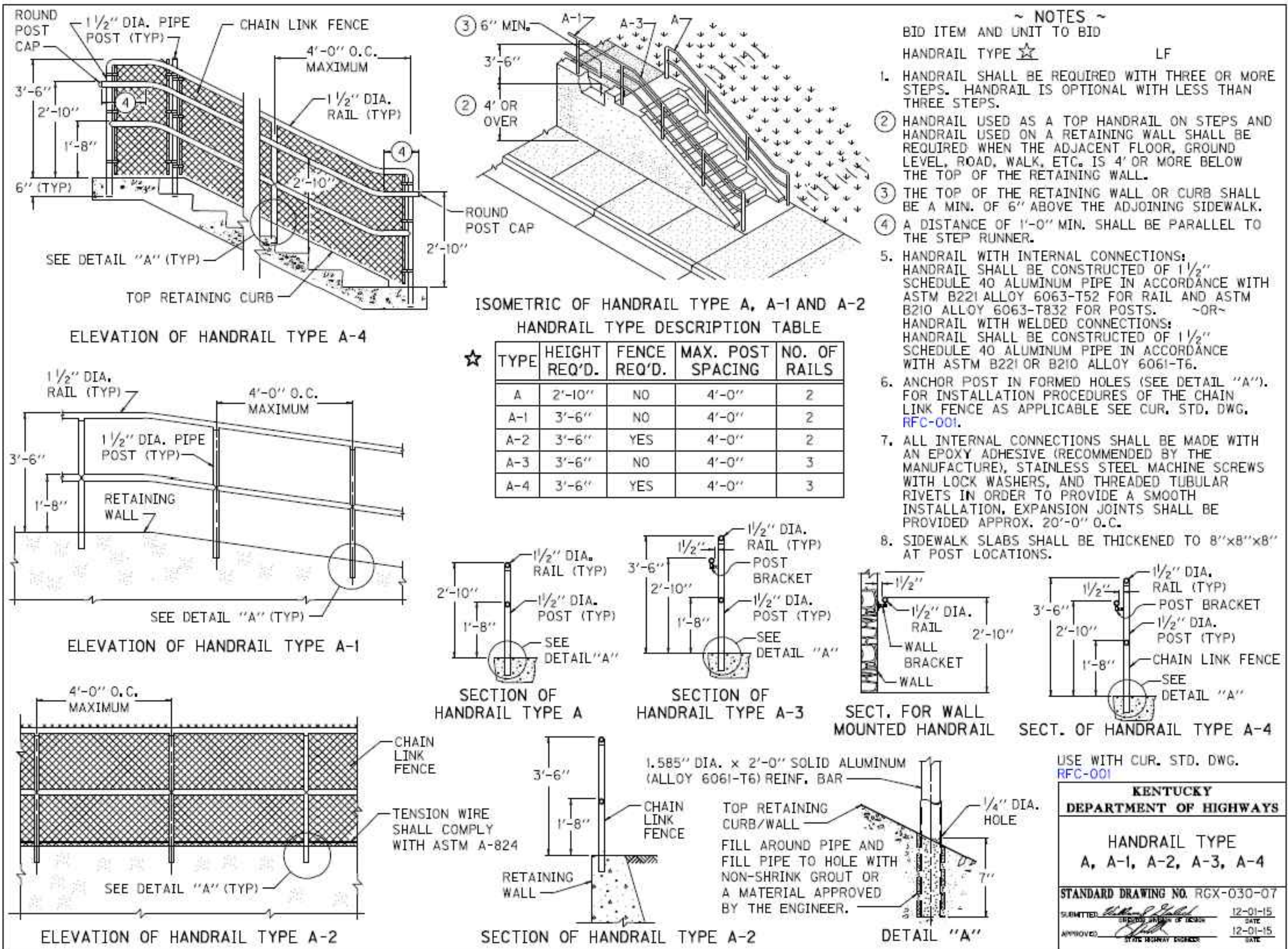

TOWER PARK - TENNIS COURT
IMPROVEMENTS
CITY OF FORT THOMAS
- CAMPBELL COUNTY -

DETAIL SHEET - 01

ISSUED FOR	BID	NO	REVISION	DATE
02/11/2025				
SCALE:				
DESIGNED BY:				
DRAWN BY:				
CHECKED BY:				

PROJECT NO.	232586
DISCIPLINE	CIVIL
SHEET NAME	DTL-01
SHEET	3
OF	10

verdantas

2161 CHAMBER CENTER DRIVE
FORT MITCHELL, KENTUCKY 41017
TEL. (609) 525-0544
WWW.VERDANTAS.COM

NOTES:

ACRYLIC COLOR:
ACRYLIC COLOR COATING FOR COURT SURFACE. DYNAFLEX MATERIALS OR APPROVED
EQUAL (2 COAT RESURFACER, 3 COATS OF COLOR COATING). INCLUDES ANY REQUIRED
LEVELING OF ASPHALT SURFACE WITH DYNABINDER QUICK PATCH BINDER.

COURT COLORING HATCH LEGEND

- COLOR : TOURNAMENT BLUE
- COLOR : TOURNAMENT GREEN
- STRIPING TO BE 2" WIDE WHITE.
- STRIPING TO BE 2" WIDE RED.

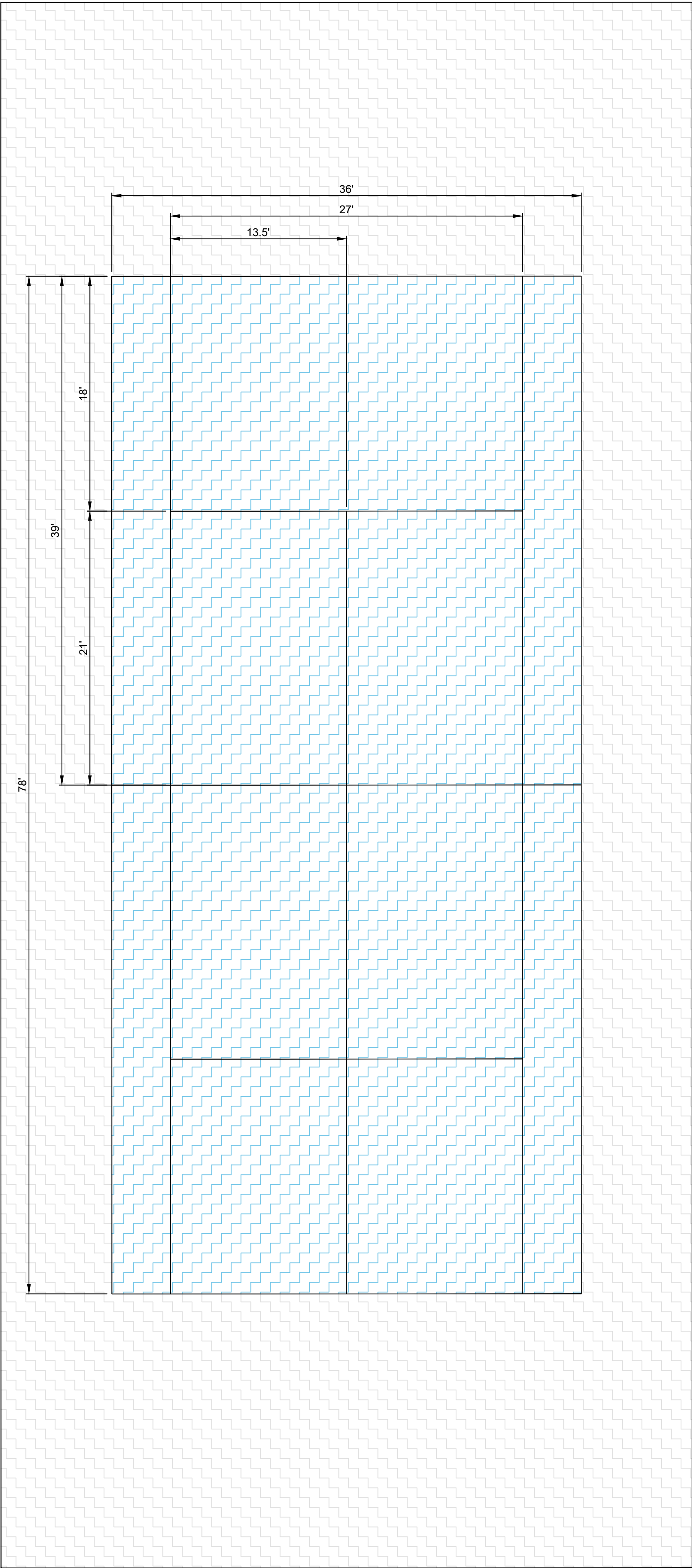

STANDARD TENNIS COURT

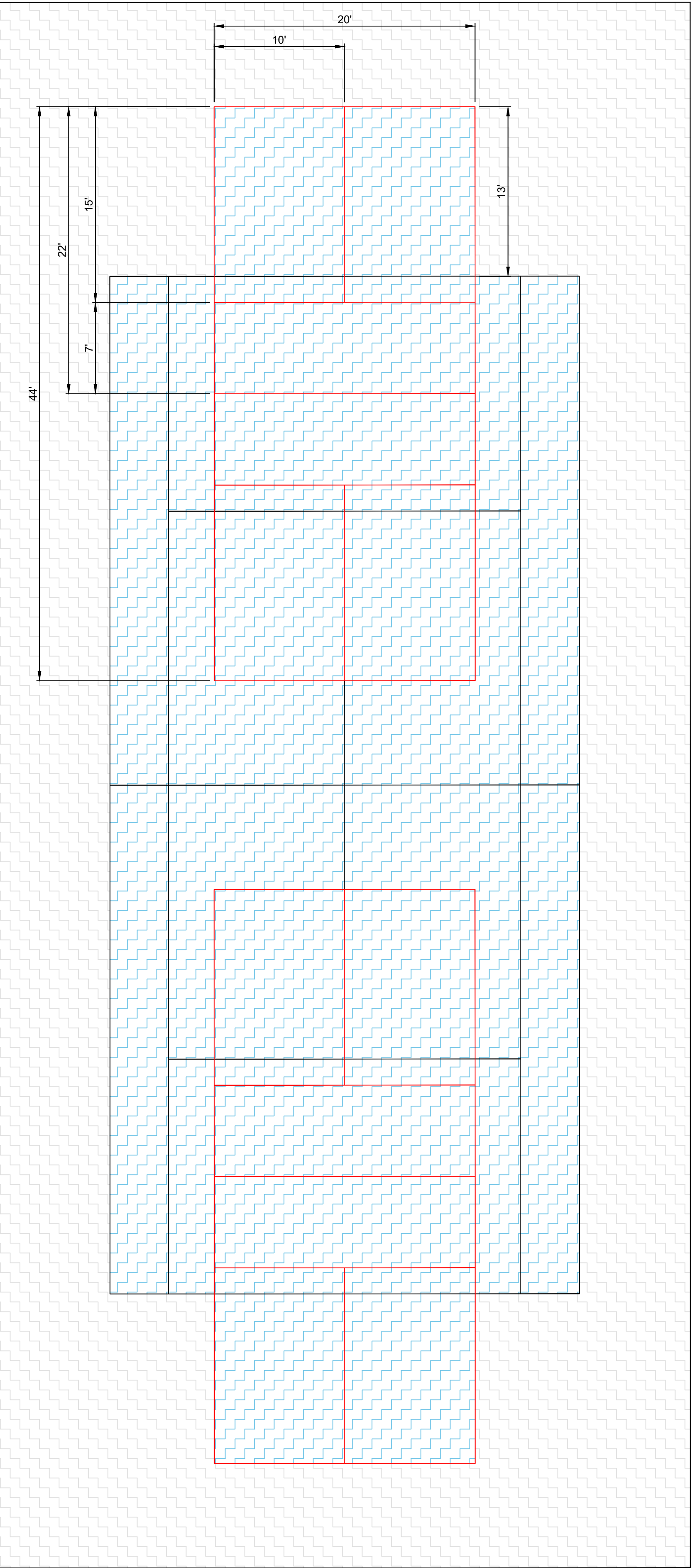

DUAL USE COURT

TOWER PARK - TENNIS COURT
IMPROVEMENTS
CITY OF FORT THOMAS
- CAMPBELL COUNTY -

DETAIL SHEET - 02

PROJECT NO. 232586	
DISCIPLINE CIVIL	
SHEET NAME DTL-02	
SHEET 4	OF 10

ISSUED FOR:	BID	NO	REVISION	DATE
ISSUE DATE:	02/11/2025			
SCALE:				
DESIGNED BY:	RSEI			
DRAWN BY:	RSEI			
CHECKED BY:	FTWE			

verdantas

2161 CHAMBER CENTER DRIVE
FORT MITCHELL, KENTUCKY 41017
TEL: (609) 525-0944
WWW.VERDANTAS.COM

Technical drawing of a chain-link fence assembly showing components and dimensions:

- Components:** TOP RAIL, LINE POST, CHAIN-LINK FABRIC, TIE WIRE OR CLIPS (TYP.), TENSION WIRE, BRACE RAILS, TRUSS ROD (3/8" TYP.), CORNER, END OR PULL POST, CONCRETE BASE, GRADE, HOG RING (TYP.), BOTTOM OF FABRIC.
- Dimensions:**
 - 16" MIN. DIA. (Post diameter)
 - 3'-4" MIN. (Post height)
 - 6" (Base height)
 - 10'-0" MAX. (Post spacing)
 - 3'-4" MIN. (Post height)
 - 6" (Base height)
 - 10'-0" (Post spacing)
 - 10'-0" MAX. (Overall length)
 - 10" MIN. DIA. (Hog ring diameter)
 - FABRIC WIDTH (Fence height)
- Notes:**
 - MAXIMUM LINE POSTS TO BE EVENLY SPACED

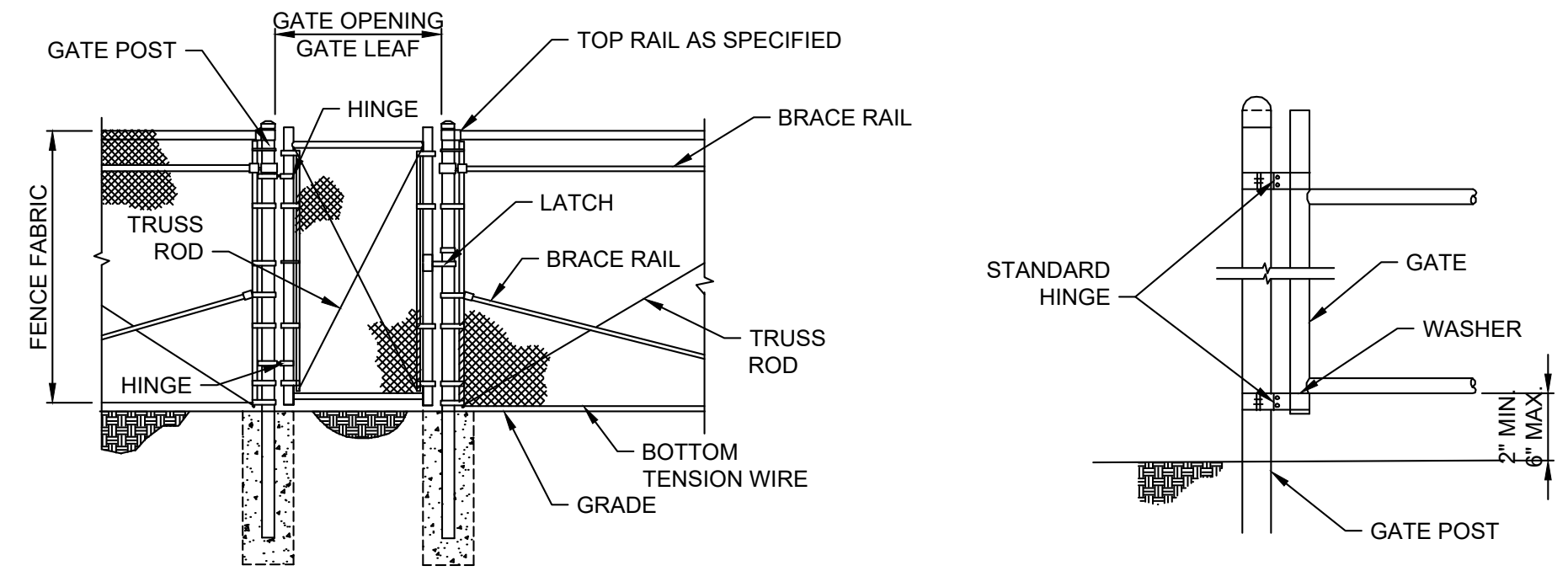

--	--	--

GATE POST SCHEDULE	
GATE LEAF WIDTH (NOMINAL)	OUTSIDE DIMENSION (NOMINAL)
6' OR LESS	2.875" O.D 2.5" SQ.
6' TO 13'	4" O.D.

1. ALL CHAIN-LINK MATERIALS AND INSTALLATION SHALL CONFORM TO SECTION 721 OF THE KYTC STANDARD SPECIFICATIONS. CHAIN LINK SHALL BE BLACK VINYL COATED.
2. DETAILS SHOWN ARE TO CLARIFY REQUIREMENTS AND ARE NOT INTENDED TO LIMIT OTHER TYPES OF FENCE SECTIONS AND METHODS OF INSTALLATION
3. WIRE TIES, RAILS, POSTS AND BRACES SHALL BE CONSTRUCTED ON THE SECURE SIDE OF THE FENCE ALIGNMENT. CHAIN-LINK FABRIC SHALL BE PLACED ON THE OPPOSITE SIDE OF THE SECURE AREA
4. C-SECTION POSTS BE INSTALLED SO THAT THE VOID INSIDE THE POST IS COMPLETELY FILLED WITH CONCRETE UP TO THE TOP OF THE FOUNDATION.
5. SWING GATES SHALL BE CONSTRUCTED WITH DROP RODS, PADLOCK, LATCH ASSEMBLY AND GATE KEEPERS EXCEPT WHERE NOTED.
6. ALL GATE FRAMES SHALL BE A MINIMUM 1.90" NOMINAL (ROUND) OR 2.00" NOMINAL (SQUARE). GATE FRAMES SHALL BE OF WELDED CONSTRUCTION OR SHALL BE ASSEMBLED USING HEAVY FITTINGS. AT CONTRACTOR'S OPTION A WELDED HORIZONTAL BRACE MAY BE USED IN LIEU OF TRUSS RODS TO BRACE ALL WELDED GATE FRAMES. THE CONTRACTOR SHALL BE RESPONSIBLE FOR THE PROPER RIGID CONSTRUCTION OF ALL GATES SUPPLIED.

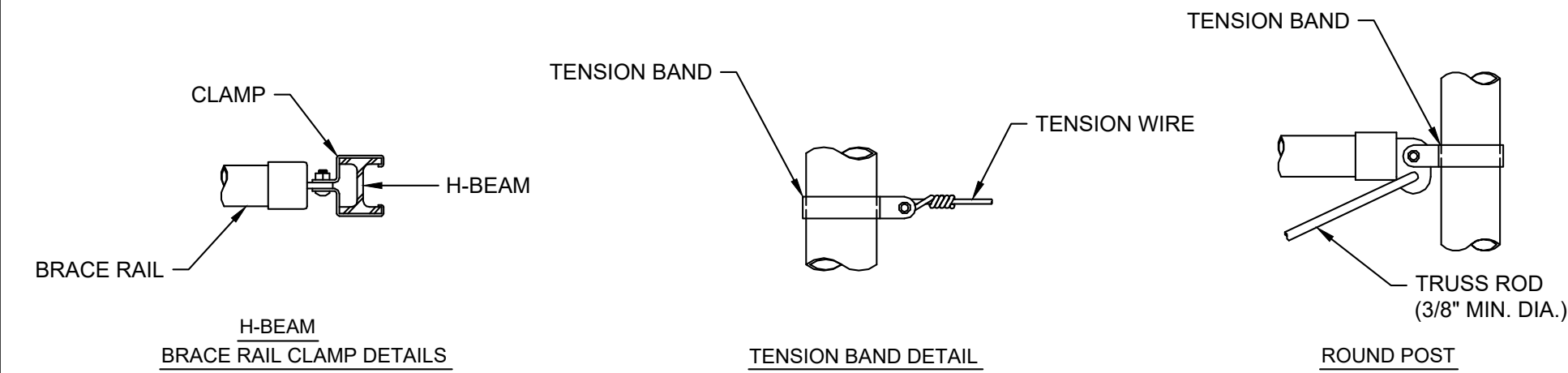
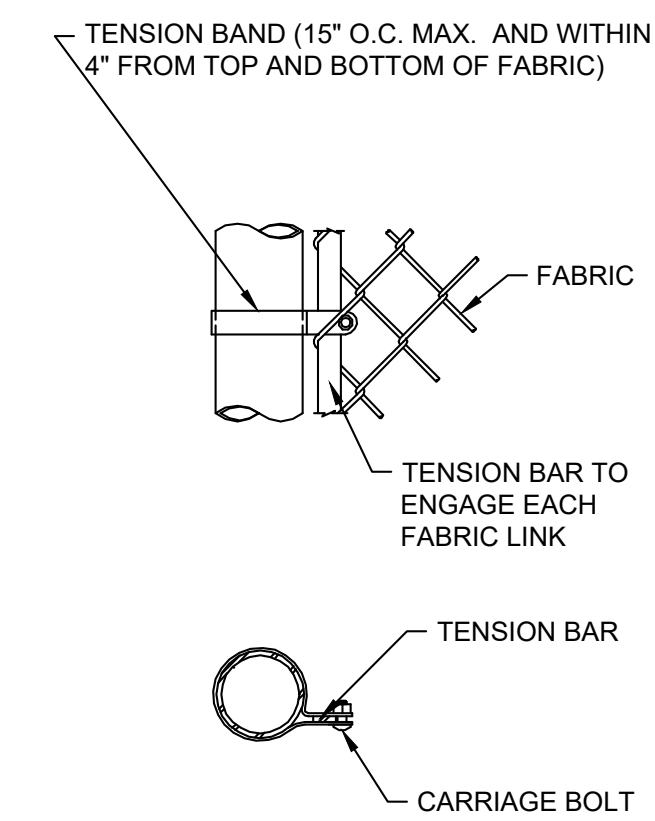
[illegible]

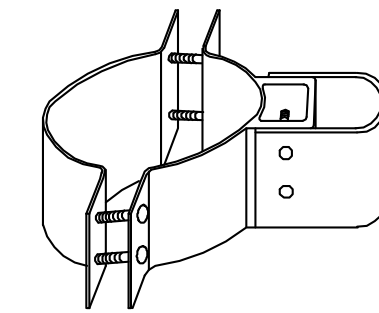

--	--

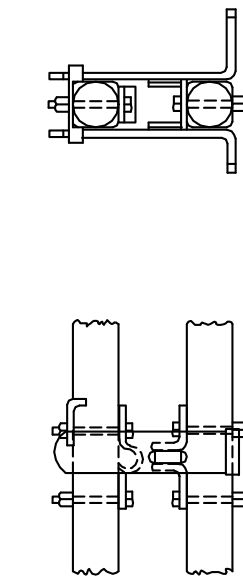

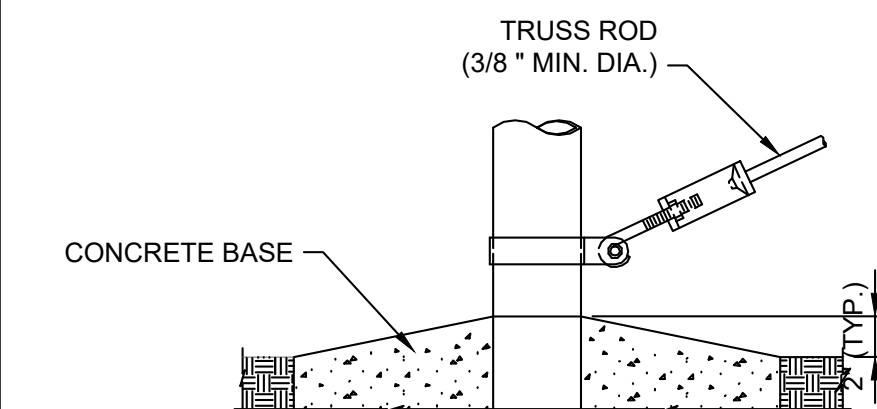

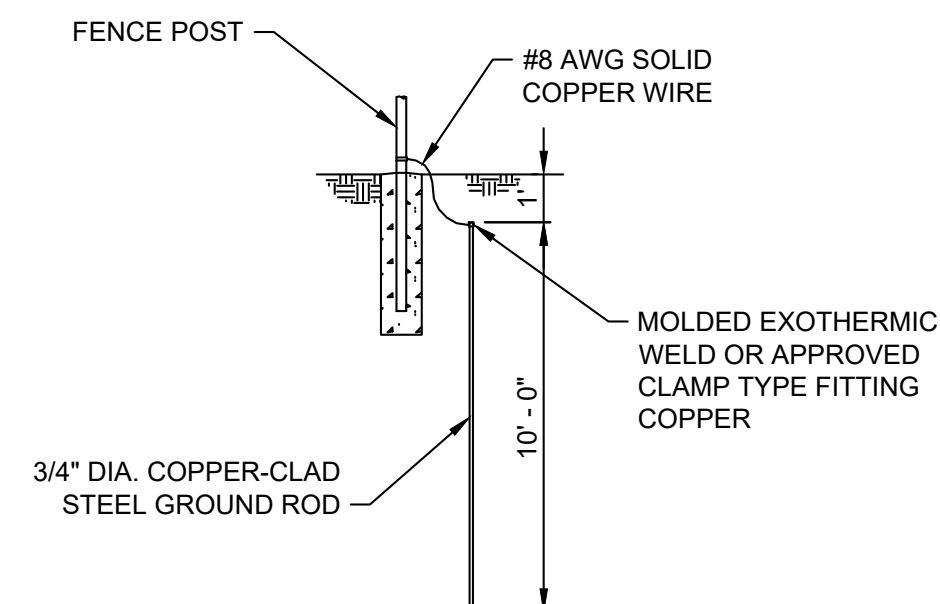

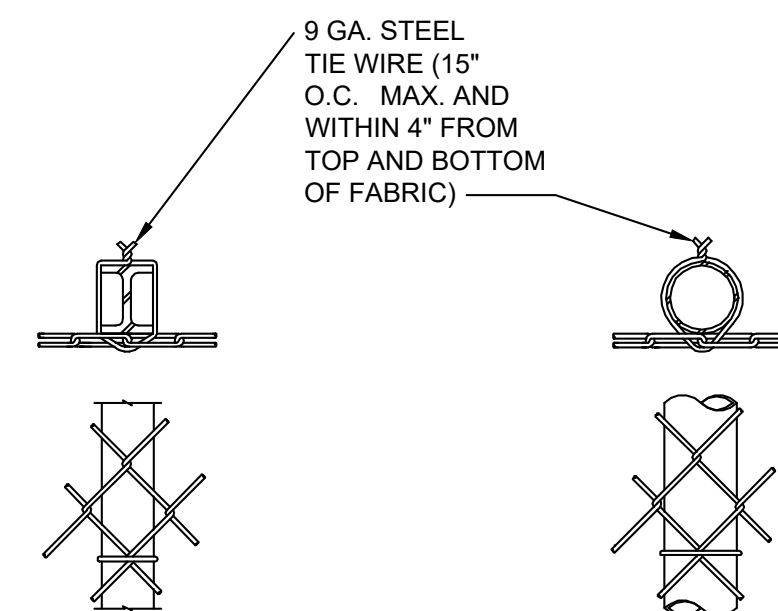

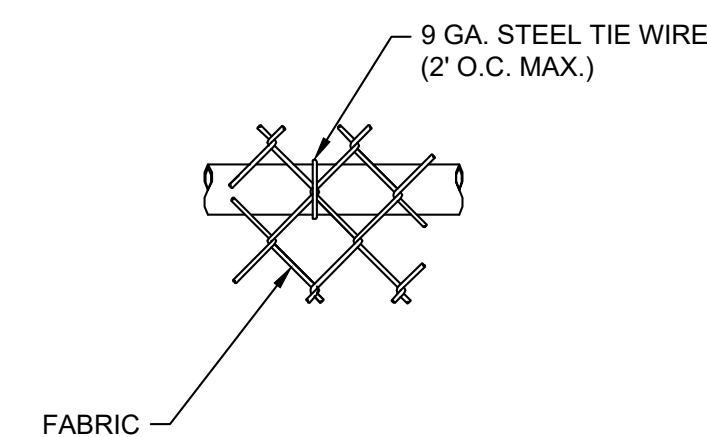

ISSUED FOR:	BID	NO	REVISION	DATE
ISSUE DATE:	02/11/2025			
SCALE:				
DESIGNED BY:	RSEI			
DRAWN BY:	RSEI			
CHECKED BY:	FTWE			

PROJECT NO.	
232586	
DISCIPLINE	
CIVIL	
SHEET NAME	
DTL-03	
SHEET	OF
5	10

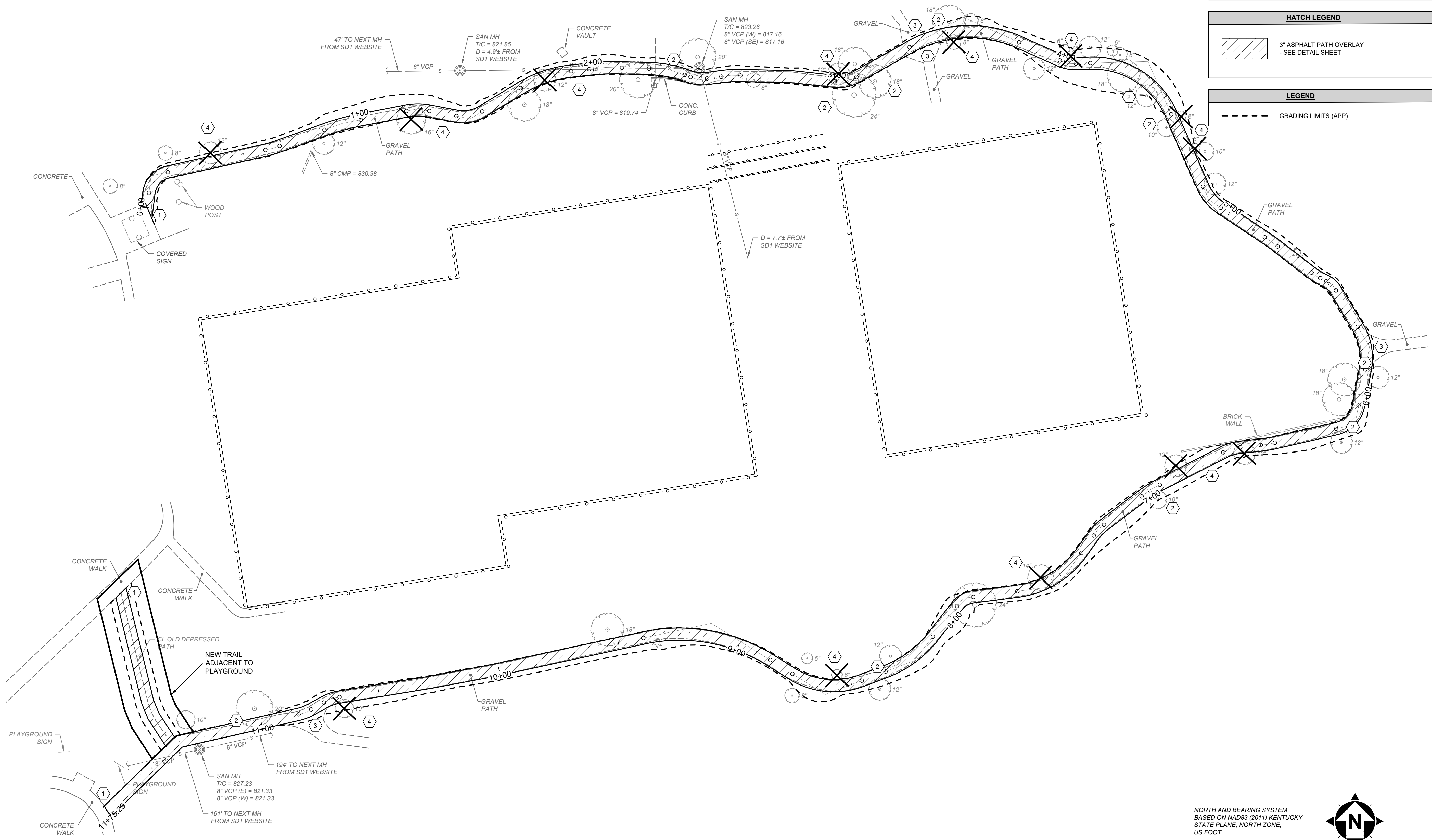

CONSTRUCTION NOTES - OUTER TRAIL

- 1 REMOVE EX. GRAVEL AS NEEDED TO ALLOW FOR ASPHALT TO MEET FLUSH WITH EX CONCRETE SIDEWALK.
- 2 EX. TREE TO REMAIN. DIG WITH CAUTION TO AVOID DAMAGE TO ROOTS.
- 3 ADD GRAVEL AS NEEDED TO MATCH NEW TRAIL ELEVATION
- 4 TREE REMOVAL BY CITY. IF CONTRACTOR IDENTIFIES TREES THAT SHOULD BE REMOVED BUT WERE NOT, CONTACT THE ENGINEER TO COORDINATE FOR THE REMOVAL.

HATCH LEGEND

- 3" ASPHALT PATH OVERLAY - SEE DETAIL SHEET

LEGEND

- GRADING LIMITS (APP)

NORTH AND BEARING SYSTEM
BASED ON NAD83 (2011) KENTUCKY
STATE PLANE, NORTH ZONE,
US FOOT.

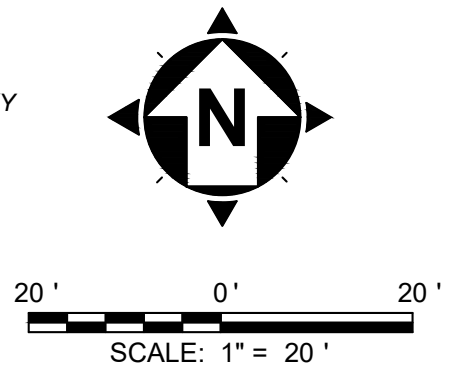

2161 CHAMBER CENTER DRIVE
FORT MITCHELL, KENTUCKY 41017
TEL: (609) 525-0544
WWW.VERDANTAS.COM

ISSUED FOR:	BID NO	REVISION	DATE
ISSUE DATE:	02/11/2025		
SCALE:			
DESIGNED BY:	RSEI		
DRAWN BY:	RSEI		
CHECKED BY:	FTWE		

TOWER PARK - TENNIS COURT
IMPROVEMENTS
CITY OF FORT THOMAS
- CAMPBELL COUNTY -

OUTER TRAIL IMPROVEMENTS
SHEET - 01

PROJECT NO.	
232586	
DISCIPLINE	
CIVIL	
SHEET NAME	
TRAIL-01	
SHEET	OF
6	10

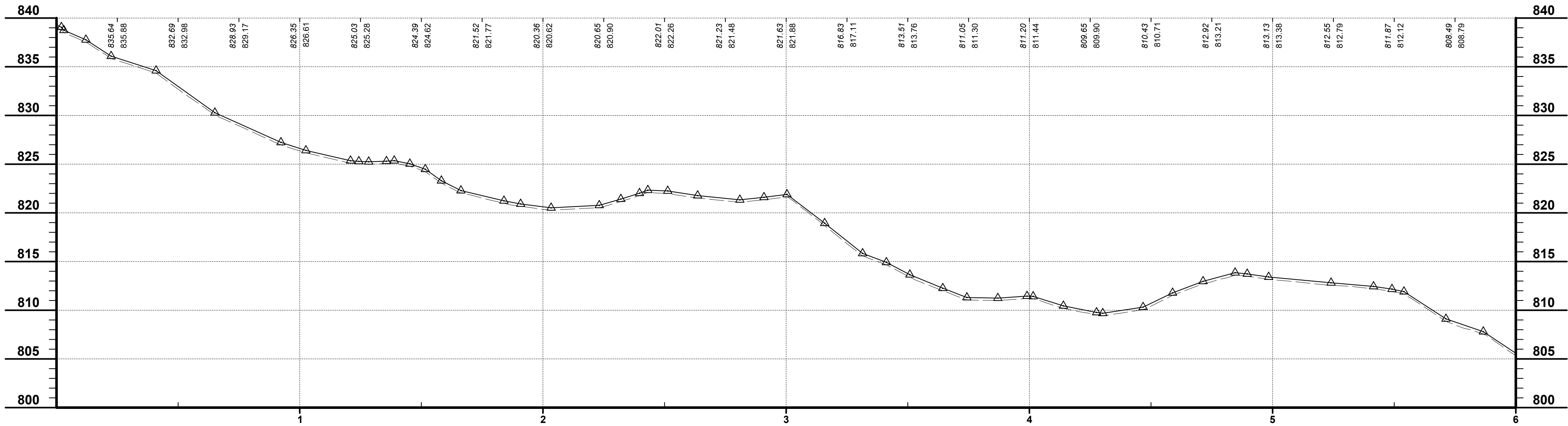

PRO-1

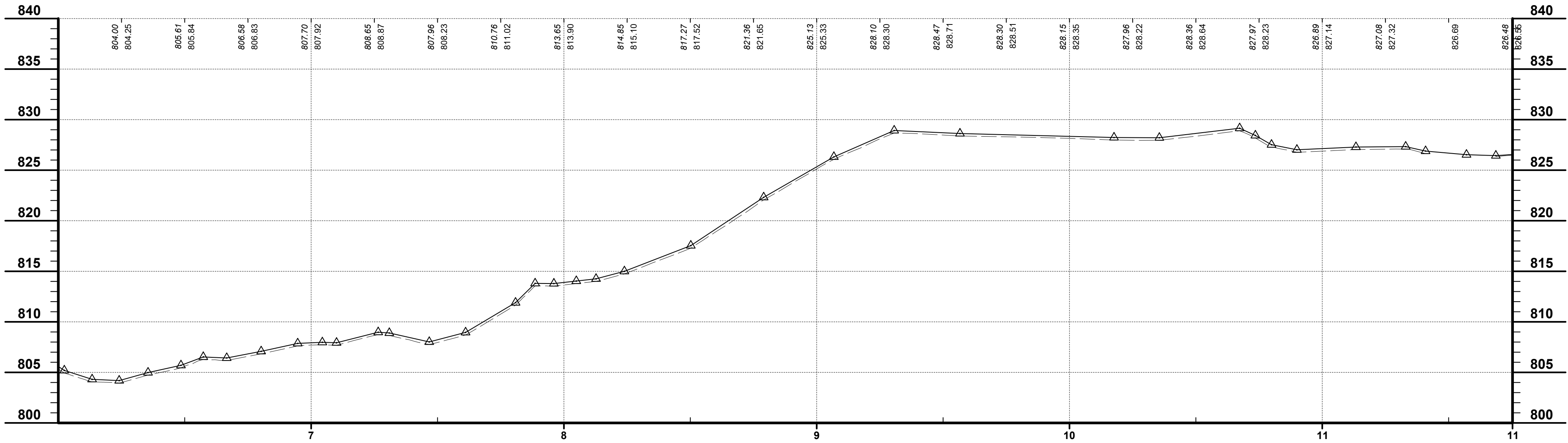

PRO-2

TOWER PARK - TENNIS COURT

IMPROVEMENTS

CITY OF FORT THOMAS

- CAMPBELL COUNTY -

OUTER TRAIL IMPROVEMENTS

SHEET - 02

PROJECT NO.	
232586	
DISCIPLINE	
CIVIL	
SHEET NAME	
TRAIL-02	
SHEET	OF
7	10

ISSUED FOR:	BID	NO	REVISION	DATE
ISSUE DATE:	02/11/2025			
SCALE:				
DESIGNED BY:	RSEI			
DRAWN BY:	RSEI			
CHECKED BY:	FTWE			



2161 CHAMBER CENTER DRIVE
FORT MITCHELL, KENTUCKY 41017
TEL: (609) 525-0544
WWW.VERDANTAS.COM

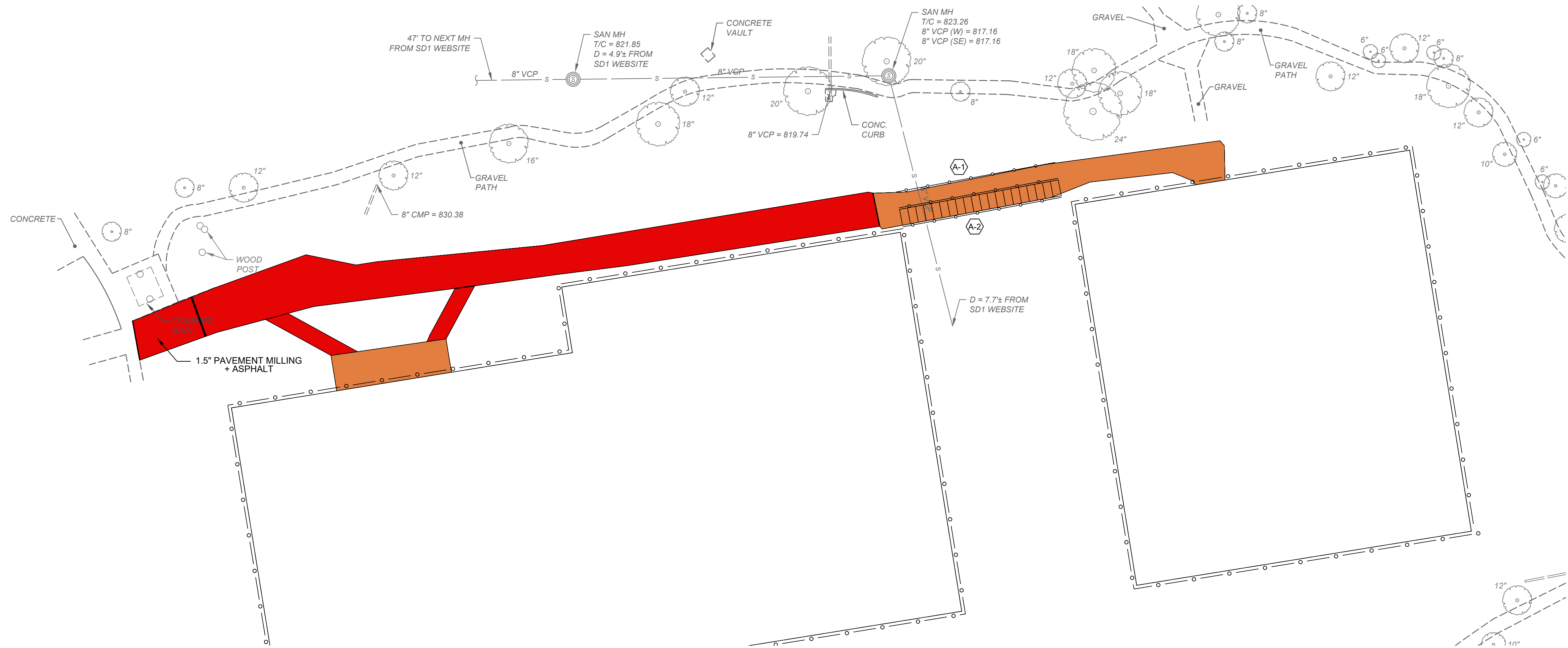

CONSTRUCTION NOTES - ACCESS PATH

- A-1** INSTALL HANDRAIL ALONG NORTHERN SIDE OF PROPOSED CONCRETE PATH.
- A-2** ALTERNATE BID: INSTALL STEPS WITH HANDRAIL ALONG SOUTHERN SIDE OF PATH. SEE ACCESS-02 FOR MORE DETAIL

HATCH LEGEND

- 1.5" PAVEMENT MILLING & ASPHALT PATH OVERLAY- SEE DETAIL SHEET
- REMOVED EX ASPHALT PATH AND RECONSTRUCT WITH CONCRETE - SEE DETAIL SHEET - FINAL LOCATION MARKED IN FIELD

REMOVED EX ASPHALT PATH AND RECONSTRUCT WITH CONCRETE (WITHIN LIMITS OF RED BOX) - SEE DETAIL SHEET



1.5" PAVEMENT MILLING & ASPHALT PATH OVERLAY- SEE DETAIL SHEET

REMOVED EX ASPHALT PATH AND RECONSTRUCT WITH CONCRETE - SEE DETAIL SHEET - FINAL LOCATION MARKED IN FIELD

NORTH AND BEARING SYSTEM
BASED ON NAD83 (2011) KENTUCKY
STATE PLANE, NORTH ZONE,
US FOOT.

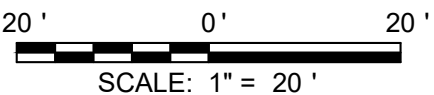
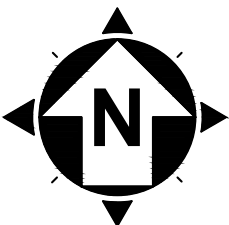

TOWER PARK - TENNIS COURT
IMPROVEMENTS
CITY OF FORT THOMAS
- CAMPBELL COUNTY -

ACCESS PATH IMPROVEMENTS
SHEET - 01

PROJECT NO. 232586	
DISCIPLINE CIVIL	
SHEET NAME ACCESS-01	
SHEET 8	OF 10

ISSUED FOR:	BID	NO	REVISION	DATE
ISSUE DATE:	02/11/2025			
SCALE:	RSEI			
DESIGNED BY:	RSEI			
DRAWN BY:	RSEI			
CHECKED BY:	FTWE			

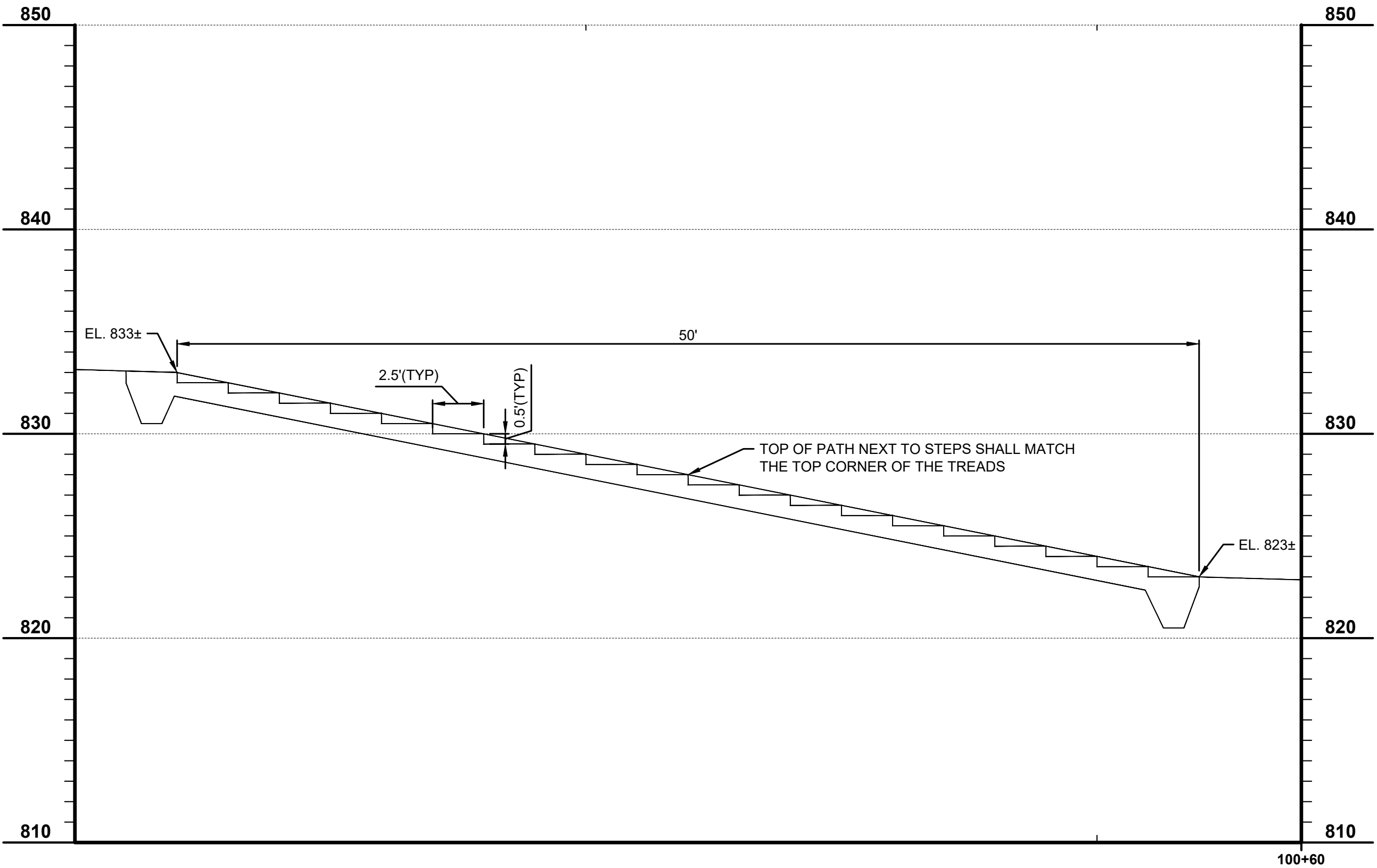

TOWER PARK - TENNIS COURT
IMPROVEMENTS
CITY OF FORT THOMAS
- CAMPBELL COUNTY -

ACCESS PATH IMPROVEMENTS
SHEET - 02

PROJECT NO.	
232586	
DISCIPLINE	
CIVIL	
SHEET NAME	
ACCESS-02	
SHEET	OF
9	10

ISSUED FOR:	BID	NO	REVISION	DATE
ISSUE DATE:	02/11/2025			
SCALE:				
DESIGNED BY:	RSEI			
DRAWN BY:	RSEI			
CHECKED BY:	FTWE			



2161 CHAMBER CENTER DRIVE
FORT MITCHELL, KENTUCKY 41017
TEL: (609) 525-0944
WWW.VERDANTAS.COM



CONSTRUCTION NOTES - TENNIS COURT

- C1 REMOVE EXISTING FENCE. (INCIDENTAL TO CLEARING AND GRUBBING)
- C2 INSTALL NEW 12' TALL HIGH COMMERCIAL GRADE BLACK VINYL FENCE.
- C3 INSTALL NEW 20' TALL HIGH COMMERCIAL GRADE BLACK VINYL FENCE.
- C4 INSTALL DOUBLE SWING GATE.
- C5 INSTALL SINGLE SWING GATE.
- C6 REMOVE EXISTING NET AND POST SYSTEM. (INCIDENTAL TO CLEARING AND GRUBBING)
- C7 INSTALL NEW NET AND POST SYSTEM

HATCH LEGEND

- 2" ASPHALT COURT MILL AND OVERLAY - SEE DETAIL SHEET

NORTH AND BEARING SYSTEM
BASED ON NAD83 (2011) KENTUCKY
STATE PLANE, NORTH ZONE,
US FOOT.

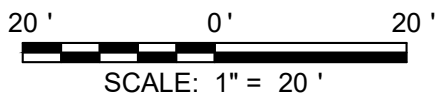
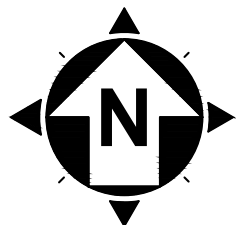

TOWER PARK - TENNIS COURT
IMPROVEMENTS
CITY OF FORT THOMAS
- CAMPBELL COUNTY -

TENNIS COURT IMPROVEMENTS
SHEET - 01

PROJECT NO. 232586	
DISCIPLINE CIVIL	
SHEET NAME COURT-01	
SHEET 10	OF 10

ISSUED FOR:	BID NO.	REVISION	DATE
ISSUE DATE:	02/11/2025		
SCALE:			
DESIGNED BY:	RSEI		
DRAWN BY:	RSEI		
CHECKED BY:	FTWE		

verdantas

2161 CHAMBER CENTER DRIVE
FORT MITCHELL, KENTUCKY 41017
TEL: (609) 525-0544
WWW.VERDANTAS.COM