

CITY OF FORT THOMAS CAMPBELL COUNTY, KENTUCKY TOWER PARK - TENNIS COURT IMPROVEMENTS 232586

CITY OF FORT THOMAS OFFICIALS	
MAYOR	ERIC HAAS
CITY CLERK	MELISSA BECKETT
CITY ADMINISTRATOR	MATTHEW KREMER
CITY COUNCIL MEMBERS	
JEFF BEZOLD	
ADAM BLAU	
ANDY ELLISON	
LAUREN MCINTOSH	
BEN PENDERY	
ERIC STRANGE	
GENERAL SERVICES DIRECTOR	KEVIN BARBIAN
PUBLIC WORKS DIRECTOR	TIM MATTINGLY

INDEX OF SHEETS		
NO.	DWG NAME	SHEET NAME
1	TTL	TITLE SHEET
2	NOTES	NOTES & LEGEND
3	DTL-01	DETAIL SHEET-01
4	DTL-02	DETAIL SHEET-02
5	DTL-02	DETAIL SHEET-03
6	TRAIL-01	OUTER TRAIL IMPROVEMENTS SHEET - 01
7	TRAIL-02	OUTER TRAIL IMPROVEMENTS SHEET - 02
8	ACCESS-01	ACCESS PATH IMPROVEMENTS SHEET - 01
9	ACCESS-02	ACCESS PATH IMPROVEMENTS SHEET - 02
10	COURT-01	TENNIS COURT IMPROVEMENTS SHEET - 01

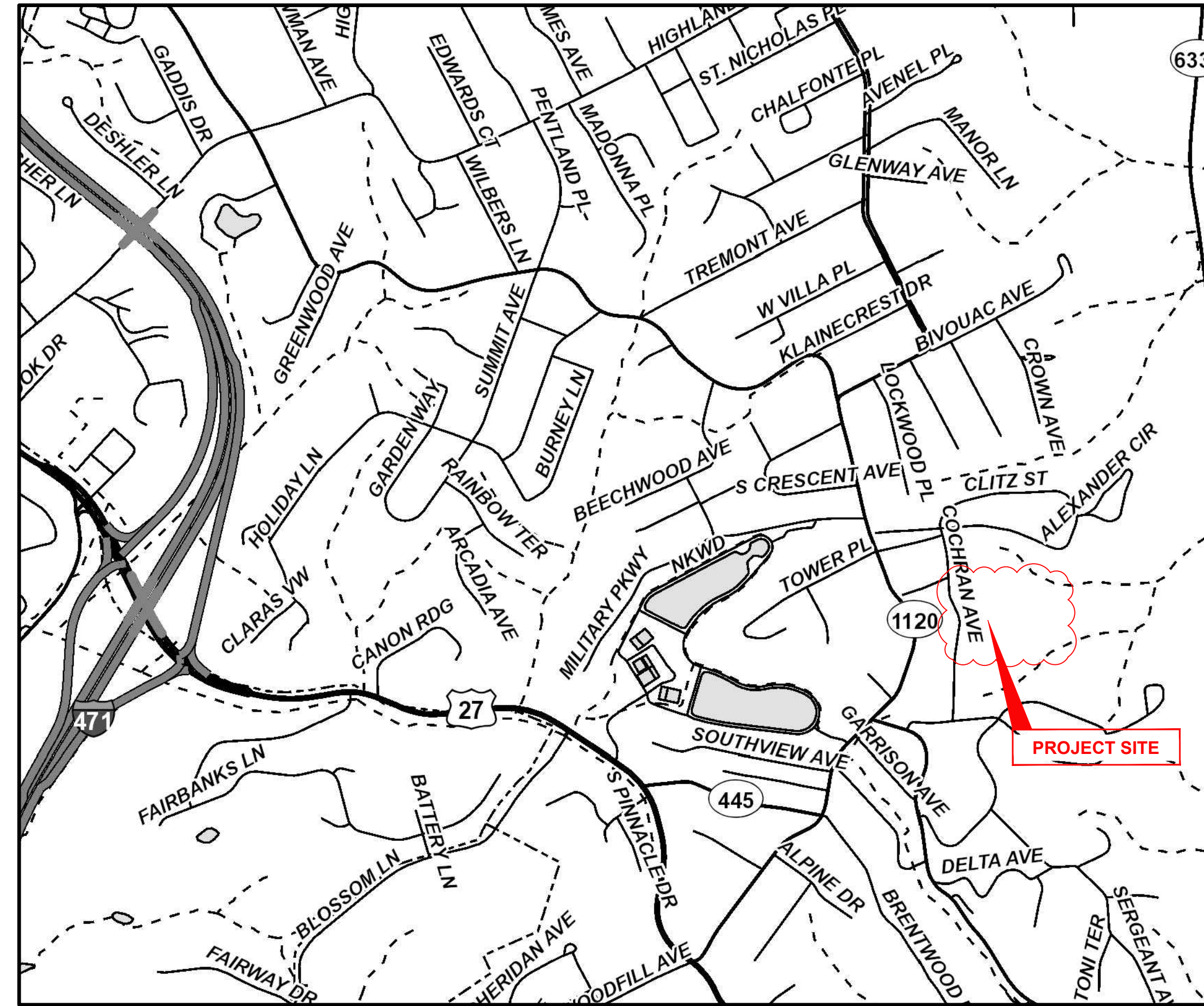

VICINITY MAP

K.T.C SPECIFICATIONS

THE LATEST STANDARD SPECIFICATIONS OF THE KENTUCKY TRANSPORTATION CABINET, INCLUDING CHANGES AND SUPPLEMENTAL SPECIFICATIONS THERETO.

SOURCE OF BOUNDARY INFORMATION

THE BOUNDARY INFORMATION SHOWN ON THESE PLANS IS BASED UPON CAMPBELL COUNTY G.I.S. MAPPING AND DOES NOT REPRESENT AN ACTUAL FIELD BOUNDARY SURVEY BY VERDANTAS LLC.



2181 CHAMBER CENTER DRIVE
FORT MITCHELL, KENTUCKY 41017
TEL: (609) 525-0944
WWW.VERDANTAS.COM

DATE	REVISION	NO	ISSUED FOR:	BID	ISSUE DATE:	SCALE:	DESIGNED BY:	DRAWN BY:	CHECKED BY:
				02/11/2025					

TOWER PARK - TENNIS COURT IMPROVEMENTS
CITY OF FORT THOMAS
- CAMPBELL COUNTY -

TITLE SHEET

PROJECT NO. 232586	
DISCIPLINE CIVIL	
SHEET NAME TTL	
SHEET 1	OF 10

ROBERT K. SEITZINGER

P.E. #33805



GENERAL NOTES

- ALL CONSTRUCTION SHALL CONFORM TO THESE PLANS AND SPECIFICATIONS, THE LATEST EDITION OF THE CITY OF FORT THOMAS SUBDIVISION REGULATIONS AND THE KENTUCKY DEPARTMENT OF HIGHWAYS STANDARD SPECIFICATIONS FOR ROAD AND BRIDGE CONSTRUCTION.
- EXPANSION MATERIAL SHALL BE FLEXIBLE FOAM MATERIAL, SUCH AS CERAMAR BY W.R. MEADOWS OR APPROVED EQUAL, INSTALLED IN AREAS OF CONCRETE WALK, DRIVES OR CURB/GUTTER ONLY AT THE FOLLOWING:
 - AT ALL FIXED OBJECTS (I.E. UTILITY COVERS, VALVES, MANHOLES, ETC.)
 - AT ALL RIGID STRUCTURES (I.E. DRIVES, CURBS, STEPS, ETC.) PAYMENT FOR THIS ITEM AND ZIP STRIPS INCLUDED IN THE PERTINENT CONCRETE PAVEMENT UNIT PRICE.
 - AT ALL STREET INTERSECTIONS AT THE POINT OF CURVATURE OF THE TURNING RADI ENTERING THE INTERSECTION.
 - NO CONCRETE SHALL BE LEFT ABOVE THE EXPANSION MATERIAL OR ACROSS THE JOINT AT ANY POINT. ANY CONCRETE SPANNING THE ENDS OF THE JOINT NEXT TO THE FORMS SHALL BE CAREFULLY CUT AWAY AFTER THE FORMS ARE REMOVED. BEFORE THE PAVEMENT IS OPENED TO TRAFFIC, THE GROOVE ABOVE THE EXPANSION JOINT MATERIAL SHALL BE CLEANED AND SEALED WITH JOINT SEALING MATERIAL.
- PAVING PROJECT MAY NOT BEGIN BEFORE JULY 14, 2025 AND SHALL BE SUBSTANTIALLY COMPLETE NO LATER THAN OCTOBER 31, 2025.**
- DOWNSPOUT AND UNDERDRAIN CONSTRUCTION SHALL MEET THESE AND THE LATEST SPECIFICATION OF THE CITY OF FORT THOMAS SUBDIVISION REGULATIONS, SD-1 REGULATIONS AND STANDARD DRAWINGS, AND DETAILS SHOWN ON THIS PLAN. BEDDING, BACKFILLING, JOINTS, EXCAVATION AND INSTALLATION SHALL BE INCLUDED IN THE COST PER FOOT OF PIPE. STORM SEWER, DOWNSPOUT AND UNDERDRAIN PIPE MATERIAL SHALL HAVE A MANNING'S "N" VALUE OF 0.013 OR LESS (UNLESS OTHERWISE SHOWN) AND BE RIGID / SMOOTH INTERIOR WALLED PVC SDR-35 PIPE, RIBBED PVC PIPE, A-2000 PVC PIPE, UNLESS OTHERWISE SHOWN.
- ALL DISTURBED AREAS ARE TO BE RESTORED (SEEDED AND MULCHED) BY THE CONTRACTOR AND SHALL PROCEED WITH JOB PROGRESSION. THE CONTRACTOR SHALL ALSO BE RESPONSIBLE FOR REMOVING ANY EXCESS MATERIALS AT THE SITE AND MAINTAINING ALL SEEDED AND MULCHED AREAS UNTIL PROJECT COMPLETION AND FINAL INSPECTION PER KDOT SPEC. 212. A RESIDENTIAL YARD SHALL BE RESTORED WITHIN TWENTY-ONE (21) DAYS AFTER CONSTRUCTION.
- ALL APPLICABLE RECOMMENDATIONS IN KENTUCKY'S BEST MANAGEMENT PRACTICES MANUAL SHALL BE FOLLOWED BY THE CONTRACTOR, INCLUDING SEEDING OF DISTURBED GROUND.
- RIGHT-OF-WAY AND PROPERTY LINES SHOWN ARE PLOTTED FROM CAMPBELL COUNTY G.I.S. MAPPING AND ARE APPROXIMATE AND NOT THE RESULT OF A FIELD BOUNDARY SURVEY.
- THE CONTRACTOR SHALL LIMIT THEIR WORK AREA TO THE EASEMENTS AND RIGHTS-OF-WAY SHOWN ON THESE PLANS UNLESS WRITTEN PERMISSION IS GIVEN BY THE PROPERTY OWNER AND APPROVED BY THE CITY OF FORT THOMAS.
- ALL OSHA, STATE AND LOCAL SAFETY REGULATIONS SHALL BE FOLLOWED DURING CONSTRUCTION.
- RELOCATION OR REINSTALLATION OF EXISTING MAIL BOXES, FENCES, PRIVATE LANDSCAPE LIGHTS, PRIVATE SIGNS, STREET SIGNS, RESTORATION OF LANDSCAPING AND TREATMENT OF EXISTING WALLS WHERE A PORTION HAS BEEN REMOVED SHALL BE INCIDENTAL TO CLEARING AND GRUBBING.
- NO CONSTRUCTION SHALL COMMENCE UNTIL ALL CAMPBELL COUNTY AND THE CITY OF FORT THOMAS PERMITS HAVE BEEN ISSUED AS REQUIRE
- THE CONTRACTOR SHALL COORDINATE ALL WORK WITHIN THE PUBLIC RIGHT OF WAY WITH THE CITY OF FORT THOMAS. LOCAL TRAFFIC MUST BE MAINTAINED AT ALL TIMES DURING CONSTRUCTION UNLESS OTHERWISE NOTED IN THESE PLANS.
- ADDITIONAL BMP'S AND EROSION AND SEDIMENT CONTROL MEASURES MAY BE REQUIRED AS DEEMED NECESSARY. ALL COST FOR ABOVE SHALL BE INCLUDED IN LUMP SUM BID FOR EROSION CONTROL AND WATER POLLUTION CONTROL.
- LIMITS OF DRIVEWAY APRON & SIDEWALK REPLACEMENT TO BE MARKED IN THE FIELD BY THE ENGINEER. ADDITIONAL DRIVEWAY & SIDEWALK REPLACEMENTS, NOT SHOWN ON THE PLANS MAY BE REQUIRED BY THE ENGINEER.

ITEM 302 - CRUSHED STONE BASE, VARIABLE DEPTH, SCRAPE & ITEM 302 - CRUSHED STONE BASE, VARIABLE DEPTH, PLACE AND COMPACT

IN ADDITION TO THE REQUIREMENTS OF KTC 302, THIS ITEM SHALL CONSIST OF SCRAPING EXISTING STONE / GRAVEL MATERIAL FROM THE PATH TO ALLOW FOR THE CONSTRUCTION OF ASPHALT LAYERS, AND THE PLACEMENT AND COMPACTION OF SAID STONE TO BUILD THE BASE ON THE OPPOSITE SIDE OF THE PATH (LEFT) WHERE ADDITIONAL BASE IS REQUIRED TO BUILD THE PATH UP BEFORE ASPHALT PLACEMENT. REFER TO TYPICAL SECTION FOR DETAILS.

UTILITY NOTES

- THIS PLAN SHOWS THE APPROXIMATE LOCATION OF UNDERGROUND UTILITIES (GAS, WATER, STORM SEWER, SANITARY SEWER, TELEPHONE, ELECTRIC, ETC.). THE PREPARER DOES NOT GUARANTEE THEIR ACCURACY OR CORRECTNESS. THE INFORMATION PROVIDED SHALL BE FIELD VERIFIED PRIOR TO CONSTRUCTION. THE CONTRACTOR SHALL BE RESPONSIBLE FOR MAINTAINING THE UTILITY AS WELL AS THE SERVICE LATERALS AT ALL TIMES DURING CONSTRUCTION. THE CONTRACTOR SHALL PRACTICE CARE DURING THE GRADING AND TRENCH EXCAVATION AND SHALL BE RESPONSIBLE FOR REPLACING ANY SERVICES THAT ARE DAMAGED DURING CONSTRUCTION AT THEIR EXPENSE.
- PRIOR TO ANY EXCAVATION OVER AN EXISTING UTILITY LINE OR SERVICE, CONTRACTOR SHALL HAND EXCAVATE TO EXPOSE THE UTILITY AND DETERMINE LOCATION AND DEPTH. NOTIFY ENGINEER IMMEDIATELY OF ANY CONFLICTS.
- TOPS OF EXISTING AND PROPOSED CASTING ELEVATIONS ARE SUBJECT TO FINAL ADJUSTMENTS AS APPROVED BY THE ENGINEER AND REQUIREMENTS OF UTILITY OWNER. THIS WORK WILL BE INCIDENTAL TO THE CONTRACT.
- FORTY-EIGHT (48) HOURS BEFORE EXCAVATION IS TO COMMENCE, THE CONTRACTOR SHALL NOTIFY THE FOLLOWING AGENCIES: THE KENTUCKY UTILITY PROTECTION SERVICE AND ALL OTHER UTILITIES THAT MAY HAVE UNDERGROUND UTILITIES INVOLVING THIS PROJECT AND ARE NON-MEMBERS OF KENTUCKY UNDERGROUND PROTECTION.

STORM & SANITARY NOTES

- ALL STORM AND SANITARY ITEMS SHALL BE IN ACCORDANCE WITH THE LATEST SPECIFICATIONS AND DETAILS FROM SD1. CONCRETE AND METAL PIPE MATERIALS SHALL NOT BE USED UNLESS OTHERWISE SPECIFIED ON THESE PLANS.
- CONTRACTOR SHALL BE REQUIRED TO MAINTAIN STORM AND SANITARY SEWER FLOW THROUGHOUT THE PROJECT, FOR THE DURATION OF CONSTRUCTION. ALL COST FOR THE ABOVE SHALL BE INCIDENTAL TO THE CONTRACT.
- IF REQUIRED, CONTRACTOR SHALL BE RESPONSIBLE FOR CONTACTING AND SCHEDULING STORM AND SANITARY SEWER INSPECTIONS AS SET OUT IN THE PRECONSTRUCTION MEETING.
- CONNECTIONS INTO EXISTING OR PROPOSED STORM OR SANITARY SEWER STRUCTURES OR PIPES SHALL BE COMPLETED BY A CERTIFIED TAPPER BY SD1.

WATER NOTES

- ALL WORK RELATING TO WATER MAINS OR WATER SERVICE LINES SHALL BE COMPLETED IN ACCORDANCE WITH THE RULES AND REGULATIONS OF THE NORTHERN KENTUCKY WATER DISTRICT (NKWD).
- CONTRACTOR MAY NOT USE WATER FROM FIRE HYDRANTS WITHOUT PRIOR PERMISSION FROM NKWD

GAS NOTES

- ALL WORK RELATING TO GAS MAINS OR GAS SERVICE LINES SHALL BE COMPLETED IN ACCORDANCE WITH THE RULES AND REGULATIONS OF THE DUKE ENERGY

ELECTRIC NOTES

- ALL WORK RELATING TO ELECTRIC LINES SHALL BE COMPLETED IN ACCORDANCE WITH THE RULES AND REGULATIONS OF THE DUKE ENERGY

MAINTENANCE OF TRAFFIC NOTES

- ALL MAINTENANCE OF TRAFFIC PROCEDURES SHALL MEET THE REQUIREMENT OF THE MANUAL OF UNIFORM TRAFFIC CONTROL DEVICES AND SECTION 112 OF KTC STANDARD SPECIFICATIONS. THE CONTRACTOR SHALL MAINTAIN ACCESS TO LOCAL TRAFFIC (ACCESS TO RESIDENCES WITHIN CONSTRUCTION LIMITS) AT ALL TIMES. THE CONTRACTOR SHALL PROVIDE SUFFICIENT SIGN, WARNING LIGHTS, BARRICADES, OR OTHER NECESSARY DEVICES MAKE THE SITE SAFE TO THE TRAVELING PUBLIC.
- IT SHALL BE THE CONTRACTOR'S RESPONSIBILITY TO SUBMIT TO THE ENGINEER AND THE OWNER A TRAFFIC CONTROL PLAN FOR THIS PROJECT.
- PRIOR TO ANY CONSTRUCTION, THE CONTRACTOR SHALL NOTIFY THE CITY OF FORT THOMAS, AS WELL AS THEIR POLICE AND FIRE POLICE DEPARTMENTS. AT ALL TIMES, EMERGENCY VEHICLES SHALL BE GIVEN ACCESS.
- RESIDENTS OF THE PROJECT AREA SHALL BE ALLOWED ACCESS TO THEIR PROPERTY AT ALL TIMES.

SYMBOL LEGEND

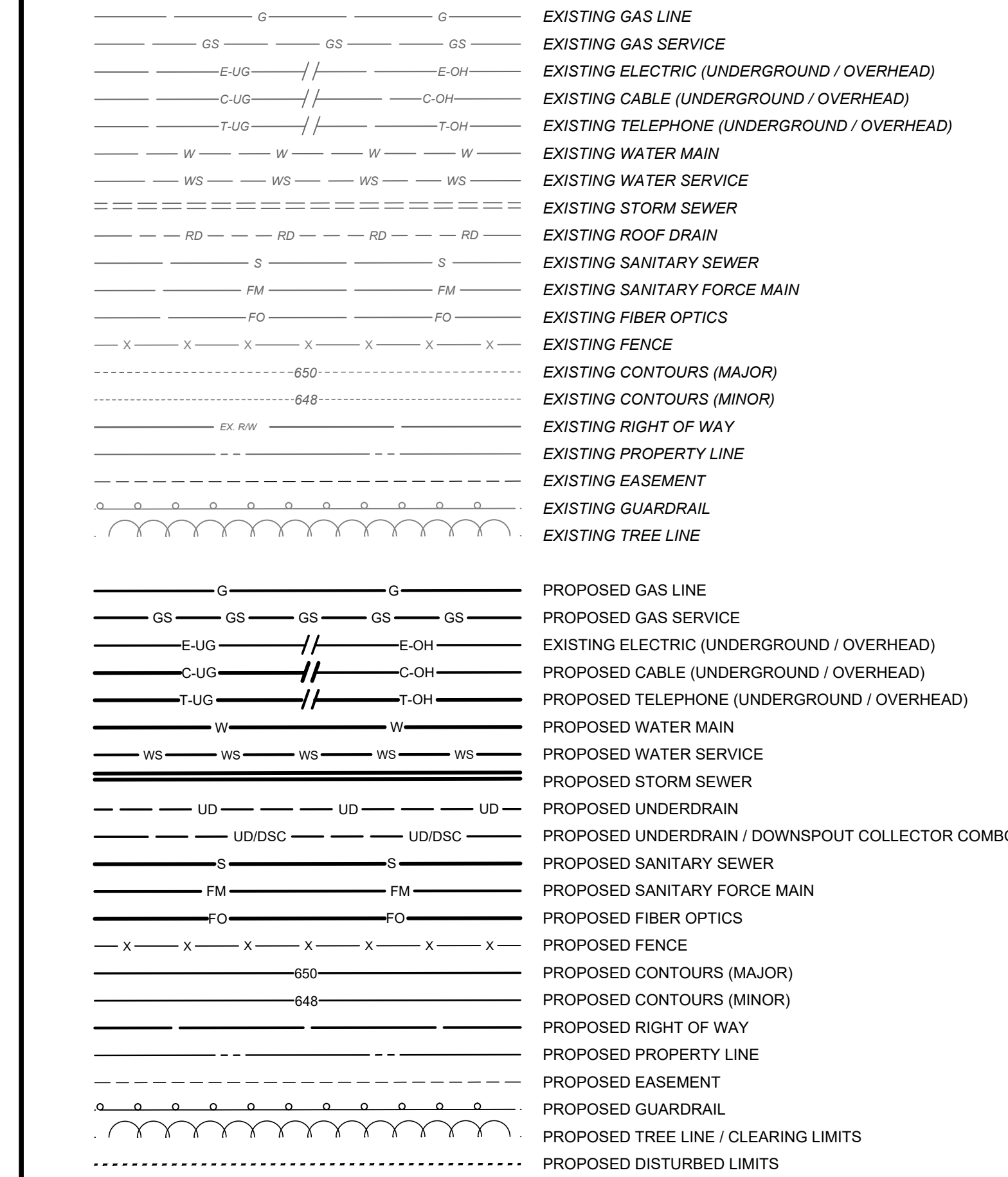

	EXISTING FLAGPOLE		PROPOSED FLAGPOLE
	EXISTING MAILBOX		PROPOSED MAILBOX
	EXISTING SIGN		PROPOSED SIGN
	EXISTING CABLE PEDESTAL		PROPOSED CABLE PEDESTAL
	EXISTING ELECTRIC PEDESTAL		PROPOSED ELECTRIC PEDESTAL
	EXISTING PULL BOX		PROPOSED PULL BOX
	EXISTING GROUND LIGHT		PROPOSED GROUND LIGHT
	EXISTING LIGHT POLE		PROPOSED LIGHT POLE
	EXISTING ELECTRIC METER		PROPOSED ELECTRIC METER
	EXISTING ELECTRIC MANHOLE		PROPOSED ELECTRIC MANHOLE
	EXISTING GAS METER		PROPOSED GAS METER
	EXISTING GAS VALVE		PROPOSED GAS VALVE
	EXISTING GAS BOX		PROPOSED GAS BOX
	EXISTING UTILITY POLE		PROPOSED UTILITY POLE
	EXISTING GUY WIRE / ANCHOR		PROPOSED GUY WIRE / ANCHOR
	EXISTING SANITARY MANHOLE		PROPOSED SANITARY MANHOLE
	EXISTING SANITARY CLEANOUT		PROPOSED SANITARY CLEANOUT
	EXISTING STORM MANHOLE		PROPOSED STORM MANHOLE
	EXISTING SINGLE / DOUBLE CURB INLET		PROPOSED SINGLE / DOUBLE CURB INLET
	EXISTING CATCH BASIN		PROPOSED CATCH BASIN
	EXISTING STORM CLEANOUT		PROPOSED STORM CLEANOUT
	EXISTING TELEPHONE MANHOLE		PROPOSED TELEPHONE MANHOLE
	EXISTING TELEPHONE PEDESTAL		PROPOSED TELEPHONE PEDESTAL
	EXISTING FIRE HYDRANT		PROPOSED FIRE HYDRANT
	EXISTING WATER METER		PROPOSED WATER METER
	EXISTING WATER VALVE		PROPOSED WATER VALVE
	EXISTING BUSHES / TREES		REMOVE EXISTING BUSH / TREE
	EXISTING SURVEY BENCHMARK		PROPOSED SLOPE DIRECTION
	TEST BORING LOCATION		

2181 CHAMBER CENTER DRIVE
FORT MITCHELL, KENTUCKY 41017
TEL: (859) 525-0644
WWW.VERDANTAS.COM

DATE		REVISION		NO	

ISSUED FOR:	BID	ISSUE DATE:	02/11/2025	RSEI	RSEI
SCALE:		DESIGNED BY:		DRAWN BY:	FTWE
CHECKED BY:					

TOWER PARK - TENNIS COURT IMPROVEMENTS
CITY OF FORT THOMAS
- CAMPBELL COUNTY -

NOTES & LEGEND

PROJECT NO.	
2322586	
DISCIPLINE	
CIVIL	
SHEET NAME	
NOTES	
SHEET	OF
2	10

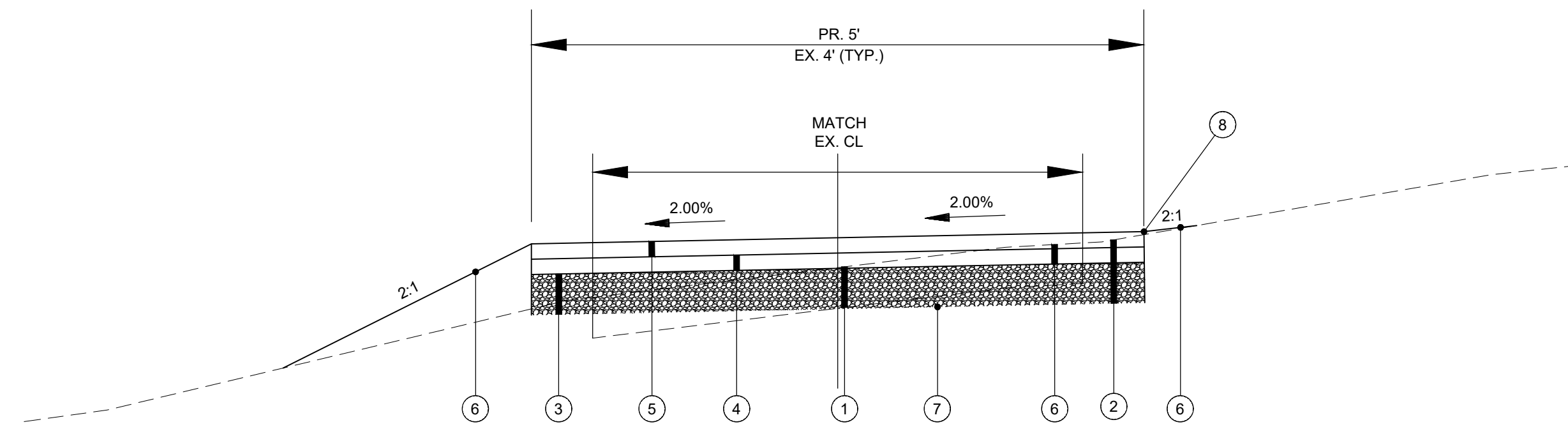

- ① EXISTING GRAVEL PATH
- ② ITEM 204 - EXCAVATION TO SUBGRADE (MAXIMUM DEPTH 7")
- ③ ITEM 302 - 4" STONE BASE
- ④ ITEM 402 / 403 - 1-1/2" ASPHALT BASE COURSE
- ⑤ ITEM 402/403 - 1-1/2" ASPHALT SURFACE COURSE
- ⑥ ITEM SPL - YARD RESTORATION (TOPSOIL, SEED & MULCH)
- ⑦ ITEM 207 - SUBGRADE COMPACTION.
- ⑧ HOLD ELEVATION ON UPHILL SIDE OF PATH.

ASPHALT PATH
N.T.S.

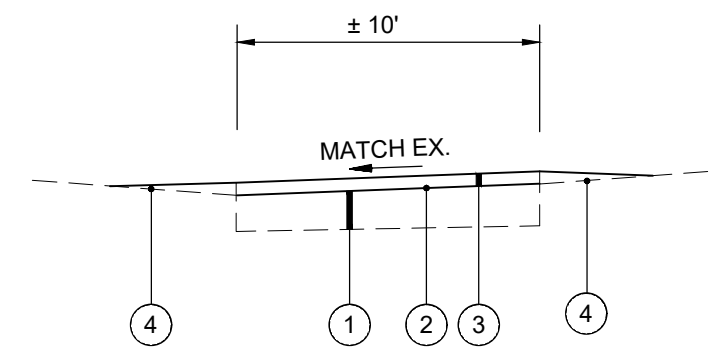

- ① EXISTING ASPHALT PAVEMENT
- ② ITEM 406 - TACK COAT @ 0.1 GAL/SY (INCIDENTAL TO ITEM 403)
- ③ ITEM 402/403 - 1 1/2" ASPHALT SURFACE COURSE
- ④ ITEM SPL - YARD RESTORATION (TOPSOIL, SEED & MULCH)

TYPICAL ASPHALT PAVEMENT OVERLAY
N.T.S.

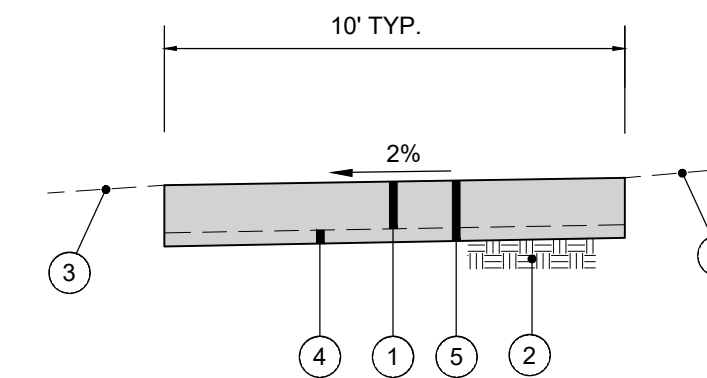

6" CONCRETE PAVEMENT REPLACEMENT
N.T.S.

- ① ITEM 203 - REMOVE EXISTING PAVEMENT.
- ② ITEM 207 - COMPACTED SUBGRADE
- ③ ITEM SPL - YARD RESTORATION (4" TOPSOIL, SEED AND MULCH) - KEEP TO A MINIMUM.
- ④ ITEM 204 - EXCAVATION TO PROPOSED SUBGRADE
- ⑤ ITEM 605 - 6" PORTLAND CEMENT CONCRETE PAVEMENT

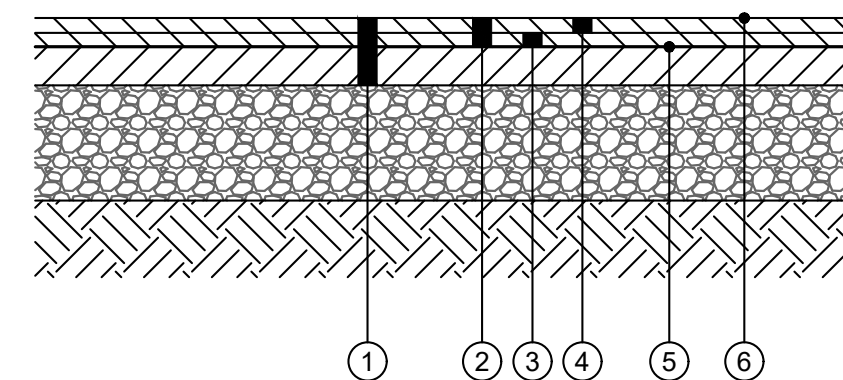

- ① EXISTING ASPHALT COURT
- ② ITEM 408 - 2" ASPHALT MILLING
- ③ ITEM 403 - 3/4" ASPHALT LEVELING COURSE
- ④ ITEM 403 - 1-1/4" ASPHALT SURFACE COURSE
- ⑤ ITEM 406 - NON-TRACKING TACK COAT INTERMEDIATE COURSE @ 0.1 GAL/ SY
- ⑥ ACRYLIC COLOR COATING FOR COURT SURFACE

2" ASPHALT COURT MILL & OVERLAY DETAIL
N.T.S.

ELEVATION OF HANDRAIL TYPE A-4

ELEVATION OF HANDRAIL TYPE A-1

ELEVATION OF HANDRAIL TYPE A-2

ISOMETRIC OF HANDRAIL TYPE A, A-1 AND A-2

TYPE	HEIGHT REQ'D.	FENCE REQ'D.	MAX. POST SPACING	NO. OF RAILS
A	2'-10"	NO	4'-0"	2
A-1	3'-6"	NO	4'-0"	2
A-2	3'-6"	YES	4'-0"	2
A-3	3'-6"	NO	4'-0"	3
A-4	3'-6"	YES	4'-0"	3

SECTION OF HANDRAIL TYPE A

SECTION OF HANDRAIL TYPE A-3

SECT. FOR WALL MOUNTED HANDRAIL

SECT. OF HANDRAIL TYPE A-4

DETAIL "A"

NOTES

BID ITEM AND UNIT TO BID
HANDRAIL TYPE A LF

- HANDRAIL SHALL BE REQUIRED WITH THREE OR MORE STEPS. HANDRAIL IS OPTIONAL WITH LESS THAN THREE STEPS.
- HANDRAIL USED AS A TOP HANDRAIL ON STEPS AND HANDRAIL USED ON A RETAINING WALL SHALL BE REQUIRED WHEN THE ADJACENT FLOOR, GROUND LEVEL, ROAD, WALK, ETC. IS 4' OR MORE BELOW THE TOP OF THE RETAINING WALL.
- THE TOP OF THE RETAINING WALL OR CURB SHALL BE A MIN. OF 6" ABOVE THE ADJOINING SIDEWALK.
- A DISTANCE OF 1'-0" MIN. SHALL BE PARALLEL TO THE STEP RUNNER.
- HANDRAIL WITH INTERNAL CONNECTIONS: HANDRAIL SHALL BE CONSTRUCTED OF 1 1/2" SCHEDULE 40 ALUMINUM PIPE IN ACCORDANCE WITH ASTM B221 ALLOY 6063-T52 FOR RAIL AND ASTM B210 ALLOY 6063-T832 FOR POSTS. -OR- HANDRAIL WITH WELDED CONNECTIONS: HANDRAIL SHALL BE CONSTRUCTED OF 1 1/2" SCHEDULE 40 ALUMINUM PIPE IN ACCORDANCE WITH ASTM B221 OR B210 ALLOY 6061-T6.
- ANCHOR POST IN FORMED HOLES (SEE DETAIL "A"). FOR INSTALLATION PROCEDURES OF THE CHAIN LINK FENCE AS APPLICABLE SEE CUR. STD. DWG. RFC-001.
- ALL INTERNAL CONNECTIONS SHALL BE MADE WITH AN EPOXY ADHESIVE (RECOMMENDED BY THE MANUFACTURER), STAINLESS STEEL MACHINE SCREWS WITH LOCK WASHERS, AND THREADED TUBULAR RIVETS IN ORDER TO PROVIDE A SMOOTH INSTALLATION. EXPANSION JOINTS SHALL BE PROVIDED APPROX. 20'-0" O.C.
- SIDEWALK SLABS SHALL BE THICKENED TO 8"x8"x8" AT POST LOCATIONS.

USE WITH CUR. STD. DWG. RFC-001

KENTUCKY
DEPARTMENT OF HIGHWAYS

HANDRAIL TYPE
A, A-1, A-2, A-3, A-4

STANDARD DRAWING NO. RCX-030-07

DATE: 12-01-15

APPROVED: [Signature]

NO.	REVISION	DATE

ISSUED FOR: 02/11/2025

SCALE: RSEI

DESIGNED BY: RSEI

DRAWN BY: RSEI

CHECKED BY: FTWE

TOWER PARK - TENNIS COURT IMPROVEMENTS
CITY OF FORT THOMAS - CAMPBELL COUNTY

DETAIL SHEET - 01

PROJECT NO.	232586
DISCIPLINE	CIVIL
SHEET NAME	DTL-01
SHEET	3
OF	10

NOTES:

ACRYLIC COLOR:
 ACRYLIC COLOR COATING FOR COURT SURFACE. DYNAFLEX MATERIALS OR APPROVED
 EQUAL (2 COAT RESURFACER, 3 COATS OF COLOR COATING). INCLUDES ANY REQUIRED
 LEVELING OF ASPHALT SURFACE WITH DYNABINDER QUICK PATCH BINDER.

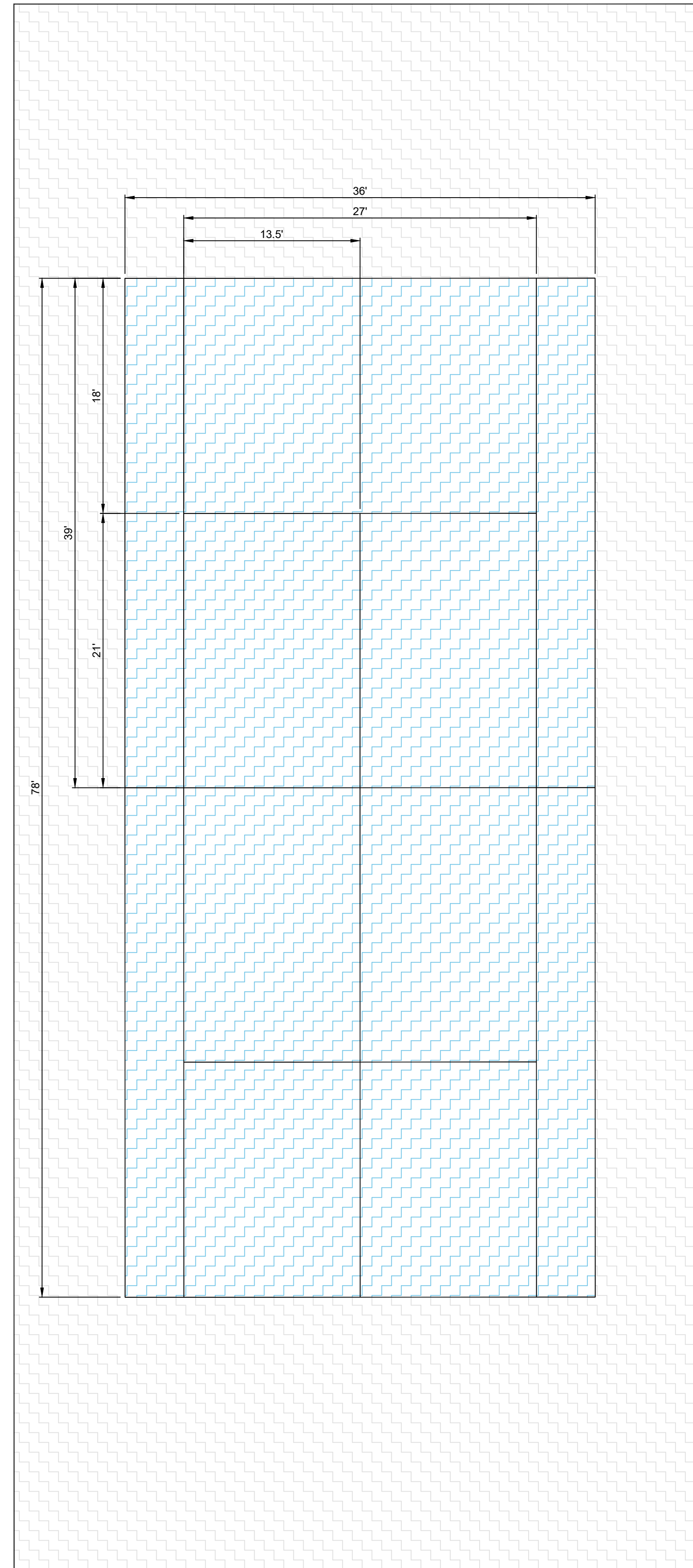

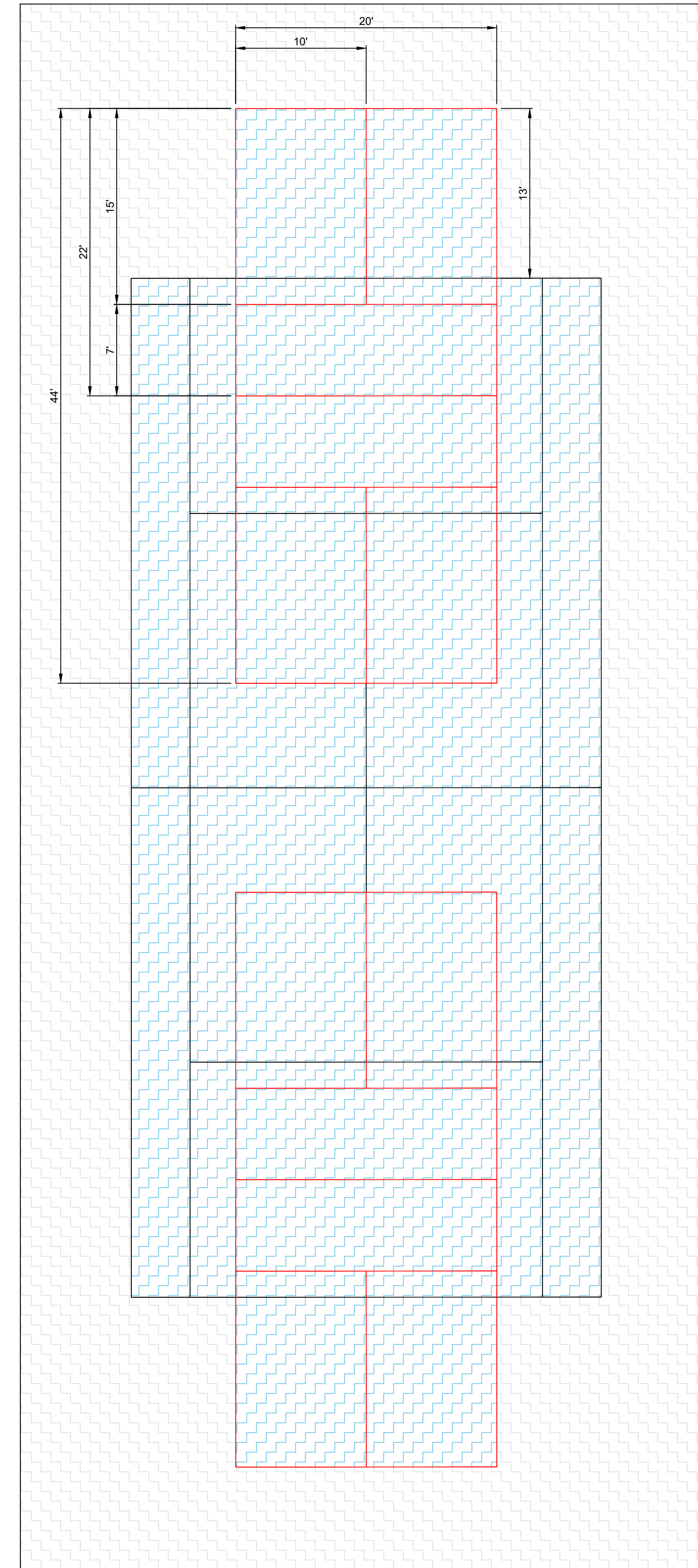

STANDARD TENNIS COURT



DUAL USE COURT

COURT COLORING HATCH LEGEND

-  COLOR : TOURNAMENT BLUE
-  COLOR : TOURNAMENT GREEN
-  STRIPING TO BE 2" WIDE WHITE.
-  STRIPING TO BE 2" WIDE RED.

**TOWER PARK - TENNIS COURT
 IMPROVEMENTS
 CITY OF FORT THOMAS
 - CAMPBELL COUNTY -
 DETAIL SHEET - 02**

PROJECT NO. 232586	
DISCIPLINE CIVIL	
SHEET NAME DTL-02	
SHEET 4	OF 10

ISSUED FOR:	BID NO	REVISION	DATE
ISSUE DATE: 02/11/2025			
SCALE:			
DESIGNED BY: RSEI			
DRAWN BY: RSEI			
CHECKED BY: FTWE			

verdantas
 2181 CHAMBER CENTER DRIVE
 FORT MITCHELL, KENTUCKY 41017
 TEL: (609) 525-0644
 WWW.VERDANTAS.COM

2" - 9 Gauge Core / 8 Gauge Finish Permafused (Fused and Adhered)

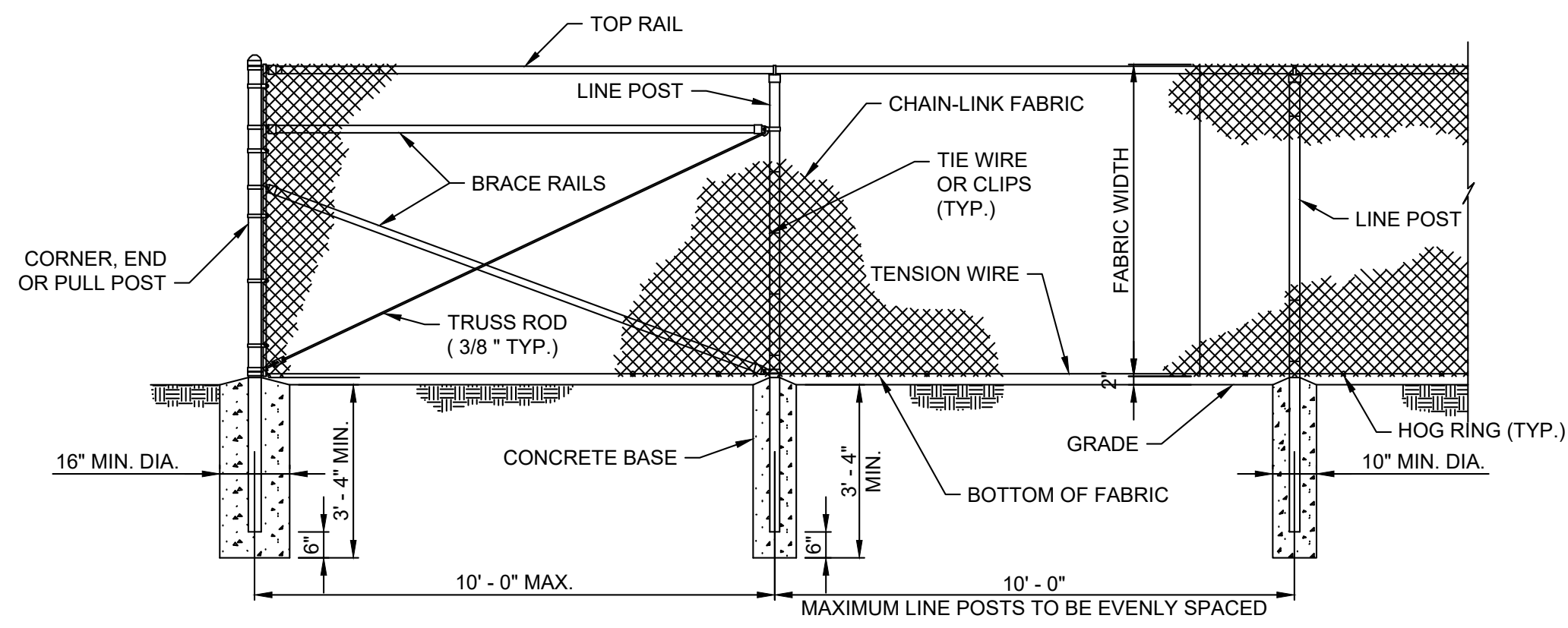

CHAIN-LINK FENCE DETAIL
NTS

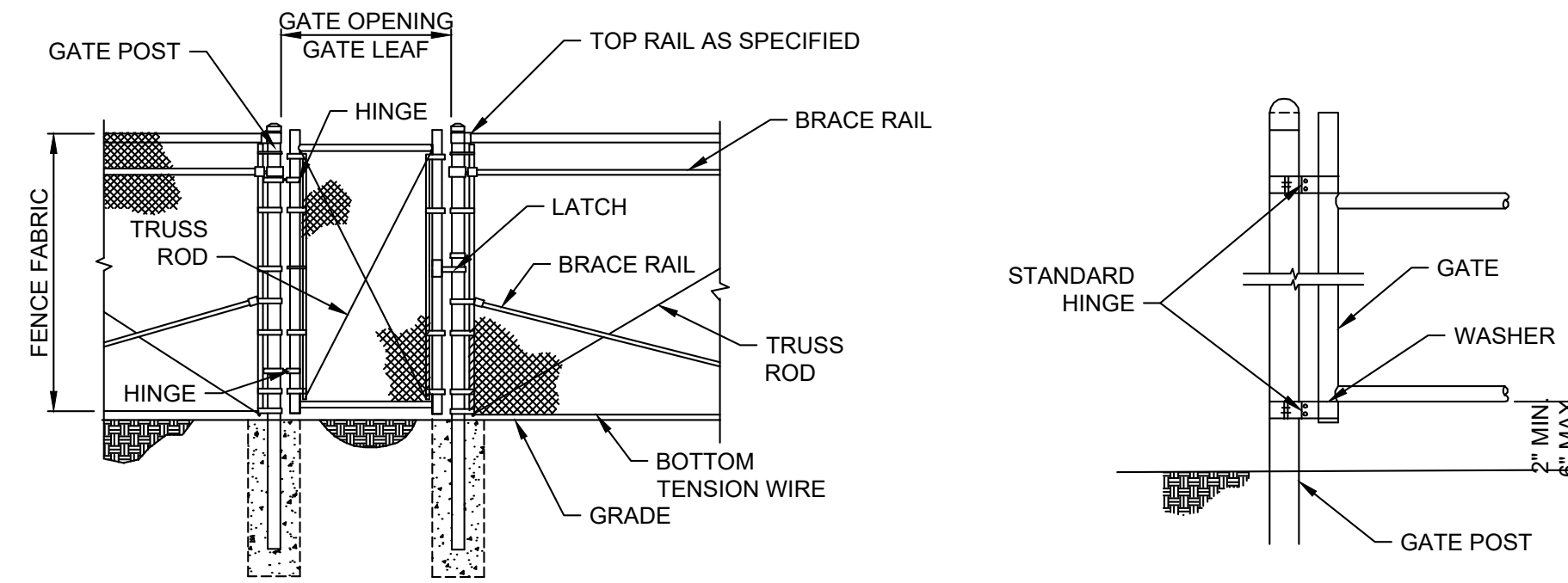

GATE DETAIL
NTS

USE AND SECTION	STEEL POST SCHEDULE	
	MINIMUM OUTSIDE DIMENSIONS (NOMINAL)	
	FABRIC LESS THEN 72"	FABRIC OVER 96"
CORNER, END & PULL POSTS TUBULAR - ROUND	2.375" O.D.	4.00" O.D.
LINE POSTS TUBULAR - ROUND	1.90" O.D.	2.875" O.D.
CORNER, END & PULL POSTS TUBULAR - ROUND	1.66" O.D.	

GATE POST SCHEDULE	
GATE LEAF WIDTH (NOMINAL)	OUTSIDE DIMENSION (NOMINAL)
6' OR LESS	2.875" O.D. 2.5" SQ.
6' TO 13'	4" O.D.

verdantas
2181 CHAMBER CENTER DRIVE
FORT MITCHELL, KENTUCKY 41017
TEL: (859) 525-0644
WWW.VERDANTAS.COM

DATE	REVISION	NO	BID	ISSUED FOR:	ISSUE DATE:	SCALE:	DESIGNED BY:	DRAWN BY:	CHECKED BY:
			02/11/2025				RSEI	RSEI	FTWE

NOTES:

- ALL CHAIN-LINK MATERIALS AND INSTALLATION SHALL CONFORM TO SECTION 721 OF THE KYTC STANDARD SPECIFICATIONS. CHAIN LINK SHALL BE BLACK VINYL COATED.
- DETAILS SHOWN ARE TO CLARIFY REQUIREMENTS AND ARE NOT INTENDED TO LIMIT OTHER TYPES OF FENCE SECTIONS AND METHODS OF INSTALLATION
- WIRE TIES, RAILS, POSTS AND BRACES SHALL BE CONSTRUCTED ON THE SECURE SIDE OF THE FENCE ALIGNMENT. CHAIN-LINK FABRIC SHALL BE PLACED ON THE OPPOSITE SIDE OF THE SECURE AREA
- C-SECTION POSTS BE INSTALLED SO THAT THE VOID INSIDE THE POST IS COMPLETELY FILLED WITH CONCRETE UP TO THE TOP OF THE FOUNDATION.
- SWING GATES SHALL BE CONSTRUCTED WITH DROP RODS, PADLOCK, LATCH ASSEMBLY AND GATE KEEPERS EXCEPT WHERE NOTED.
- ALL GATE FRAMES SHALL BE A MINIMUM 1.90" NOMINAL (ROUND) OR 2.00" NOMINAL (SQUARE). GATE FRAMES SHALL BE OF WELDED CONSTRUCTION OR SHALL BE ASSEMBLED USING HEAVY FITTINGS. AT CONTRACTOR'S OPTION A WELDED HORIZONTAL BRACE MAY BE USED IN LIEU OF TRUSS RODS TO BRACE ALL WELDED GATE FRAMES. THE CONTRACTOR SHALL BE RESPONSIBLE FOR THE PROPER RIGID CONSTRUCTION OF ALL GATES SUPPLIED.

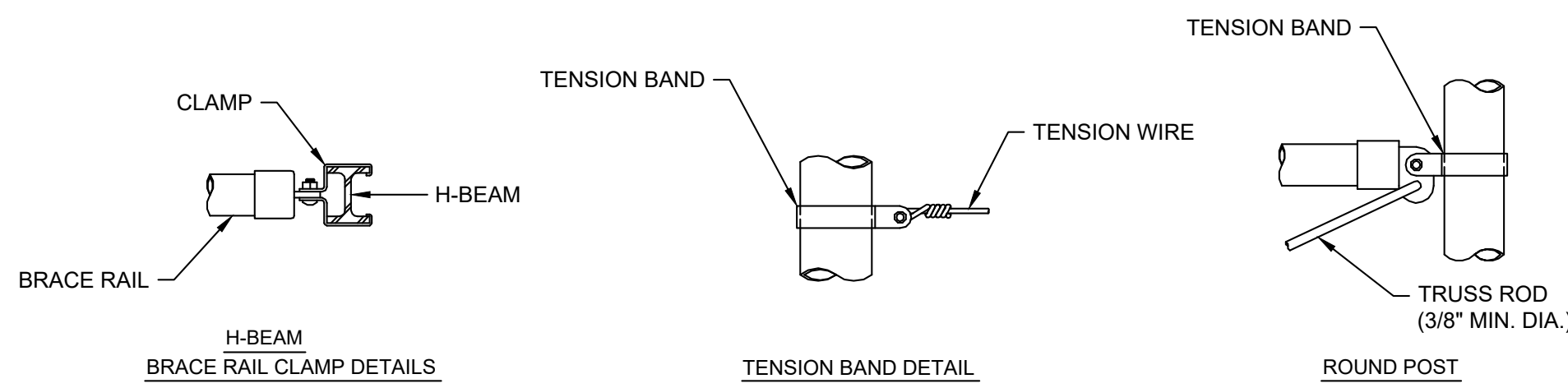

FASTENING DETAIL
NTS

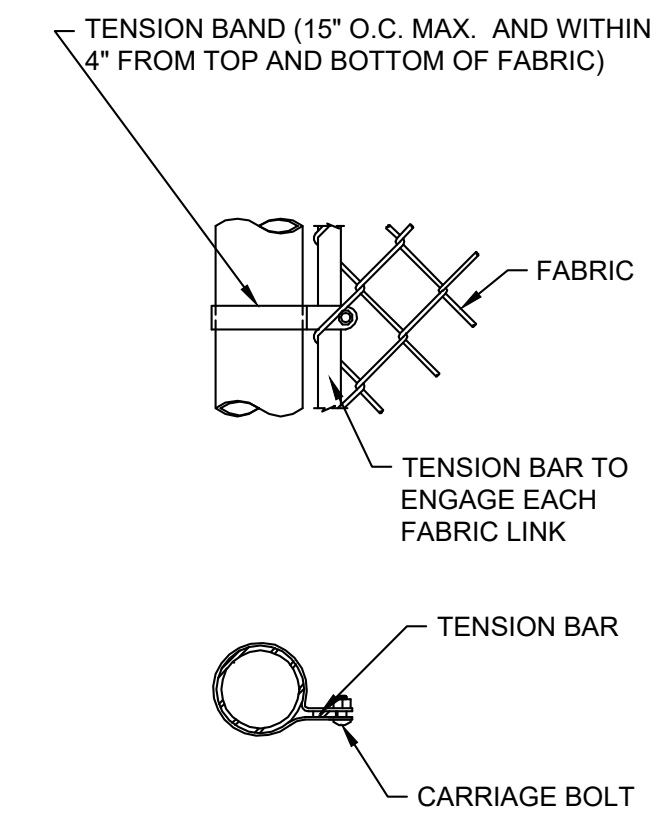

END OR GATE POST DETAIL
NTS

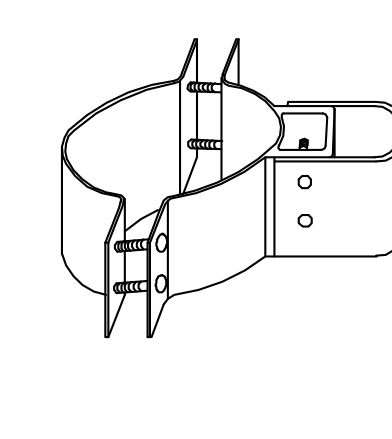

STANDARD HINGE
NTS

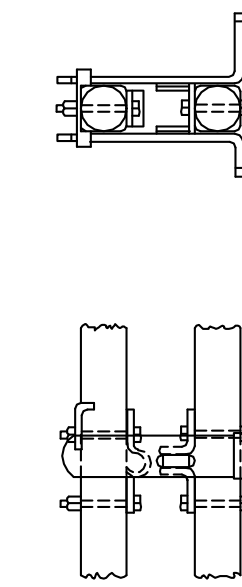

LATCH ASSEMBLY
NTS

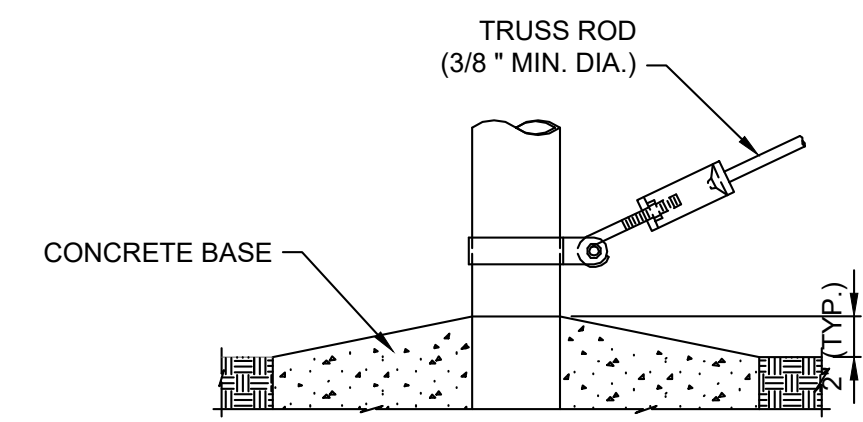

TRUSS ROD AND BAND
NTS

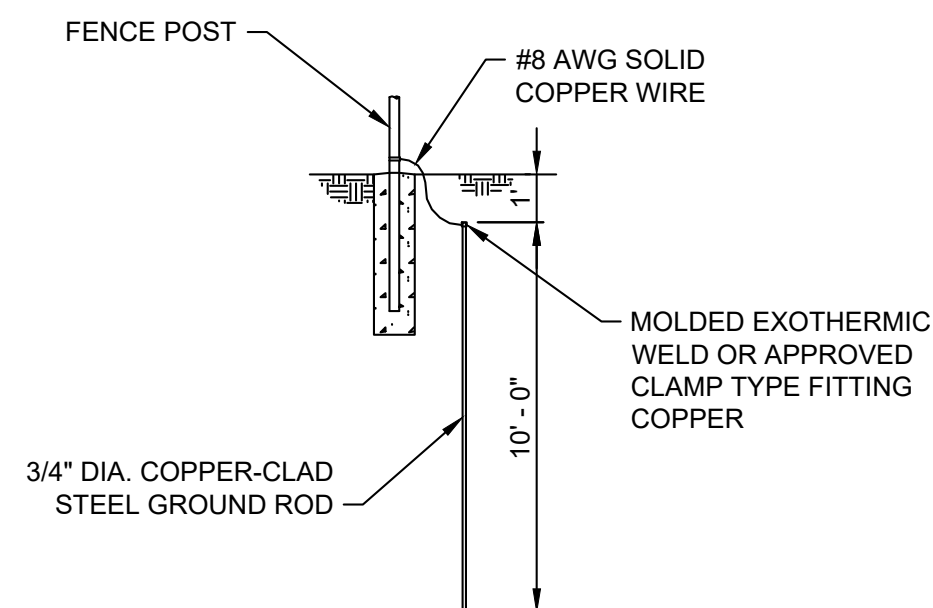

GROUNDING DETAIL
NTS

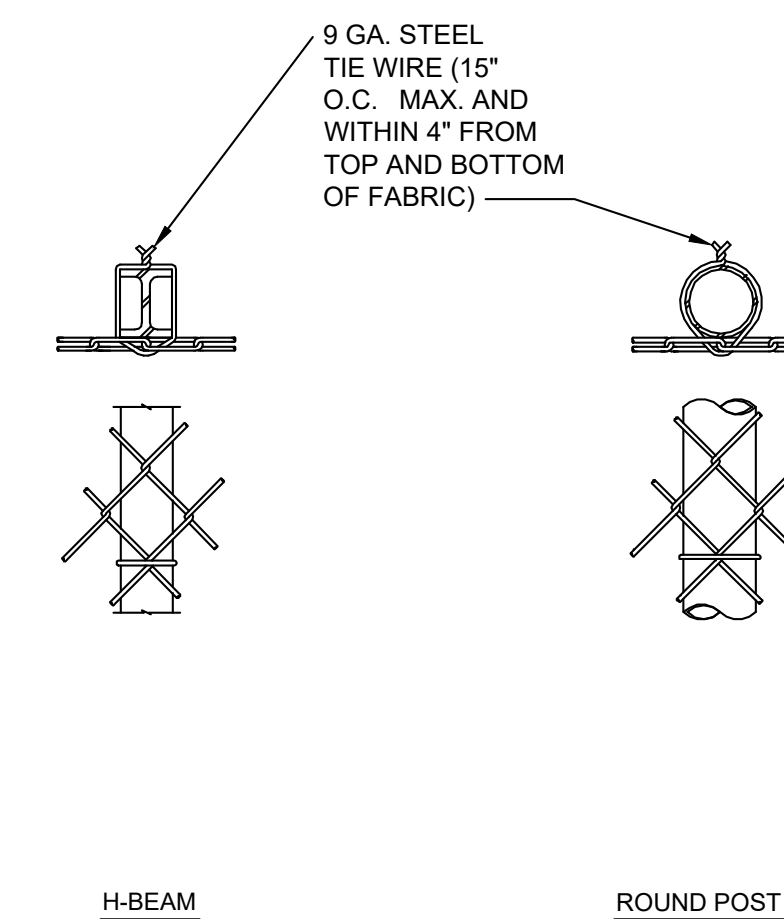

LINE POST ATTACHMENT
NTS

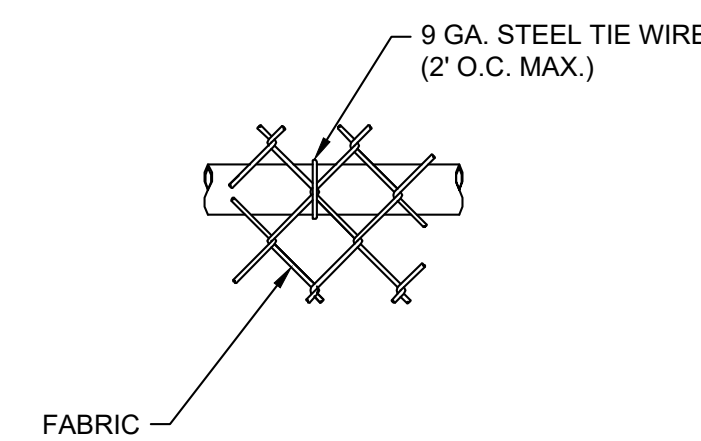

TOP OR BRACE RAIL ATTACHMENT
NTS

TOWER PARK - TENNIS COURT IMPROVEMENTS
CITY OF FORT THOMAS - CAMPBELL COUNTY -
DETAIL SHEET - 03

PROJECT NO.	232586
DISCIPLINE	CIVIL
SHEET NAME	DTL-03
SHEET	OF
5	10

CONSTRUCTION NOTES - OUTER TRAIL

- REMOVE EX. GRAVEL AS NEEDED TO ALLOW FOR ASPHALT TO MEET FLUSH WITH EX CONCRETE SIDEWALK.
- EX. TREE TO REMAIN. DIG WITH CAUTION TO AVOID DAMAGE TO ROOTS.
- ADD GRAVEL AS NEEDED TO MATCH NEW TRAIL ELEVATION
- TREE REMOVAL BY CITY. IF CONTRACTOR IDENTIFIES TREES THAT SHOULD BE REMOVED BUT WERE NOT, CONTACT THE ENGINEER TO COORDINATE FOR THE REMOVAL.

HATCH LEGEND

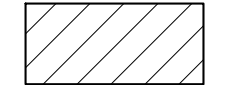
 3" ASPHALT PATH OVERLAY - SEE DETAIL SHEET

LEGEND

 GRADING LIMITS (APP)

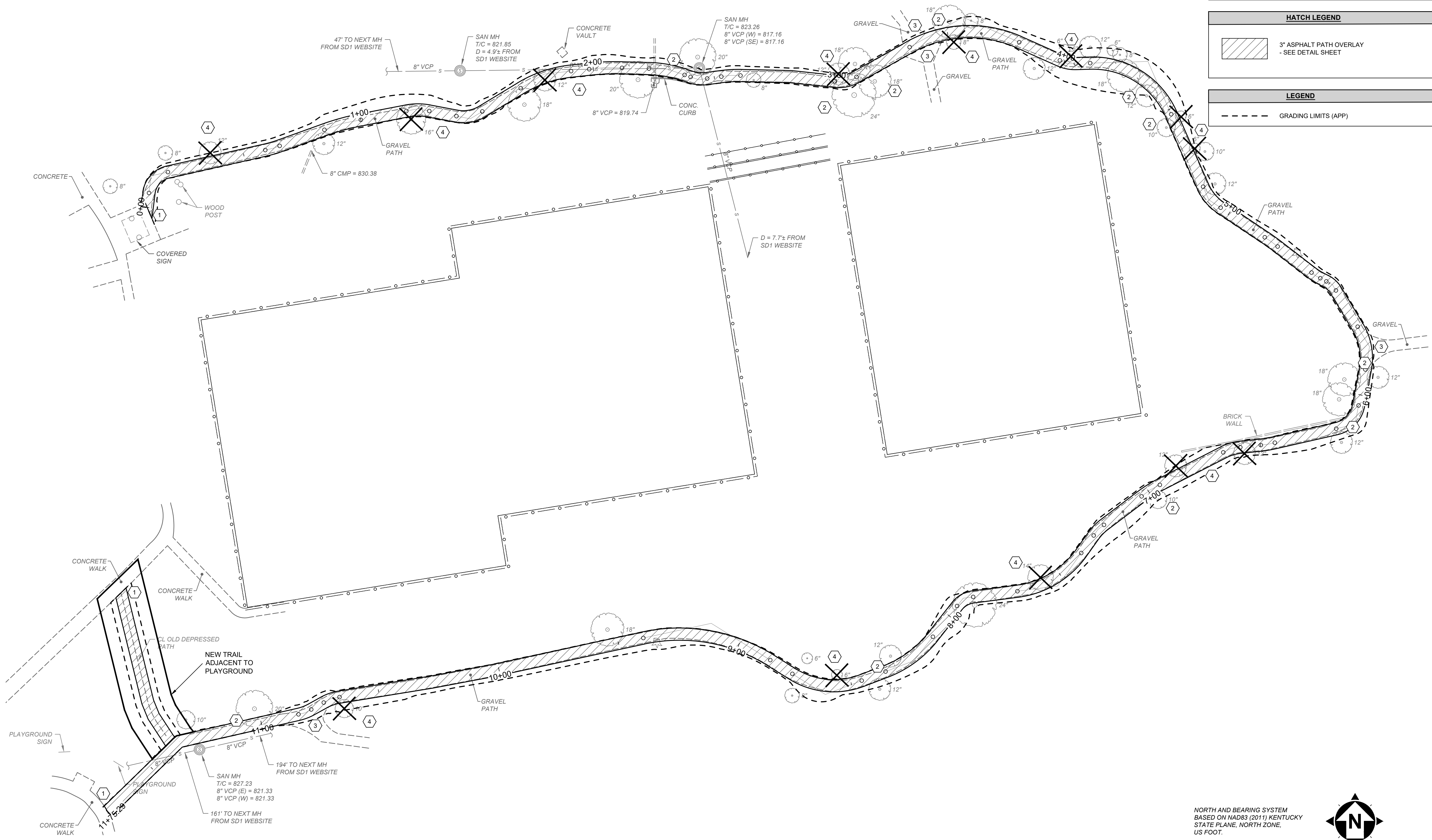

NORTH AND BEARING SYSTEM
BASED ON NAD83 (2011) KENTUCKY
STATE PLANE, NORTH ZONE,
US FOOT.

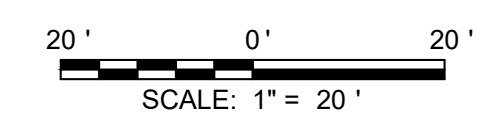
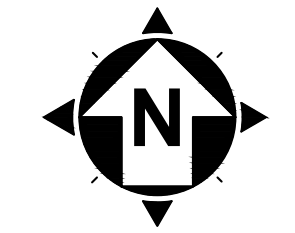

ISSUED FOR:	BID NO:	NO.	REVISION	DATE
ISSUE DATE: 02/11/2025	02/11/2025			
SCALE:				
DESIGNED BY: RSEI				
DRAWN BY: RSEI				
CHECKED BY: FTWE				

**TOWER PARK - TENNIS COURT
IMPROVEMENTS
CITY OF FORT THOMAS
- CAMPBELL COUNTY -
OUTER TRAIL IMPROVEMENTS
SHEET - 01**

PROJECT NO.	232586
DISCIPLINE	CIVIL
SHEET NAME	TRAIL-01
SHEET	6
OF	10

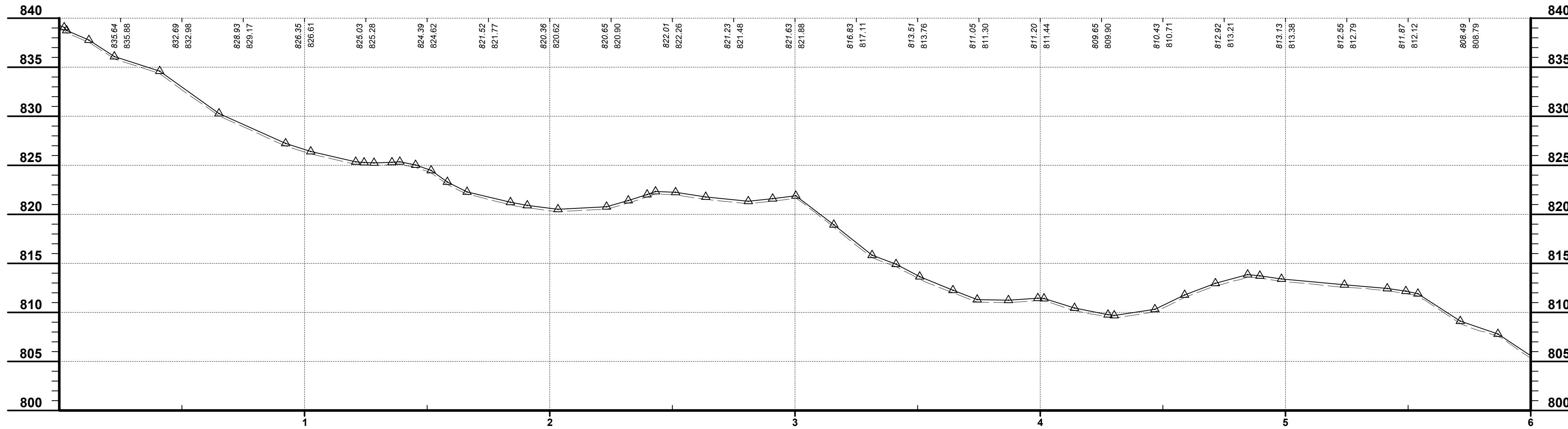

PRO-1

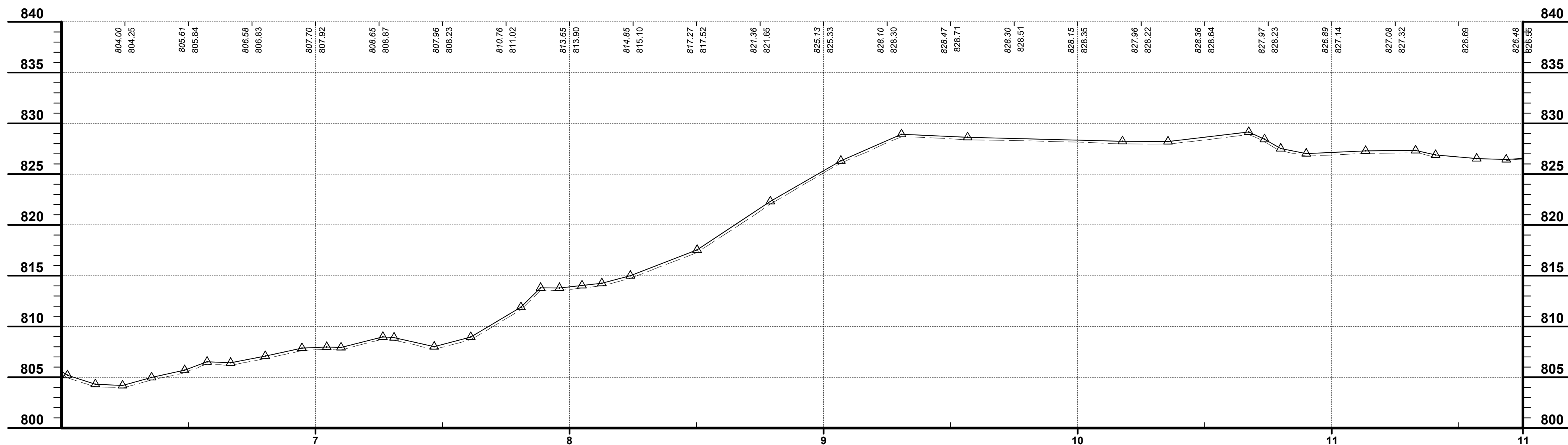

PRO-2



2181 CHAMBER CENTER DRIVE
FORT MITCHELL, KENTUCKY 41017
TEL: (609) 525-0644
WWW.VERDANTAS.COM

ISSUED FOR:	BID NO:	REVISION	DATE
ISSUE DATE:	02/11/2025		
SCALE:			
DESIGNED BY:	RSEI		
DRAWN BY:	RSEI		
CHECKED BY:	FTWE		

**TOWER PARK - TENNIS COURT
IMPROVEMENTS
CITY OF FORT THOMAS
- CAMPBELL COUNTY -
OUTER TRAIL IMPROVEMENTS
SHEET - 02**

PROJECT NO. 232586	
DISCIPLINE CIVIL	
SHEET NAME TRAIL-02	
SHEET 7	OF 10

CONSTRUCTION NOTES - ACCESS PATH

A-1 INSTALL HANDRAIL ALONG NORTHERN SIDE OF PROPOSED CONCRETE PATH.

A-2 ALTERNATE BID: INSTALL STEPS WITH HANDRAIL ALONG SOUTHERN SIDE OF PATH. SEE ACCESS-02 FOR MORE DETAIL.

HATCH LEGEND

 1.5" PAVEMENT MILLING & ASPHALT PATH OVERLAY- SEE DETAIL SHEET

 REMOVED EX ASPHALT PATH AND RECONSTRUCT WITH CONCRETE - SEE DETAIL SHEET - FINAL LOCATION MARKED IN FIELD

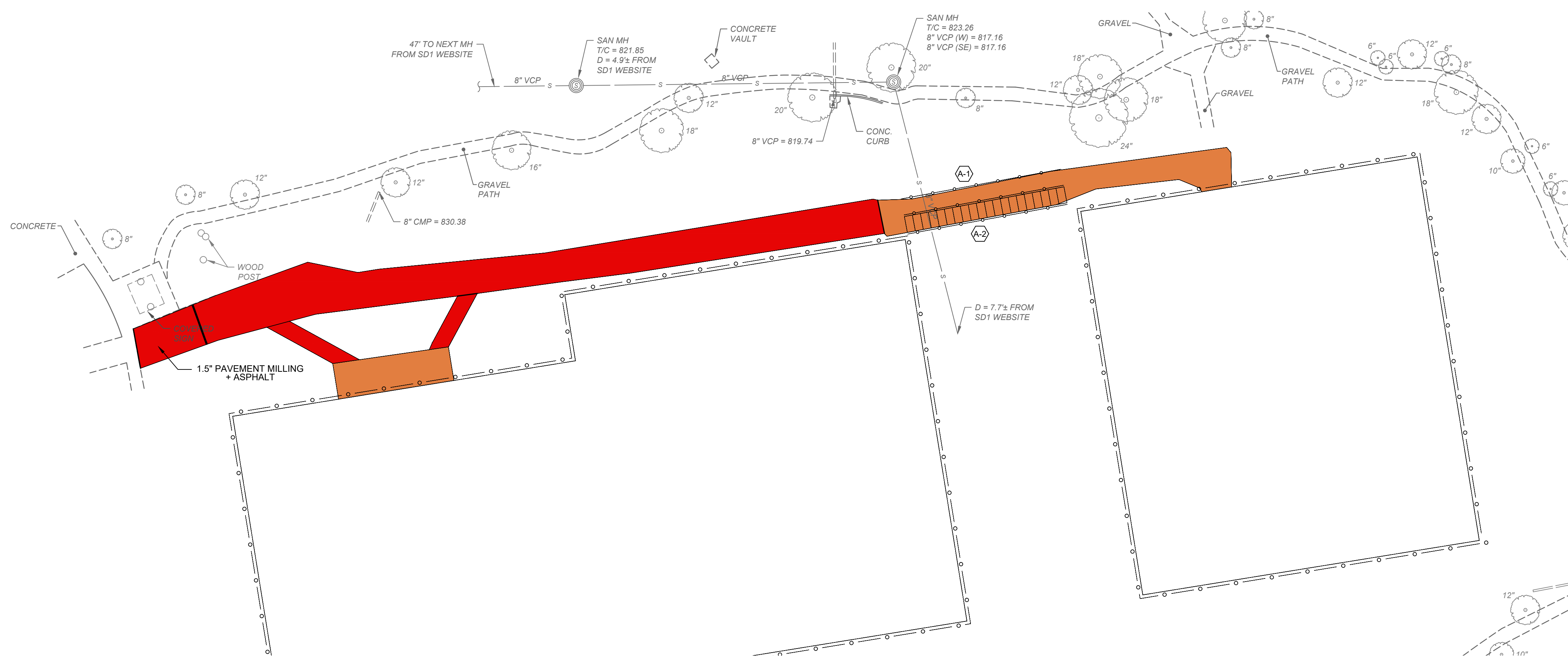

 REMOVED EX ASPHALT PATH AND RECONSTRUCT WITH CONCRETE (WITHIN LIMITS OF RED BOX) - SEE DETAIL SHEET



 1.5" PAVEMENT MILLING & ASPHALT PATH OVERLAY- SEE DETAIL SHEET



 REMOVED EX ASPHALT PATH AND RECONSTRUCT WITH CONCRETE - SEE DETAIL SHEET - FINAL LOCATION MARKED IN FIELD

NORTH AND BEARING SYSTEM
BASED ON NAD83 (2011) KENTUCKY
STATE PLANE, NORTH ZONE,
US FOOT.

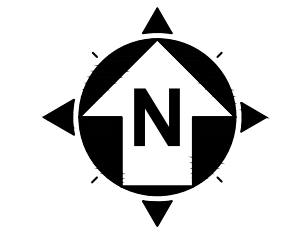

20' 0' 20'
SCALE: 1" = 20'

verdantas

2181 CHAMBER CENTER DRIVE
FORT MITCHELL, KENTUCKY 41017
TEL: (609) 525-0644
WWW.VERDANTAS.COM

ISSUED FOR:	BID NO:	DATE
ISSUE DATE:	REVISION NO:	DATE
02/11/2025		
SCALE:	DESIGNED BY:	CHECKED BY:
	RSEI	FTWE
DRAWN BY:	DESIGNED BY:	CHECKED BY:
	RSEI	FTWE

**TOWER PARK - TENNIS COURT
IMPROVEMENTS**
CITY OF FORT THOMAS
- CAMPBELL COUNTY -

**ACCESS PATH IMPROVEMENTS
SHEET - 01**

PROJECT NO.	232586
DISCIPLINE	CIVIL
SHEET NAME	ACCESS-01
SHEET	OF
8	10

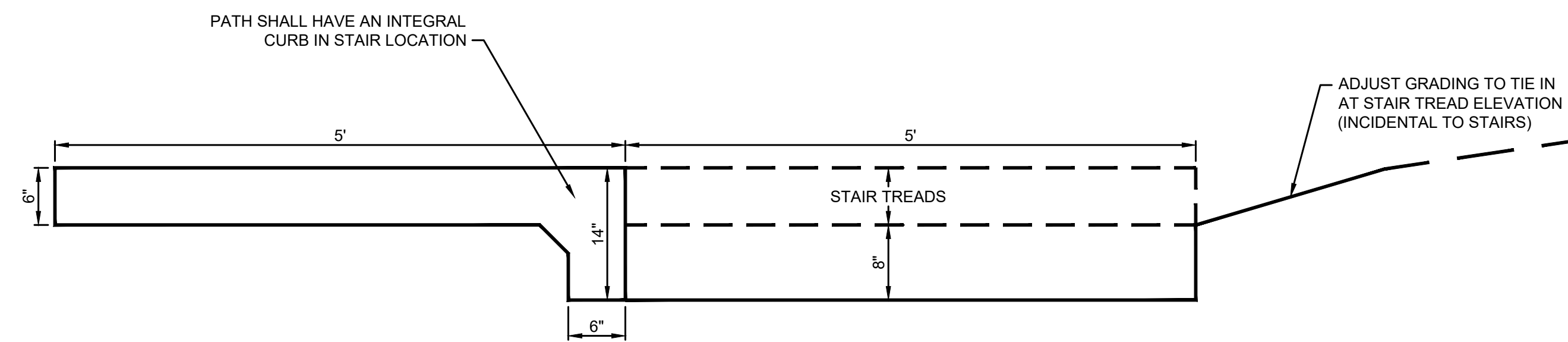
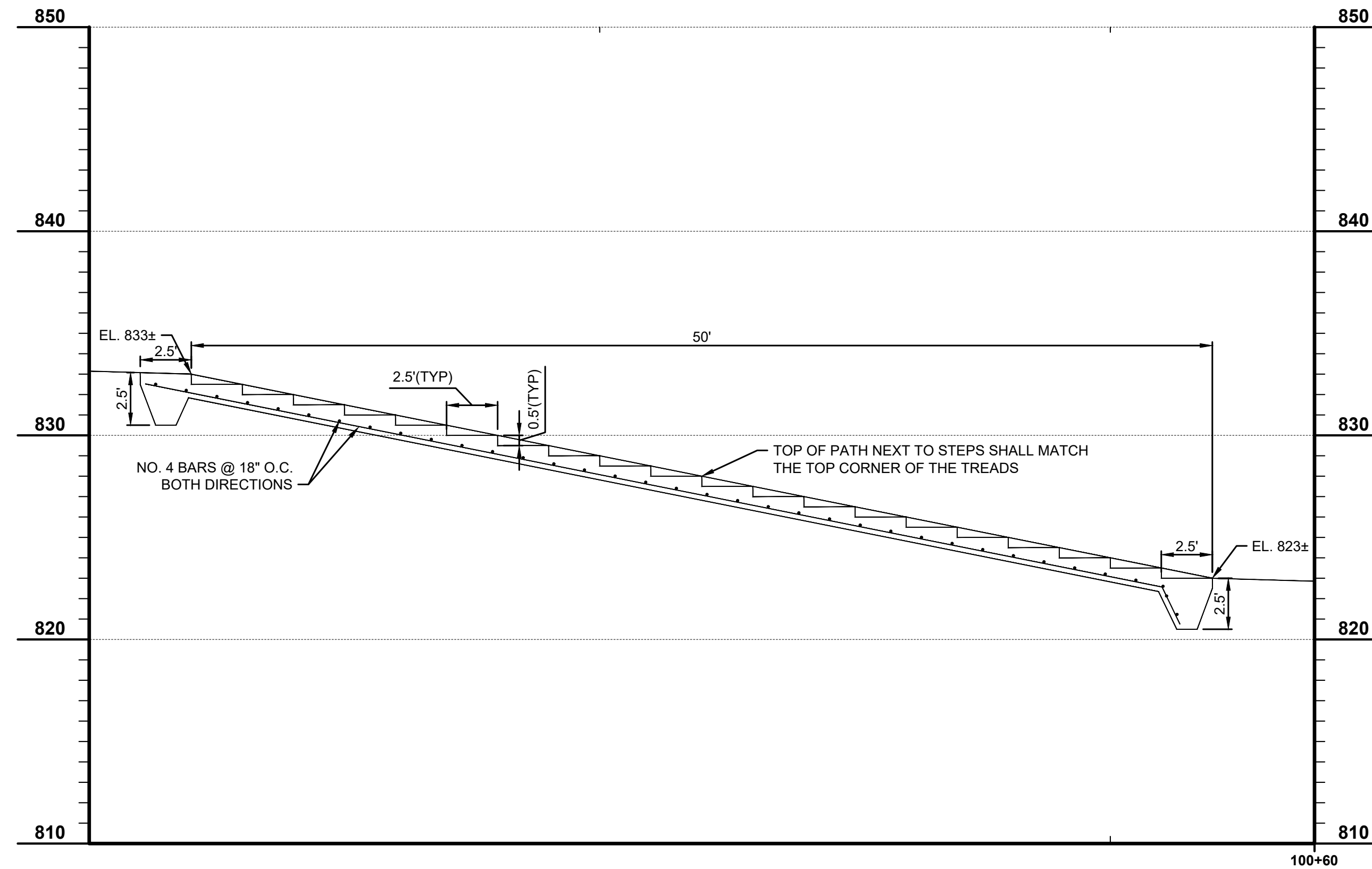

ISSUED FOR:	BID NO.	REVISION	DATE
ISSUE DATE: 02/11/2025			
SCALE:			
DESIGNED BY: RSEI			
DRAWN BY: RSEI			
CHECKED BY: FTWE			

**TOWER PARK - TENNIS COURT
IMPROVEMENTS
CITY OF FORT THOMAS
- CAMPBELL COUNTY -
ACCESS PATH IMPROVEMENTS
SHEET - 02**

PROJECT NO. 232586	
DISCIPLINE CIVIL	
SHEET NAME ACCESS-02	
SHEET 9	OF 10

- CONSTRUCTION NOTES - TENNIS COURT**
- C1 REMOVE EXISTING FENCE. (INCIDENTAL TO CLEARING AND GRUBBING)
 - C2 INSTALL NEW 12' TALL HIGH COMMERCIAL GRADE BLACK VINYL FENCE.
 - C3 INSTALL NEW 20' TALL HIGH COMMERCIAL GRADE BLACK VINYL FENCE.
 - C4 INSTALL DOUBLE SWING GATE.
 - C5 INSTALL SINGLE SWING GATE.
 - C6 REMOVE EXISTING NET AND POST SYSTEM. (INCIDENTAL TO CLEARING AND GRUBBING)
 - C7 INSTALL NEW NET AND POST SYSTEM

- HATCH LEGEND**
- 2" ASPHALT COURT MILL AND OVERLAY - SEE DETAIL SHEET



NORTH AND BEARING SYSTEM
 BASED ON NAD83 (2011) KENTUCKY
 STATE PLANE, NORTH ZONE,
 US FOOT.

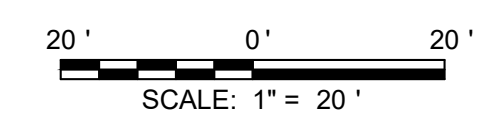
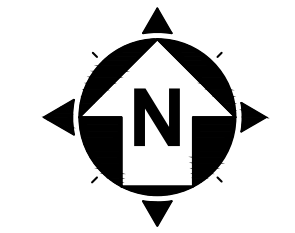

ISSUED FOR:	BID NO:	REVISION	DATE
ISSUE DATE: 02/11/2025	02/11/2025		
SCALE:			
DESIGNED BY: RSEI			
DRAWN BY: RSEI			
CHECKED BY: FTWE			

**TOWER PARK - TENNIS COURT
 IMPROVEMENTS
 CITY OF FORT THOMAS
 - CAMPBELL COUNTY -
 TENNIS COURT IMPROVEMENTS
 SHEET - 01**

PROJECT NO.	232586
DISCIPLINE	CIVIL
SHEET NAME	COURT-01
SHEET OF	10 OF 10