

CITY OF FORT THOMAS

CAMPBELL COUNTY, KENTUCKY

ROSSFORD AVE CULVERT

220890

CITY OF FORT THOMAS OFFICIALS
MAYOR ERIC HAAS
CITY CLERK MELISSA BECKETT
CITY COUNCIL MEMBERS JEFF BEZOLD ADAM BLAU BEN PENDERY LAUREN MCINTOSH ERIC STRANGE ANDY ELLISON
CITY ADMINISTRATOR MATTHEW KREMER
PUBLIC WORKS DIRECTOR KEVIN BARBIAN

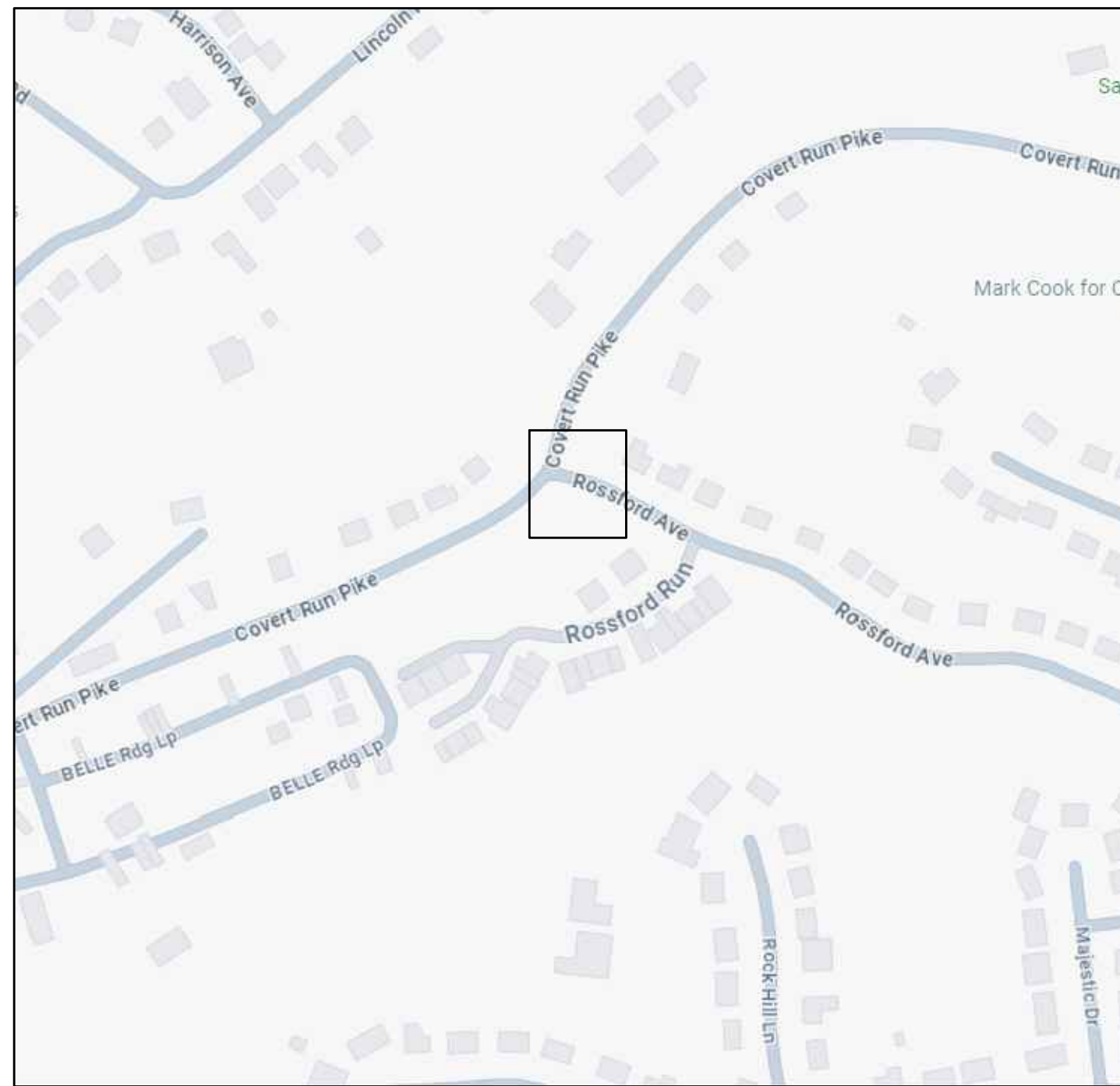

VICINITY MAP
N.T.S

INDEX OF SHEETS		
PAGE NO.	DWG NAME	SHEET TITLE
1	TTL	TITLE SHEET
2	NOTES	NOTES & LEGEND SHEET
3	MOT	DETOUR PLAN
4	PP1	CULVERT PLAN

K.T.C SPECIFICATIONS

THE LATEST STANDARD SPECIFICATIONS OF THE KENTUCKY TRANSPORTATION CABINET, INCLUDING CHANGES AND SUPPLEMENTAL SPECIFICATIONS THERETO AND CITY OF FORT WRIGHT DEPARTMENT REQUIREMENTS SHALL GOVERN THIS IMPROVEMENT.

SOURCE OF BOUNDARY INFORMATION

THE BOUNDARY INFORMATION SHOWN ON THESE PLANS IS BASED UPON FIELD BOUNDARY SURVEY BY CT CONSULTANTS, INC.

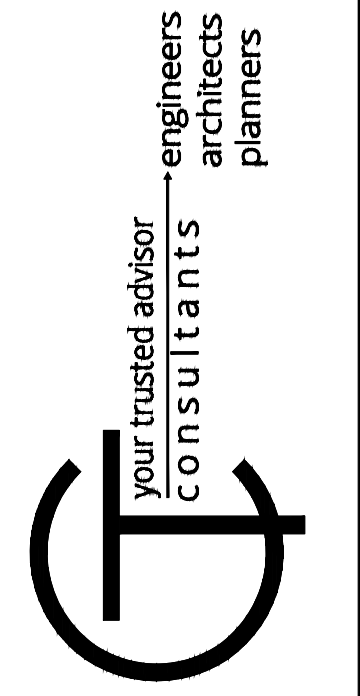

ISSUED FOR:	BID NO	DATE
ISSUE DATE: 7/11/2024	7/11/2024	
SCALE: AS SHOWN	AS SHOWN	
DESIGNED BY: MLAC	MLAC	
DRAWN BY: MLAC	MLAC	
CHECKED BY: MLAC	MLAC	

ROSSFORD AVENUE
CITY OF FORT THOMAS
CAMPBELL COUNTY, KENTUCKY
TITLE SHEET

PROJECT NO.	
220890	
DISCIPLINE	
CIVIL	
SHEET NAME	
TITLE	
SHEET	OF
1	4



H:\2022\220890\DWG\HEETS\C_220890 - TITLE SHEET.DWG - TTL - 6/13/2024 1:16:54 PM - MORK LACHNIET

GENERAL NOTES

- ALL CONSTRUCTION SHALL CONFORM TO THESE PLANS AND SPECIFICATIONS, THE LATEST EDITION OF THE CAMPBELL COUNTY SUBDIVISION REGULATIONS AND THE KENTUCKY DEPARTMENT OF HIGHWAYS STANDARD SPECIFICATIONS FOR ROAD AND BRIDGE CONSTRUCTION.
- THERE SHALL BE NO DEVIATION FROM THE APPROVED PLANS WITHOUT PRIOR WRITTEN APPROVAL FROM THE OWNER OR THEIR REPRESENTATIVE. ANY DEVIATION FROM THESE PLANS WITHOUT PRIOR WRITTEN APPROVAL SHALL BE AT THE CONTRACTOR'S RISK AND EXPENSE.
- THE CONTRACTOR SHALL OBTAIN THE SERVICES OF A TESTING AGENCY FOR ALL REQUIRED TESTING.
- ALL WORK SHALL BE LIMITED TO THE PROPERTIES AND EASEMENTS IDENTIFIED ON THE PLANS. ANY WORK WITHIN THE PUBLIC RIGHT OF WAY IS SUBJECT TO INSPECTIONS AND ENCROACHMENT PERMITS FROM THE JURISDICTION HAVING AUTHORITY OVER THE RIGHT-OF-WAY. REQUIREMENTS OF SUCH PERMITS ARE INCORPORATED INTO THESE DOCUMENTS BY REFERENCE.
- ANY DEFECTS IN CONSTRUCTION, INCLUDING MATERIALS OR WORKMANSHIP, SHALL BE REPLACED OR CORRECTED BY THE CONTRACTOR BY REMOVAL AND REPLACEMENT OR OTHER APPROVED METHODS PRIOR TO ACCEPTANCE BY THE OWNER WITH NO ADDITIONAL COMPENSATION.
- CONTRACTOR SHALL SUBMIT A PLAN FOR REVIEW AND APPROVAL BY THE ENGINEER THAT WILL INDICATE EQUIPMENT STAGING AREAS, STOCKPILE LOCATION AND SANITATION FACILITIES.
- ALL OSHA, STATE AND LOCAL SAFETY REGULATIONS SHALL BE FOLLOWED DURING CONSTRUCTION.
- APPROPRIATE BARRICADES, WARNING LIGHTS, SIGNS, FENCING ETC. SHALL BE ERRECTED AROUND THE CONSTRUCTION AREA DURING NON-WORKING HOURS TO ALERT PERSONS OF THE POTENTIAL DANGER ASSOCIATED WITH THE AREA UNDER CONSTRUCTION AS WELL AS TO PREVENT ACCESS BY UNAUTHORIZED PERSONNEL. THE CONTRACTOR IS RESPONSIBLE FOR ENSURING THE SAFETY OF THE GENERAL PUBLIC AS WELL AS ALL CONSTRUCTION PERSONNEL.
- ANY EXISTING ROADWAY, LAWN, CURB, SIDEWALK OR OTHER APPURTENANCE DISTURBED DURING CONSTRUCTION NOT DESIGNATED FOR REMOVAL OR REPLACEMENT SHALL BE RESTORED BY THE CONTRACTOR WITHOUT ADDITIONAL COMPENSATION TO A CONDITION EQUAL TO OR BETTER THAN THAT WHICH EXISTED PRIOR TO DISTURBANCE.
- ANY TEMPORARY UTILITY REQUIRED BY THE CONTRACTOR (ELECTRIC, WATER ETC.) SHALL BE AT THE SOLE EXPENSE OF THE CONTRACTOR.
- THE CONTRACTOR SHALL PRESERVE ALL BENCHMARKS, PROPERTY LINE REFERENCES, REFERENCE POINTS, STAKES AND ANY OTHER SURVEY REFERENCE. IN CASE OF DISTURBANCE THE CONTRACTOR SHALL REPLACE THEM AT THE CONTRACTOR'S EXPENSE, BE RESPONSIBLE FOR ANY ERRORS THAT MAY BE CAUSED BY THEIR LOSS OR DISTURBANCE.
- ALL PROPOSED CONCRETE PAVEMENT ABUTTING EXISTING PAVEMENT SHALL BE DOWELED INTO EXISTING CONCRETE PAVEMENT USING A 3/4" DEFORMED DOWEL WITH 9" MINIMUM EMBEDMENT.
- THE CONTRACTOR SHALL COMPLY AT ALL TIMES WITH APPLICABLE FEDERAL, STATE AND LOCAL LAWS, PROVISIONS, AND POLICIES GOVERNING SAFETY AND HEALTH, INCLUDING THE FEDERAL CONSTRUCTION SAFETY ACT (PUBLIC LAW 91-54), FEDERAL REGISTER, CHAPTER XVII, PART 1926 OF TITLE 29 REGULATIONS, OCCUPATIONAL SAFETY AND HEALTH REGULATIONS FOR CONSTRUCTION, AND SUBSEQUENT PUBLICATIONS UPDATING THESE REGULATIONS.
- THE CONTRACTOR SHALL BE RESPONSIBLE FOR EXAMINING THE AREAS AND CONDITIONS UNDER WHICH THE PROJECT IS TO BE CONSTRUCTED PRIOR TO THE SUBMISSION OF THE BID. SUBMISSION OF A BID SHALL BE CONSTRUED TO MEAN THE CONTRACTOR HAS REVIEWED THE SITE AND IS FAMILIAR WITH THE CONDITIONS AND CONSTRAINTS OF THE SITE.
- CONTRACTOR SHALL SUBMIT SHOP DRAWINGS FOR ANY PROPOSED PIPE, HEADWALLS, BACKFILL, WATER PROOFING, AGGREGATE, UNDERDRAINS AND SIMILAR MATERIALS REQUIRED TO PERFORM THE WORK DESCRIBED IN THESE PLANS. SHOP DRAWINGS ARE TO BE APPROVED AND ON ORDER PRIOR TO MOBILIZATION TO THE SITE.
- CONTRACTOR SHALL MAKE REASONABLE EFFORTS TO MINIMIZE THE DISRUPTION TO THE RESIDENCES AND FACILITATE A TIMELY INSTALLATION ON THE PROJECT.
- THIS PROJECT IS COVERED UNDER A NATION WIDE PERMIT, GREAT CARE SHALL BE TAKEN TO AVOID EXCESS DISTURBED AREA.
- CONSTRUCTION SEQUENCING SHALL ENSURE THAT THE GAS MAIN BE RESTORED AND OPERATIONAL PRIOR TO NOV 1ST.
- AN ALTERNATE BID FOR UTILIZING 72" CIRCULAR PIPE INSTEAD OF ELLIPTICAL PIPE SHALL BE PROVIDED. MODIFICATIONS TO THE JUNCTION STRUCTURE AND HEADWALLS MAY BE REQUIRED WHEN USING 72" CIRCULAR PIPE.

UTILITY NOTES

- THIS PLAN SHOWS THE APPROXIMATE LOCATION OF UNDERGROUND UTILITIES (GAS, WATER, STORM SEWER, SANITARY SEWER, TELEPHONE, ELECTRIC, ETC.). THE PREPARER DOES NOT GUARANTEE THEIR ACCURACY OR CORRECTNESS. THE INFORMATION PROVIDED SHALL BE FIELD VERIFIED PRIOR TO CONSTRUCTION. THE CONTRACTOR SHALL BE RESPONSIBLE FOR MAINTAINING THE UTILITY AS WELL AS THE SERVICE LATERALS AT ALL TIMES DURING CONSTRUCTION. THE CONTRACTOR SHALL PRACTICE CARE DURING THE GRADING AND TRENCH EXCAVATION AND SHALL BE RESPONSIBLE FOR REPLACING ANY SERVICES THAT ARE DAMAGED DURING CONSTRUCTION AT THEIR EXPENSE.
- PRIOR TO ANY EXCAVATION OVER AN EXISTING UTILITY LINE OR SERVICE, CONTRACTOR SHALL HAND EXCAVATE TO EXPOSE THE UTILITY AND DETERMINE LOCATION AND DEPTH. NOTIFY ENGINEER IMMEDIATELY OF ANY CONFLICTS.
- TOPS OF EXISTING AND PROPOSED CASTING ELEVATIONS ARE SUBJECT TO FINAL ADJUSTMENTS AS APPROVED BY THE ENGINEER AND REQUIREMENTS OF UTILITY OWNER. THIS WORK WILL BE INCIDENTAL TO THE CONTRACT.
- FORTY-EIGHT (48) HOURS BEFORE EXCAVATION IS TO COMMENCE, THE CONTRACTOR SHALL NOTIFY THE FOLLOWING AGENCIES: THE KENTUCKY UTILITY PROTECTION SERVICE AND ALL OTHER UTILITIES THAT MAY HAVE UNDERGROUND UTILITIES INVOLVING THIS PROJECT AND ARE NON-MEMBERS OF KENTUCKY UNDERGROUND PROTECTION.
- THE SITE MAY CONTAIN EXISTING PRIVATELY OWNED UTILITIES. THESE HAVE BEEN SHOWN AS ACCURATELY AS POSSIBLE BASED ON EXISTING UTILITY INFORMATION, BUT THE PREPARER OF THESE DOCUMENTS DOES NOT ATTEST TO THEIR ACCURACY OR CORRECTNESS. IT SHALL BE THE CONTRACTOR'S RESPONSIBILITY TO CONTRACT WITH A PRIVATE UTILITY MARKING AGENCY TO IDENTIFY AND LOCATE ALL PRIVATE UTILITIES WITHIN THE WORK SITE. THIS MAY INVOLVE THE EXCAVATION AND UNCOVERING OF UTILITIES TO VERIFY LOCATION. NOTIFY ENGINEER IMMEDIATELY OF ANY CONFLICTS. CONTRACT SHALL MAKE RECORDS OF ALL PRIVATE UTILITIES ENCOUNTERED DURING THE PROJECT.
- RECORD DRAWINGS OF NEW UTILITY SERVICES SHALL BE PREPARED BY THE CONTRACTOR AND SUBMITTED TO THE OWNER UPON COMPLETION OF THE PROJECT.

STORM & SANITARY NOTES

- ALL STORM AND SANITARY ITEMS SHALL BE IN ACCORDANCE WITH THE LATEST SPECIFICATIONS AND DETAILS FROM SD1.
- CONTRACTOR SHALL BE REQUIRED TO MAINTAIN STORM AND SANITARY SEWER FLOW THROUGHOUT THE PROJECT, FOR THE DURATION OF CONSTRUCTION. ALL COST FOR THE ABOVE SHALL BE INCIDENTAL TO THE CONTRACT.
- IF REQUIRED, CONTRACTOR SHALL BE RESPONSIBLE FOR CONTACTING AND SCHEDULING STORM AND SANITARY SEWER INSPECTIONS AS SET OUT IN THE PRECONSTRUCTION MEETING.
- CONNECTIONS INTO EXISTING OR PROPOSED STORM OR SANITARY SEWER STRUCTURES OR PIPES SHALL BE COMPLETED BY A CERTIFIED TAPPER BY SD1.
- ROOF DRAINS, FOUNDATION DRAINS AND OTHER CLEAN WATER CONNECTIONS TO THE SANITARY SEWER SYSTEM ARE PROHIBITED.
- CONTRACTOR SHALL ASSURE THAT THERE IS POSITIVE DRAINAGE TO THE INLETS UPON PLACEMENT OF NEW PAVEMENT
- ALL PIPES SHALL BE REINFORCED CONCRETE PIPE PER KTC 810.03

GAS NOTES

- ALL WORK RELATING TO GAS MAINS OR GAS SERVICE LINES SHALL BE COMPLETED IN ACCORDANCE WITH THE RULES AND REGULATIONS OF DUKE ENERGY
- CONTRACTOR IS RESPONSIBLE FOR COORDINATING TEMPORARY RELOCATION OF ANY GAS LINES.

ELECTRIC NOTES

- ALL WORK RELATING TO ELECTRIC LINES SHALL BE COMPLETED IN ACCORDANCE WITH THE RULES AND REGULATIONS OF DUKE ENERGY
- CONTRACTOR IS RESPONSIBLE FOR COORDINATING TEMPORARY RELOCATION OF ANY ELECTRIC LINES.

MAINTENANCE OF TRAFFIC NOTES

- ALL MAINTENANCE OF TRAFFIC PROCEDURES SHALL MEET THE REQUIREMENT OF THE MANUAL OF UNIFORM TRAFFIC CONTROL DEVICES AND SECTION 112 OF KTC STANDARD SPECIFICATIONS. THE CONTRACTOR SHALL MAINTAIN ACCESS TO LOCAL TRAFFIC (ACCESS TO RESIDENCES WITHIN CONSTRUCTION LIMITS) AT ALL TIMES. THE CONTRACTOR SHALL PROVIDE SUFFICIENT SIGN, WARNING LIGHTS, BARRICADES, OR OTHER NECESSARY DEVICES MAKE THE SITE SAFE TO THE TRAVELING PUBLIC.
- IT SHALL BE THE CONTRACTOR'S RESPONSIBILITY TO SUBMIT TO THE ENGINEER AND THE OWNER A TRAFFIC CONTROL PLAN FOR THIS PROJECT.
- PRIOR TO ANY CONSTRUCTION, THE CONTRACTOR SHALL NOTIFY THE CITY OF FORT THOMAS AND THE FORT THOMAS POLICE DEPARTMENT. AT ALL TIMES, EMERGENCY VEHICLES SHALL BE GIVEN ACCESS.
- RESIDENTS OF THE PROJECT AREA SHALL BE ALLOWED ACCESS TO THEIR PROPERTY AT ALL TIMES.
- ALTERNATE ROUTES OR CONTINUOUS TRAFFIC CONTROL SHALL BE EMPLOYED WHEN A PUBLIC WAY IS TEMPORARY BLOCKED DURING CONSTRUCTION, INCLUDING PEDESTRIAN AND BICYCLE FACILITIES. ADVANCED NOTICE SIGNS IN ACCORDANCE WITH THE MUTCD SHALL BE EMPLOYED.
- CONTRACTOR SHALL INCLUDE DETOUR SIGNAGE AS PART OF THE BID.

GRADING AND EROSION CONTROL NOTES

- ALL DISTURBED AREAS ARE TO BE RESTORED (SEEDED AND MULCHED) BY THE CONTRACTOR AND SHALL PROCEED WITH JOB PROGRESSION. THE CONTRACTOR SHALL ALSO BE RESPONSIBLE FOR REMOVING ANY EXCESS MATERIALS AT THE SITE AND MAINTAINING ALL SEEDED AND MULCHED AREAS UNTIL PROJECT COMPLETION AND FINAL INSPECTION PER KDOT SPEC. 212. ALL DISTURBED AREAS SHALL BE RESTORED WITHIN TWENTY-ONE (21) DAYS AFTER CONSTRUCTION.
- ALL APPLICABLE RECOMMENDATIONS IN KENTUCKY'S BEST MANAGEMENT PRACTICES MANUAL SHALL BE FOLLOWED BY THE CONTRACTOR, INCLUDING SEEDING OF DISTURBED GROUND.
- ADDITIONAL BMP'S AND EROSION AND SEDIMENT CONTROL MEASURES MAY BE REQUIRED AS DEEMED NECESSARY. ALL COST FOR ABOVE SHALL BE INCLUDED IN LUMP SUM BID FOR EROSION CONTROL AND WATER POLLUTION CONTROL.
- ALL EXCAVATION IS CONSIDERED UNCLASSIFIED AND THE CONTRACTOR SHALL BE RESPONSIBLE FOR MEANS, METHODS AND MATERIALS OF CONSTRUCTION. THE DESIGN ENGINEER SHALL NOT BE RESPONSIBLE FOR THE SUITABILITY OF MATERIAL UNDERLYING THE PROJECT SITE. THE CONTRACTOR SHALL PERFORM ANY INVESTIGATIONS OR TESTING NECESSARY TO ADEQUATELY DETERMINE OR ESTIMATE TO THEIR SATISFACTION ANY EXISTING SITE CONDITION WHICH COULD AFFECT HIS BID OR THE PERFORMANCE OF THE PROPOSED IMPROVEMENTS. THIS COULD INCLUDE, BUT NOT BE LIMITED TO, UNSUITABLE OR UNSTABLE SOIL/SUBSURFACE CONDITIONS, ROCK, WATER (PERCHED OR FREE), OBSTRUCTIONS ETC.
- ALL TREES AND OTHER VEGETATION WITHIN THE PROJECT LIMITS THAT INTERFERE WITH CONSTRUCTION SHALL BE REMOVED, INCLUDED STUMP REMOVAL.
- THE CONTRACTOR SHALL REMOVE ALL SURPLUS DEMOLISHED AND WASTE MATERIALS, INCLUDING TREES, STUMPS, TRASH AND DEBRIS, FROM THE PROJECT LIMITS AND DISPOSE OF OFF-SITE. IN NO INSTANCE SHALL MATERIAL BE BURIED ON-SITE.
- THE CONTRACTOR SHALL REMOVE FROM THE SITE ALL MATERIAL DEEMED UNSUITABLE FOR EMBANKMENT BY THE OWNER'S REPRESENTATIVE AND BE DISPOSED OF OFF-SITE.
- THE CONTRACTOR SHALL PROVIDE FINAL GRADING TO WITHIN 1" OF GRADES SHOWN ON THE PLANS.
- TOPSOIL SHALL BE STRIPPED AND SOCKPILED FROM ALL AREAS TO BE GRADED, TO WHATEVER DEPTH ENCOUNTERED, AND IN A MANNER TO PREVENT INTERMINGLING WITH UNDERLYING SUBSOIL. SOILD SHALL NOT BE STOCKPILED NEAR THE EDGE OF EXCAVATIONS OR WITHIN DRIP LINES OF TREES TO REMAIN.
- EXCESS SOIL GENERATED FROM TRENCH EXCAVATIONS SHALL BE INCORPORATED IN THE UNIT PRICE BID FOR EXCAVATION INCLUDING EMBANKMENT CONSTRUCTION. ANY EXCESS SOIL UNABLE TO BE PLACED ON-SITE OR DEEMED UNSUITABLE FOR EMBANKMENT BY THE ENGINEER SHALL BE DISPOSED OF OFF-SITE.
- THE CONTRACTOR SHALL FOLLOW THE RECOMMENDATIONS IN THE SUBSURFACE EXPLORATION AND GEOTECHNICAL ENGINEERING REPORT FOR EXCAVATION AND EMBANKMENT TO CONSTRUCT THE IMPROVEMENTS AND ACHIEVE THE FINISHED GRADES SHOWN ON THE PLANS.
- NO SLAG, RIVER GRAVEL, RECYCLED PORTLAND CEMENT CONCRETE, RECLAIMED ASPHALT CONCRETE PAVEMENT OR RECLAIMED BITUMINOUS AGGREGATE BASE SHALL BE USED AS FILL.
- EXPOSED PAVEMENT SUBGRADE AREAS SHALL BE MAINTAINED IN CONDITIONS TO PREVENT PONDING OF WATER AFTER RAINS.
- ALL EXISTING AND PROPOSED MANHOLE COVERS, VALVE BOXES, ETC. LOCATED WITHIN PEDESTRIAN ACCESS SHALL BE FLUSH MOUNTED WITH THE WALKING SURFACE.
- SLOPE ALL PAVING AND LANDSCAPE AREAS AWAY FROM THE BUILDING AT A MINIMUM OF 1%
- THE ENGINEER MAKES NO REPRESENTATION AS TO A BALANCED EARTHWORK SITE. THE CONTRACTOR SHALL BE RESPONSIBLE FOR PROVIDING THE FINAL SITE GRADES AS INDICATED ON THE GRADING PLAN, INCLUDING THE IMPORT OR EXPORT OF MATERIAL IF REQUIRED TO ACHIEVE THE PROPOSED GRADES. ADDITIONALLY, THE CONTRACTOR SHALL BE RESPONSIBLE FOR THE PROPER REMOVAL AND DISPOSAL OF ALL SURPLUS EARTHWORK, DEBRIS OR WASTE FROM THE SITE. ALL COST FOR THE ABOVE SHALL BE INCLUDED IN THE CONTRACTORS BID PRICE FOR EXCAVATION AND/OR EMBANKMENT.
- THE CONTRACTOR SHALL PROTECT STRUCTURES, UTILITIES, SIDEWALKS, PAVEMENTS AND OTHER FACILITIES TO REMAIN FROM DAMAGE CAUSED BY EARTHWORK OPERATIONS.
- MAINTENANCE OF ALL TEMPORARY AND PERMANENT EROSION AND SEDIMENT CONTROL FACILITIES IS THE RESPONSIBILITY OF THE CONTRACTOR(S)
- CONTRACTOR SHALL PROVIDE WRITTEN DOCUMENTATION OF REPAIR AND/OR REPLACEMENT OF BMP'S

SYMBOL LEGEND

	EXISTING GAS LINE		PROPOSED GAS LINE
	EXISTING GAS SERVICE		PROPOSED GAS SERVICE
	EXISTING ELECTRIC (UNDERGROUND / OVERHEAD)		EXISTING ELECTRIC (UNDERGROUND / OVERHEAD)
	EXISTING CABLE (UNDERGROUND / OVERHEAD)		PROPOSED CABLE (UNDERGROUND / OVERHEAD)
	EXISTING TELEPHONE (UNDERGROUND / OVERHEAD)		PROPOSED TELEPHONE (UNDERGROUND / OVERHEAD)
	EXISTING WATER MAIN		PROPOSED WATER MAIN
	EXISTING WATER SERVICE		PROPOSED WATER SERVICE
	EXISTING STORM SEWER		PROPOSED STORM SEWER
	EXISTING ROOF DRAIN		PROPOSED ROOF DRAIN
	EXISTING SANITARY SEWER		PROPOSED SANITARY SEWER
	EXISTING SANITARY FORCE MAIN		PROPOSED SANITARY FORCE MAIN
	EXISTING FIBER OPTICS		PROPOSED FIBER OPTICS
	EXISTING FENCE		PROPOSED FENCE
	EXISTING CONTOURS (MAJOR)		PROPOSED CONTOURS (MAJOR)
	EXISTING CONTOURS (MINOR)		PROPOSED CONTOURS (MINOR)
	EXISTING RIGHT OF WAY		PROPOSED RIGHT OF WAY
	EXISTING PROPERTY LINE		PROPOSED PROPERTY LINE
	EXISTING EASEMENT		PROPOSED EASEMENT
	EXISTING GUARDRAIL		PROPOSED GUARDRAIL
	EXISTING TREE LINE		PROPOSED TREE LINE / CLEARING LIMITS
	PROPOSED DISTURBED LIMITS		
	EXISTING FLAGPOLE		PROPOSED FLAGPOLE
	EXISTING MAILBOX		PROPOSED MAILBOX
	EXISTING SIGN		PROPOSED SIGN
	EXISTING CABLE PEDESTAL		PROPOSED CABLE PEDESTAL
	EXISTING ELECTRIC PEDESTAL		PROPOSED ELECTRIC PEDESTAL
	EXISTING PULL BOX		PROPOSED PULL BOX
	EXISTING GROUND LIGHT		PROPOSED GROUND LIGHT
	EXISTING LIGHT POLE		PROPOSED LIGHT POLE
	EXISTING ELECTRIC METER		PROPOSED ELECTRIC METER
	EXISTING ELECTRIC MANHOLE		PROPOSED ELECTRIC MANHOLE
	EXISTING GAS METER		PROPOSED GAS METER
	EXISTING GAS VALVE		PROPOSED GAS VALVE
	EXISTING GAS BOX		PROPOSED GAS BOX
	EXISTING UTILITY POLE		PROPOSED UTILITY POLE
	EXISTING GUY WIRE / ANCHOR		PROPOSED GUY WIRE / ANCHOR
	EXISTING SANITARY MANHOLE		PROPOSED SANITARY MANHOLE
	EXISTING SANITARY CLEANOUT		PROPOSED SANITARY CLEANOUT
	EXISTING STORM MANHOLE		PROPOSED STORM MANHOLE
	EXISTING SINGLE / DOUBLE CURB INLET		PROPOSED SINGLE / DOUBLE CURB INLET
	EXISTING CATCH BASIN		PROPOSED CATCH BASIN
	EXISTING STORM CLEANOUT		PROPOSED STORM CLEANOUT
	EXISTING TELEPHONE MANHOLE		PROPOSED TELEPHONE MANHOLE
	EXISTING TELEPHONE PEDESTAL		PROPOSED TELEPHONE PEDESTAL
	EXISTING FIRE HYDRANT		PROPOSED FIRE HYDRANT
	EXISTING WATER METER		PROPOSED WATER METER
	EXISTING WATER VALVE		PROPOSED WATER VALVE
	EXISTING BUSHES / TREES		REMOVE EXISTING BUSH / TREE
	EXISTING SURVEY BENCHMARK		PROPOSED SLOPE DIRECTION
	TEST BORING LOCATION		

your trusted advisor
consultants
engineers
architects
planners

DATE									
REVISION	NO	BID	ISSUED FOR:	ISSUE DATE:	SCALE:	DESIGNED BY:	DRAWN BY:	CHECKED BY:	
		7/11/2024	AS SHOWN	MLAC	MLAC	MLAC			

ROSSFORD AVENUE
 CITY OF FORT THOMAS
 CAMPBELL COUNTY, KENTUCKY

NOTES & LEGEND SHEET

PROJECT NO.	
220890	
DISCIPLINE	
CIVIL	
SHEET NAME	
NOTES	
SHEET	OF
2	4

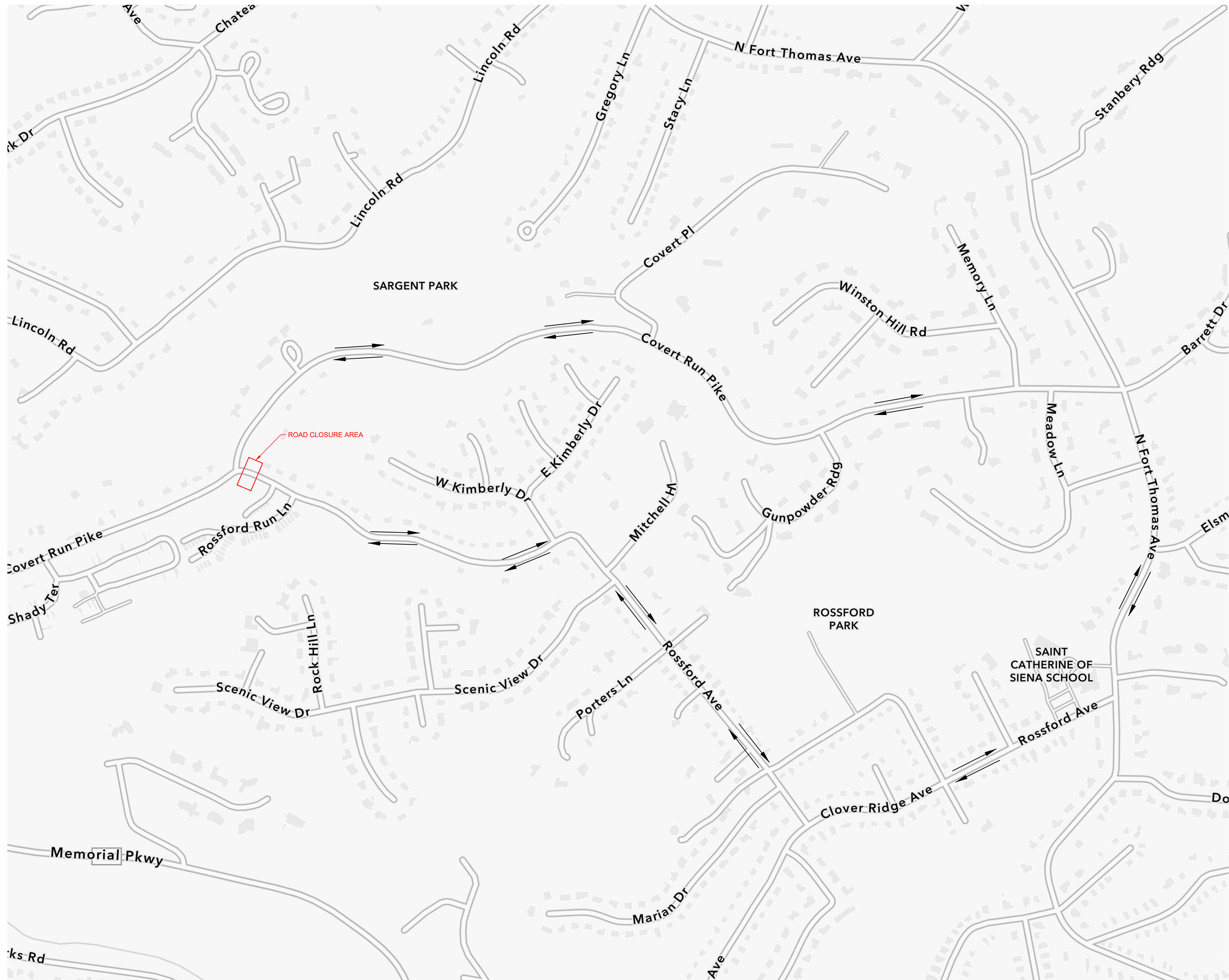

MAINTENANCE OF TRAFFIC NOTES:

ALL MAINTENANCE OF TRAFFIC PROCEDURES SHALL MEET THE REQUIREMENTS OF THE MANUAL OF UNIFORM TRAFFIC CONTROL DEVICES AND SECTION 112 OF THE LATEST EDITION OF THE KENTUCKY TRANSPORTATION CABINET STANDARD SPECIFICATIONS. THE CONTRACTOR SHALL MAINTAIN ACCESS TO LOCAL TRAFFIC (ACCESS TO RESIDENCES WITHIN THE CONSTRUCTION LIMITS) AT ALL TIMES. THE CONTRACTOR SHALL PROVIDE SUFFICIENT SIGNS, DRUMS, WARNING LIGHTS, BARRICADES OR OTHER NECESSARY DEVICES TO MAKE THE SITE SAFE TO THE TRAVELING PUBLIC.

PRIOR TO ANY CONSTRUCTION, THE CONTRACTOR SHALL NOTIFY THE CITY OF FORT THOMAS, FORT THOMAS FIRE DEPARTMENT, AND THE FORT THOMAS POLICE DEPARTMENT. AT ALL TIMES, EMERGENCY VEHICLES SHALL BE GIVEN ACCESS.

RESIDENTS OF THE PROJECT AREA SHALL BE ALLOWED ACCESS TO THEIR PROPERTY AT ALL TIMES.

EACH DRIVEWAY SHALL BE ACCESSIBLE WHENEVER POSSIBLE. WHEN PORTLAND CEMENT CONCRETE CONSTRUCTION AFFECTS A DRIVEWAY, THE CONTRACTOR SHALL NOTIFY THE AFFECTED OWNERS 24 HOURS IN ADVANCE AND ADVISE THEM TO FIND ALTERNATIVE PARKING FOR A PERIOD OF AT LEAST 10 CALENDAR DAYS AFTER THE POUR. ALTERNATIVE PARKING SHALL INCLUDE "ON STREET" PARKING WITH ACCESS TO THE PROPERTY, TEMPORARY SIDEWALKS, ETC. WILL BE NECESSARY TO PREVENT PERSONS FROM WALKING IN MUD IN ORDER TO ENTER THEIR PROPERTY. TEMPORARY BRIDGES, RAILINGS ETC. WILL BECOME NECESSARY IN ORDER TO CROSS FORMED CURB LINES, EXCAVATED AREAS BEHIND CURB LINES AND WALKWAYS, ETC.

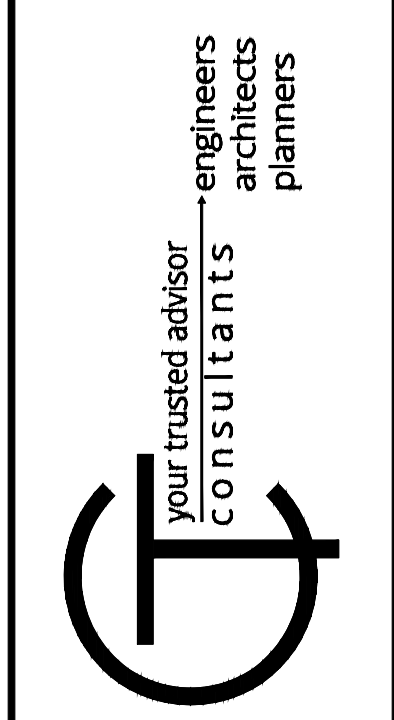

ISSUED FOR:	BID NO.	REVISION	DATE
ISSUE DATE: 7/11/2024			
SCALE: AS SHOWN			
DESIGNED BY: MLAC			
DRAWN BY: MLAC			
CHECKED BY: MLAC			

ROSSFORD AVENUE
 CITY OF FORT THOMAS
 CAMPBELL COUNTY, KENTUCKY

DETOUR PLAN

PROJECT NO.	
220890	
DISCIPLINE	
CIVIL	
SHEET NAME	
MOT	
SHEET	OF
3	4

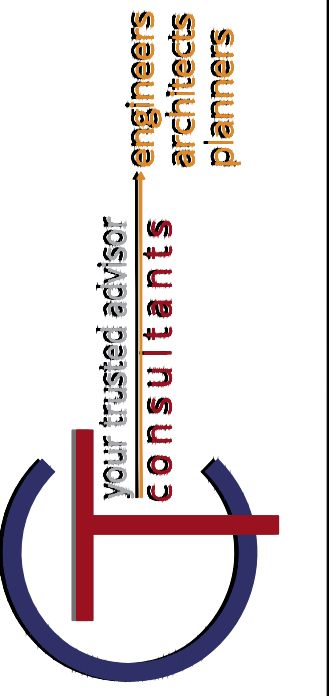
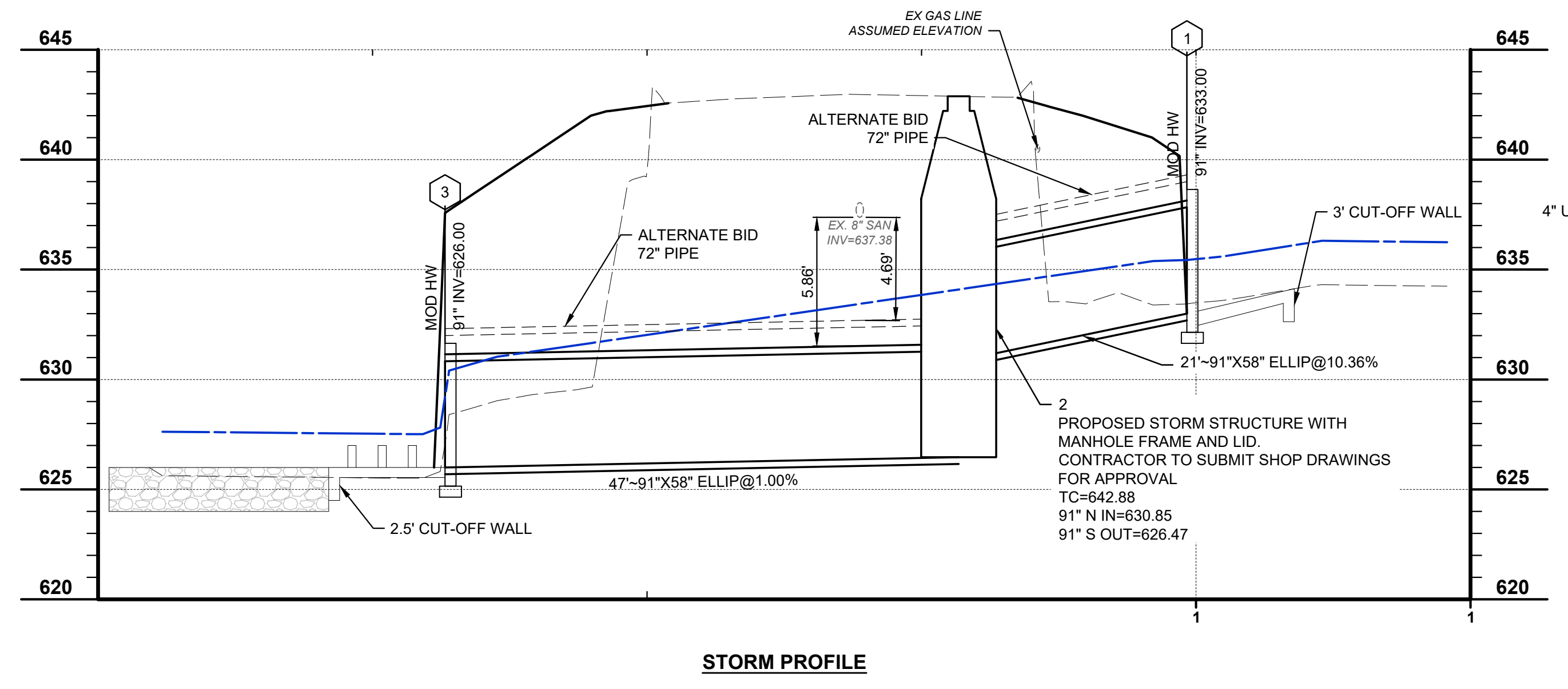
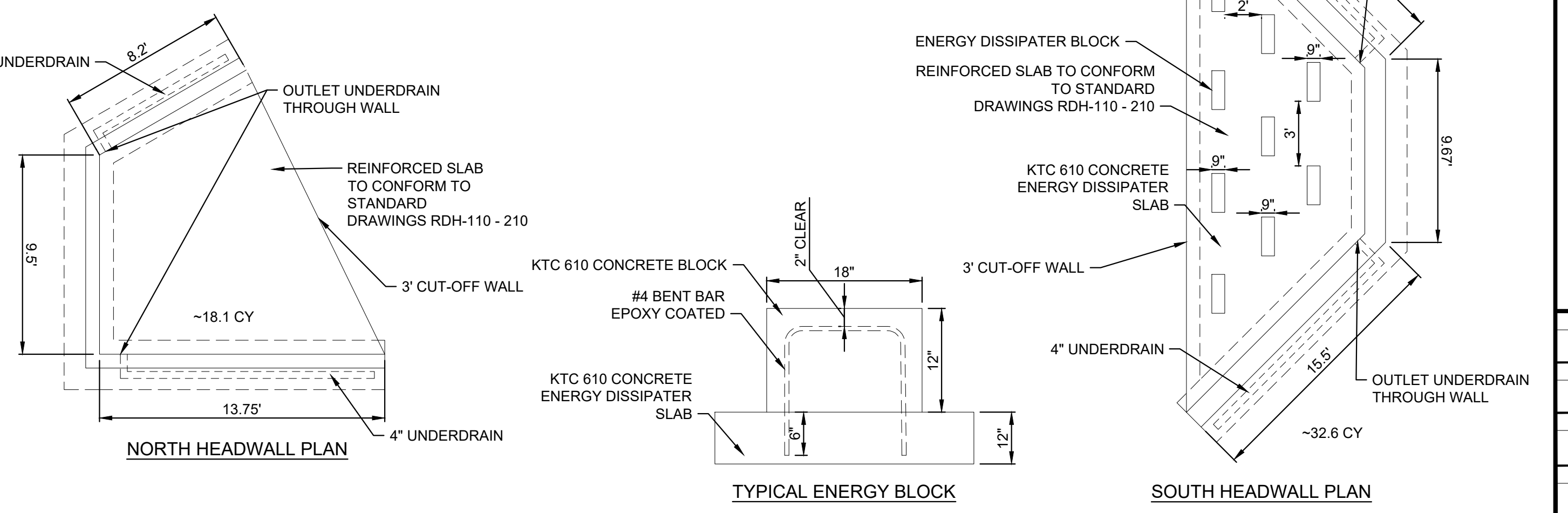
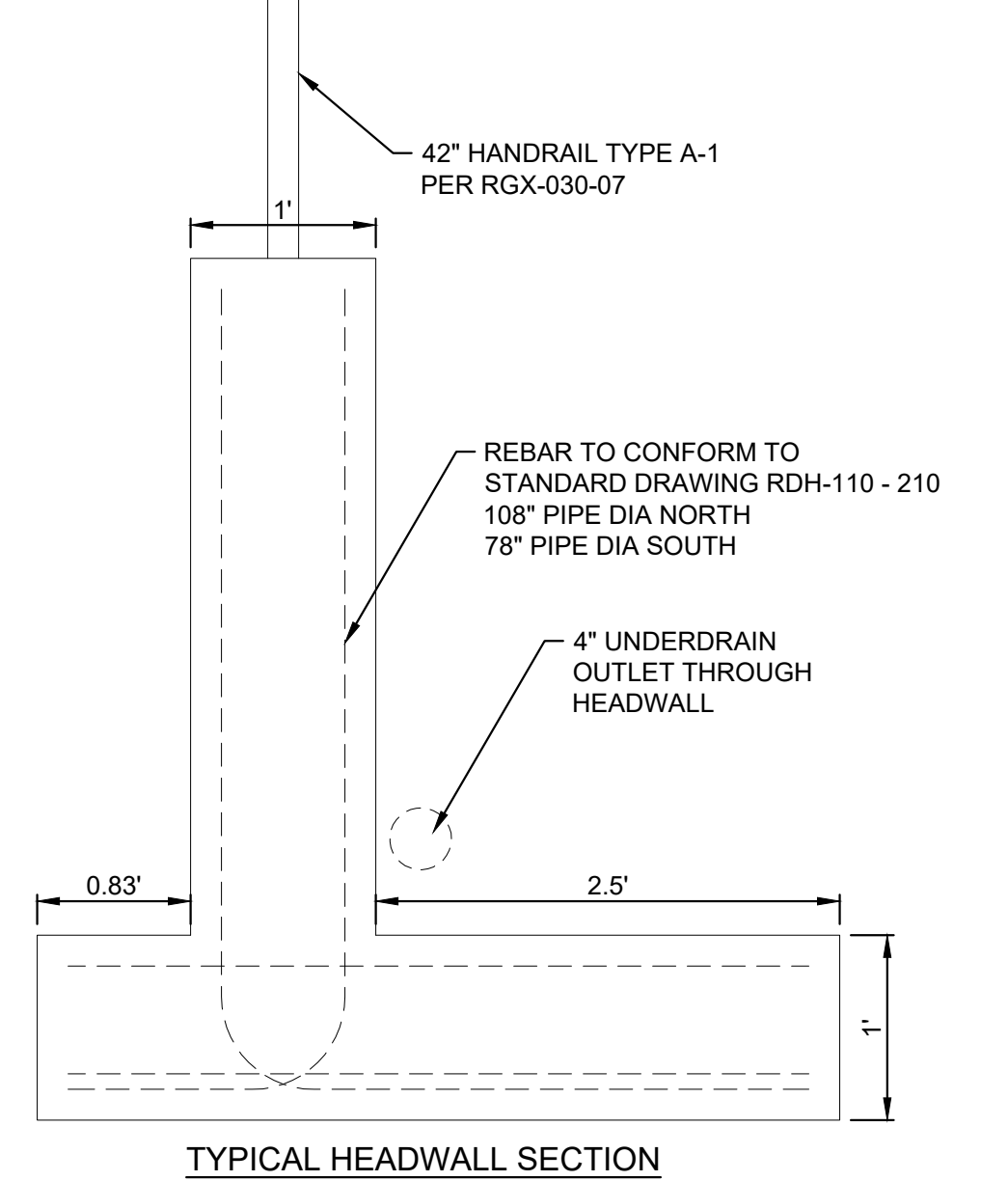
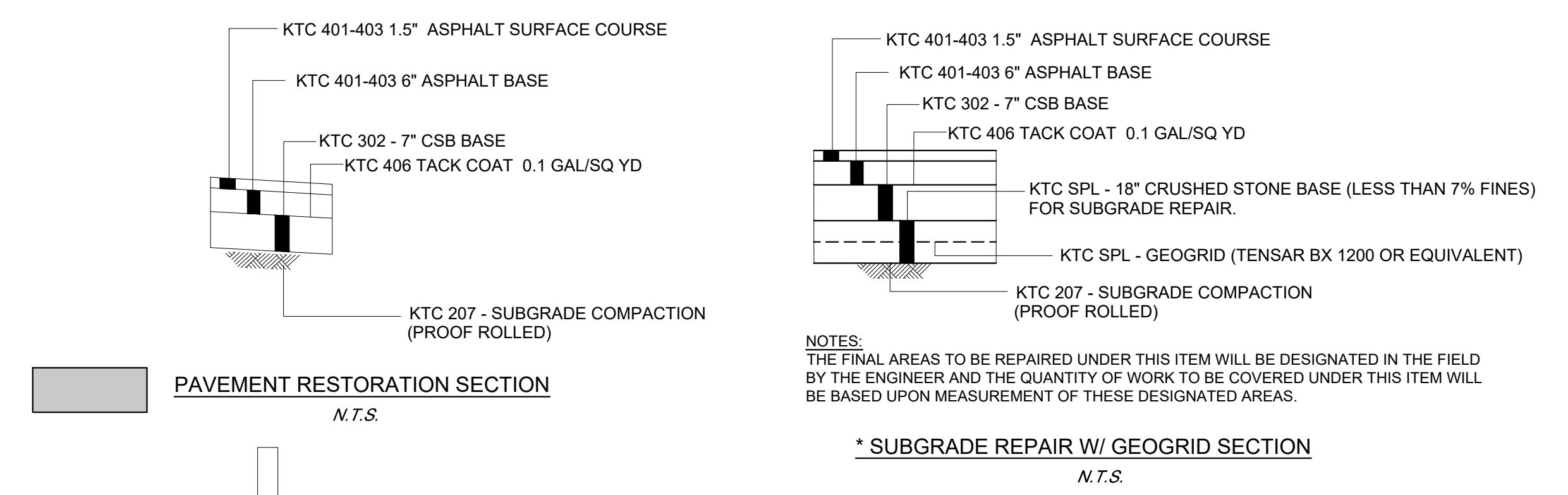
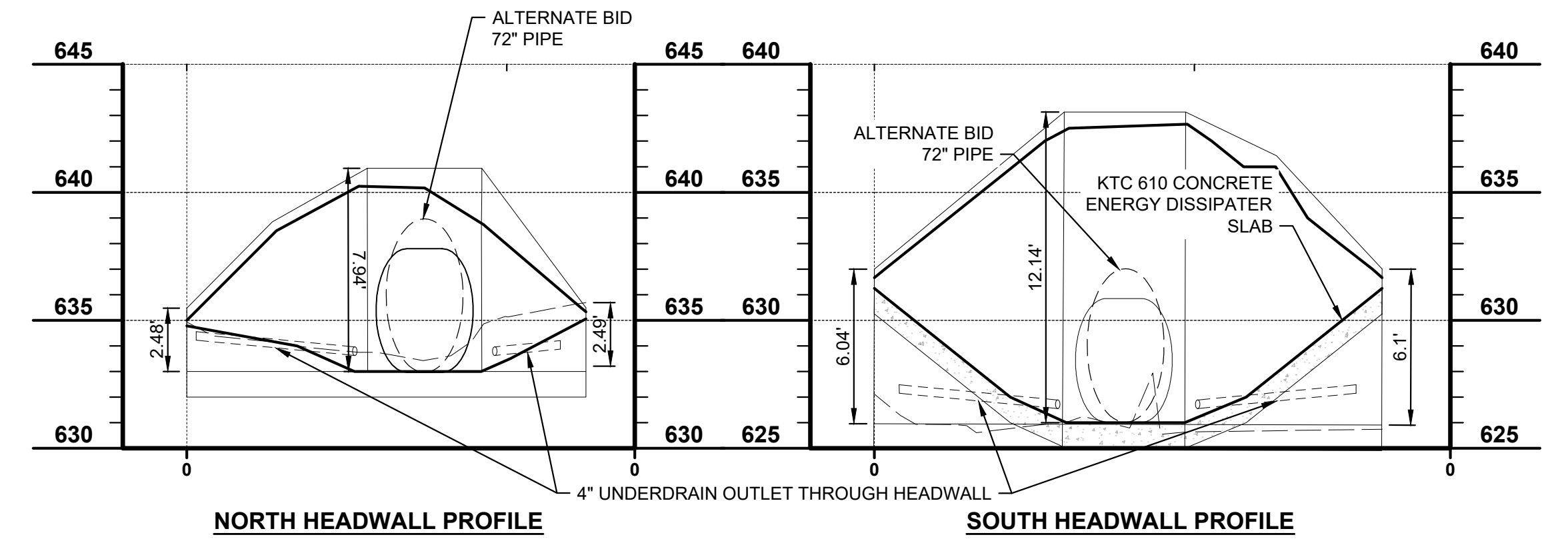
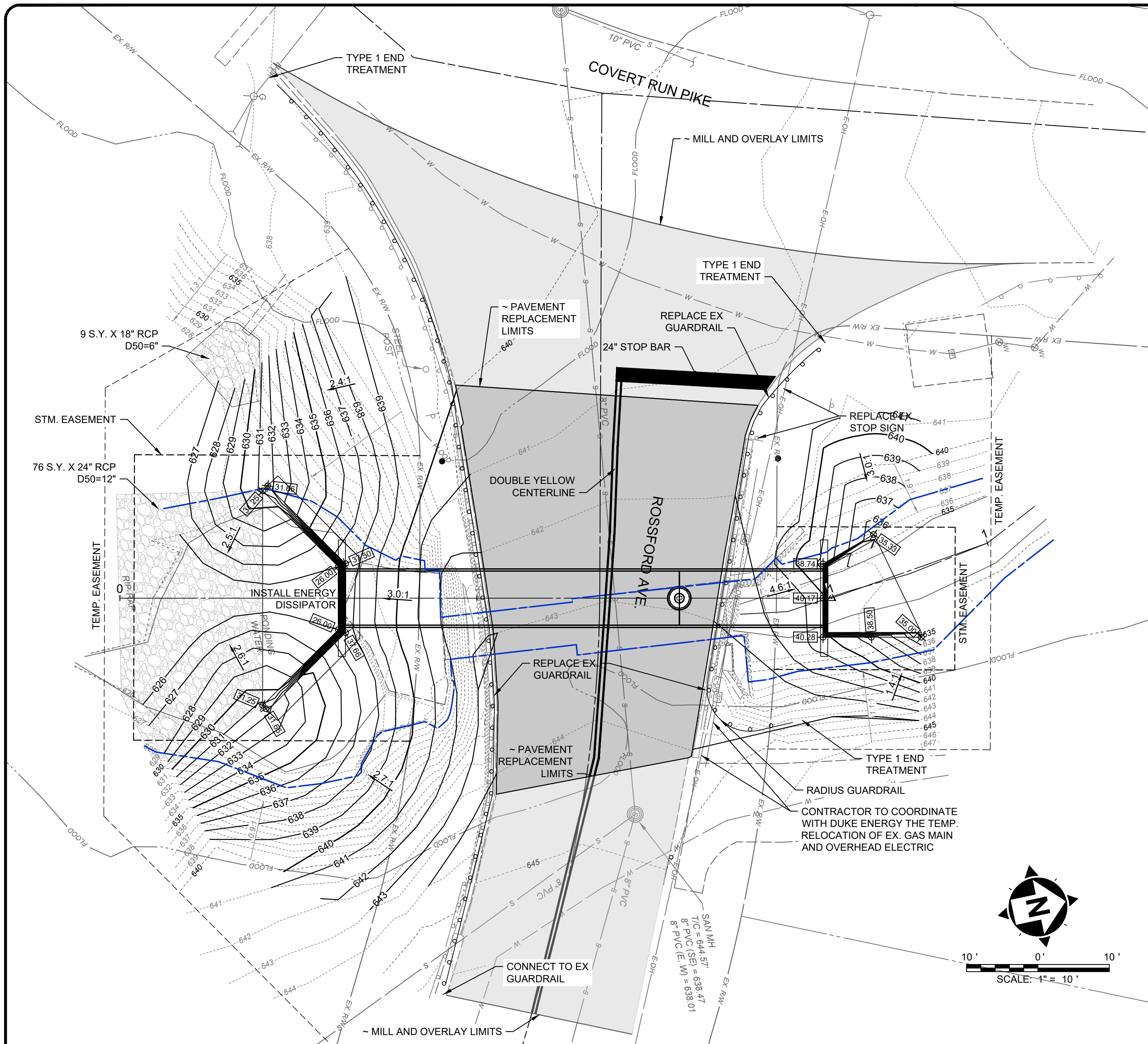

DATE	REVISION	NO	BID	ISSUED FOR:
XXXX18		A	7/11/2024	
			AS SHOWN	
			MLAC	
			MLAC	
			MLAC	

ROSSFORD AVENUE
CITY OF FORT THOMAS
CAMPBELL COUNTY, KENTUCKY

CULVERT PLAN

PROJECT NO.	220890
DISCIPLINE	CIVIL
SHEET NAME	PP1
SHEET	4
OF	4