



SITE VIEW

# CITY OF SOUTHGATE OPTIMIST PARK

## CITY OF SOUTHGATE CAMPBELL COUNTY, KENTUCKY

JOB #45436

INDEX OF SHEETS		
NO.	DWG NAME	SHEET NAME
C1	TTL	TITLE
C2	NOTES	NOTES & LEGEND
C3	EX	EXISTING CONDITIONS/DEMO SHEET
C4	LAYOUT	SITE AND UTILITY LAYOUT PLAN
C5	GRADING	GRADING AND EROSION CONTROL
C5	SWPPP	STORM WATER POLLUTION PREVENTION PLAN
L1-L3	LAND	LANDSCAPE PLAN

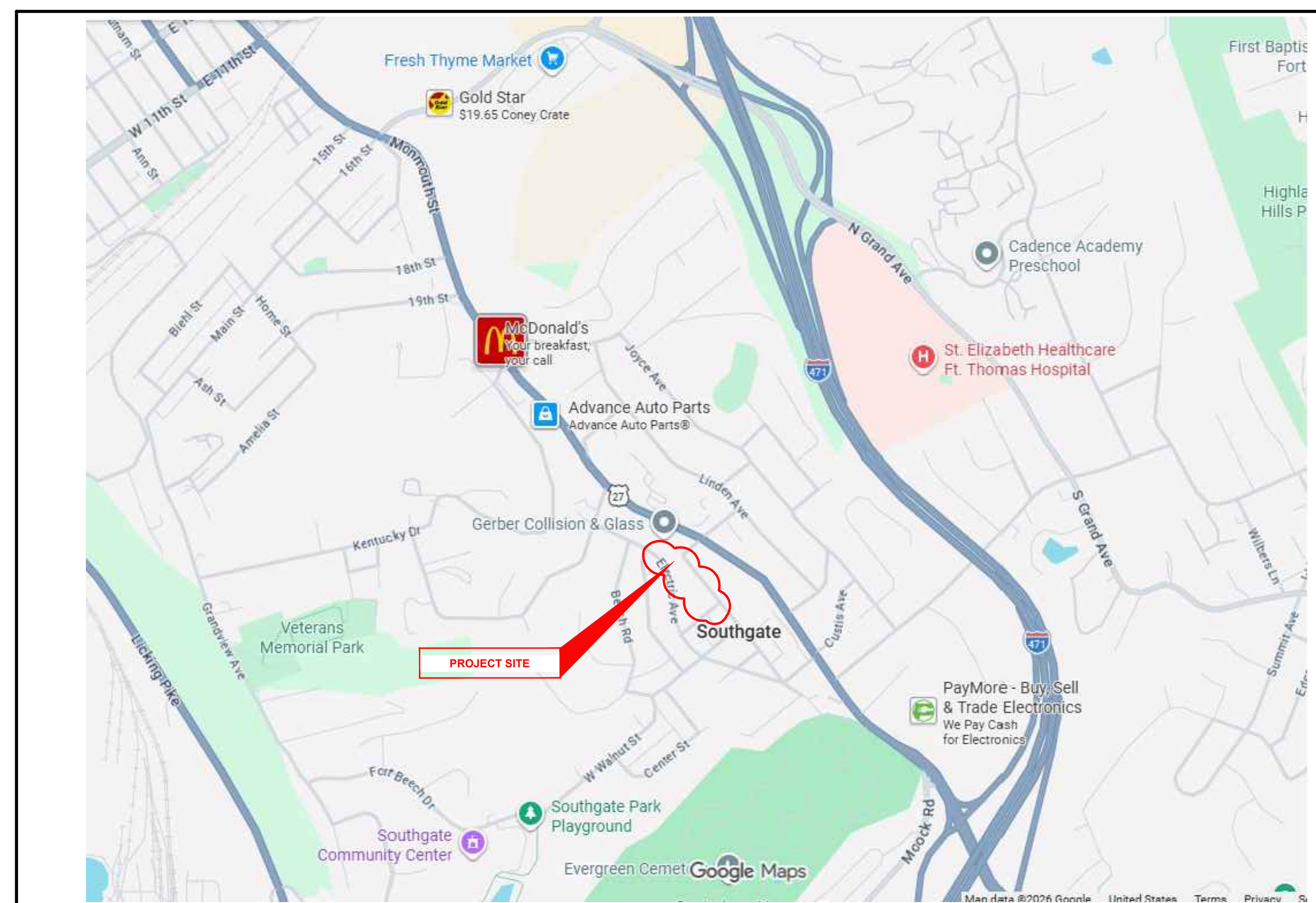

SITE MAP

**K.T.C SPECIFICATIONS**

THE LATEST STANDARD SPECIFICATIONS OF THE KENTUCKY TRANSPORTATION CABINET, INCLUDING CHANGES AND SUPPLEMENTAL SPECIFICATIONS THERETO AND CAMPBELL COUNTY SUBDIVISION REGULATION REQUIREMENTS SHALL GOVERN THIS IMPROVEMENT.

**SOURCE OF BOUNDARY AND TOPOGRAPHIC INFORMATION**

THE TOPOGRAPHIC INFORMATION SHOWN ON THESE PLANS IS BASED UPON A FIELD SURVEY BY VERDANTAS. THE BOUNDARY INFORMATION SHOWN ON THESE PLANS IS BASED UPON PLANNING AND DEVELOPMENT SERVICES (P.D.S) G.I.S. MAPPING AND DOES NOT REPRESENT AN ACTUAL FIELD BOUNDARY SURVEY BY VERDANTAS.



Z:\PROJECT FILES\8A-726\04\GATE\45436 - SOUTHGATE OPTIMIST PARK\CADD\DWG\BASE\K636 - C-BASE\4-26.DWG - TTL - 4/13/2026 3:38:53 PM - DAVE GARRETT



CITY OF SOUTHGATE OFFICIALS	
<b>MAYOR</b>	JIM HAMBERG
<b>CITY CLERK</b>	BRANDI BARTON
<b>CITY COUNCIL MEMBERS</b>	JACKSON CURRY ELIZABETH HARTMAN PAUL MELVILLE MARK MESSMER AILEEN OKURA TOM WHITEHEAD
<b>CITY ATTORNEY</b>	MARY ANN STEWART
<b>PUBLIC WORKS DIRECTOR</b>	ARVIL BOWMAN

DATE	REVISION	NO	BID	ISSUED FOR:	ISSUE DATE:	SCALE:	DESIGNED BY:	DRAWN BY:	CHECKED BY:
			4/16/2026		4/16/2026	AS NOTED			

<b>OPTIMIST PARK</b>	<b>TITLE SHEET</b>
<b>CITY OF SOUTHGATE</b>	
<b>CAMPBELL COUNTY, KENTUCKY</b>	

PROJECT NO.	45436
DISCIPLINE	CIVIL
SHEET NAME	C1
SHEET	1
OF	6

**GENERAL NOTES**

- 1. ALL CONSTRUCTION SHALL CONFORM TO THESE PLANS AND SPECIFICATIONS, THE LATEST EDITION OF THE CAMPBELL COUNTY SUBDIVISION REGULATIONS AND THE KENTUCKY DEPARTMENT OF HIGHWAYS STANDARD SPECIFICATIONS FOR ROAD AND BRIDGE CONSTRUCTION.
- 2. THERE SHALL BE NO DEVIATION FROM THE APPROVED PLANS WITHOUT PRIOR WRITTEN APPROVAL FROM THE OWNER OR THEIR REPRESENTATIVE. ANY DEVIATION FROM THESE PLANS WITHOUT PRIOR WRITTEN APPROVAL SHALL BE AT THE CONTRACTOR'S RISK AND EXPENSE.
- 3. THE CONTRACTOR SHALL OBTAIN THE SERVICES OF A TESTING AGENCY FOR ALL REQUIRED TESTING.
- 4. NOT USED.
- 5. THE CONTRACTOR SHALL BE RESPONSIBLE FOR ALL CONSTRUCTION LAYOUT STAKING INCLUDING HORIZONTAL AND VERTICAL CONTROL. ANY DISCREPANCIES DISCOVERED IN THE PLAN INFORMATION, OR BETWEEN THE PLAN AND ELECTRONIC DATA SHALL BE BROUGHT TO THE IMMEDIATE ATTENTION OF THE DESIGN ENGINEER SO THE APPROPRIATE ADJUSTMENTS MAY BE MADE.
- 6. ALL WORK SHALL BE LIMITED TO THE PROPERTIES AND EASEMENTS IDENTIFIED ON THE PLANS. ANY WORK WITHIN THE PUBLIC RIGHT OF WAY IS SUBJECT TO INSPECTIONS AND ENCROACHMENT PERMITS FROM THE JURISDICTION HAVING AUTHORITY OVER THE RIGHT-OF-WAY. REQUIREMENTS OF SUCH PERMITS ARE INCORPORATED INTO THESE DOCUMENTS BY REFERENCE.
- 7. ANY DEFECTS IN CONSTRUCTION, INCLUDING MATERIALS OR WORKMANSHIP, SHALL BE REPLACED OR CORRECTED BY THE CONTRACTOR BY REMOVAL AND REPLACEMENT OR OTHER APPROVED METHODS PRIOR TO ACCEPTANCE BY THE OWNER WITH NO ADDITIONAL COMPENSATION.
- 8. CONTRACTOR SHALL SUBMIT A PLAN OF OPERATIONS FOR REVIEW AND APPROVAL BY THE ARCHITECT THAT WILL INDICATE EQUIPMENT STAGING AREAS, STOCKPILE LOCATION AND SANITATION FACILITIES.
- 9. RIGHT-OF-WAY AND PROPERTY LINES SHOWN ARE PLOTTED FROM CAMPBELL COUNTY G.I.S. MAPPING AND ARE APPROXIMATE AND NOT THE RESULT OF A FIELD BOUNDARY SURVEY.
- 10. ALL OSHA, STATE AND LOCAL SAFETY REGULATIONS SHALL BE FOLLOWED DURING CONSTRUCTION.
- 11. NO CONSTRUCTION SHALL COMMENCE UNTIL ALL CAMPBELL COUNTY AND THE CITY OF SOUTHGATE PERMITS HAVE BEEN ISSUED AS REQUIRE.
- 12. APPROPRIATE BARRICADES, WARNING LIGHTS, SIGNS, FENCING ETC. SHALL BE ERRECTED AROUND THE CONSTRUCTION AREA DURING NON-WORKING HOURS TO ALERT PERSONS OF THE POTENTIAL DANGER ASSOCIATED WITH THE AREA UNDER CONSTRUCTION AS WELL AS TO PREVENT ACCESS BY UNAUTHORIZED PERSONNEL. THE CONTRACTOR IS RESPONSIBLE FOR ENSURING THE SAFETY OF THE GENERAL PUBLIC AS WELL AS ALL CONSTRUCTION PERSONNEL.
- 13. ANY EXISTING ROADWAY, LAWN, CURB, SIDEWALK OR OTHER APPURTENANCE DISTURBED DURING CONSTRUCTION NOT DESIGNATED FOR REMOVAL OR REPLACEMENT SHALL BE RESTORED BY THE CONTRACTOR WITHOU ADDITIONAL COMPENSATION TO A CONDITION EQUAL TO OR BETTER THAN THAT WHICH EXISTED PRIOR TO DISTURBANCE.
- 14. ANY TEMPORARY UTILITY REQUIRED BY THE CONTRACTOR (ELECTRIC, WATER ETC.) SHALL BE AT THE SOLE EXPENSE OF THE CONTRACTOR.
- 15. THE CONTRACTOR SHALL PRESERVE ALL BENCHMARKS, PROPERTY LINE REFERENCES, REFERENCE POINTS, STAKES AND ANY OTHER SURVEY REFERENCE. IN CASE OF DISTURBANCE THE CONTRACTOR SHALL REPLACE THEM AT THE CONTRACTOR'S EXPENSE. BE RESPONSIBLE FOR ANY ERRORS THAT MAY BE CAUSED BY THEIR LOSS OR DISTURBANCE.
- 16. ALL PROPOSED CONCRETE PAVEMENT ABUTTING EXISTING PAVEMENT SHALL BE DOWELED INTO EXISTING CONCRETE PAVEMENT USING A 1/2" DEFORMED DOWEL WITH 9" MINIMUM EMBEDMENT.
- 17. THE CONTRACTOR SHALL COMPLY AT ALL TIMES WITH APPLICABLE FEDERAL, STATE AND LOCAL LAWS, PROVISIONS, AND POLICIES GOVERNING SAFETY AND HEALTH, INCLUDING THE FEDERAL CONSTRUCTION SAFETY ACT (PUBLIC LAW 91-54), FEDERAL REGISTER, CHAPTER XVII, PART 1926 OF TITLE 29 REGULATIONS, OCCUPATIONAL SAFETY AND HEALTH REGULATIONS FOR CONSTRUCTION, AND SUBSEQUENT PUBLICATIONS UPDATING THESE REGULATIONS.
- 18. THE CONTRACTOR SHALL BE RESPONSIBLE FOR EXAMINING THE AREAS AND CONDITIONS UNDER WHICH THE PROJECT IS TO BE CONSTRUCTED PRIOR TO THE SUBMISSION OF THE BID. SUBMISSION OF A BID SHALL BE CONSTRUED TO MEAN THE CONTRACTOR HAS REVIEWED THE SITE AND IS FAMILIAR WITH THE CONDITIONS AND CONSTRAINTS OF THE SITE.
- 19. CONTRACTOR SHALL REFER TO OTHER PLANS WITHIN THIS CONSTRUCTION SET FOR OTHER PERTINENT INFORMATION.

**ACCESSIBILITY NOTES**

- 1. ALL REQUIREMENTS OF THE AMERICANS WITH DISABILITIES ACT (ADA) SHALL BE FOLLOWED IN ALL ASPECTS OF THE PROJECT.
- 2. ALL SIDEWALKS INSTALLED SHALL HAVE A MAXIMUM CROSS SLOPE OF 2%
- 3. HANDICAP ACCESSIBLE PARKING SPACES SHALL NOT EXCEED A SLOPE OF 2% IN ANY DIRECTION
- 4. ALL CURB RAMPS SHOWN ALONG A DESIGNATED ACCESSIBLE ROUTE SHALL BE FLUSH WITH THE ADJACENT PAVEMENT.

**UTILITY NOTES**

- 1. THIS PLAN SHOWS THE APPROXIMATE LOCATION OF UNDERGROUND UTILITIES (GAS, WATER, STORM SEWER, SANITARY SEWER, TELEPHONE, ELECTRIC, ETC.). THE PREPARER DOES NOT GUARANTEE THEIR ACCURACY OR CORRECTNESS. THE INFORMATION PROVIDED SHALL BE FIELD VERIFIED PRIOR TO CONSTRUCTION. THE CONTRACTOR SHALL BE RESPONSIBLE FOR MAINTAINING THE UTILITY AS WELL AS THE SERVICE LATERALS AT ALL TIMES DURING CONSTRUCTION. THE CONTRACTOR SHALL PRACTICE CARE DURING THE GRADING AND TRENCH EXCAVATION AND SHALL BE RESPONSIBLE FOR REPLACING ANY SERVICES THAT ARE DAMAGED DURING CONSTRUCTION AT THEIR EXPENSE.
- 2. PRIOR TO ANY EXCAVATION OVER AN EXISTING UTILITY LINE OR SERVICE, CONTRACTOR SHALL HAND EXCAVATE TO EXPOSE THE UTILITY AND DETERMINE LOCATION AND DEPTH. NOTIFY ENGINEER IMMEDIATELY OF ANY CONFLICTS.
- 3. TOPS OF EXISTING AND PROPOSED CASTING ELEVATIONS ARE SUBJECT TO FINAL ADJUSTMENTS AS APPROVED BY THE ENGINEER AND REQUIREMENTS OF UTILITY OWNER. THIS WORK WILL BE INCIDENTAL TO THE CONTRACT.
- 4. FORTY-EIGHT (48) HOURS BEFORE EXCAVATION IS TO COMMENCE, THE CONTRACTOR SHALL NOTIFY THE FOLLOWING AGENCIES: THE KENTUCKY UTILITY PROTECTION SERVICE AND ALL OTHER UTILITIES THAT MAY HAVE UNDERGROUND UTILITIES INVOLVING THIS PROJECT AND ARE NON-MEMBERS OF KENTUCKY UNDERGROUND PROTECTION.
- 5. THE SITE MAY CONTAIN EXISTING PRIVATELY OWNED UTILITIES. THESE HAVE BEEN SHOWN AS ACCURATELY AS POSSIBLE BASED ON EXISTING UTILITY INFORMATION, BUT THE PREPARER OF THESE DOCUMENTS DOES NOT ATTEST TO THEIR ACCURACY OR CORRECTNESS. IT SHALL BE THE CONTRACTOR'S RESPONSIBILITY TO CONTRACT WITH A PRIVATE UTILITY MARKING AGENCY TO IDENTIFY AND LOCATE ALL PRIVATE UTILITIES WITHIN THE WORK SITE. THIS MAY INVOLVE THE EXCAVATION AND UNCOVERING OF UTILITIES TO VERIFY LOCATION. NOTIFY ENGINEER IMMEDIATELY OF ANY CONFLICTS. CONTRACT SHALL MAKE RECORDS OF ALL PRIVATE UTILITIES ENCOUNTERED DURING THE PROJECT.
- 6. RECORD DRAWINGS OF NEW UTILITY SERVICES SHALL BE PREPARED BY THE CONTRACTOR AND SUBMITTED TO THE OWNER UPON COMPLETION OF THE PROJECT.

**STORM & SANITARY NOTES**

- 1. ALL STORM AND SANITARY ITEMS SHALL BE IN ACCORDANCE WITH THE LATEST SPECIFICATIONS AND DETAILS FROM SD1. CONCRETE AND METAL PIPE MATERIALS SHALL NOT BE USED UNLESS OTHERWISE SPECIFIED ON THESE PLANS.
- 2. CONTRACTOR SHALL BE REQUIRED TO MAINTAIN STORM AND SANITARY SEWER FLOW THROUGHOUT THE PROJECT, FOR THE DURATION OF CONSTRUCTION. ALL COST FOR THE ABOVE SHALL BE INCIDENTAL TO THE CONTRACT.
- 3. IF REQUIRED, CONTRACTOR SHALL BE RESPONSIBLE FOR CONTACTING AND SCHEDULING STORM AND SANITARY SEWER INSPECTIONS AS SET OUT IN THE PRECONSTRUCTION MEETING.
- 4. CONNECTIONS INTO EXISTING OR PROPOSED STORM OR SANITARY SEWER STRUCTURES OR PIPES SHALL BE COMPLETED BY A CERTIFIED TAPPER BY SD1.
- 5. DOWNSPOUT AND UNDERDRAIN CONSTRUCTION SHALL MEET THESE AND THE LATEST SPECIFICATION OF THE CAMPBELL COUNTY SUBDIVISION REGULATIONS, SD-1 REGULATIONS AND STANDARD DRAWINGS, AND DETAILS SHOWN ON THIS PLAN, BEDDING, BACKFILLING, JOINTS, EXCAVATION AND INSTALLATION SHALL BE INCLUDED IN THE COST PER FOOT OF PIPE. STORM SEWER, DOWNSPOUT AND UNDERDRAIN PIPE MATERIAL SHALL HAVE A MANNINGS "N" VALUE OF 0.013 OR LESS (UNLESS OTHERWISE SHOWN) AND BE RIGID / SMOOTH INTERIOR WALLED PVC SDR-35 PIPE, RIBBED PVC PIPE, A-2000 PVC PIPE, UNLESS OTHERWISE SHOWN.
- 6. ROOF DRAINS, FOUNDATION DRAINS AND OTHER CLEAN WATER CONNECTIONS TO THE SANITARY SEWER SYSTEM ARE PROHIBITED.
- 7. CONTRACTOR TO PROVIDE SHOP DRAWINGS ON ALL STORM SEWER MANHOLES, INLETS AND DETENTION SYSTEMS.
- 8. CONTRACTOR SHALL ASSURE THAT THERE IS POSITIVE DRAINAGE TO THE INLETS UPON PLACEMENT OF NEW PAVEMENT

**WATER NOTES**

- 1. ALL WORK RELATING TO WATER MAINS OR WATER SERVICE LINES SHALL BE COMPLETED IN ACCORDANCE WITH THE RULES AND REGULATIONS OF THE NORTHERN KENTUCKY WATER DISTRICT (NKWD).
- 2. CONTRACTOR MAY NOT USE WATER FROM FIRE HYDRANTS WITHOUT PRIOR PERMISSION FROM NKWD
- 3. MAINTAIN A MINIMUM 10' HORIZONTAL SEPARATION AND 18" VERTICAL SEPARATION FROM ALL SANITARY SEWERS.

**GAS NOTES**

- 1. ALL WORK RELATING TO GAS MAINS OR GAS SERVICE LINES SHALL BE COMPLETED IN ACCORDANCE WITH THE RULES AND REGULATIONS OF THE DUKE ENERGY

**ELECTRIC NOTES**

- 1. ALL WORK RELATING TO ELECTRIC LINES SHALL BE COMPLETED IN ACCORDANCE WITH THE RULES AND REGULATIONS OF THE DUKE ENERGY

**MAINTENANCE OF TRAFFIC NOTES**

- 1. ALL MAINTENANCE OF TRAFFIC PROCEDURES SHALL MEET THE REQUIREMENT OF THE MANUAL OF UNIFORM TRAFFIC CONTROL DEVICES AND SECTION 112 OF KTC STANDARD SPECIFICATIONS. THE CONTRACTOR SHALL MAINTAIN ACCESS TO LOCAL TRAFFIC (ACCESS TO RESIDENCES WITHIN CONSTRUCTION LIMITS) AT ALL TIMES. THE CONTRACTOR SHALL PROVIDE SUFFICIENT SIGN, WARNING LIGHTS, BARRICADES, OR OTHER NECESSARY DEVICES MAKE THE SITE SAFE TO THE TRAVELING PUBLIC.
- 2. IT SHALL BE THE CONTRACTOR'S RESPONSIBILITY TO SUBMIT TO THE ENGINEER AND THE OWNER A TRAFFIC CONTROL PLAN FOR THIS PROJECT.
- 3. PRIOR TO ANY CONSTRUCTION, THE CONTRACTOR SHALL NOTIFY THE CITY OF SOUTHGATE AND THE SOUTHGATE POLICE DEPARTMENT. AT ALL TIMES, EMERGENCY VEHICLES SHALL BE GIVEN ACCESS.
- 4. RESIDENTS OF THE PROJECT AREA SHALL BE ALLOWED ACCESS TO THEIR PROPERTY AT ALL TIMES.
- 5. ALTERNATE ROUTES OR CONTINUOUS TRAFFIC CONTROL SHALL BE EMPLOYED WHEN A PUBLIC WAY IS TEMPORARLY BLOCKED DURING CONSTRUCTION, INCLUDING PEDESTRIAN AND BICYCLE FACILITIES. ADVANCED NOTICE SIGNS IN ACCORDANCE WITH THE MUTCD SHALL BE EMPLOYED.

**GRADING AND EROSION CONTROL NOTES**

- 1. ALL DISTURBED AREAS ARE TO BE RESTORED (SEEDED AND MULCHED) BY THE CONTRACTOR AND SHALL PROCEED WITH JOB PROGRESSION. THE CONTRACTOR SHALL ALSO BE RESPONSIBLE FOR REMOVING ANY EXCESS MATERIALS AT THE SITE AND MAINTAINING ALL SEEDED AND MULCHED AREAS UNTIL PROJECT COMPLETION AND FINAL INSPECTION PER KDOT SPEC. 212. ALL DISTURBED AREAS SHALL BE RESTORED WITHIN TWENTY-ONE (21) DAYS AFTER CONSTRUCTION.
- 2. ALL APPLICABLE RECOMMENDATIONS IN KENTUCKY'S BEST MANAGEMENT PRACTICES MANUAL SHALL BE FOLLOWED BY THE CONTRACTOR, INCLUDING SEEDING OF DISTURBED GROUND.
- 3. ADDITIONAL BMP'S AND EROSION AND SEDIMENT CONTROL MEASURES MAY BE INCLUDED IN LUMP SUM BID FOR EROSION CONTROL AND WATER POLLUTION CONTROL.
- 4. ALL EXCAVATION IS CONSIDERED UNCLASSIFIED AND THE CONTRACTOR SHALL BE RESPONSIBLE FOR MEANS, METHODS AND MATERIALS OF CONSTRUCTION. THE DESIGN ENGINEER SHALL NOT BE RESPONSIBLE FOR THE SUITABILITY OF MATERIAL UNDERLYING THE PROJECT SITE. THE CONTRACTOR SHALL PERFORM ANY INVESTIGATIONS OR TESTING NECESSARY TO ADEQUATELY DETERMINE OR ESTIMATE TO THEIR SATISFACTION ANY EXISTING SITE CONDITION WHICH COULD AFFECT HIS BID OR THE PERFORMANCE OF THE PROPOSED IMPROVEMENTS. THIS COULD INCLUDE, BUT NOT BE LIMITED TO, UNSUITABLE OR UNSTABLE SOIL/SUBSURFACE CONDITIONS, ROCK, WATER (PERCHED OR FREE), OBSTRUCTIONS ETC.
- 5. ALL TREES AND OTHER VEGETATION WITHIN THE PROJECT LIMITS THAT INTERFERE WITH CONSTRUCTION SHALL BE REMOVED, INCLUDED STUMP REMOVAL.
- 6. THE CONTRACTOR SHALL REMOVE ALL SURPLUS DEMOLISHED AND WASTE MATERIALS, INCLUDING TREES, STUMPS, TRASH AND DEBRIS, FROM THE PROJECT LIMITS AND DISPOSE OF OFF-SITE. IN NO INSTANCE SHALL MATERIAL BE BURIED ON-SITE.
- 7. THE CONTRACTOR SHALL REMOVE FROM THE SITE ALL MATERIAL DEEMED UNSUITABLE FOR EMBANKMENT BY THE OWNER'S REPRESENTATIVE AND BE DISPOSED OF OFF-SITE.
- 8. THE CONTRACTOR SHALL PROVIDE FINAL GRADING TO WITHIN 1" OF GRADES SHOWN ON THE PLANS.
- 9. TOPSOIL SHALL BE STRIPPED AND SOCKPILED FROM ALL AREAS TO BE GRADED, TO WHATEVER DEPTH ENCOUNTERED, AND IN A MANNER TO PREVENT INTERMINGLING WITH UNDERLYING SUBSOIL. SOILD SHALL NOT BE STOCKPILED NEAR THE EDGE OF EXCAVATIONS OR WITHIN DRIP LINES OF TREES TO REMAIN.
- 10. EXCESS SOIL GENERATED FROM TRENCH EXCAVATIONS SHALL BE INCORPORATED IN THE UNIT PRICE BID FOR EXCAVATION INCLUDING EMBANKMENT CONSTRUCTION. ANY EXCESS SOIL UNABLE TO BE PLACED ON-SITE OR DEEMED UNSUITABLE FOR EMBANKMENT BY THE ENGINEER SHALL BE DISPOSED OF OFF-SITE.
- 11. THE CONTRACTOR SHALL FOLLOW THE RECOMMENDATIONS IN THE SUBSURFACE EXPLORATION AND GEOTECHNICAL ENGINEERING REPORT FOR EXCAVATION AND EMBANKMENT TO CONSTRUCT THE IMPROVEMENTS AND ACHIEVE THE FINISHED GRADES SHOWN ON THE PLANS.
- 12. NO SLAG, RIVER GRAVEL, RECYCLED PORTLAND CEMENT CONCRETE, RECLAIMED ASPHALT CONCRETE PAVEMENT OR RECLAIMED BITUMINOUS AGGREGATE BASE SHALL BE USED AS FILL.
- 13. EXPOSED PAVEMENT SUBGRADE AREAS SHALL BE MAINTAINED IN CONDITIONS TO PREVENT PONDING OF WATER AFTER RAINS.
- 14. ALL EXISTING AND PROPOSED MANHOLE COVERS, VALVE BOXES, ETC. LOCATED WITHIN PEDESTRIAN ACCESS SHALL BE FLUSH MOUNTED WITH THE WALKING SURFACE.
- 15. SLOPE ALL PAVING AND LANDSCAPE AREAS AWAY FROM THE BUILDING AT A MINIMUM OF 1%
- 16. THE ENGINEER MAKES NO REPRESENTATION AS TO A BALANCED EARTHWORK SITE. THE CONTRACTOR SHALL BE RESPONSIBLE FOR PROVIDING THE FINAL SITE GRADES AS INDICATED ON THE GRADING PLAN, INCLUDING THE IMPORT OR EXPORT OF MATERIAL IF REQUIRED TO ACHIEVE THE PROPOSED GRADES. ADDITIONALLY, THE CONTRACTOR SHALL BE RESPONSIBLE FOR THE PROPER REMOVAL AND DISPOSAL OF ALL SURPLUS EARTHWORK, DEBRIS OR WASTE FROM THE SITE. ALL COST FOR THE ABOVE SHALL BE INCLUDED IN THE CONTRACTORS BID PRICE FOR EXCAVATION AND/OR EMBANKMENT.
- 17. THE CONTRACTOR SHALL PROTECT STRUCTURES, UTILITIES, SIDEWALKS, PAVEMENTS AND OTHER FACILITIES TO REMAIN FROM DAMAGE CAUSED BY EARTHWORK OPERATIONS.
- 18. MAINTENANCE OF ALL TEMPORARY AND PERMANENT EROSION AND SEDIMENT CONTROL FACILITIES IS THE RESPONSIBILITY OF THE CONTRACTOR(S)
- 19. CONTRACTOR SHALL PROVIDE WRITTEN DOCUMENTATION OF REPAIR AND/OR REPLACEMENT OF BMP'S

**EROSION CONTROL LEGEND**

- IP INLET PROTECTION (SEE DETAIL)
- CD CHECK DAM
- CE CONSTRUCTION ENTRANCE
- WA CONCRETE WASHOUT
- RCP ROCK CHANNEL PROTECTION

**HATCH LEGEND**

- SF PROPOSED SILT FENCE

**SYMBOL LEGEND**

EXISTING GAS LINE, EXISTING GAS SERVICE, EXISTING ELECTRIC (UNDERGROUND / OVERHEAD), EXISTING CABLE (UNDERGROUND / OVERHEAD), EXISTING TELEPHONE (UNDERGROUND / OVERHEAD), EXISTING WATER MAIN, EXISTING WATER SERVICE, EXISTING STORM SEWER, EXISTING ROOF DRAIN, EXISTING SANITARY SEWER, EXISTING SANITARY FORCE MAIN, EXISTING FIBER OPTICS, EXISTING FENCE, EXISTING CONTOURS (MAJOR), EXISTING CONTOURS (MINOR), EXISTING RIGHT OF WAY, EXISTING PROPERTY LINE, EXISTING EASEMENT, EXISTING GUARDRAIL, EXISTING TREE LINE, PROPOSED GAS LINE, PROPOSED GAS SERVICE, EXISTING ELECTRIC (UNDERGROUND / OVERHEAD), PROPOSED CABLE (UNDERGROUND / OVERHEAD), PROPOSED TELEPHONE (UNDERGROUND / OVERHEAD), PROPOSED WATER MAIN, PROPOSED WATER SERVICE, PROPOSED STORM SEWER, PROPOSED UNDERDRAIN, PROPOSED UNDERDRAIN / DOWNSPOUT COLLECTOR COMBO, PROPOSED SANITARY SEWER, PROPOSED SANITARY FORCE MAIN, PROPOSED FIBER OPTICS, PROPOSED FENCE, PROPOSED CONTOURS (MAJOR), PROPOSED CONTOURS (MINOR), PROPOSED RIGHT OF WAY, PROPOSED PROPERTY LINE, PROPOSED EASEMENT, PROPOSED GUARDRAIL, PROPOSED TREE LINE / CLEARING LIMITS, PROPOSED DISTURBED LIMITS, EXISTING FLAGPOLE, EXISTING MAILBOX, EXISTING SIGN, EXISTING CABLE PEDESTAL, EXISTING ELECTRIC PEDESTAL, EXISTING PULL BOX, EXISTING GROUND LIGHT, EXISTING LIGHT POLE, EXISTING ELECTRIC METER, EXISTING ELECTRIC MANHOLE, EXISTING GAS METER, EXISTING GAS VALVE, EXISTING GAS BOX, EXISTING UTILITY POLE, EXISTING GUY WIRE / ANCHOR, EXISTING SANITARY MANHOLE, EXISTING SANITARY CLEANOUT, EXISTING STORM MANHOLE, EXISTING SINGLE / DOUBLE CURB INLET, EXISTING CATCH BASIN, EXISTING STORM CLEANOUT, EXISTING TELEPHONE MANHOLE, EXISTING TELEPHONE PEDESTAL, EXISTING FIRE HYDRANT, EXISTING WATER METER, EXISTING WATER VALVE, EXISTING BUSHES / TREES, EXISTING SURVEY BENCHMARK, TEST BORING LOCATION, PROPOSED FLAGPOLE, PROPOSED MAILBOX, PROPOSED SIGN, PROPOSED CABLE PEDESTAL, PROPOSED ELECTRIC PEDESTAL, PROPOSED PULL BOX, PROPOSED GROUND LIGHT, PROPOSED LIGHT POLE, PROPOSED ELECTRIC METER, PROPOSED ELECTRIC MANHOLE, PROPOSED GAS METER, PROPOSED GAS VALVE, PROPOSED GAS BOX, PROPOSED UTILITY POLE, PROPOSED GUY WIRE / ANCHOR, PROPOSED SANITARY MANHOLE, PROPOSED SANITARY CLEANOUT, PROPOSED STORM MANHOLE, PROPOSED SINGLE / DOUBLE CURB INLET, PROPOSED CATCH BASIN, PROPOSED STORM CLEANOUT, PROPOSED TELEPHONE MANHOLE, PROPOSED TELEPHONE PEDESTAL, PROPOSED FIRE HYDRANT, PROPOSED WATER METER, PROPOSED WATER VALVE, REMOVE EXISTING BUSH / TREE, PROPOSED SLOPE DIRECTION

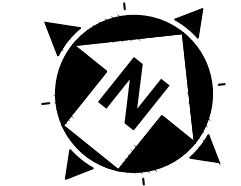
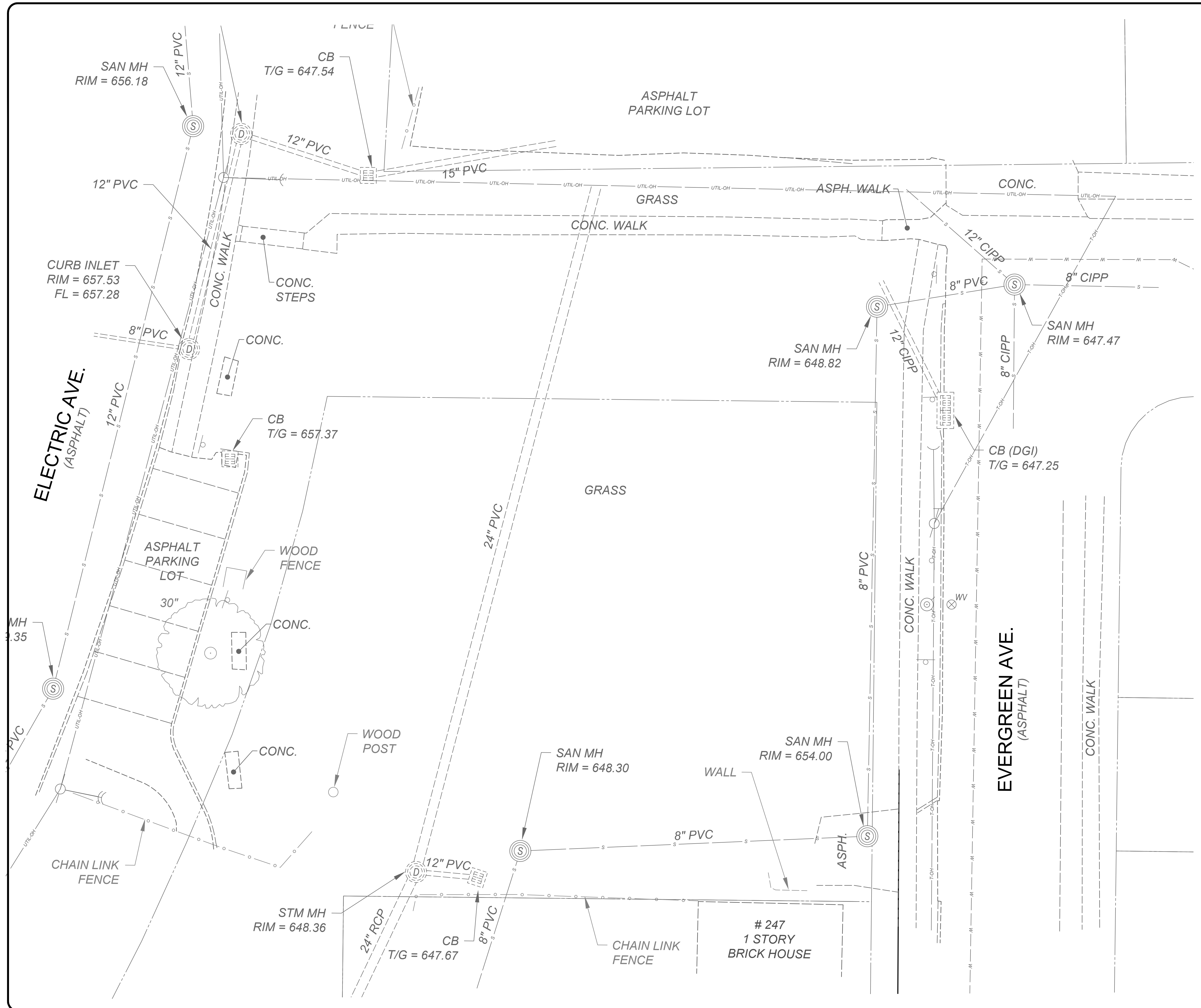

Table with columns: DATE, REVISION, NO, BID, 4/16/2026, AS NOTED, DGAR, DGAR, JSU

ISSUED FOR: OPTIMIST PARK, CITY OF SOUTHGATE, CAMPBELL COUNTY, KENTUCKY

Table with columns: PROJECT NO. (45436), DISCIPLINE (CIVIL), SHEET NAME (C2), SHEET (2) OF (6)

NOTES AND LEGEND SHEET



NORTH AND BEARING SYSTEM  
 BASED ON NAD83 (2011)  
 KENTUCKY STATE PLANE,  
 NORTH ZONE, US FOOT.

0' 10' 20'

22"x34" SCALE: 1" = 10'  
 11"x17" SCALE: 1" = 20'



ISSUED FOR:	BID NO	REVISION	DATE
ISSUE DATE:	4/16/2026		
SCALE:	AS NOTED		
DESIGNED BY:	DGAR		
DRAWN BY:	DGAR		
CHECKED BY:	JSHU		

**OPTIMIST PARK**  
 CITY OF SOUTHGATE  
 CAMPBELL COUNTY, KENTUCKY

**EXISTING CONDITIONS SHEET**

PROJECT NO.	45436
DISCIPLINE	CIVIL
SHEET NAME	C3
SHEET	3
OF	6

Z:\PROJECT FILES\2026\OUTGATE\45436 - SOUTHGATE OPTIMIST PARK\CDWG\BASE\K636 - C-BASE\4-26.DWG - CS EX COND - 4/13/2026 3:38:53 PM - DAVE GARRETT

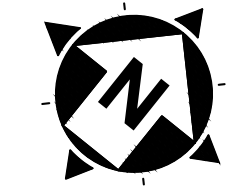

NORTH AND BEARING SYSTEM  
BASED ON NAD83 (2011)  
KENTUCKY STATE PLANE,  
NORTH ZONE, US FOOT.

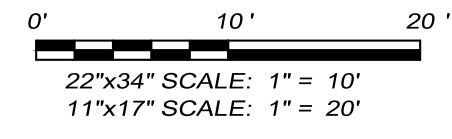

**GENERAL CONSTRUCTION NOTES**

- 1 CONSTRUCT INTEGRAL CURB AND CONCRETE SIDEWALK. SEE DETAIL SHEET.
- 2 SAW-CUT EXISTING PAVEMENT TO CREATE A CLEAN JOINT TO CONSTRUCT PROPOSED PAVEMENT.
- 3 NOT USED
- 4 NOT USED
- 5 INSTALL 2' TALL STONE WALL WITH FLAG POLE, AT CENTER.
- 6 LANDSCAPE ISLANDS. SEE LANDSCAPE PLAN FOR LOCATIONS AND DETAILS.
- 7 CONNECT TO EXISTING CONCRETE CURB AND/OR SIDEWALK.
- 8 PROPOSED SWINGING BENCH (BY CITY)
- 9 INSTALL PROPOSED BENCHES. COORDINATE WITH LANDSCAPE PLAN FOR TYPE AND DETAILS. (BY CITY)
- 10 INSTALL PROPOSED PARK AND DONOR SIGN (BY CITY)
- 11 NOT USED
- 12 PROPOSED DOG WASTE STATION (BY CITY)
- 13 TRASH RECEPTACLE (BY CITY)
- 14 CEDAR FENCE, WHITE SOLID FENCE (BY CITY)

**STORM SEWER CONSTRUCTION NOTES**

- (D) NA

**SANITARY SEWER CONSTRUCTION NOTES**

- (S) NA

**WATER CONSTRUCTION NOTES**

- (W) PROPOSED 2" WATER SERVICE FROM METER PIT TO EXISTING WATER MAIN AT STREET. METER PIT AND CONNECTION TO EX. WATER MAIN INSTALLED BY CITY OF SOUTHGATE WATER DEPARTMENT. COORDINATE WITH DEPARTMENT FOR ACTUAL LOCATIONS AND DETAILS. INSTALL PER LOCAL WATER REQUIREMENTS
- (W2) PROPOSED WATER FOUNTAIN
- (W3) PROPOSED WATER SPIGOT WITH DOG WATERING WITH TIMER.

**ELECTRIC CONSTRUCTION NOTES**

- (E) INSTALL 2" PVC CONDUITS FOR ELECTRIC POWER SERVICE.
- (E2) CONNECT ELECTRIC SERVICE TO EXISTING POWER POLE. COORDINATE WITH UTILITY OWNER FOR ADDITIONAL DETAILS.

**HATCH LEGEND**

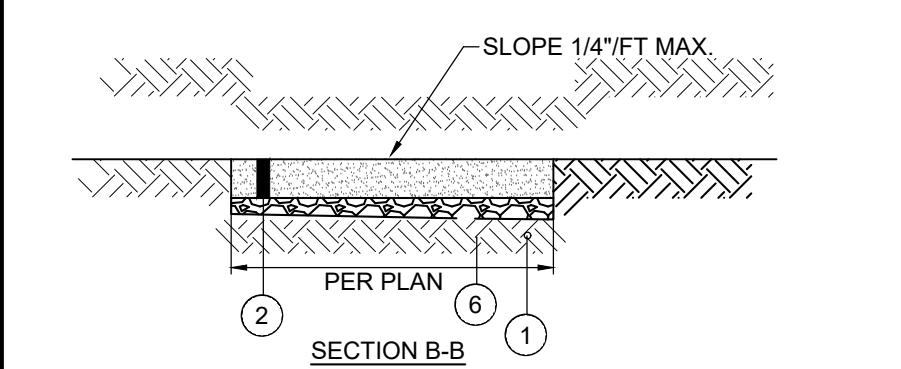
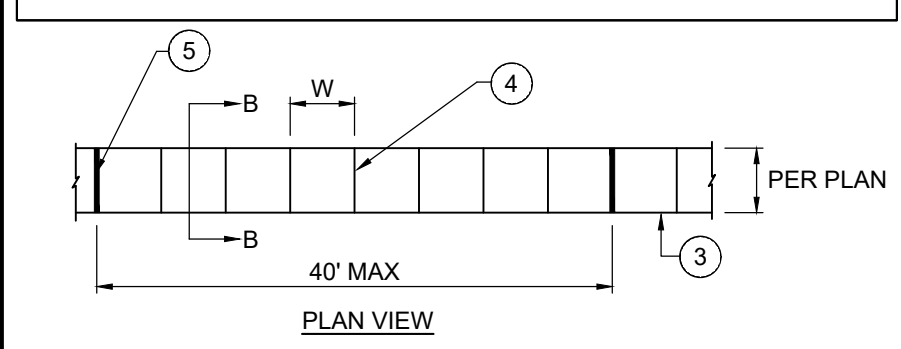
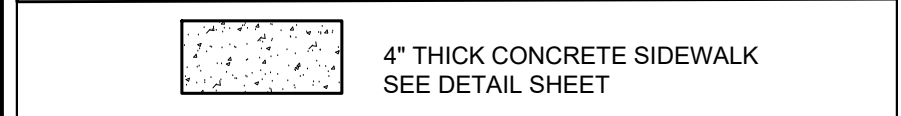

- 1 ITEM 207 - COMPACTED SUBGRADE (INCIDENTAL TO CONCRETE SIDEWALK)
- 2 ITEM SPL - 4" CONCRETE SIDEWALK PER KENTON COUNTY SUBDIVISION REGULATIONS
- 3 TOOLED EDGE
- 4 TOOLED CONTRACTION JOINT
- 5 2" PREMOLDED EXPANSION JOINT
- 6 ITEM 304 4" AGGREGATE BASE

**CONCRETE SIDEWALK DETAIL**



DATE	REVISION	NO	BID	ISSUED FOR:
			4/16/2026	
			AS NOTED	
			DGAR	
			DGAR	
			JSHU	

**OPTIMIST PARK**  
CITY OF SOUTHGATE  
CAMPBELL COUNTY, KENTUCKY

PROJECT NO.	45436
DISCIPLINE	CIVIL
SHEET NAME	C4
SHEET	4
OF	6

**SITE AND UTILITY SHEET**

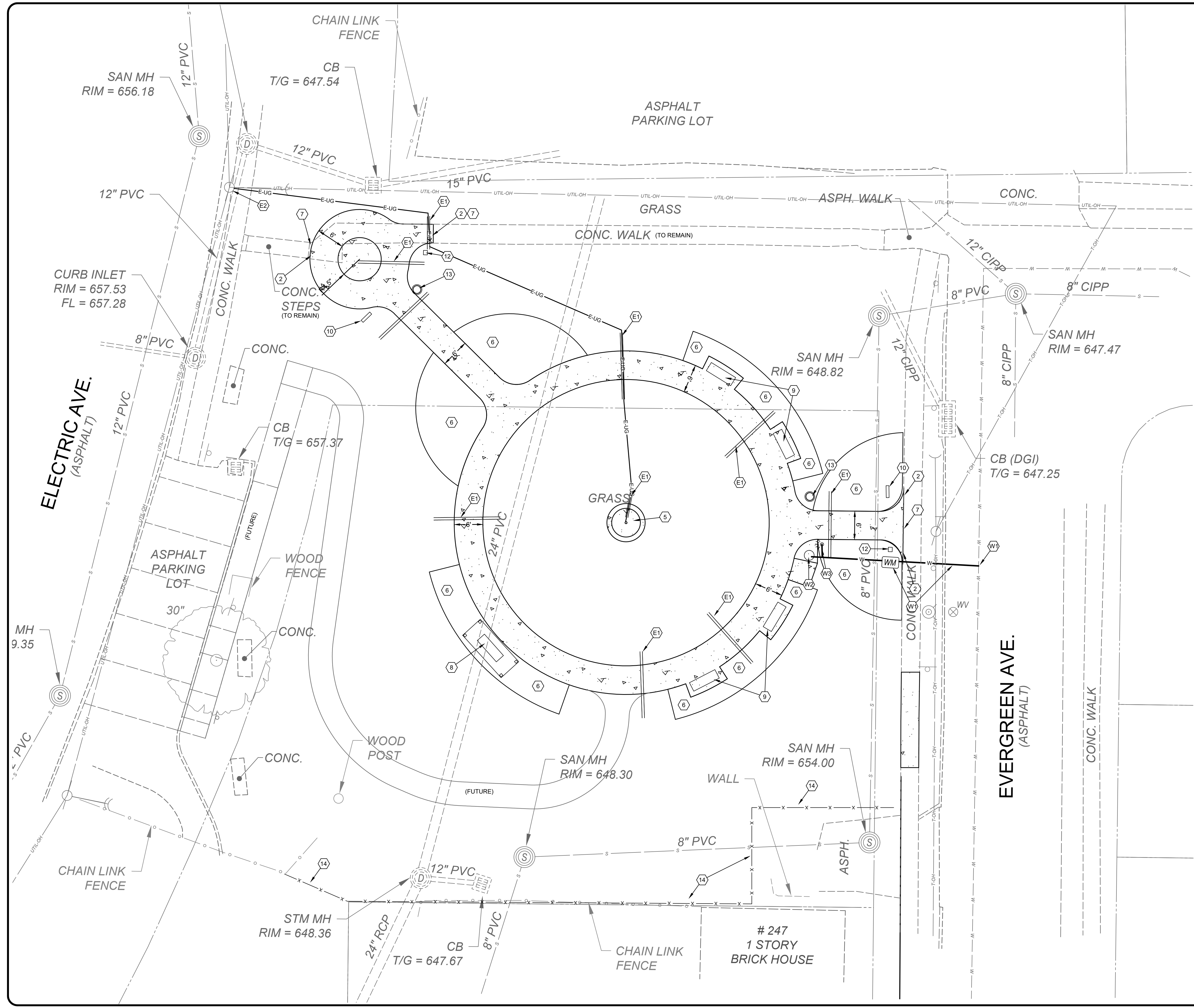

Z:\PROJECT FILES\2026\OUTGATE\45436 - SOUTHGATE OPTIMIST PARK\CADD\DWG\BASE\45436 - C-BASE-4-26.DWG - C4.LAY & UTIL - 4/13/2026 3:38:53 PM - DAVE GARNETT

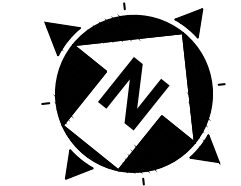
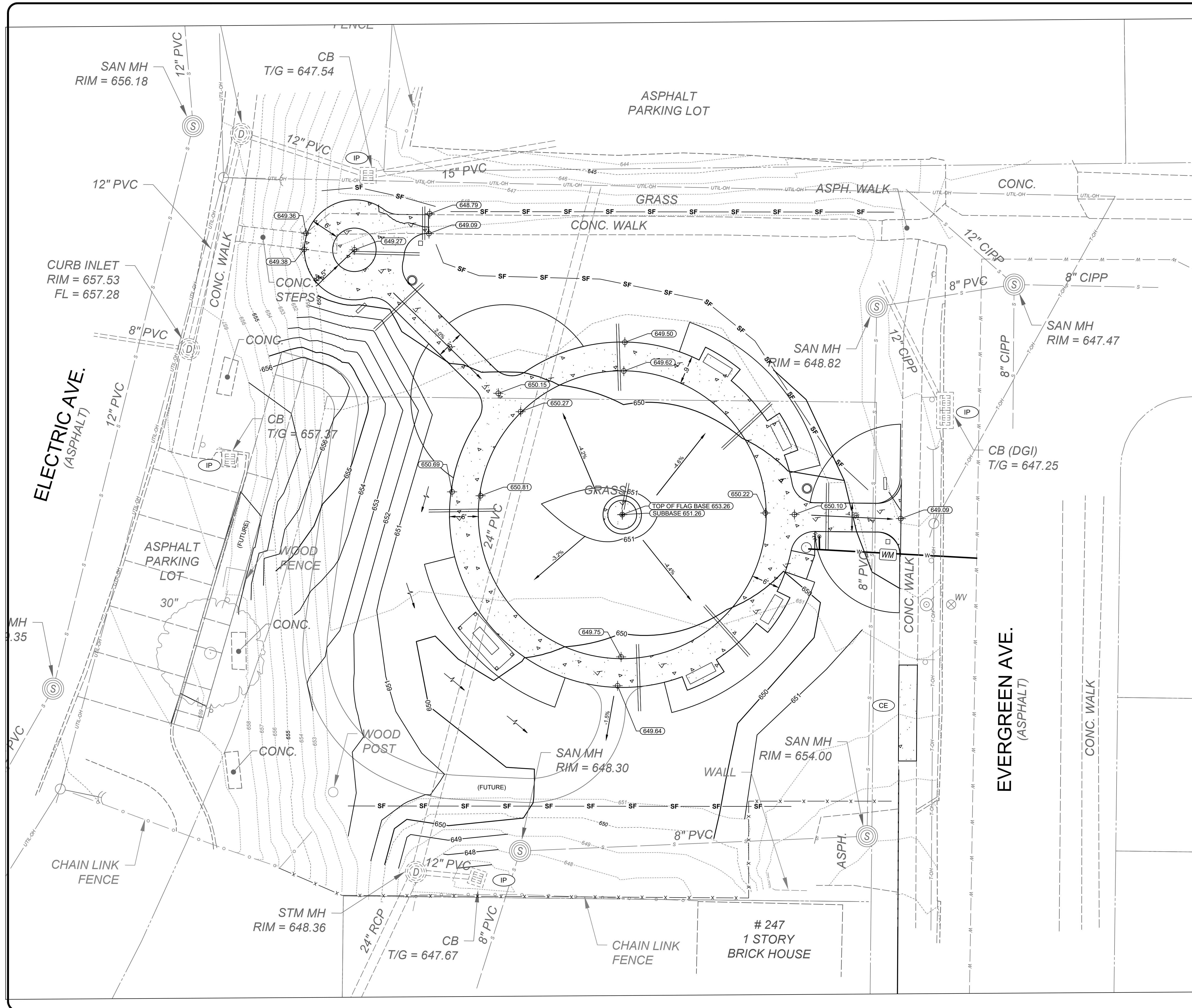

NORTH AND BEARING SYSTEM  
 BASED ON NAD83 (2011)  
 KENTUCKY STATE PLANE,  
 NORTH ZONE, US FOOT.

0' 10' 20'  
 22"x34" SCALE: 1" = 10'  
 11"x17" SCALE: 1" = 20'

**verdantas**

ISSUED FOR:	BID NO	DATE
4/16/2026		
ISSUE DATE:	NO	REVISION
AS NOTED		
SCALE:	DGAR	DGAR
DESIGNED BY:	DGAR	JSHU
DRAWN BY:	DGAR	JSHU
CHECKED BY:	DGAR	JSHU

**OPTIMIST PARK**  
 CITY OF SOUTHGATE  
 CAMPBELL COUNTY, KENTUCKY

**GRADING AND EROSION CONTROL SHEET**

PROJECT NO.	45436
DISCIPLINE	CIVIL
SHEET NAME	C5
SHEET	5
OF	6

- EROSION CONTROL LEGEND**
- IP INLET PROTECTION (SEE DETAIL)
  - SF PROPOSED SILT FENCE
  - CE CONSTRUCTION ENTRANCE
- GRADING LEGEND**
- EXISTING SPOT ELEVATION (EX 232.46)
  - PROPOSED SPOT ELEVATION (232.60)
  - PROPOSED SPOT ELEVATION AT TOP/BACK OF CURB (TC 232.60)
  - PROPOSED SPOT ELEVATION AT FACE/BOTTOM OF CURB (FC 232.60)
  - PROPOSED SPOT ELEVATION AT TOP/BACK OF WALL (TW 232.60)
  - PROPOSED SPOT ELEVATION AT FACE/BOTTOM OF WALL (FW 232.60)
  - PROPOSED GRADE LABEL 10.8%

Z:\PROJECT FILES\2026\OUTGATE\45436 - SOUTHGATE OPTIMIST PARK\CADD\DWG\BASE\6436 - C-BASE-4-26.DWG - CS GRADING - 4/13/2026 3:53 PM - DAVE GARRETT

**STORM WATER POLLUTION PREVENTION NOTES**

- SANITATION DISTRICT NO. 1 IS TO BE CONTACTED 72 HOURS PRIOR TO ANY CONSTRUCTION ACTIVITY AT 859-578-6892
- ALL EROSION AND SEDIMENTATION CONTROL SHALL BE PERFORMED AS SHOWN ON THE PLANS, AND SHALL BE IN COMPLIANCE WITH THE LATEST CONSTRUCTION ACTIVITY - NATIONAL POLLUTANT DISCHARGE ELIMINATION SYSTEM" RULES AND REGULATIONS AND SECTION 02370 OF SD1 SPECIFICATIONS.
- A COPY OF THE STORM WATER POLLUTION PREVENTION PLAN (SWPPP) AND A COPY OF THE "NOTICE OF INTENT (NOI) SHALL BE KEPT ON SITE.
- AN AMENDMENT OF THE SWPPP IS REQUIRED WHENEVER A CHANGE IN DESIGN, CONSTRUCTION, AND OPERATION OR MAINTENANCE HAS A SIGNIFICANT EFFECT ON THE POTENTIAL FOR THE DISCHARGE OF POLLUTANTS, OR IF THE SWPPP PROVES TO BE INEFFECTIVE IN ACHIEVING THE GENERAL OBJECTIVES OF THE SWPPP.
- THE CONTRACTOR SHALL ALSO MAINTAIN THE FOLLOWING RECORDS ON SITE:
  - GENERAL CONTRACTOR AND/OR SUBCONTRACTOR SWPPP CERTIFICATIONS
  - THE DATE, TIME, AND EXACT LOCATION OF THE INSPECTION, AND THE NAME OF THE INSPECTOR
  - AN ASSESSMENT OF THE CONDITION OF THE EROSION CONTROLS
  - A DESCRIPTION OF ANY EROSION CONTROL IMPLEMENTATION AND MAINTENANCE PERFORMED
  - A DESCRIPTION OF THE PRESENT PHASE OF CONSTRUCTION AT THE SITE
- CONSTRUCTION SEQUENCE
  - ALL PERIMETER SILT FENCE, INLET PROTECTION AND OTHER EROSION CONTROLS SHALL BE IN PLACE BEFORE ANY OTHER EARTH MOVING ACTIVITIES BEGIN.
  - THE CONTRACTOR SHALL CLEAR AND GRUB ONLY THE AREAS PLANNED FOR EARTH MOVING.
  - REMOVE TOPSOIL, STOCKPILE IT, AND INSTALL SILT FENCE AROUND PERIMETER
  - SEED SOIL STOCKPILE WITH PERENNIAL RYE GRASS AND MULCH WITH STRAW IF NO TO BE DISTURBED FOR MORE THAN 21 DAYS.
  - INSTALL STORM SEWER SYSTEM AND SURFACE STORM INLET AND MANHOLE PROTECTION WHERE REQUIRED.
  - ESTABLISH A TEMPORARY SEEDING ON ALL BARE AREAS THAT ARE TO REMAIN UNDISTURBED FOR MORE THAN 21 DAYS. SEED WITH PERENNIAL RYE GRASS MULCH WITH STRAW.
  - IMMEDIATE AFTER TOPSOIL HAS BEEN PLACED, STABILIZE THE SAME SURFACE AREA WITH FINAL SEED AND MULCH 7 DAYS AFTER REACHING FINAL GRADE.
  - AFTER THE VEGETATION HAS BECOME WELL ESTABLISHED, REMOVE TEMPORARY EROSION OR SEDIMENT CONTROL PRACTICES.
- EROSION CONTROLS MUST BE INSPECTED ONCE EVERY 7 DAYS AND WITHIN 24 HOURS OF 0.5" OR GREATER RAINFALL. REMOVE ACCUMULATED SEDIMENT FROM EROSION CONTROLS.
- TEMPORARY SEEDING SHALL BE PERENNIAL RYE GRASS (40 LB / ACRED) AND MULCH AT 3 BALES OF STRAW PER 1000 S.F.
- CONTRACTOR IS RESPONSIBLE FOR OBTAINING BORROW MATERIAL ONSITE AND / OR DISPOSING OF EXCESS MATERIAL OFF SITE AS REQUIRED TO MEET INDICATED DESIGN ELEVATIONS.
- DEBRIS SHALL BE COLLECTED WITHIN PROPERTY LIMITS WEEKLY OR AS NEEDED FOR PUBLIC SAFETY. SURROUNDING STREETS AFFECTED BY THE CONSTRUCTION SHALL BE CLEANED DAILY OR AS NEEDED FOR PUBLIC SAFETY. SEE CONSTRUCTION ENTRANCE DETAIL, IN SWPPP DETAILS SHEET.
- THE CONSTRUCTION OF BMPs SHALL BE REVISED OR ADDED IF DEEMED NECESSARY PER SECTION 1000 OF THE SANITATION DISTRICT 1 REGULATIONS.
- CONTACT SANITATION DISTRICT NO. 1 72 HOURS PRIOR TO INSTALLATION OF THE WATER QUALITY FEATURE.

**NOTES:**

- SUBSOILING SHALL OCCUR WHEN SOIL MOISTURE IS LOW ENOUGH TO ALLOW THE SOIL TO CRACK OR FRACTURE. SUBSOILING IS NOT PERMITTED ON SLIP-PRONE AREAS.
- THE SITE SHALL BE GRADED TO PERMIT THE USE OF CONVENTIONAL EQUIPMENT FOR SEEDBED PREPARATION AND SEEDING.
- TOPSOIL SHALL BE APPLIED WHERE NEEDED TO ESTABLISH VEGETATION.
- THE SEEDBED SHALL BE PREPARED BY APPLYING AGRICULTURAL GROUND LIMESTONE OR FERTILIZER AS RECOMMENDED BY A SOIL TEST. IN LIEU OF A SOIL TEST, APPLY LIME AT 2 TONS/AC, OR FERTILIZER AT 500 LB/AC. OF 10-10-10 OR 12-12-12 ANALYSIS. LIME AND FERTILIZER SHALL BE WORKED INTO THE SOIL TO A DEPTH OF 3".
- APPLY SEED UNIFORMLY ON FIRM, MOIST SEED BED.
- SEEDING SHOULD BE APPLIED FROM MARCH 1 TO MAY 31 OR AUGUST 1 TO SEPTEMBER 30. IF SEEDING OCCURS OUTSIDE OF THESE DATES, ADDITIONAL MULCH AND IRRIGATION MAY BE REQUIRED TO ENSURE A MINIMUM OF 80% GERMINATION. TILLAGE FOR SEEDBED PREPARATION SHALL OCCUR WHEN THE SOIL IS DRY ENOUGH TO CRUMBLE AND NOT FORM RIBBONS WHEN COMPRESSED BY HAND.
  - FROM OCTOBER 1 TO NOVEMBER 20, INCREASE THE SEEDING RATE BY 50%. PREPARE THE SEED BED, ADD LIME AND FERTILIZER, MULCH AND ANCHOR.
  - FROM NOVEMBER 20 TO MARCH 15, ONLY IF SOIL CONDITIONS PERMIT, INCREASE THE SEEDING RATE BY 50%. PREPARE THE SEED BED, ADD LIME AND FERTILIZER, APPLY THE SEED MIXTURE, MULCH AND ANCHOR.
- APPLY MULCH MATERIAL IMMEDIATELY AFTER SEEDING.
- PERMANENT SEEDING SHALL INCLUDE IRRIGATION TO ESTABLISH VEGETATION DURING DRY OR HOT WEATHER OR ON ADVERSE SITE CONDITIONS AS NEEDED. AVOID EXCESSIVE IRRIGATION AND MONITOR TO PREVENT EROSION AND DAMAGE FROM RUNOFF.
- PERMANENT SEEDING SHALL NOT BE CONSIDERED ESTABLISHED FOR AT LEAST 1 FULL YEAR FROM THE TIME OF PLANTING. DURING THIS PERIOD, INSPECT FOR SOIL EROSION OR PLANT LOSS AND REPAIR BARE OR SPARSE AREAS. FILL GULLIES, RE-FERTILIZE, RE-SEED OR RE-MULCH AS NEEDED.
- A MINIMUM OF 70% GROWTH DENSITY, BASED ON A VISUAL INSPECTION, MUST EXIST FOR AN ADEQUATE PERMANENT VEGETATIVE PLANTING.
- ALL SEEDING MIX, FERTILIZER AND MULCH SHALL CONFORM TO SECTION 02370 OF THE SANITATION DISTRICT NO. 1 SPECIFICATIONS.

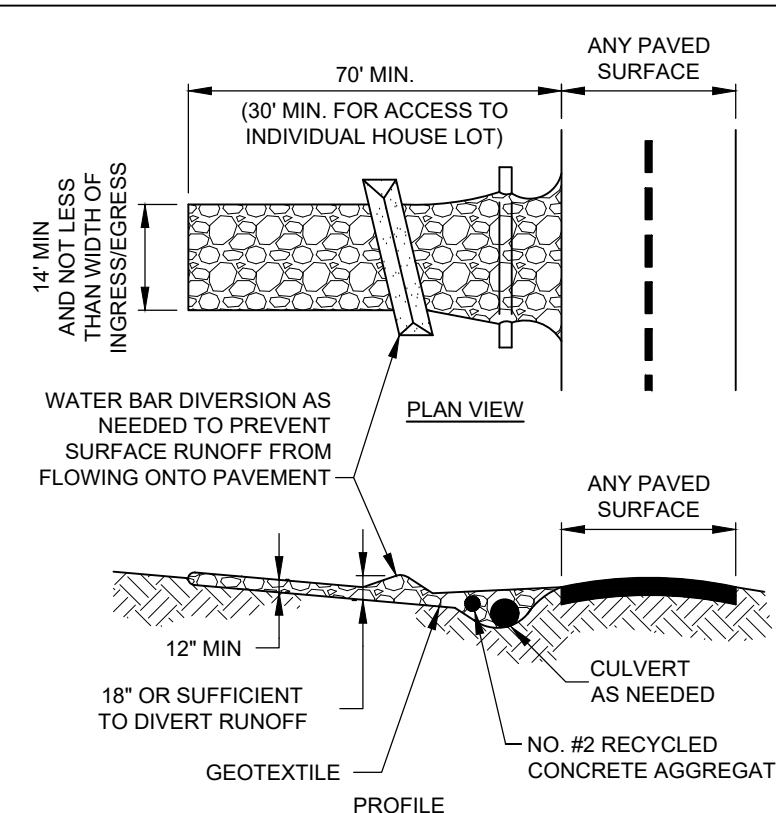

**NOTES:**

- PLACE GEOTEXTILE OVER THE ENTIRE AREA PRIOR TO PLACING STONE MEETING THE MIN. SPECIFICATIONS:
  - TENSILE STRENGTH = 200 LBS.
  - PUNCTURE STRENGTH = 80 PSI
  - TEAR STRENGTH = 50 LBS.
  - BURST STRENGTH = 320 PSI
  - ELONGATION = 20%
  - EQUIVALENT OPENING SIZE ≤ 0.6 MM
  - PERMITTIVITY = 0.001 CM/SEC
- APPLY ADDITIONAL STONE AS CONDITIONS DEMAND AND REPLENISH STONE WHEN THE DEPTH IS LESS THAN 6". REMOVE AND REPLACE IF STONES BECOMES MUD-LADEN.
- IMMEDIATELY REMOVE MUD DROPPED, WASHED OR TRACKED ONTO ROADS OR ANY SURFACE WHERE RUNOFF IS NOT CHECKED BY SEDIMENT CONTROLS BY SCRAPING OR SWEEPING.
- CONSTRUCTION ENTRANCES SHALL NOT BE RELIED UPON TO REMOVE MUD FROM VEHICLES OR TO PREVENT OFF-SITE TRACKING. VEHICLES THAT ENTER AND LEAVE THE CONSTRUCTION SITE SHALL BE RESTRICTED FROM MUDDY AREAS.

**CE CONSTRUCTION ENTRANCE**  
SCALE: NONE

**NOTES:**

- THE SEED BED SHALL BE PULVERIZED AND LOOSE TO ENSURE THE SUCCESS OF ESTABLISHING VEGETATION.
- SOIL AMENDMENTS MAY BE REQUIRED TO ESTABLISH ADEQUATE VEGETATION. PERFORM SOIL TESTS ON THE SITE TO PREDICT THE NEED FOR LIME AND FERTILIZER.
- APPLY SEED UNIFORMLY. COVER BROADCASTED SEED BY RAKING OR DRAGGING AND THEN LIGHTLY TAMPING INTO PLACE.
- APPLY MULCHING IMMEDIATELY AFTER SEEDING.
- SEEDING SHALL BE INSPECTED FOR BARE SPOTS AND WASHOUTS, AND RESEEDED AS NECESSARY.

TEMPORARY SEEDING SPECIES SELECTION			
DATES	SPECIES	LB/1,000 SF	LB/AC.
MARCH 1 TO AUGUST 15	OATS	3	128
	TALL FESCUE	1	40
	PERENNIAL RYEGRASS	1	40
AUGUST 16 TO NOVEMBER 1	PERENNIAL RYEGRASS	2	40
	TALL FESCUE	1	40
	RYE	3	112
NOVEMBER 1 TO SPRING	TALL FESCUE	1	40
	PERENNIAL RYEGRASS	1	40
	WHEAT	3	120
	TALL FESCUE	1	40
	PERENNIAL RYEGRASS	1	40
	TALL FESCUE	1	40
ONLY MULCH OR DORMANT SEEDING.			

**TEMPORARY SEEDING DETAIL**  
SCALE: NONE

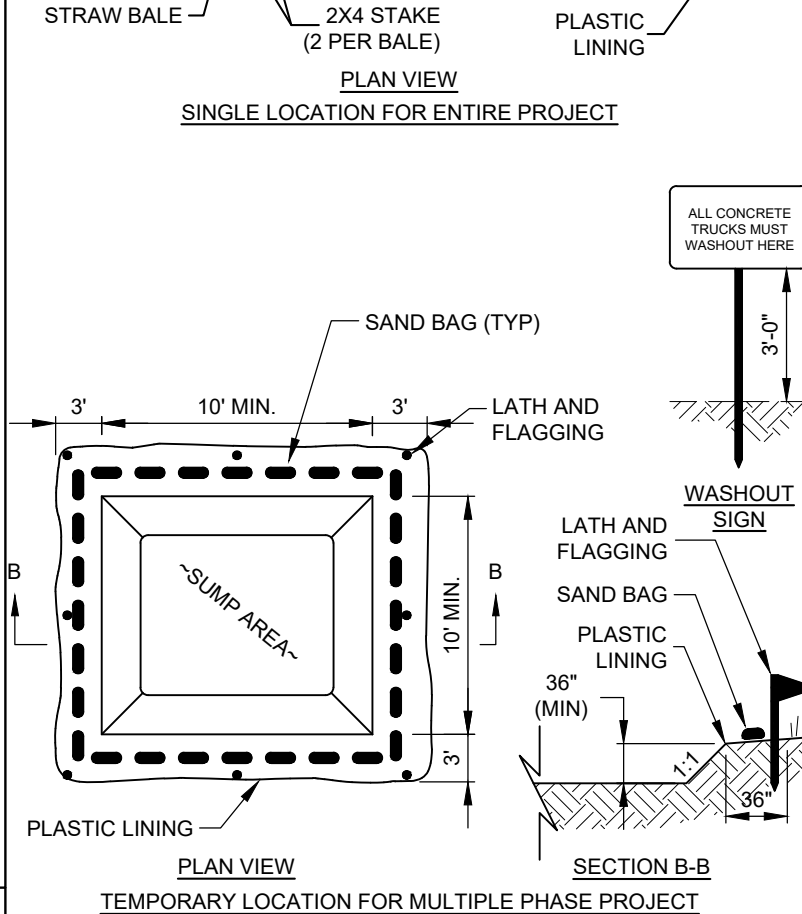
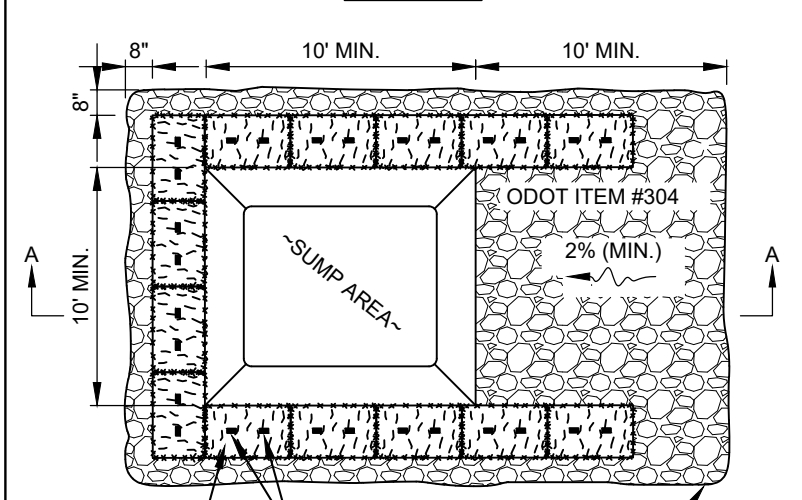
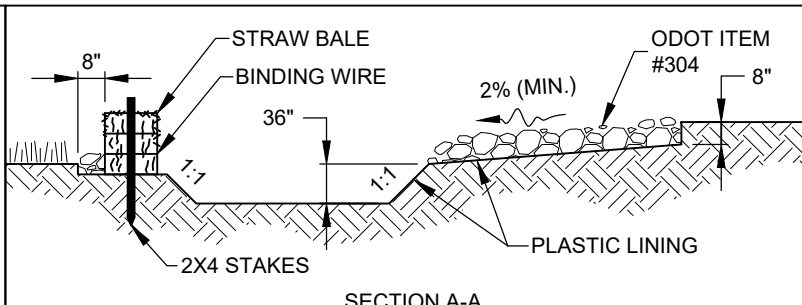

- NOTES:**
- WASHOUT PIT SHALL BE LOCATED 100' MINIMUM FROM INLETS, STREAMS, WETLANDS AND ANY OTHER SURFACE WATERS.
  - ALL EXCESS CONCRETE AND CONCRETE WASHOUT, INCLUDING FROM HAND MIXERS AND LIGHT EQUIPMENT, SHALL BE DISPOSED OF IN THE CONCRETE WASHOUT AREA. DISPOSAL OF EXCESS CONCRETE OR CONCRETE WASHOUT ON THE GROUND, OR IN STORM DRAINS, DITCHES OR WATER BODIES, IS PROHIBITED.
  - CONCRETE WASHOUT AREA SHALL BE SUFFICIENT SIZE TO CONTAIN CONCRETE WASTE GENERATED. FOR LARGER SITES, MULTIPLE CONCRETE WASHOUT AREAS MAY BE REQUIRED.
  - IF CONCRETE WASHOUT AREA IS LOCATED AWAY FROM A PAVED SURFACE, CONSTRUCT A GRAVEL ACCESS ROUTE EQUAL IN COMPOSITION TO THE CONSTRUCTION ENTRANCE.
  - PLASTIC LINING SHALL BE DOUBLE-LINED, CONTINUOUS 10-MIL. POLYETHYLENE SHEETING FREE OF HOLES, TEARS OR OTHER DEFECTS, AND INSTALLED ON A SMOOTH, LEVEL SURFACE, FREE OF ROCKS OR DEBRIS.
  - CONCRETE WASHOUT SIGNAGE SHALL BE CLEARLY VISIBLE AND LOCATED WITHIN 30 FEET OF EACH WASHOUT AREA.
  - CONCRETE WASHOUT AREAS SHALL BE COVERED DURING INCLEMENT WEATHER TO PREVENT OVERFLOWS.
  - PREFABRICATED, PORTABLE AND RE-USABLE CONCRETE WASHOUT CONTAINERS ARE ACCEPTABLE, BUT MUST BE SPECIFICALLY DESIGNED FOR CONCRETE WASHOUT USE.
  - CONCRETE WASHOUT AREA SHALL BE INSPECTED DAILY TO CHECK FOR DAMAGE AND TO DETERMINE IF IT NEEDS CLEANED OR REPLACED. ANY DAMAGE TO THE SIDEWALLS OR POLYETHYLENE SHEETING SHALL BE REPAIRED IMMEDIATELY. THE CONCRETE WASHOUT AREA SHALL BE CLEANED OR REPLACED WHEN IT IS 75% FULL. THE POLYETHYLENE SHEETING SHALL BE REPLACED AFTER EACH CLEANING.
  - SAW CUT CONCRETE, RESIDUE FROM SAW CUT, AND GRINDINGS SHALL BE DISPOSED OF IN THE WASHOUT PIT.

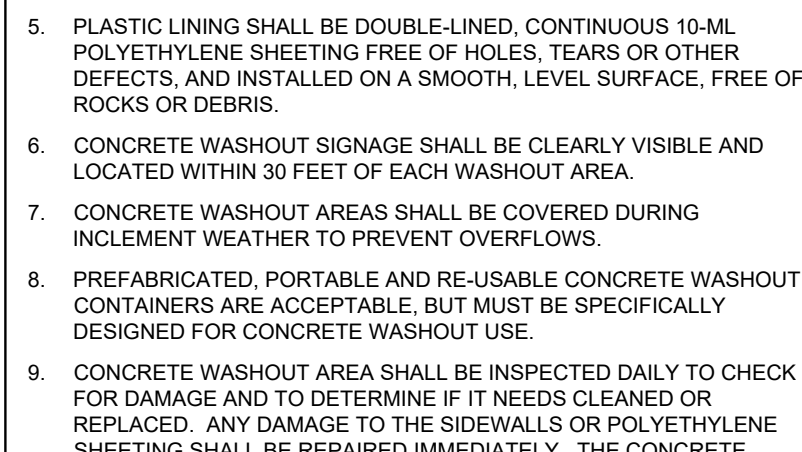

**WA CONCRETE WASHOUT DETAIL**  
SCALE: NONE

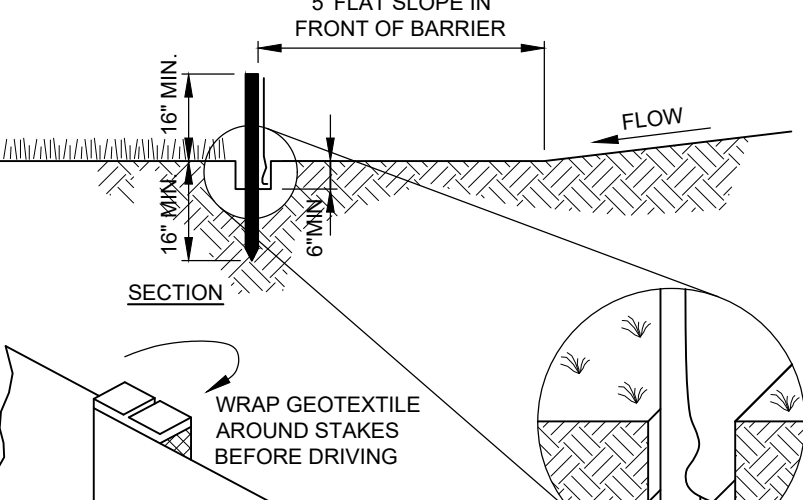
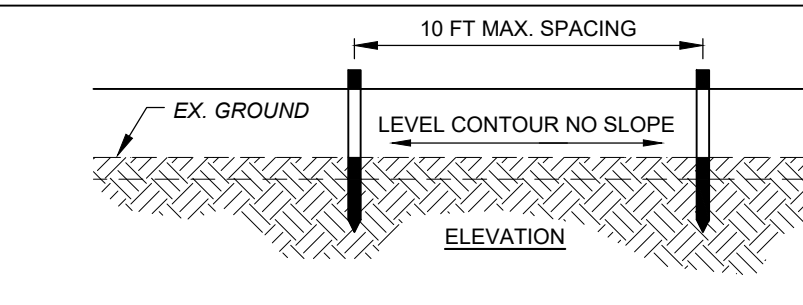

- NOTES:**
- PRESERVE VEGETATION FOR 5 FEET, OR AS MUCH AS POSSIBLE, UPSLOPE FROM THE SILT FENCE. IF VEGETATION IS REMOVED, IT SHALL BE RE-ESTABLISHED WITHIN 7 DAYS FROM SILT FENCE INSTALLATION.
  - SILT FENCE SHALL ALLOW RUNOFF TO PASS ONLY AS DIFFUSE FLOW THROUGH THE GEOTEXTILE. PERFORM ONE OF THE FOLLOWING IF RUNOFF OVERTOPS THE SILT FENCE, FLOWS UNDER OR AROUND THE ENDS, OR IN ANY OTHER WAY BECOMES A CONCENTRATED FLOW:
    - CHANGE THE LAYOUT OF THE SILT FENCE.
    - REMOVE ACCUMULATED SEDIMENT.
    - INSTALL OTHER PRACTICES.

FABRIC PROPERTIES	VALUES	TEST METHOD
GRAB TENSILE STRENGTH	90 LB. MIN	ASTM D-1682
MULLEN BURST STRENGTH	190 PSI MIN	ASTM D-3786
SLURRY FLOW RATE	0.3 GAL./MIN./S.F. MAX.	
EQUIVALENT OPENING SIZE	40-80	US STD. SIEVE CW-02215
ULTRAVIOLET RADIATION STABILITY	90% MIN	ASTM-G-26

**SF SILT FENCE**  
SCALE: NONE

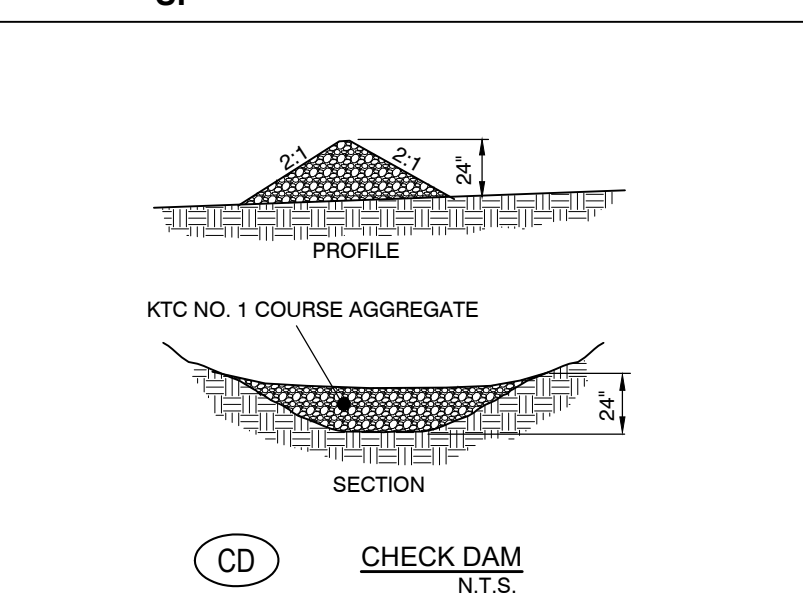

**CD CHECK DAM**  
SCALE: NONE

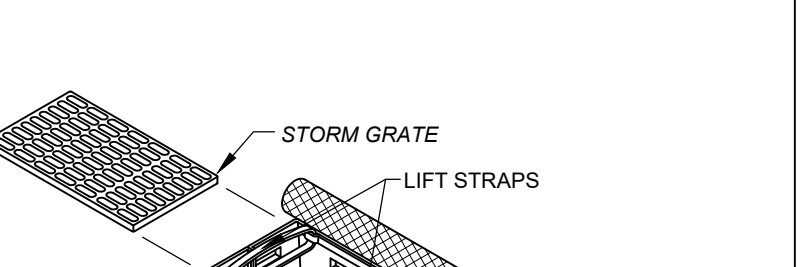
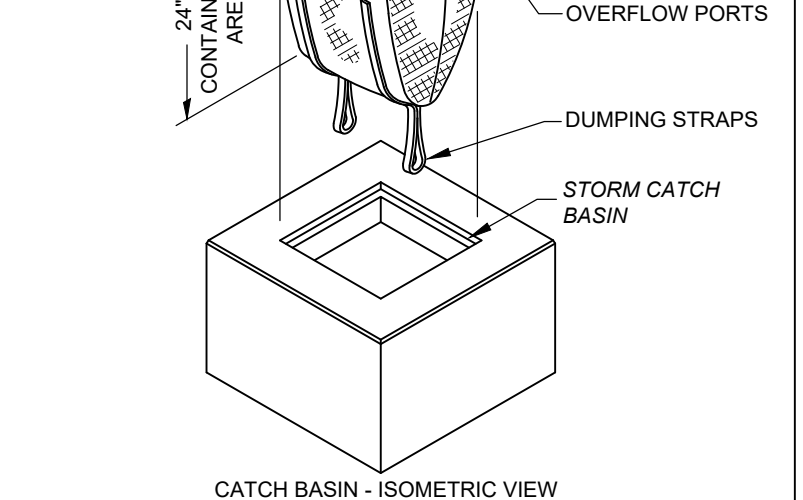
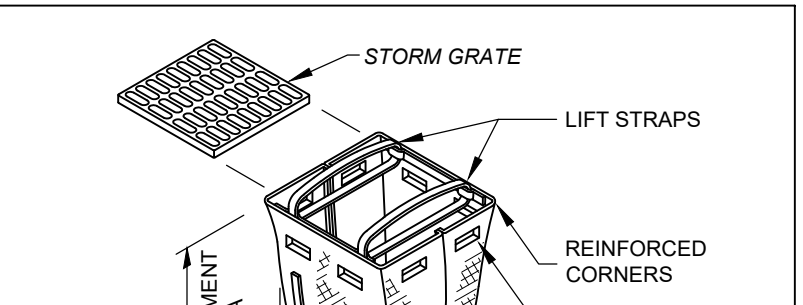

- NOTES:**
- PRESERVE VEGETATION FOR 5 FEET, OR AS MUCH AS POSSIBLE, UPSLOPE FROM THE SILT FENCE. IF VEGETATION IS REMOVED, IT SHALL BE RE-ESTABLISHED WITHIN 7 DAYS FROM SILT FENCE INSTALLATION.
  - SILT FENCE SHALL ALLOW RUNOFF TO PASS ONLY AS DIFFUSE FLOW THROUGH THE GEOTEXTILE. PERFORM ONE OF THE FOLLOWING IF RUNOFF OVERTOPS THE SILT FENCE, FLOWS UNDER OR AROUND THE ENDS, OR IN ANY OTHER WAY BECOMES A CONCENTRATED FLOW:
    - CHANGE THE LAYOUT OF THE SILT FENCE.
    - REMOVE ACCUMULATED SEDIMENT.
    - INSTALL OTHER PRACTICES.

FABRIC PROPERTIES	VALUES	TEST METHOD
GRAB TENSILE STRENGTH	90 LB. MIN	ASTM D-1682
MULLEN BURST STRENGTH	190 PSI MIN	ASTM D-3786
SLURRY FLOW RATE	0.3 GAL./MIN./S.F. MAX.	
EQUIVALENT OPENING SIZE	40-80	US STD. SIEVE CW-02215
ULTRAVIOLET RADIATION STABILITY	90% MIN	ASTM-G-26

**IP STORM DRAIN INLET PROTECTION DETAIL**  
SCALE: NONE

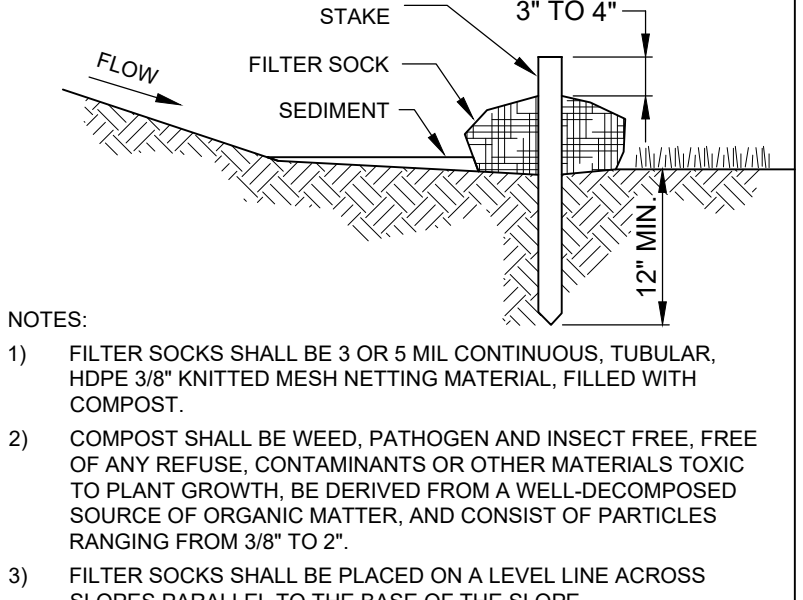

- NOTES:**
- FILTER SOCKS SHALL BE 3 OR 5 MIL CONTINUOUS, TUBULAR, HDPE 3/8" KNITTED MESH NETTING MATERIAL, FILLED WITH COMPOST.
  - COMPOST SHALL BE WEED, PATHOGEN AND INSECT FREE, FREE OF ANY REFUSE, CONTAMINANTS OR OTHER MATERIALS TOXIC TO PLANT GROWTH. BE DERIVED FROM A WELL-DECOMPOSED SOURCE OF ORGANIC MATTER, AND CONSIST OF PARTICLES RANGING FROM 3/8" TO 2".
  - FILTER SOCKS SHALL BE PLACED ON A LEVEL LINE ACROSS SLOPES PARALLEL TO THE BASE OF THE SLOPE.
  - FILTER SOCKS SHALL BE PLACED AT LEAST 5' FROM THE TOE OF SLOPE FOR SEDIMENT DEPOSIT.
  - BUILT UP SEDIMENT SHALL BE REMOVED WHEN IT HAS REACHED 1/3 THE FILTER SOCK HEIGHT.
  - WHEN A FILTER SOCK IS NO LONGER REQUIRED, IT SHALL BE DISPERSED ON-SITE.
  - THE MAXIMUM DRAINAGE AREA PER 100 FEET OF FILTER SOCK IS 1/2 ACRE AND IS DEPENDENT ON THE SLOPE.

MAX. SLOPE LENGTH ABOVE FILTER SOCK					
SLOPE	RATIO (H:V)	8'	12'	18'	24'
0% - 2%	0 - 50:1	125'	250'	300'	350'
2% - 10%	50:1 - 10:1	100'	125'	200'	250'
10% - 20%	10:1 - 5:1	75'	100'	150'	200'

**FS FILTER SOCK DETAIL**  
SCALE: NONE

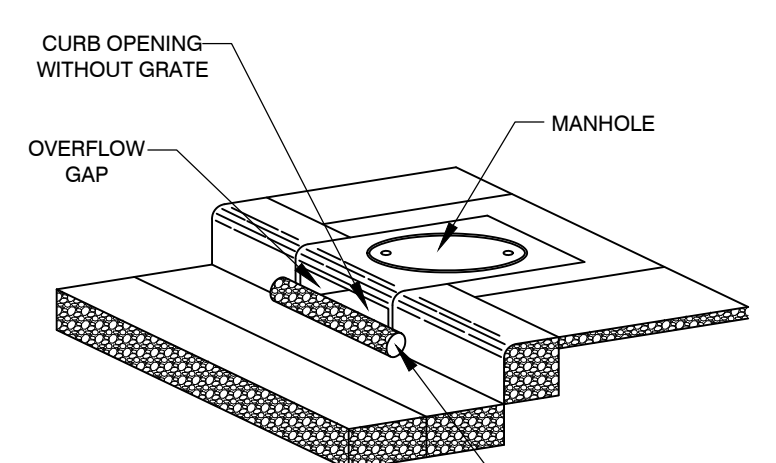

**IP DANDY CURB**  
SCALE: NONE



DATE	REVISION	NO	BID	ISSUED FOR:	ISSUE DATE:	SCALE:	AS NOTED	DESIGNED BY:	DGAR	DGAR	JSHU	CHECKED BY:
			4/16/2026									

**OPTIMIST PARK**  
**CITY OF SOUTHGATE**  
**CAMPBELL COUNTY, KENTUCKY**

**STORM WATER POLLUTION PREVENTION PLAN**

PROJECT NO.	45436
DISCIPLINE	CIVIL
SHEET NAME	C6
SHEET	6
OF	6



**LEGEND**

SHREDDED BLACK HARDWOOD MULCH BEDS.

**GENERAL NOTES**

1. DETERMINE DRAINAGE PATTERNS BEFORE START OF CONSTRUCTION. ENSURE PROPER DRAINAGE THROUGHOUT SITE.
2. ALL PLANTING MATERIAL TO BE GUARANTEED FOR 1 YEAR FROM TIME OF COMPLETION.
3. NOTIFY OWNER OF ANY OBSTRUCTIONS OR POOR SOIL CONDITIONS ENCOUNTERED THAT MAY IMPACT PLANT PLACEMENT OR HEALTH.
4. PLANT SUBSTITUTIONS ARE NOT ALLOWED WITHOUT WRITTEN APPROVAL OF THE OWNER, PRIOR TO PURCHASE OF PLANT MATERIALS.
5. CONTRACTOR SHALL LOCATE AND VERIFY EXISTING UTILITIES (CHARTED AND UNCHARTED) PRIOR TO STARTING WORK AND WILL BE HELD RESPONSIBLE FOR ANY DAMAGE.
6. PROVIDE 3" SHREDDED HARDWOOD MULCH FOR ALL PLANTING BEDS AND TREE SAUCER BEDS UNLESS NOTED OTHERWISE.
7. ALL PLANT MATERIAL TO MEET THE REQUIREMENTS OF ANSI Z60.1: AMERICAN STANDARD FOR NURSERY STOCK.
8. PROVIDE IMPORTED TOPSOIL ONLY. TOPSOIL SHALL BE FREE OF ROCKS OR OTHER DEBRIS. PROVIDE SOIL TEST AND PROVIDE AMENDMENTS BASED ON THESE TEST.
9. PROVIDE 6" DEPTH TOPSOIL FOR ALL TURF AREAS AND 12" DEPTH TOPSOIL FOR ALL LANDSCAPE BEDS. PROVIDE TOPSOIL FOR DECIDUOUS TREES, EVERGREEN TREES, AND SHRUB PLANTINGS.
10. PROVIDE SEEDED LAWN FOR ALL AREAS DISTURBED BY CONSTRUCTION.
11. PLANT COUNT: PLANT SYMBOLS SUPERSEDE PLANT SCHEDULE.
12. PROVIDE SHOVEL CUT BEDLINE AROUND ALL PLANTING BEDS AND TREE SAUCERS.

**PLANT SCHEDULE**

SYMBOL	QTY	BOTANICAL NAME	COMMON NAME	SIZE	SPACING
LIR TUL	9	LIRIODENDRON TULIPIFERA 'LITTLE VOL.'	LITTLE VOLUNTEER TULIP POPLAR	2" CAL.	AS SHOWN
AME PRI	7	AMELANCHIER CANADENSIS 'PRINCE WILL.'	PRINCE WILLIAM SHADBLOW SERVICE.	2" CAL.	AS SHOWN
CER RED	4	CERCIS CANADENSIS	EASTERN REDBUD	2" CAL.	AS SHOWN
CHA CYP	16	CHAMAECYPARIS PISIFERA 'GOLDEN MOP'	GOLDEN MOP FALSE CYPRESS	#3 CONT.	AS SHOWN
PHY WIN	24	PHYSOCARPUS OPULIFOLIUS	TINY WINE NINEBARK	#3 CONT.	AS SHOWN

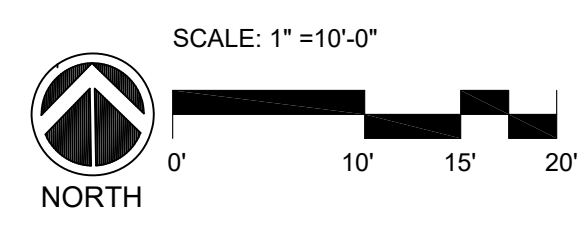

REVISIONS DATE	#	ITEM
4/01/2025	1	REVIEW
5/05/2025	2	REVIEW
5/20/2025	3	REVIEW
7/8/2025	4	REVIEW
7/29/2025	5	REVIEW
11/13/2025	6	REVIEW
1/09/2026	7	REVIEW
2/18/2026	8	REVIEW
4/10/2026	9	REVIEW

Landscape Architecture  
 Urban Design  
 Planning  
 Environmental Graphics  
**place**  
 WORKSHOP  
293 East Fifth Street, 15th Floor PMB #649 • Cincinnati, Ohio 45202 • 513.312.2395 • www.placeworkshop.com

**PROJECT:** OPTIMIST PARK CONCEPT PLAN  
 SOUTHGATE, KENTUCKY  
**CLIENT:** SOUTHBANK PARTNERS

FOR REVIEW ONLY  
 PRELIMINARY  
 NOT RELEASED  
 FOR  
 CONSTRUCTION

DRAWN BY: KBO	SEAL
CHECKED BY: KBO	
PROJECT MANAGER: KBO	
PROJECT NO. 2510	
SCALE 1" = 10'	
DATE 04-10-26	
LANDSCAPE PLAN	
SHEET <b>L-1</b>	

**GENERAL TURF NOTES**

**PART 1 - GENERAL**

**1.1 SUMMARY**

- A. Provide lawns as shown and specified. The work includes:
  1. Soil preparation
  2. Seeded lawns
  3. Maintenance

**1.2 SUBMITTALS**

- A. Submit the following material certifications:
  1. Seed vendor's certification indicating percentage by weight, percentages of purity, germination and weed seed content for each type of grass species.
  2. Fertilizer(s) analysis
- B. Submit schedule of seeding operations including seeding methods for lawns that will be employed.

**1.3 QUALITY ASSURANCE**

- A. Coordinate with work of other trades and activities, particularly with sequencing of finish grading and planting.

**1.4 DELIVERY, STORAGE, AND HANDLING**

- A. Fertilizer: Deliver fertilizer materials in original unopened containers, showing weight, analysis, and name of manufacturer. Store in a manner to prevent wetting and deterioration.
- B. Seed: All seed materials shall be handled and delivered to the site in a manner which protects seed against moisture, incompatible temperature and weather until utilized in seeding operations.

**1.5 PROJECT CONDITIONS**

- A. Work notification: Notify General Contractor at least 7 working days prior to start of seeding operations.
- B. Protect existing utilities, paving, and other facilities from damage caused by seeding operations.
- C. Perform work only after finish grading and planting and any other work affecting ground surface is completed and has received approval from the owners representative.
- D. Restrict traffic from lawn areas until grass is established. Erect signs and barriers as required.
- E. Provide hoses and lawn-watering equipment as required.
- F. Seeding Periods: Seeding of permanent lawns to occur from March 15 through May 15 and from September 1 through October 15. Seeding operations at other times shall be only with the approval of the Owner's Representative and at the Subcontractor's risk.

**1.6 WARRANTY**

- A. Provide a uniform stand of grass by maintaining lawn areas until final acceptance. Re-seed areas, with specified materials, which fail to provide a uniform stand until all affected areas are accepted by the owners representative.

**PART 2 - PRODUCTS**

**2.1 MATERIALS**

- A. Lawn Seed: Shall be certified grass seed blend, fresh, clean, weed seed free and new crop seed, composed of the following varieties, mixed to the specified proportions by weight and tested to minimum percentages of purity and germination. Seed Mix for lawn areas: Select seed type per local recommendations for project area.

- B. Starter Fertilizer: Granular, commercial-grade complete fertilizer of neutral character, consisting of fast and slow-release nitrogen, 50% derived from natural organic sources of urea-form, phosphorous and potassium in amounts recommended in soils report from a qualified soil-testing agency.

**Fertilizer:**

- A. Ground limestone: ASTM C 602, Class T, agricultural limestone containing a minimum 80% calcium carbonate equivalent, with a minimum 99% passing a No. 8 sieve and a minimum 75% passing a No. 6 sieve. Provide lime in the form of dolomitic limestone. If needed and at rate determined by agronomist based on soil test.

- B. Sulfur: Granulated agricultural sulfur.

- C. Straw Mulch: Clean oat or wheat straw, well seasoned before baling, free from mature seed bearing stalks or roots of prohibited or noxious weeds.

- D. Tackifier: Liquid concentrate diluted with water forming a transparent 3-dimensional film-like crust, permeable to water and air, and containing no agents toxic to seed germination.

- E. Water: Potable, clean fresh and free from harmful materials. Water shall be furnished by the Owner. All hoses and other irrigation equipment required for the work shall be furnished by the Contractor. Failures in the water distribution system shall not relieve the Contractor from applying water as required.

- F. Erosion control blanket: Biodegradable wood excelsior, straw, or coconut-fiber mat enclosed in a photodegradable plastic mesh. Include manufacturer's recommended staples.

**PART 3 - EXECUTION**

**3.1 INSPECTION**

- A. Examine finish graded surfaces, grades, topsoil quality and depth. Lawn areas shall be free of brush piles, construction debris and other deleterious materials. Do not start topsoil and seeding work until unsatisfactory conditions are corrected and after finish grading, planting and any other work affecting ground surface is completed and has received approval from the Landscape Architect.

**3.2 SOIL EROSION CONTROL**

- A. Provide erosion control measures to prevent erosion or displacement of soils and discharge of soil-bearing water runoff or airborne dust to adjacent properties and walkways. Erosion control measures include placement of erosion barriers such as silt fence or staked hay bales, and temporary seeding.
- B. Provide temporary seeding to stabilize soils when permanent seeding is prohibitive due to inappropriate planting season or limitations from project sequencing.

- C. Provide erosion control blanket on all slopes of 3:1 or greater.

**3.3 LAWN PLANTING PREPARATION**

- A. Soil Preparation:
  1. Limit preparation to areas which will be immediately seeded.
  2. Spread stockpiled topsoil to a uniform depth of 6" over entire area to be seeded/sodded.
  3. Remove sticks, roots, and stones over 1/2" in any dimension and other extraneous matter.
  4. Grade lawn areas to a smooth, free-draining even surface with a loose, moderately coarse texture. Roll and rake, remove ridges, and fill depressions as required to drain. Surface shall be graded to such elevation so the lawn, when established, shall be flush with any adjacent turfed area, pavement or curb.
  5. Restore prepared areas to specified condition if compacted, eroded, settled, or otherwise disturbed after fine grading and prior to seeding operations.
- B. Soil Amendments:
  1. Apply fertilizer to indicated turf areas at a rate equal to 1.0 lb. of actual nitrogen per 1,000 sq. ft., or as determined by the topsoil test report. Apply fertilizers by mechanical rotary or drop type distributor, thoroughly and evenly incorporated with soil to a depth of 3" by discing or other approved method. Fertilize areas inaccessible to power equipment with hand tools and incorporate into soil.

**3.4 LAWN INSTALLATION**

- A. Seeded Lawn:
  1. Perform seeding operations when the soil is not saturated and when winds do not exceed 5 miles per hour velocity. Apply seed at rates specified with each seed mixture. Spread evenly with a rotary or drop-type spreader, sowing equal quantities in 2 directions, at right angles to each other, at a rate to obtain specified seed-sowing rate. Incorporate into the top surface of the soil by raking lightly or rolling with a light lawn roller. Immediately after seeding, cover areas with straw evenly spread at a rate of 1 bale per 1000 sq. ft. to achieve an approximate coverage of 50% of the soil surface. Anchor straw with liquid tackifier applied uniformly at rates recommended by the manufacturer. Protect buildings, pavements, plantings and all non-seeded areas from tackifier overspray and seeding operations.
  2. Watering: Following installation of seeded lawns, entire area will be watered by use of lawn sprinklers. Initial watering shall continue until the equivalent of a 2" depth of water has been applied over the entire lawn area, at a rate, which will not dislodge seed. Watering methods and equipment which may cause erosion and/or compaction of the surface will not be permitted. Water lawns until final acceptance, at such frequency as weather conditions require, to maintain appropriate soil moisture for seed germination and lawn establishment.

**3.5 MAINTENANCE**

- A. Begin maintenance of lawns immediately after each area is planted and continue until acceptable lawn is established, but for not less than the following period:
  1. Seeded Lawns: 60 days after date of Substantial Completion, except when full maintenance period has not elapsed before end of fall planting season, or if lawn has not fully established at that time, then maintenance period shall continue into spring planting season.
- B. Maintenance to including watering, spot weeding, mowing, applications of herbicides, fungicides, insecticides, and re-seeding or sodding until a full, uniform stand of grass free of weeds, undesirable grass species, disease, and insects is achieved and accepted by the owners representative.
- C. Mowing: Mow lawn areas as soon as lawn top growth reaches a 3 1/2" height. Cut back to 2 1/2" in height. Remove no more than 40 percent of grass-leaf growth in initial or subsequent mowing. Do not delay mowing until grass blades bend over and become matted. Do not mow when grass is wet. Repeat mowing as required to maintain specified height.
- D. Post-fertilization: Apply fertilization to lawn after first mowing and when grass is dry. Apply fertilizer at rates that will provide actual nitrogen of at least 1 lb. per 1000 sq. ft. of lawn area or at rate determined by topsoil test recommendations.

**3.6 FINAL ACCEPTANCE**

- A. Inspection to determine final acceptance of lawn areas will be made by the Owner's Representative, upon Contractor's request. Provide notification at least 10 working days before requested inspection date.
  1. Seeded Lawn areas will be acceptable provided all requirements, including maintenance, have been complied with and a healthy, uniform, close stand of grass is established free of weeds, undesirable grass species, disease and insects. No single lawn area shall have bare spots or unacceptable cover exceeding 6" dimension in any direction.
- B. Upon acceptance and following the maintenance period, the Owner will assume lawn maintenance.

**3.7 CLEANING**

- A. Perform cleaning during installation of the work and upon completion of the work. Remove from site all excess materials, debris, and equipment. Repair damage resulting from seeding operations.

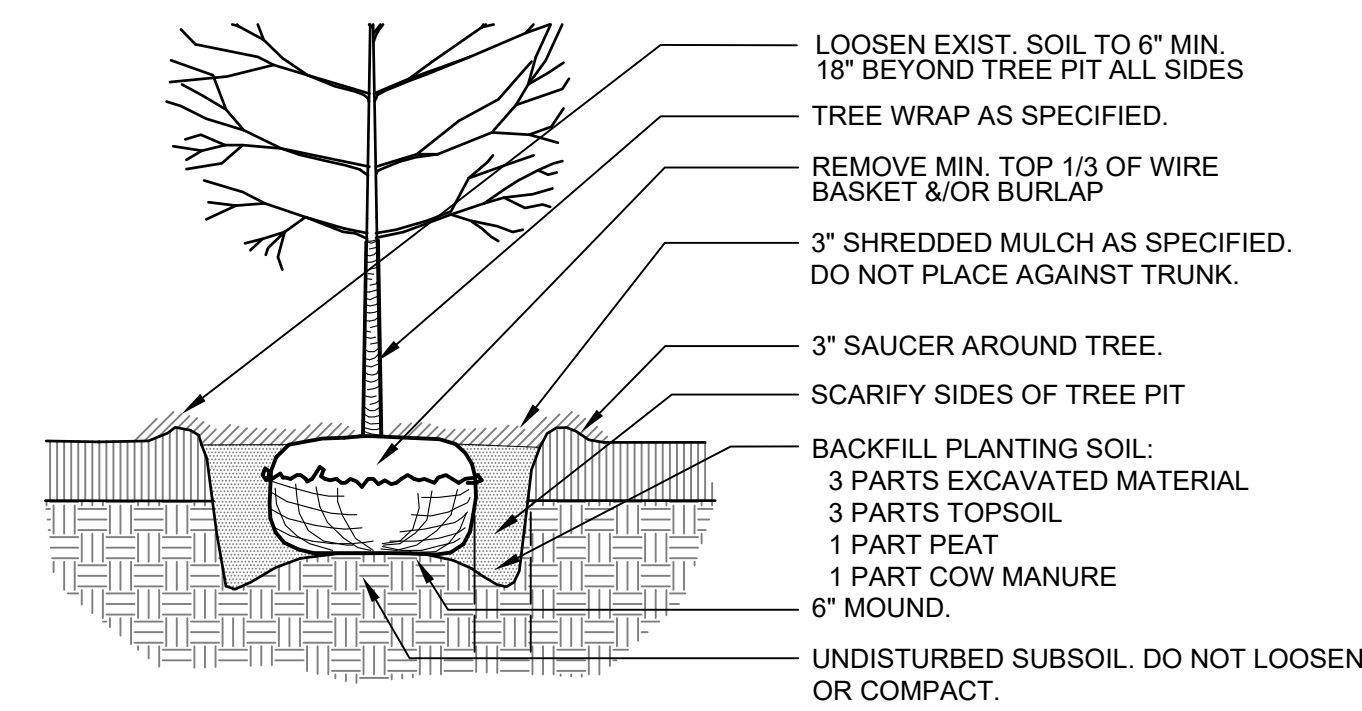

**DECIDUOUS TREE PLANTING DETAIL**

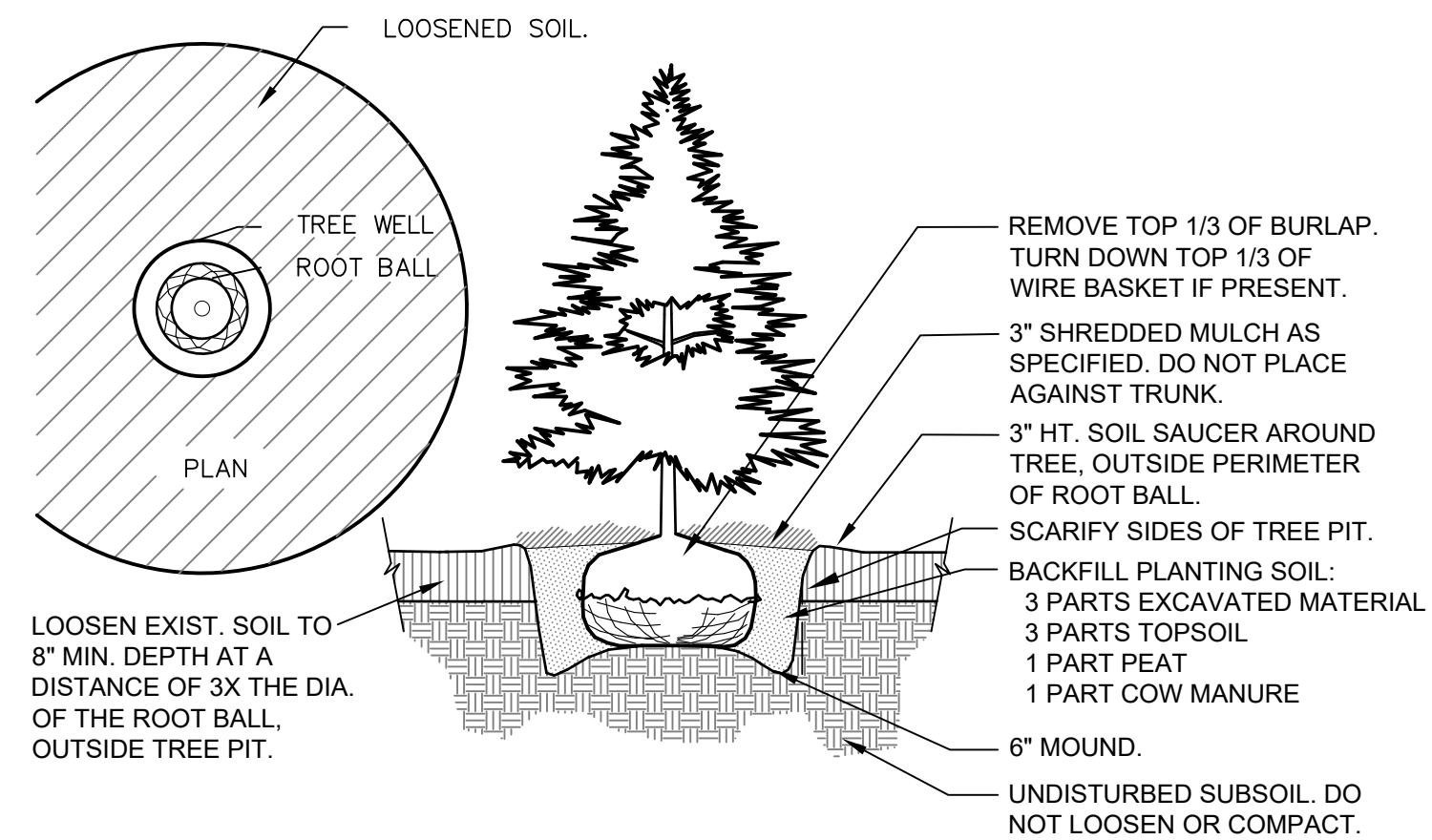

**CONIFEROUS TREE PLANTING DETAIL**

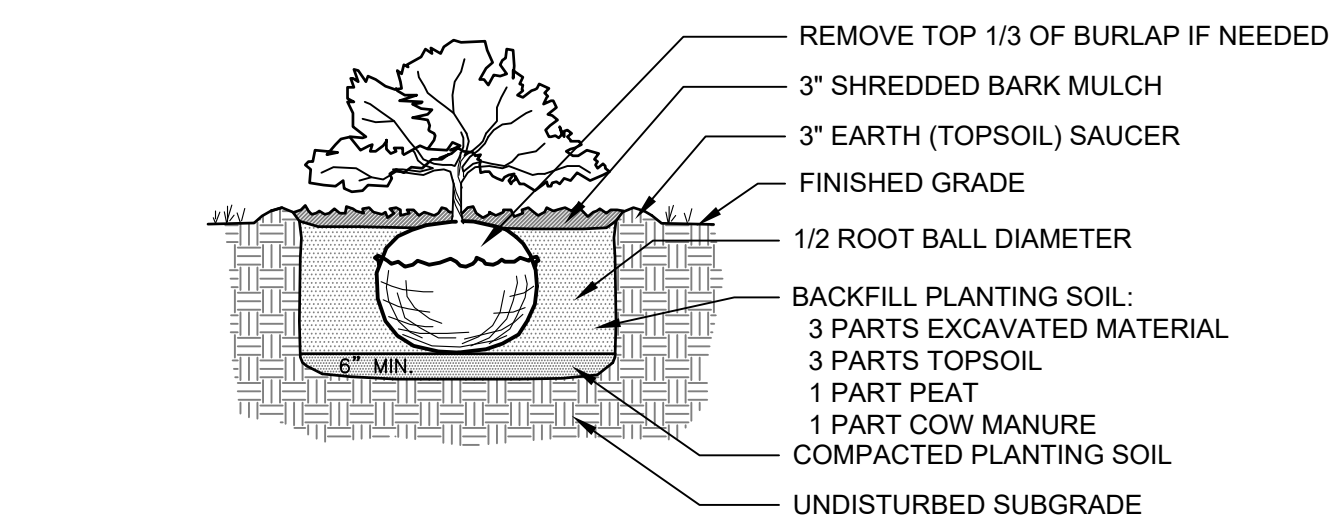

**SHRUB PLANTING DETAIL**

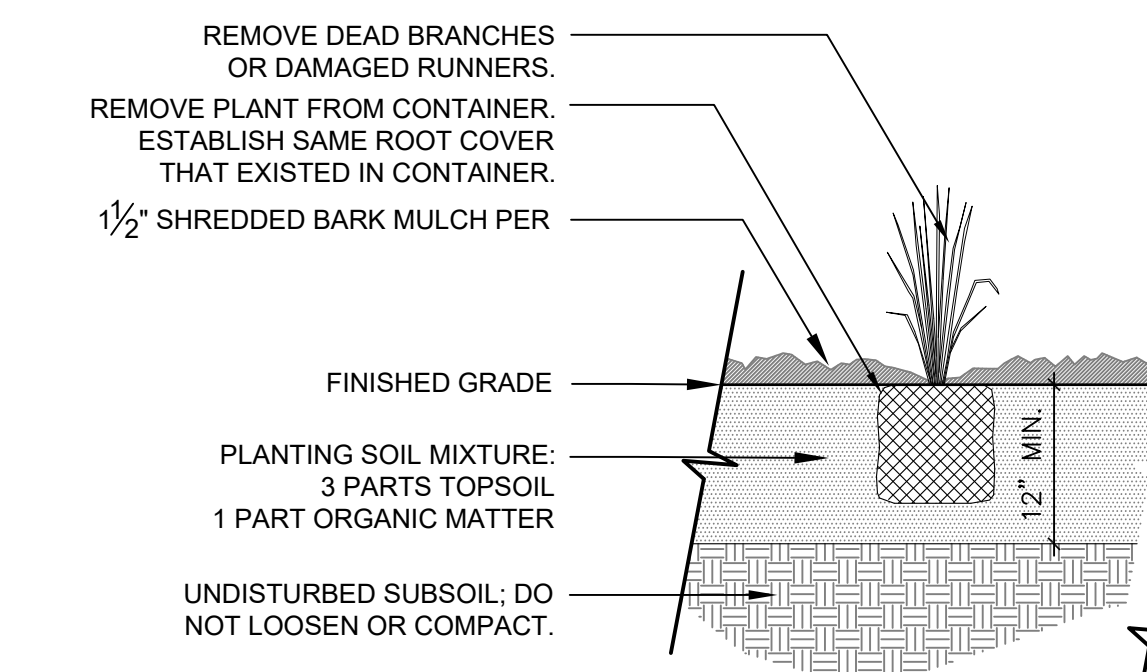

**ORNAMENTAL PERENNIAL GRASS PLANTING DETAIL**

REVISIONS DATE	#	ITEM
4/01/2025	1	REVIEW
5/05/2025	2	REVIEW
5/20/2025	3	REVIEW
7/8/2025	4	REVIEW
7/29/2025	5	REVIEW
11/13/2025	6	REVIEW
1/09/2026	7	REVIEW
2/18/2026	8	REVIEW
4/10/2026	9	REVIEW

Landscape Architecture  
Urban Design  
Planning  
Environmental Graphics

**place**  
WORKSHOP

293 East Fifth Street, 15th Floor PMB #049 • Cincinnati, Ohio 45202 • 513.312.2395 • www.placeworkshop.com

PROJECT: OPTIMIST PARK CONCEPT PLAN SOUTHGATE, KENTUCKY

CLIENT: SOUTHBANK PARTNERS

FOR REVIEW ONLY  
PRELIMINARY  
NOT RELEASED  
FOR  
CONSTRUCTION

DRAWN BY:	SEAL
KBO	
CHECKED BY:	
KBO	
PROJECT MANAGER:	
KBO	

PROJECT NO. 2510  
SCALE N.T.S.  
DATE 04-10-26

DETAILS & NOTES

SHEET **L-2**

GENERAL PLANTING NOTES

1.1 SUMMARY

A. This Section includes the following: Trees, Shrubs, Plants, Topsoil.

1.2 DEFINITIONS

A. **Balled and Burlapped Stock:** Exterior plants dug with firm, natural balls of earth in which they are grown, with ball size not less than diameter and depth recommended by ANSI Z60.1 for type and size of tree or shrub required; wrapped, tied, rigidly supported, and drum-laced as recommended by ANSI Z60.1.

B. **Balled and Potted Stock:** Exterior plants dug with firm, natural balls of earth in which they are grown and placed, unbroken, in a container. Ball size is not less than diameter and depth recommended by ANSI Z60.1 for type and size of exterior plant required.

C. **Container-Grown Stock:** Healthy, vigorous, well-rooted exterior plants grown in a container with well-established root system reaching sides of container and maintaining a firm ball when removed from container. Container shall be rigid enough to hold ball shape and protect root mass during shipping and be sized according to ANSI Z60.1 for kind, type, and size of exterior plant required.

D. **Finish Grade:** Elevation of finished surface of planting soil.

E. **Planting Soil:** Imported topsoil, mixed with soil amendments.

F. **Subgrade:** Surface or elevation of subsoil remaining after completing excavation, or top surface of a fill or backfill, before placing planting soil.

1.3 SUBMITTALS

A. **Product Data:** For each type of product indicated.

B. **Plant Materials:** Include quantities, sizes, quality, and sources for plant materials

B. **Manufacturer's certified analysis for standard products.**  
Analysis of other materials by a recognized laboratory made according to methods established by the Association of Official Analytical Chemists, where applicable.

C. **Qualification Data:** For landscape installer.

D. **Material Test Reports:** For existing surface soil and imported topsoil.

E. **Planting Schedule:** Indicating anticipated planting dates for exterior plants.

F. **Maintenance Instructions:** Recommended procedures to be established by Owner for maintenance of exterior plants during a calendar year. Submit before expiration of required maintenance periods.

1.4 QUALITY ASSURANCE

A. **Installer Qualifications:** A qualified landscape installer whose work has resulted in successful establishment of exterior plants.

B. **Soil-Testing Laboratory Qualifications:** An independent laboratory, recognized by the State Department of Agriculture, with the experience and capability to conduct the testing indicated and that specializes in types of tests to be performed.

C. **Topsoil Analysis:** Furnish soil analysis by a qualified soil-testing laboratory stating percentages of organic matter; gradation of sand, silt, and clay content; cation exchange capacity; sodium absorption ratio; deleterious material; pH; and mineral and plant-nutrient content of topsoil.

- Testing methods and written recommendations shall comply with USDA's Handbook No. 60.
- The soil-testing laboratory shall oversee soil sampling; with depth, location, and number of samples to be taken per instructions from Architect. A minimum of three representative samples shall be taken from varied locations for each soil to be used or amended for planting purposes.
- Report suitability of tested soil for plant growth.
  - Based upon the test results, state recommendations for soil treatments and soil amendments to be incorporated. State recommendations in weight per 1000 sq. ft. for nitrogen, phosphorus, and potash nutrients and soil amendments to be added to produce satisfactory planting soil suitable for healthy, viable plants.
  - Report presence of problem salts, minerals, or heavy metals, including aluminum, arsenic, barium, cadmium, chromium, cobalt, lead, lithium, and vanadium. If such problem materials are present, provide additional recommendations for corrective action.

D. **Provide quality, size, genus, species, and variety of exterior plants indicated, complying with applicable requirements in ANSI Z60.1, "American Standard for Nursery Stock."**

E. **Tree and Shrub Measurements:** Measure according to ANSI Z60.1 with branches and trunks or canes in their normal position. Do not prune to obtain required sizes. Take caliper measurements 6 inches above ground for trees up to 4-inch caliper size, and 12 inches above ground for larger sizes. Measure main body of tree or shrub for height and spread; do not measure branches or roots tip-to-tip.

F. **Observation:** Owner's Representative may observe trees and shrubs at site before planting for compliance with requirements for genus, species, variety, size, and quality. Owner's Representative retains right to observe trees and shrubs further for size and condition of balls and root systems, insects, injuries, and latent defects and to reject unsatisfactory or defective material at any time during progress of work. Remove rejected trees or shrubs immediately from Project site.

G. **No substitution of any plant materials, including but not limited to trees, shrubs, groundcovers, perennials, grasses, etc., shall be permitted without the written approval of the owners representative.** This approval must be obtained at least two weeks prior to plant materials being delivered to the site. No substitution will be authorized after plants have been delivered to the site.

1.5 DELIVERY, STORAGE, AND HANDLING

A. Deliver exterior plants freshly dug.

B. Do not prune trees and shrubs before delivery, except as approved by owners representative. Protect bark, branches, and root systems from sun scald, drying, sweating, whipping, and other handling and tying damage. Do not bend or bind-tie trees or shrubs in such a manner as to destroy their natural shape. Provide protective covering of exterior plants during delivery. Do not drop exterior plants during delivery.

C. Handle planting stock by root ball.

D. Deliver exterior plants after preparations for planting have been completed and install immediately. If planting is delayed more than six hours after delivery, set exterior plants trees in shade, protect from weather and mechanical damage, and keep roots moist. Heel-in bare-root stock. Soak roots in water for two hours if dried out. Set balled stock on ground and cover ball with soil, peat moss, sawdust, or other acceptable material. Do not remove container-grown stock from containers before time of planting. Water root systems of exterior plants stored on-site with a fine-mist spray. Water as often as necessary to maintain root systems in a moist condition.

1.6 COORDINATION

A. **Contact:** Ohio 811 2 business days before digging. 1-800-362-2764. <http://www.oups.org>. Kentucky 811. <https://kentucky811.org/>

B. **Planting Restrictions:** Plant during one of the following periods. Coordinate planting periods with maintenance periods to provide required maintenance from date of Substantial Completion.  
Spring Planting: March 15 to June 15  
Fall Planting: September 15 to November 15

C. **Weather Limitations:** Proceed with planting only when existing and forecasted weather conditions permit.

D. **Coordination with Lawns:** Plant trees and shrubs after finish grades are established and before planting lawns, unless otherwise acceptable to Owner's Representative.

D. **When planting trees and shrubs after lawns, protect lawn areas and promptly repair damage caused by planting operations.**

1.7 WARRANTY

A. **Special Warranty:** Warrant the following exterior plants, for the warranty period indicated, against defects including death and unsatisfactory growth, except for defects resulting from lack of adequate maintenance, neglect, or abuse by Owner, or incidents that are beyond Contractor's control.

B. **Warranty Period:** One year from date of Substantial Completion.  
Remove dead exterior plants immediately. Replace immediately unless required to plant in the succeeding planting season.  
Replace exterior plants that are more than 25 percent dead or in an unhealthy condition at end of warranty period.  
A limit of one replacement of each exterior plant will be required, except for losses or replacements due to failure to comply with requirements.

1.8 MAINTENANCE

A. **Trees and Shrubs:** Maintain for the following maintenance period by pruning, cultivating, watering, weeding, fertilizing, restoring planting saucers, tightening and repairing stakes and guy supports, and resetting to proper grades or vertical position, as required to establish healthy, viable plantings. Spray as required keeping trees and shrubs free of insects and disease. Restore or replace damaged tree wrappings.

1. **Maintenance Period:** 1 year from date of Substantial Completion.

B. **Ground Cover and Plants:** Maintain for the following maintenance period by watering, weeding, fertilizing, and other operations as required to establish healthy, viable plantings:  
1. **Maintenance Period:** 1 year from date of Substantial Completion.

C. **When full maintenance period has not elapsed before end of planting season, continue maintenance during next planting season.**

PART 2 - PRODUCTS

2.1 TREE AND SHRUB MATERIAL

A. **General:** Furnish nursery-grown trees and shrubs complying with ANSI Z60.1, with healthy root systems developed by transplanting or root pruning. Provide well-shaped, fully branched, healthy, vigorous stock free of disease, insects, eggs, larvae, and defects such as knots, sunscald, injuries, abrasions, and disfigurement.

B. **Grade:** Provide trees and shrubs of sizes and grades complying with ANSI Z60.1 for type of trees and shrubs required. Trees and shrubs of a larger size may be used if acceptable to Owner's Representative, with a proportionate increase in size of roots or balls.

C. **Label each tree and shrub with securely attached, waterproof tag bearing legible designation of botanical and common name. Remove all tags after final acceptance.**

D. **If formal arrangements or consecutive order of trees or shrubs is shown, select stock for uniform height and spread, and number label to assure symmetry in planting.**

2.2 SHADE AND FLOWERING TREES

A. **Shade Trees:** Single-stem trees with straight trunk, well-balanced crown, and intact leader, of height and caliper indicated, complying with ANSI Z60.1 for type of trees required.  
Provide balled and burlapped trees.  
Branching Height: One-third to one-half of tree height.

B. **Small Upright Spreading Trees:** Branched or pruned naturally according to species and type, with relationship of caliper, height, and branching according to ANSI Z60.1; stem form as follows:  
Stem Form: Single stem.  
Provide balled and burlapped trees.

C. **Multistem Trees:** Branched or pruned naturally according to species and type, with relationship of caliper, height, and branching according to ANSI Z60.1; stem form as follows:  
Stem Form: Clump.  
Provide balled and burlapped trees.

2.3 DECIDUOUS SHRUBS

A. **Form and Size:** Deciduous shrubs with not less than the minimum number of canes required by and measured according to ANSI Z60.1 for type, shape, and height of shrub.  
Provide balled and burlapped or container-grown, as noted on plans shrubs.

2.4 CONIFEROUS EVERGREENS

A. **Form and Size:** Normal-quality, well-balanced, coniferous evergreens, of type, height, spread, and shape required, complying with ANSI Z60.1.  
Provide balled and burlapped trees.

2.5 PLANTS

A. **Perennials and Ornamental Grasses:** Provide healthy, field-grown plants from a commercial nursery, of species and variety shown or listed.

2.6 INORGANIC SOIL AMENDMENTS

A. **Lime:** ASTM C 602, agricultural limestone containing a minimum 80 percent calcium carbonate equivalent and as follows:  
Class: Class O, with a minimum 95 percent passing through No. 8 sieve and a minimum 55 percent of passing through No. 60 sieve.  
Provide lime in form of dolomitic limestone.  
Select appropriate sulfate compounds from first three paragraphs below. Sulfur is used to lower pH and neutralize alkaline soils. Revise descriptions and add proprietary products if required.

B. **Sulfur:** Granular, biodegradable, containing a minimum of 90 percent sulfur, with a minimum 99 percent passing through No. 6 sieve and a maximum 10 percent passing through No. 40 sieve.

C. **Iron Sulfate:** Granulated ferrous sulfate containing a minimum of 20 percent iron and 10 percent sulfur.

2.7 ORGANIC SOIL AMENDMENTS

A. **Compost:** Well-composted, stable, and weed-free organic matter, pH range of 5.5 to 8; moisture content 35 to 55 percent by weight; 100 percent passing through 3/4-inch (19-mm) sieve; soluble salt content of 5 to 10 decimeqsm/cm; not exceeding 0.5 percent inert contaminants and free of substances toxic to plantings; and as follows:  
Organic Matter Content: 50 to 60 percent of dry weight.  
Compost may be produced from several feedstocks or raw materials. Revise types of feedstocks below if limiting sources. Revise descriptions and add product names if required.

B. **Peat:** Sphagnum peat moss, partially decomposed, finely divided or granular texture, with a pH range of 3.4 to 4.8.

C. **Manure:** Well-rotted, unleached, stable or cattle manure containing not more than 25 percent by volume of straw, sawdust, or other bedding materials; free of toxic substances, stones, sticks, soil, weed seed, and material harmful to plant growth.

2.8 TOPSOILS

A. **Planting Soil:** Imported topsoil or manufactured topsoil from off-site sources. Obtain topsoil displaced from naturally well-drained construction or mining sites where topsoil occurs at least 4 inches (100 mm) deep; do not obtain from **agricultural land**, bogs, or marshes.

1. **Additional Properties of Imported Topsoil or Manufactured Topsoil:** Screened and free of stones 3/8" or larger in any dimension; free of roots, plants, sod, clods, clay lumps, pockets of coarse sand, paint, paint washout, concrete slurry, concrete layers or chunks, cement, plaster, building debris, oils, gasoline, diesel fuel, paint thinner, turpentine, tar, roofing compound, acid, and other extraneous materials harmful to plant growth; free of obnoxious weeds and invasive plants including quackgrass, Johnsongrass, poison ivy, nutsedge, nimblewill, Canada thistle, bindweed, bentgrass, wild garlic, ground ivy, perennial sorrel, and bromegrass; not infested with nematodes; grubs; or other pests, pest eggs, or other undesirable organisms and disease-causing plant pathogens; friable and with sufficient structure to give good tilth and aeration. Continuous, air-filled pore space content on a volume/volume basis shall be at least 15 percent when moisture is present at field capacity. Soil shall have a field capacity of at least 15 percent on a dry weight basis.

2.9 FERTILIZER

A. **Bonemeal:** Commercial, raw or steamed, finely ground; a minimum of 4 percent nitrogen and 10 percent phosphoric acid.

B. **Superphosphate:** Commercial, phosphate mixture, soluble; a minimum of 20 percent available phosphoric acid.

C. **Commercial Fertilizer:** Commercial-grade complete fertilizer of neutral character, consisting of fast- and slow-release nitrogen, 50 percent derived from natural organic sources of urea formaldehyde, phosphorous, and potassium in the following composition:  
Composition: Nitrogen, phosphorous, and potassium in amounts recommended in soil reports from a qualified soil-testing agency.

D. **Slow-Release Fertilizer:** Granular or pelleted fertilizer consisting of 50 percent water-insoluble nitrogen, phosphorous, and potassium in the following composition:  
Composition: Nitrogen, phosphorous, and potassium in amounts recommended in soil reports from a qualified soil-testing agency.

2.10 MULCHES

A. **Organic Mulch:** Free from deleterious materials and suitable as a top dressing of trees and shrubs, consisting of one of the following:  
Type: Shredded hardwood bark.

2.11 STAKES AND GUYS

A. **Upright and Guy Stakes:** Rough-sawn, sound, new hardwood, redwood, or pressure-preservative-treated softwood, free of knots, holes, cross grain, and other defects, 2 by 2 inches by length indicated, pointed at one end.

B. **Guy and Tie Wire:** ASTM A 641/A 641M, Class 1, galvanized-steel wire, 2-strand, twisted, 0.106 inch in diameter.

C. **Guy Cable:** 5-strand, 3/16-inch diameter, galvanized-steel cable, with zinc-coated turnbuckles, a minimum of 3 inches long, with two 3/8-inch galvanized eyebolts.

D. **Hose Chafing Guard:** Reinforced rubber or plastic hose at least 1/2 inch in diameter, black, cut to lengths required to protect tree trunks from damage.

E. **Flags:** Standard surveyor's plastic flagging tape, white, 6 inches long.

2.12 LANDSCAPE EDGING

A. **Shovel cut natural edge.** To be maintained 2 times per season.

2.13 MISCELLANEOUS PRODUCTS

A. **Antidesiccant:** Water-insoluble emulsion, permeable moisture retarder, film forming, for trees and shrubs. Deliver in original, sealed, and fully labeled containers and mix according to manufacturer's written instructions.

B. **Trunk-Wrap Tape:** Two layers of crinkled paper cemented together with bituminous material, 4-inch wide minimum, with stretch factor of 33 percent.

2.14 PLANTING SOIL MIX

A. **Planting Soil Mix:** Mix topsoil with the following soil amendments and fertilizers in the following quantities:  
Ratio of Loose Compost to Topsoil by Volume: 1:4.  
Ratio of Loose Peat Moss to Topsoil by Volume: 1:4  
Weight of Sulfur, Iron Sulfate, and/or Aluminum Sulfate per 1000 Sq. Ft.: Per soils report recommendation.  
Weight of Commercial Fertilizer per 1000 Sq. Ft.: Per soils report recommendation.

PART 3 - EXECUTION

3.1 EXAMINATION

A. **Examine areas to receive exterior plants for compliance with requirements and conditions affecting installation and performance. Proceed with installation only after unsatisfactory conditions have been corrected.**

3.2 PREPARATION

A. **Protect structures, utilities, sidewalks, pavements, and other facilities, and lawns and existing exterior plants from damage caused by planting operations.**

B. **Provide erosion-control measures to prevent erosion or displacement of soils and discharge of soil-bearing water runoff or airborne dust to adjacent properties and walkways.**

C. **Lay out individual tree and shrub locations and areas for multiple exterior plantings. Stake locations, outline areas, adjust locations when requested, and obtain Owner's Representative's acceptance of layout before planting. Make minor adjustments as required.**

D. **Apply antidesiccant to trees and shrubs using power spray to provide an adequate film over trunks, branches, stems, twigs, and foliage to protect during digging, handling, and transportation. If deciduous trees or shrubs are moved in full leaf, spray with antidesiccant at nursery before moving and again two weeks after planting.**

3.3 PLANTING BED ESTABLISHMENT

A. **Loosen subgrade of planting beds to a minimum depth of 12 inches. Remove stones larger than 1 inch in any dimension and sticks, roots, rubbish, and other extraneous matter and legally dispose of them off Owner's property. Coordinate with "Planting Soil Mix" Article in Part 2.**

B. **Spread topsoil to depths indicated, apply soil amendments and fertilizer on surface, and thoroughly blend planting soil mix. Delay mixing fertilizer with planting soil if planting will not proceed within a few days.**

C. **Finish Grading:** Grade planting beds to a smooth, uniform surface plane with loose, uniformly fine texture. Roll and rake, remove ridges, and fill depressions to meet finish grades.

D. **Restore planting beds if eroded or otherwise disturbed after finish grading and before planting.**

3.4 TREE AND SHRUB EXCAVATION

A. **Pits and Trenches:** Excavate circular pits with sides sloped inward. Trim base leaving center area raised slightly to support root ball and assist in drainage. Do not further disturb base. Scatterly sides of plant pit smeared or smoothed during excavation. Excavate approximately three times as wide as ball diameter for balled and burlapped stock. If drain tile is shown or required under planted areas, excavate to top of porous backfill over tile.

B. **Subsoil removed from excavations may be used as backfill if mixed per details.**

C. **Obstructions:** Notify Owner's Representative if unexpected rock or obstructions detrimental to trees or shrubs are encountered in excavations.

D. **Drainage:** Notify Owner's Representative if subsoil conditions evidence unexpected water seepage or retention in tree or shrub pits.

E. **Fill excavations with water and allow to percolate away before positioning trees and shrubs.**

3.5 TREE AND SHRUB PLANTING

A. **Set balled and burlapped stock plumb and in center of pit or trench with top of root ball 1 inch above adjacent finish grades.**

Remove burlap and wire baskets from tops of root balls and partially from sides, but do not remove from under root balls. Remove pallets, if any, before setting. Do not use planting stock if root ball is cracked or broken before or during planting operation.

Place planting soil mix around root ball in layers, tamping to settle mix and eliminate voids and air pockets. When pit is approximately one-half backfilled, water thoroughly before placing remainder of backfill. Repeat watering until no more water is absorbed. Water again after placing and tamping final layer of planting soil mix.

B. **Set container-grown stock plumb and in center of pit or trench with top of root ball 1 inch above adjacent finish grades.**

Carefully remove root ball from container without damaging root ball or plant.  
Place planting soil mix around root ball in layers, tamping to settle mix and eliminate voids and air pockets. When pit is approximately one-half backfilled, water thoroughly before placing remainder of backfill. Repeat watering until no more water is absorbed. Water again after placing and tamping final layer of planting soil mix.

C. **Organic Mulching:** Apply 3-inch average thickness of organic mulch extending 12 inches beyond edge of planting pit or trench. Do not place mulch within 2 inches of trunks or stems.

D. **Wrap trees of 2-inch caliper and larger with trunk-wrap tape. Start at base of trunk and spiral cover trunk to height of first branches. Overlap wrap, exposing half the width, and securely attach without causing girdling. Inspect tree trunks for injury, improper pruning, and insect infestation; take corrective measures required before wrapping.**

3.6 TREE AND SHRUB PRUNING

A. **Prune trees and shrubs according to standard horticultural practice. Prune trees only to remove damaged or interfering branches. Prune shrubs to remove damaged or interfering branches or primary buds to encourage secondary growth. Retain height and spread. Unless otherwise indicated by Owner's Representative, do not cut tree leaders. Prune shrubs to retain natural character. Shrub sizes indicated are sizes after pruning.**

3.7 GUYING AND STAKING

A. **Upright Staking and Tying:** Stake trees of 2- through 5-inch caliper. Stake trees of less than 2-inch caliper only as required to prevent wind tip-out. Use a minimum of 2 stakes of length required to penetrate at least 18 inches below bottom of backfilled excavation and to extend at least 72 inches above grade. Set vertical stakes and space to avoid penetrating root balls or root masses. Support trees with two strands of tie wire encased in hose sections at contact points with tree trunk. Allow enough slack to avoid rigid restraint of tree. Use the number of stakes as follows:  
Use 2 stakes for trees up to 12 feet high and 2-12 inches or less in caliper; 3 stakes for trees less than 14 feet high and 3 inches in caliper or more. Space stakes equally around trees.  
Attach flags to each guy wire, 30 inches above finish grade.

3.8 ORNAMENTAL GRASSES AND PERENNIAL PLANTING

A. **Set out and space plants as indicated.**

B. **Dig holes large enough to allow spreading of roots, and backfill with planting soil.**

C. **Work soil around roots to eliminate air pockets and leave a slight saucer indentation around plants to hold water.**

D. **Water thoroughly after planting, taking care not to cover plant crowns with wet soil.**

3.9 PLANTING BED MULCHING

A. **Mulch backfilled surfaces of planting beds and other areas indicated.**  
Organic Mulch: Apply 3-inch average thickness of organic mulch, and finish level with adjacent finish grades. Do not place mulch against plant stems.

3.10 EDGING INSTALLATION

A. **Shovel cut natural edge. Maintain two times per season.**

3.11 CLEANUP AND PROTECTION

A. **During exterior planting, keep adjacent pavings and construction clean and work area in an orderly condition.**

B. **Protect exterior plants from damage due to landscape operations, operations by other contractors and trades, and others. Maintain protection during installation and maintenance periods. Treat, repair, or replace damaged exterior planting.**

3.12 DISPOSAL

A. **Disposal:** Remove surplus soil and waste material, including excess subsoil, unsuitable soil, trash, and debris, and legally dispose of them off Owner's property.

REVISIONS	DATE	#	ITEM
	4/01/2025		REVIEW
	5/05/2025		REVIEW
	5/20/2025		REVIEW
	7/8/2025		REVIEW
	7/29/2025		REVIEW
	11/13/2025		REVIEW
	1/09/2026		REVIEW
	2/18/2026		REVIEW
	4/10/2026		REVIEW

  
 Landscape Architecture  
 Urban Design  
 Planning  
 Environmental Graphics  
**place**  
 W O R K S H O P  
293 East Fifth Street, 15th Floor PMB #648 • Cincinnati, Ohio 45202 • +1 513.121.2395 • www.placeworkshop.com

**PROJECT:** OPTIMIST PARK CONCEPT PLAN SOUTHGATE, KENTUCKY  
**CLIENT:** SOUTHBANK PARTNERS  

**FOR REVIEW ONLY**  
**PRELIMINARY NOT RELEASED FOR CONSTRUCTION**

DRAWN BY: KBO	SEAL
CHECKED BY: KBO	
PROJECT MANAGER: KBO	
PROJECT NO. 2510	
SCALE N.T.S.	
DATE 04-10-26	
NOTES	
SHEET <b>L-3</b>	