

THE VILLAGE OF ORWELL

PENNIMAN ROAD PAVEMENT IMPROVEMENTS

ASHTABULA COUNTY, OHIO

MAY 2025

ADMINISTRATION:

KIMBERLY MCKINLEY	FINANCE DIRECTOR
BERT CARLSON	SENIOR ADMINISTRATIVE ASSISTANT/DEPUTY CLERK
SHANE GREGORY	STREET DEPARTMENT SUPERINTENDENT

COUNCIL MEMBERS:

CHRIS RUKS	PRESIDENT OF COUNCIL
DAVID HARTZ	VICE PRESIDENT OF COUNCIL
JEREMY COTTRELL	COUNCIL MEMBER
BOB DENIHAM	COUNCIL MEMBER
ROBERTA COZAD	COUNCIL MEMBER

OHIO 811 DESIGN SERIAL NUMBER & UTILITY LIST:

WATER/SANITARY SEWER: VILLAGE OF ORWELL WATER & SEWER DIVISION 179 W. MAIN STREET ORWELL, OHIO 44076 P.O. BOX 354 PHONE: 440-437-6459	NORTHEAST OHIO NATURAL GAS CORP: 8470 STATION STREET MENTOR, OHIO 44060 CONTACT: TIM REILLY PHONE: 440-701-5100 treilly@neogas.com	HANSON COMMUNICATIONS: 7820 DIVISION DRIVE WAPAKONETA, OHIO 45895 CONTACT: KEVIN WOLFE PHONE: 440-437-6117 Kevin.Wolfe@telserco.com
--	---	--

STORM SEWER: VILLAGE OF ORWELL STREET DEPARTMENT 179 W. MAIN STREET ORWELL, OHIO 44076 P.O. BOX 354 PHONE: 440-321-0700	FIRST ENERGY CORP.: 76 S. MAIN STREET AKRON, OHIO 44308 PHONE: 800-633-4766
--	--



- UNDERGROUND BUILDING SERVICE UTILITY LINES ARE NOT SHOWN ON THE PLANS. THE CONTRACTOR SHALL BE RESPONSIBLE FOR LOCATING, MAINTAINING AND REPLACING AS NECESSARY TO ENSURE CONTINUAL SERVICE TO BUILDINGS.
- THE CONTRACTOR IS RESPONSIBLE TO CALL OHIO UTILITIES PROTECTION SERVICE @ 1-800-362-2764, THREE WORKING DAYS PRIOR TO CONSTRUCTION.

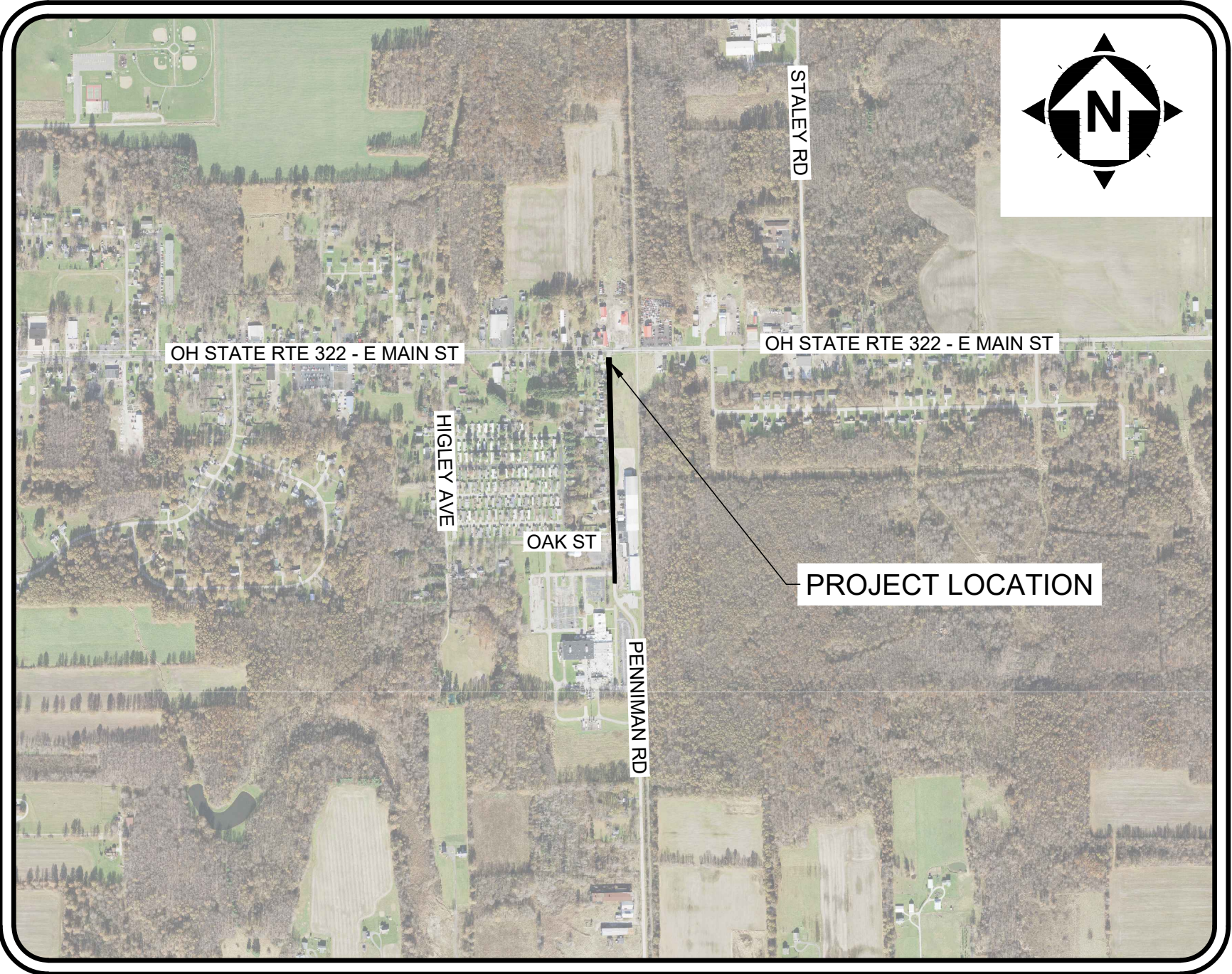

LOCATION MAP
1" = 1000'

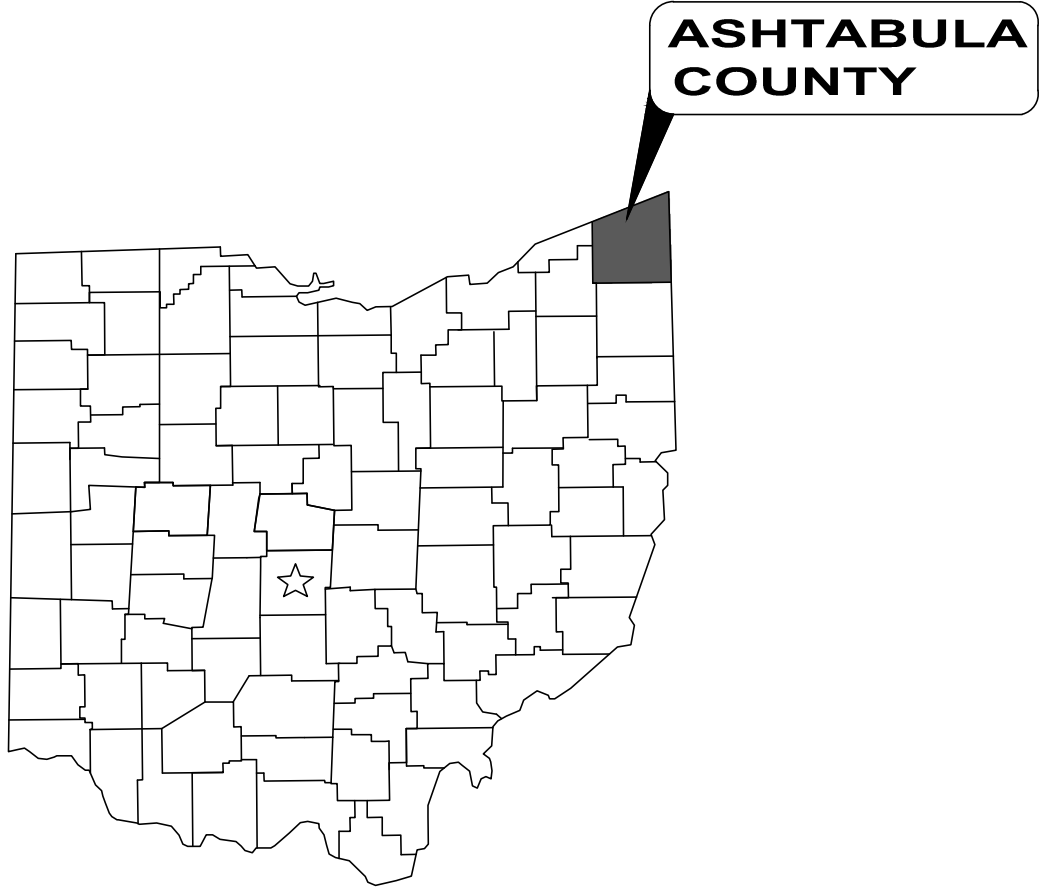

APPROVALS:

Shane Gregory
SHANE GREGORY STREET DEPARTMENT SUPERINTENDENT
4-30-25
DATE

OFFICE:

VILLAGE OF ORWELL ADMINISTRATIVE BUILDING
179 WEST MAIN STREET
ORWELL, OHIO 44076
PHONE: (440) 437-6450

DEPARTMENTS:

VILLAGE OF ORWELL ROADWAY DEPARTMENT

SHANE GREGORY - STREET DEPT. SUPERINTENDENT
PHONE: (440) 321-0700

ENGINEER:

VERDANTAS,LLC
8150 STERLING COURT
MENTOR, OH 44060

(440) 951-9000 PHONE
(440) 951-7487 FAX

PROJECT SITE:

THE PROJECT CONSISTS OF A MILL & FILL ON PENNIMAN RD IN ORWELL, OH. THE PROJECT BEGINS JUST SOUTH OF THE DRIVE APRON OF PARCEL 39-013-4001000 AT 180 PENNIMAN RD. THE PROJECT ENDS APPROXIMATELY 140 FT SOUTH OF THE INTERSECTION OF PENNIMAN RD AND STATE ROUTE 322.

Patrick Blake

PATRICK A. BLAKE

P.E. No. 88436

5/05/2025

DATE

ENGINEER'S PROJECT No. 31849

THE VILLAGE OF ORWELL

PENNIMAN ROAD PAVEMENT IMPROVEMENTS

ASHTABULA COUNTY

ORWELL, OH

ISSUED FOR:	BID
ISSUE DATE:	04/24/2025
SCALE:	AS SHOWN
SHEET SIZE:	34x22"
DESIGNED BY:	SNK
CHECKED BY:	PAB

COVER SHEET

PROJECT NO.	
31849	
DISCIPLINE	
CIVIL	
SHEET NAME	
COVER	
SHEET	OF
1	6

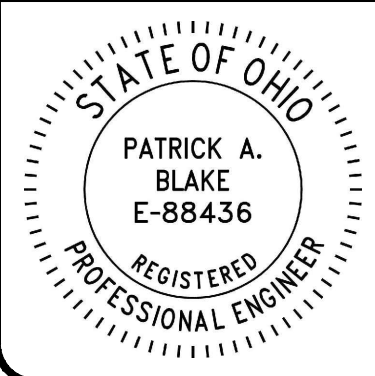

verdantas

GENERAL:

1. A PRE-CONSTRUCTION CONFERENCE SCHEDULED BY THE ENGINEER SHALL BE HELD PRIOR TO ANY WORK STARTING. IN ADDITION, THE CONTRACTOR SHALL PROVIDE 48 HOURS NOTICE TO THE ENGINEER AND THE OWNER PRIOR TO BEGINNING WORK TO ARRANGE FOR INSPECTION.
2. THE CONTRACTOR SHALL BE RESPONSIBLE FOR ALL CONSTRUCTION STAKEOUT/LAYOUT AND SHALL NOTIFY THE ENGINEER, IN WRITING, OF ANY DISCREPANCIES.
3. NO WORK SHALL COMMENCE WITHOUT AN EXECUTED NOTICE TO PROCEED.
4. THE CONTRACTOR SHALL BE SOLELY RESPONSIBLE FOR COMPLYING WITH OSHA SAFETY REQUIREMENTS. THE CONTRACTOR SHALL BE RESPONSIBLE FOR THE SAFETY OF ALL VISITORS, EMPLOYEES AND WORKERS ON THE CONSTRUCTION SITE.
5. THE CONTRACTOR SHALL CONSTRUCT THIS PROJECT IN COMPLIANCE WITH FEDERAL, STATE AND LOCAL BUILDING CODES.
6. ALL EXCAVATIONS ARE TO BE SECURED AND PROTECTED AT ALL TIMES.
7. MANHOLES, CATCH BASINS, MONUMENT BOXES, WATER VALVE BOXES AND OTHER CASTINGS WITHIN THE ROADWAY AREA OF SHALL BE PROTECTED FROM CHIP SEAL AND FOG EMULSION MATERIAL PLACEMENT. PAYMENT FOR THIS WORK SHALL BE INCLUDED IN THE UNIT PRICE BID FOR OTHER ITEMS OF WORK EXCEPT WHEN BID AS A SEPARATE ITEM.
8. ALL SEDIMENT AND EROSION CONTROL PRACTICES SHALL BE THE SOLE RESPONSIBILITY OF THE CONTRACTOR AS PER ODOT ITEM 832.
9. ANY DISTURBED AREAS NOT SCHEDULED FOR CONSTRUCTION ACTIVITIES WITHIN SIXTY DAYS OF DISTURBANCE SHALL BE TEMPORARILY STABILIZED.
10. ALL POLLUTANTS OTHER THAN SEDIMENT THAT OCCUR ON-SITE DURING CONSTRUCTION SHALL BE HANDLED AND LEGALLY DISPOSED OF IN A MANNER THAT DOES NOT CAUSE CONTAMINATION OF STORM OR SURFACE WATERS. POLLUTANTS OF CONCERN INCLUDE, BUT ARE NOT LIMITED TO, FUELS, LUBRICANTS, SOLVENTS, CONCRETE BI-PRODUCTS AND CONSTRUCTION MATERIALS.
11. THE CONTRACTOR SHALL BE SOLELY RESPONSIBLE FOR THE SECURITY OF ALL STORED MATERIALS.
12. THE CONTRACTOR SHALL BE RESPONSIBLE FOR MAINTAINING A SET OF PROJECT RECORD DOCUMENTS. THESE DOCUMENTS SHALL INCLUDE REVIEWED SHOP DRAWINGS, CHANGE ORDERS, EQUIPMENT OPERATING INSTRUCTIONS, FIELD TEST RECORDS, AND AS BUILT DRAWINGS. THE AS BUILT DRAWINGS SHALL BE MARKED LEGIBLY IN RED WITH THE ACTUAL LOCATION OF EQUIPMENT AND CONDUITS AS CONSTRUCTED.

STANDARD SPECIFICATIONS:

1. THE "CONSTRUCTION AND MATERIAL SPECIFICATIONS" OF THE STATE OF OHIO DEPARTMENT OF TRANSPORTATION (ODOT), 2023 EDITION, CURRENT ODOT SUPPLEMENTAL SPECIFICATIONS, AND CURRENT ODOT STANDARD DRAWINGS SHALL GOVERN WORK AND MATERIALS WHICH ARE NOT SPECIFIED OR MODIFIED HEREIN OR ON THE PROJECT CONTRACT DRAWINGS. ALL REFERENCES TO "THE DEPARTMENT" SHALL BE CHANGED TO "THE OWNER OR HIS REPRESENTATIVE." THE PROJECT CONTRACT DRAWINGS AND SPECIFICATIONS, IN THE EVENT OF A DISCREPANCY, SHALL SUPERSEDE THE ODOT SPECIFICATIONS.

EXISTING UTILITIES:

1. THE CONTRACTOR SHALL VERIFY THE LOCATIONS OF ALL PUBLIC AND PRIVATE UTILITIES WHICH MAY BE AFFECTED BY THE CONSTRUCTION. THE LOCATION OF UTILITIES AND STRUCTURES, BOTH SURFACE AND SUBSURFACE, ARE SHOWN ON THE DRAWINGS FROM RECORD DATA AVAILABLE FROM THE VILLAGE AND ARE NOT NECESSARILY COMPLETE OR CORRECT. THE EXACT LOCATION AND PROTECTION OF UTILITIES AND STRUCTURES ARE THE RESPONSIBILITY OF THE CONTRACTOR. CONTRACTOR TO CALL OUPS (1-800-362-2764) *48 HOURS BEFORE YOU DIG* AND CALL OIL & GAS PRODUCERS PROTECTIVE (1-800-925-0988). CONTRACTOR ALSO TO COORDINATE HIS WORK WITH THE UTILITIES LISTED ON THIS SHEET. NEITHER THE OWNER NOR THE ENGINEER ENSURES THEIR ACCURACY OR COMPLETENESS.
2. THE CONTRACTOR SHALL NOTIFY UTILITY COMPANIES AT LEAST THREE DAYS, EXCLUDING SATURDAYS, SUNDAYS AND LEGAL HOLIDAYS, PRIOR TO CONSTRUCTION TO HAVE UTILITIES STAKED, MARKED OR OTHERWISE DESIGNATED IN THE CONSTRUCTION AREA IN SUCH A MANNER; OR LOCATING SHALL BE COORDINATED TO STAY 48 HOURS AHEAD OF THE PLANNED CONSTRUCTION.
3. CONTRACTOR SHALL VERIFY THE LOCATION AND ELEVATION OF ALL THE EXISTING UNDERGROUND UTILITIES PRIOR TO THE INSTALLATION OF ANY PROPOSED IMPROVEMENT INDICATED ON THE PLANS. SHOULD A CONFLICT EXIST AT A UTILITY CROSSING, THE CONTRACTOR SHALL NOTIFY THE PROJECT ENGINEER IMMEDIATELY.
4. IN THE EVENT OF DAMAGE TO EXISTING PUBLIC AND/OR PRIVATE UTILITIES, THE AGENCY CONCERNED SHALL BE NOTIFIED IMMEDIATELY AND ALL REPAIR WORK SHALL BE EXECUTED IN ACCORDANCE WITH THE SPECIFICATIONS OF THE RESPECTIVE AGENCY AT NO ADDITIONAL EXPENSE TO THE OWNER INCLUDING ANY INSPECTION FEES OR MAINTENANCE CREWS. CABLE RELOCATION AND SUPPORT COST SHALL BE INCLUDED IN OTHER BID ITEMS.
5. WHERE EXISTING POWER OR TELEPHONE POLES ARE IN CLOSE PROXIMITY TO WORK, THE CONTRACTOR SHALL COORDINATE HIS WORK EFFORTS WITH THOSE OF THE UTILITY COMPANIES SUCH THAT THEIR EXISTING FACILITIES CAN BE MAINTAINED AND PROTECTED DURING THE TIME WORK IS GOING ON ADJACENT TO THE POLE. THE COST FOR ANY REQUIRED PROTECTION OR RELOCATION OF EXISTING POWER OR TELEPHONE POLES SHALL BE THE RESPONSIBILITY OF THE CONTRACTOR AND NOT BE THE RESPONSIBILITY OF THE OWNER.
6. DELAYS TO THE CONTRACTOR AS RESULT OF TIMING OF UTILITY RELOCATIONS OR PROTECTION SHALL NOT BE CONSIDERED COMPENSABLE DELAYS, AS IT SHALL BE THE CONTRACTOR'S RESPONSIBILITY TO COORDINATE HIS WORK WITH THE UTILITY COMPANY'S SCHEDULE.
7. SHOULD IT BECOME NECESSARY TO CHANGE THE POSITION OR TEMPORARILY REMOVE ANY STORM DRAIN, SANITARY SEWER, ELECTRIC CONDUITS, WATER PIPES, GAS PIPES, PROCESS OR OTHER PIPES IN ORDER TO PERMIT THE CONTRACTOR TO USE A PARTICULAR METHOD OF CONSTRUCTION OR IN ORDER TO CLEAR THE STRUCTURES BEING BUILT, THE CONTRACTOR SHALL NOTIFY THE ENGINEER OF THE LOCATION AND CIRCUMSTANCES AND SHALL CEASE WORK, IF NECESSARY, UNTIL SATISFACTORY ARRANGEMENTS HAVE BEEN MADE BY THE OWNERS OF SAID PIPES OR WIRES TO PROPERLY CARE FOR THE SAME. NO CLAIMS FOR DAMAGES WILL BE ALLOWED ON ACCOUNT OF ANY DELAY OCCASIONED THEREBY. THE ENTIRE COST OF THE CHANGES OR TEMPORARY REMOVAL MUST BE INCLUDED IN THE PRICES STIPULATED FOR THE VARIOUS ITEMS OF WORK TO BE DONE UNDER THIS CONTRACT.
8. CONTRACTOR IS RESPONSIBLE FOR THE PRESERVATION OF ALL FENCES, RETAINING WALLS, STEPS, UTILITY POLES, MONUMENTS, UTILITY APPURTENANCES, SIGNAGE AND LANDSCAPE BEDS. IF DAMAGED, THE CONTRACTOR IS RESPONSIBLE FOR THE REPLACEMENT OF THESE ITEMS AT NO ADDITIONAL COST TO THE OWNER.

MATERIAL TESTING AND PERMITS:

1. THE CONTRACTOR SHALL BE RESPONSIBLE FOR THE COST OF ALL MATERIAL AND EQUIPMENT TESTING. THE CONTRACTOR SHALL BE RESPONSIBLE FOR OBTAINING ALL PERMITS REQUIRED FOR THIS PROJECT. THE EXECUTED PROJECT CONTRACT SHALL SERVE TO FULFILL THE VILLAGE OF ORWELL'S PERMITTING REQUIREMENTS.

MATERIAL DISPOSAL AND TEMPORARY SURFACES:

1. THE REMOVAL AND DISPOSAL OF ALL SURPLUS CONSTRUCTION DEBRIS SHALL BE THE RESPONSIBILITY OF THE CONTRACTOR FOR ULTIMATE DISPOSAL.
2. THE COST OF HEREIN DESCRIBED WORK, INCLUDING SEEDING AND MULCHING NECESSARY TO SECURE THESE RESULTS, SHALL BE CONSIDERED INCIDENTAL TO THE OTHER VARIOUS ITEMS OF WORK IN THIS CONTRACT AND INCLUDED IN THE RESPECTIVE PAY ITEMS. NO SEPARATE PAYMENT SHALL BE MADE.
3. TEMPORARY SURFACES WHERE EXCAVATION ARE LOCATED IN STREETS, DRIVES AND PARKING AREAS SHALL BE FURNISHED AND PLACED BY THE CONTRACTOR AND SHALL BE FULLY MAINTAINED TO MINIMIZE INCONVENIENCE TO THE PUBLIC AT NO ADDITIONAL COST TO THE OWNER.
4. THE ABOVE DESCRIBED WORK SHALL BE CONSIDERED INCIDENTAL TO THE COMPLETION OF ALL WORK AND INCLUDED IN THE RESPECTIVE PAY ITEMS AND SHALL NOT BE A SEPARATE PAY ITEM.
5. DUMP SITES MUST BE APPROVED BY THE OWNER.

USE OF PRIVATE PROPERTY:

1. THE CONTRACTOR CAN USE PRIVATE PROPERTY FOR THE STORAGE OF EQUIPMENT AND MATERIALS ONLY WITH A WRITTEN AGREEMENT WITH THE PROPERTY OWNER. THE CONTRACTOR SHALL PROVIDE THIS AGREEMENT TO THE ENGINEER PRIOR TO ANY USE OF PRIVATE PROPERTY.

RESTORATION:

1. CONTRACTOR SHALL RESTORE ANY DISTURBED AREAS CAUSED FROM CONSTRUCTION TO PRE-CONSTRUCTION CONDITIONS OR BETTER OR AS PER PLAN. FOR DISTURBED LAWN AREAS, THE CONTRACTOR SHALL INSTALL COMPACTED, SCREENED, IMPORTED TOPSOIL TO PROVIDE A SMOOTH TRANSITION FROM NEW OR EXISTING CURB OR SIDEWALK SURFACES TO THE NON-PAVED SURFACE.
2. THE COMPOSITION OF SEED MIXTURE SHALL CONFORM TO THE ODOT CMS STANDARDS FOR SEEDING.

DUST CONTROL:

1. WATER IS TO BE PROVIDED BY THE CONTRACTOR FOR USE AS DUST CONTROL, AS DIRECTED BY THE ENGINEER. NO SEPARATE PAYMENT WILL BE MADE.

NOISE CONTROL PRACTICES:

1. CONSTRUCTION ACTIVITIES WILL BE LIMITED TO WEEKDAY DAYTIME HOURS (7:00AM TO 5:00PM), UNLESS APPROVED IN ADVANCE BY THE OWNER.
2. CONSTRUCTION EQUIPMENT WILL BE PROVIDED WITH INTAKE SILENCERS AND MUFFLERS, AS REQUIRED BY SAFETY STANDARDS.
3. PERIODICALLY CHECK EQUIPMENT AND MACHINERY FOR PROPER TUNING TO MINIMIZE EXHAUST EMISSIONS AND NOISE.

TRAFFIC MAINTENANCE:

1. MAINTAINING TRAFFIC SHALL BE IN ACCORDANCE WITH ODOT ITEM 614 AND THE OHIO MANUAL OF UNIFORM TRAFFIC CONTROL DEVICES (OMUTCD).
2. IT WILL BE THE RESPONSIBILITY OF THE CONTRACTOR TO MAINTAIN SAFE LOCAL ACCESS, VEHICULAR AND PEDESTRIAN INCLUDING PERSONS WITH DISABILITIES, TO ALL PROPERTIES WITHIN THE PROJECT LIMITS. THE CONTRACTOR WILL FURNISH, MAINTAIN AND SUBSEQUENTLY REMOVE ALL NECESSARY SAFEGUARDS SUCH AS BARRICADES, BARRIERS, TEMPORARY PAVEMENT, LIGHTING, FLAGGERS, SIGNING, PAVEMENT MARKINGS AND OTHER TRAFFIC CONTROLS TO INSURE THE SAFETY OF PERSONS AND VEHICLES DURING CONSTRUCTION WITHIN THE PROJECT LIMITS.
3. AT ALL EXCAVATION LOCATIONS THE CONTRACTOR SHALL PROVIDE SUITABLE FLASHERS, BARRICADES, AND TRAFFIC CONTROL DEVICES AS DEEMED NECESSARY BY THE ENGINEER AND IN ACCORDANCE WITH THE MUTCD. SUCH TIME AS THE AREA IS COMPLETELY BACKFILLED.
4. ALL WORK AND TRAFFIC CONTROL DEVICES SHALL BE IN ACCORDANCE WITH ITEM 614 AND OTHER APPLICABLE PORTIONS OF THE SPECIFICATIONS, AS WELL AS THE OHIO MUTCD. PAYMENT FOR ALL LABOR, EQUIPMENT AND MATERIALS SHALL BE INCLUDED IN THE LUMP SUM CONTRACT PRICE FOR ITEM 614, MAINTAINING TRAFFIC, UNLESS SEPARATELY ITEMIZED IN THE PLAN.

MONUMENTS, PROPERTY CORNERS AND BENCHMARKS:

1. MONUMENTS, PROPERTY CORNER MARKERS AND BENCHMARKS SHALL NOT BE DISTURBED BY THE CONTRACTOR. IN THE EVENT THAT IT IS NECESSARY TO REMOVE MONUMENTS, PROPERTY CORNER MARKERS OR BENCHMARKS FOR THE CONSTRUCTION OF THE WORK, THE CONTRACTOR SHALL HAVE A REGISTERED LAND SURVEYOR PROPERLY REFERENCE THE POINTS AND SHALL HAVE SAME RESET AFTER THE CONSTRUCTION HAS PASSED THE AREA, AT NO ADDITIONAL COST TO THE OWNER.

ITEM SPECIFICATIONS

1. CONTINGENCY ITEM 253 PAVEMENT REPAIR, AS PER PLAN HAS BEEN ADDED AS A FULL DEPTH PAVEMENT REPAIR AS DIRECTED ITEM. THIS SHOULD ONLY BE COMPLETED AT THE DIRECTION OF THE ENGINEER AFTER PAVEMENT PLANING HAS OCCURRED.
2. ITEM 251 PARTIAL DEPTH PAVEMENT REPAIR, AS PER PLAN WILL BE MARKED BY THE ENGINEER/VILLAGE AFTER PAVEMENT PLANING HAS OCCURRED.

PROHIBITED CONSTRUCTION ACTIVITIES:

1. THE USE OF EXPLOSIVES, UNLESS A PERMIT IS ISSUED BY THE OWNER.
2. PUMPING OF SEDIMENT-LADEN WATER FROM TRENCHES OR OTHER EXCAVATIONS DIRECTLY INTO ANY SURFACE WATERS, STREAM CORRIDORS, OR STORM SEWERS; ALL SUCH WATER WILL BE PROPERLY FILTERED OR SETTLED TO REMOVE SILT PRIOR TO RELEASE.
3. DISCHARGING POLLUTANTS SUCH AS CHEMICALS, FUELS, LUBRICANTS, BITUMINOUS MATERIALS, RAW SEWAGE, OR ANY OTHER HARMFUL WASTE INTO OR ALONGSIDE OF RIVERS, STREAMS, IMPOUNDMENTS OR INTO NATURAL OR MAN-MADE CHANNELS LEADING THERETO.
4. OPEN BURNING OF PROJECT DEBRIS WITHOUT A PERMIT.
5. STORING CONSTRUCTION EQUIPMENT AND VEHICLES AND/OR STOCKPILING CONSTRUCTION MATERIALS ON PROPERTY, PUBLIC OR PRIVATE, NOT PREVIOUSLY SPECIFIED ON THE PLANS BY THE ENGINEER FOR SUCH PURPOSES.
6. RUNNING WELL POINT OR PUMP DISCHARGE LINES THROUGH PRIVATE OR PUBLIC PROPERTY AND RIGHTS-OF-WAY WITHOUT PERMISSION OF THE PROPERTY OWNER AND THE CONSENT OF THE ENGINEER.
7. OPERATION ENTAILING THE USE OF VIBRATORY HAMMERS OR COMPACTORS OUTSIDE THE HOURS OF 8:00 AM AND 5:00 PM OR OUTSIDE THE HOURS ALLOWED BY LOCAL ORDINANCES OR REGULATIONS.
8. CLOSING OFF CLEAR ACCESS TO ANY PUBLIC ALLEY, STREET, ROAD, AVENUE OR BOULEVARD WITHOUT THE PRIOR CONSENT OF MUNICIPAL OFFICIALS AND THE ENGINEER AND CLOSING CLEAR ACCESS:

BY FIRE PROTECTION EQUIPMENT AND EMERGENCY VEHICLES;

BY THE PUBLIC TO ANY COMMERCIAL OR PROFESSIONAL PLACE OF BUSINESS, QUASI-PUBLIC OR PUBLIC ESTABLISHMENT, OR PLACE OF RESIDENCE; OR

BY VEHICLES TO DRIVEWAYS WITHOUT THE PROVISION OF ALTERNATIVE MEANS OF BUILDING INGRESS AND EGRESS.

SHEET LIST	
SHEET NUMBER	SHEET NAME
1	COVER SHEET
2	GENERAL NOTES
3-4	PLAN
5	MAINTENANCE OF TRAFFIC
6	CONSTRUCTION DETAILS

THE VILLAGE OF ORWELL

PENNIMAN ROAD PAVEMENT IMPROVEMENTS

ASHTABULA COUNTY

ORWELL, OH

ISSUED FOR:	BID
ISSUE DATE:	04/24/2025
SCALE:	AS SHOWN
SHEET SIZE:	34x22"
DESIGNED BY:	SNK
CHECKED BY:	PAB

GENERAL NOTES

PROJECT NO.	
31849	
DISCIPLINE	
CIVIL	
SHEET NAME	
GN	
SHEET	OF
2	6

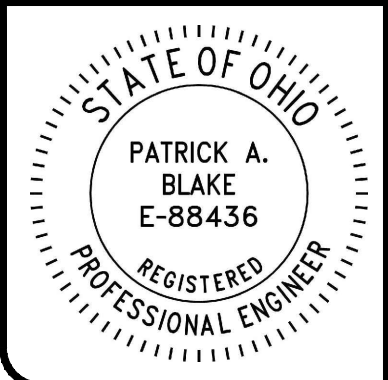

NO	REVISION	DATE

LEGEND:

3" OF EX. ASPHALT PAVEMENT PLANING

TRACKLESS TACK COAT APPLIED AT 0.1 GAL/SY

1.75" ASPHALT CONCRETE INTERMEDIATE COURSE, TYPE 2, (448)

TRACKLESS TACK COAT APPLIED AT 0.1 GAL/SY

1.25" ASPHALT CONCRETE SURFACE COURSE, TYPE 1, (448) PG64-22

IP

INLET PROTECTION

TYPE "F" GRAVEL DRIVE APRON,
RESTORE PER DETAIL

ODOT ITEM 617 -RECONDITIONING
SHOULDER (SHOULDER PREPARATION
AND 3" THICK ODOT #304 COMPACTED
AGGREGATE AND 2' TYP. WIDTH FROM
THE EDGE OF PAVEMENT, VARIED
EXTENTS AS MARKED IN THE FIELD BY
THE VILLAGE OF ORWELL)

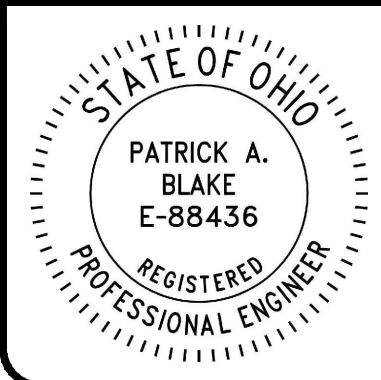
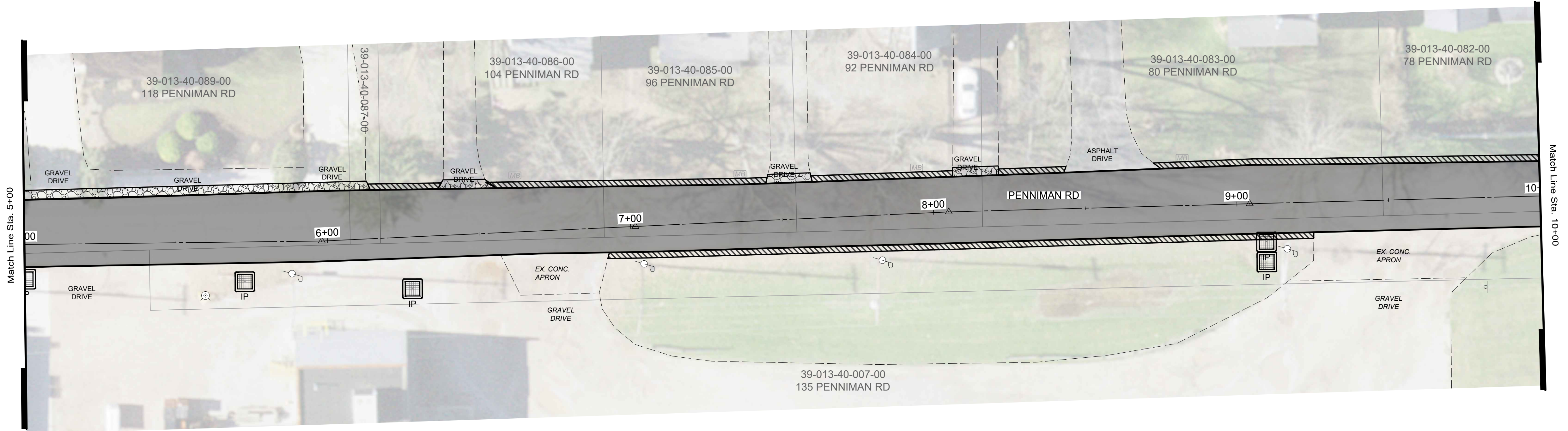
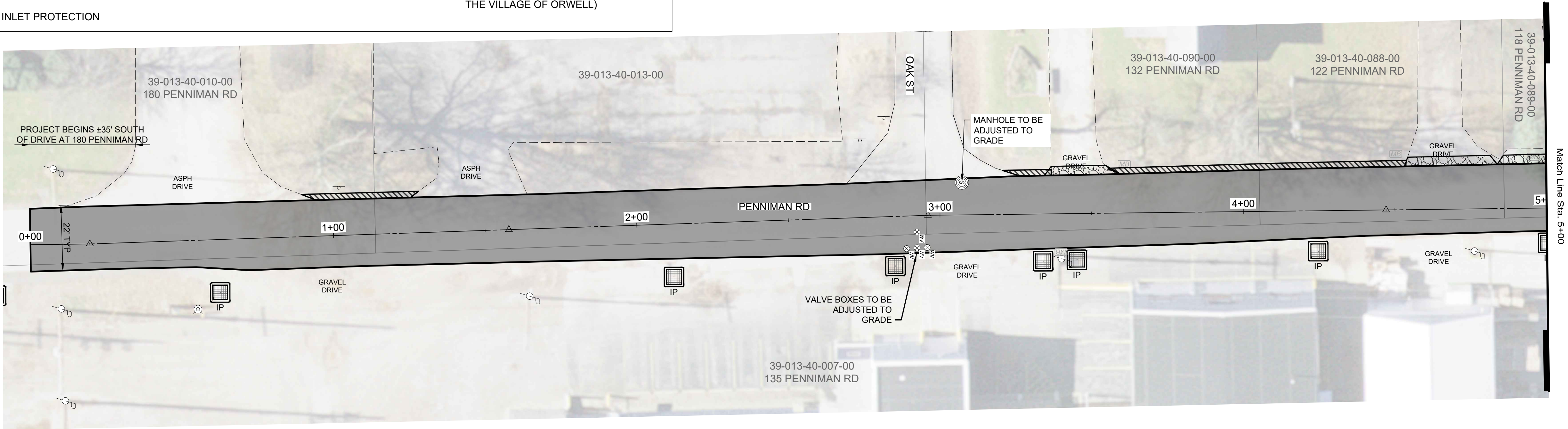
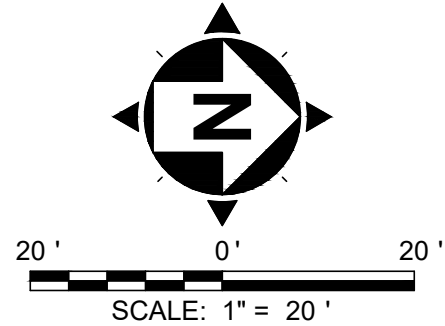

NO	REVISION	DATE

THE VILLAGE OF ORWELL

PENNIMAN ROAD PAVEMENT IMPROVEMENTS

ASHTABULA COUNTY

ORWELL, OH

ISSUED FOR:	BID
ISSUE DATE:	04/24/2025
SCALE:	AS SHOWN
SHEET SIZE:	34x22"
DESIGNED BY:	SNK
CHECKED BY:	PAB

PLAN

STA 0+00 TO 10+00

PROJECT NO.	
31849	
DISCIPLINE	
CIVIL	
SHEET NAME	
P-1	
SHEET	OF
3	6

LEGEND:

3" OF EX. ASPHALT PAVEMENT PLANING

TRACKLESS TACK COAT APPLIED AT 0.1 GAL/SY

1.75" ASPHALT CONCRETE INTERMEDIATE COURSE, TYPE 2, (448)

TRACKLESS TACK COAT APPLIED AT 0.1 GAL/SY

1.25" ASPHALT CONCRETE SURFACE COURSE, TYPE 1, (448) PG64-22

IP

INLET PROTECTION

TYPE "F" GRAVEL DRIVE APRON, RESTORE PER DETAIL

ODOT ITEM 617 -RECONDITIONING SHOULDER (SHOULDER PREPARATION AND 3" THICK ODOT #304 COMPACTED AGGREGATE AND 2' TYP. WIDTH FROM THE EDGE OF PAVEMENT, VARIED EXTENTS AS MARKED IN THE FIELD BY THE VILLAGE OF ORWELL)

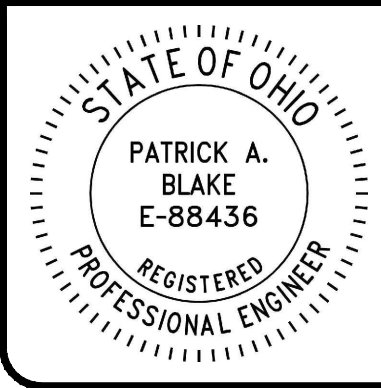
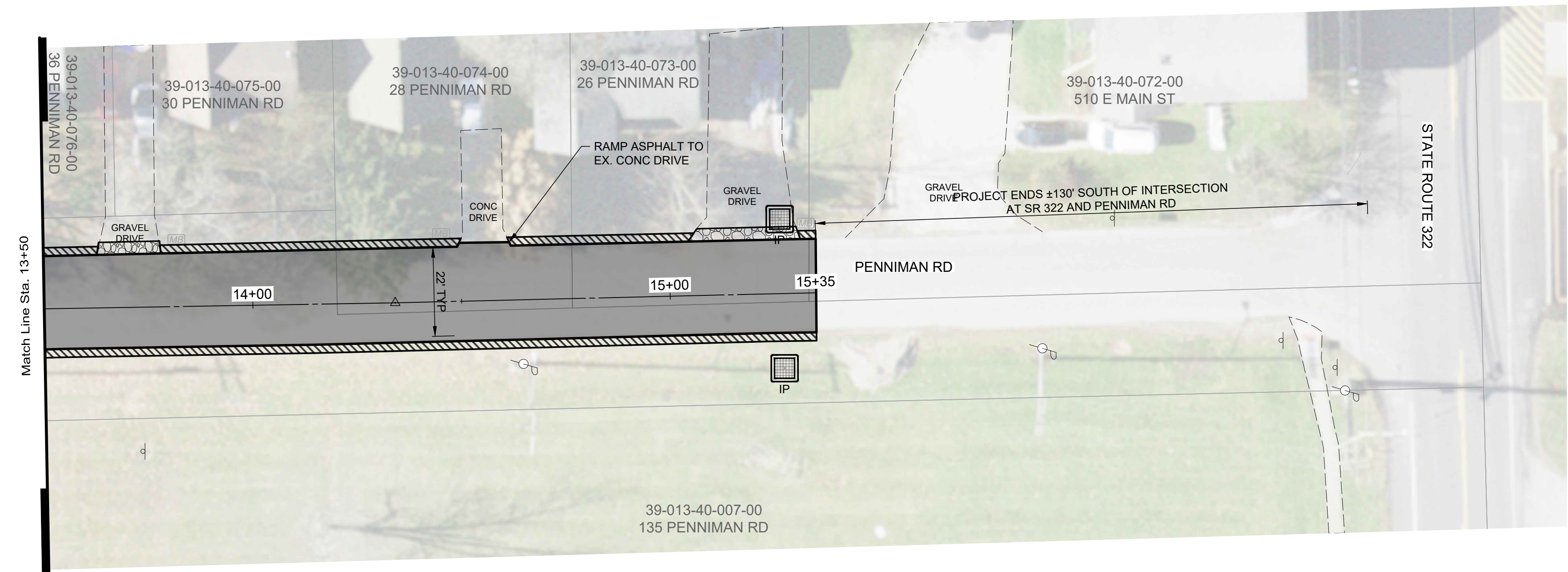
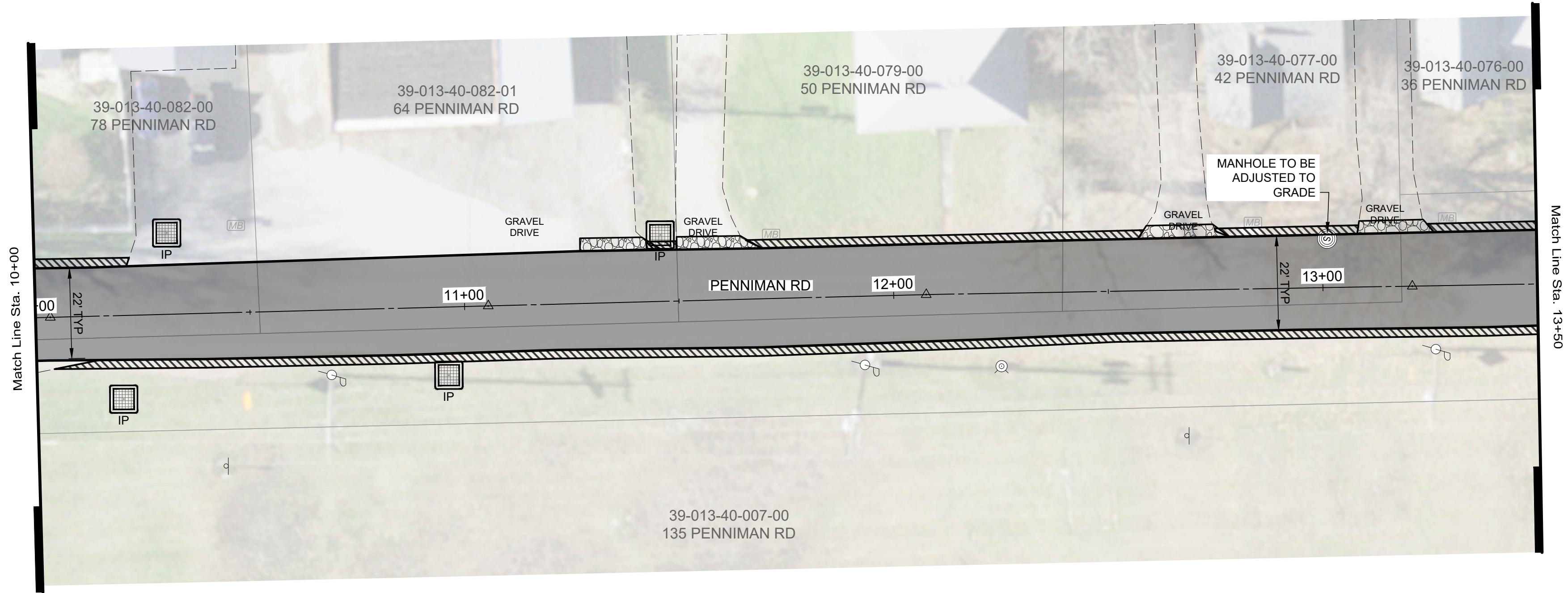
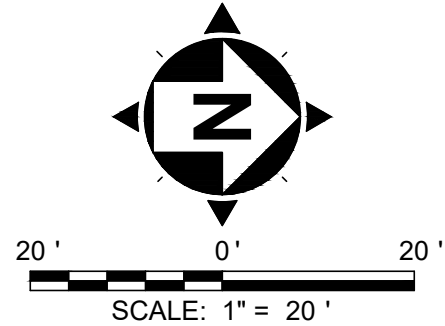

NO	REVISION	DATE

THE VILLAGE OF ORWELL

PENNIMAN ROAD PAVEMENT IMPROVEMENTS

ASHTABULA COUNTY

ORWELL, OH

ISSUED FOR:	BID
ISSUE DATE:	04/24/2025
SCALE:	AS SHOWN
SHEET SIZE:	34x22"
DESIGNED BY:	SNK
CHECKED BY:	PAB

PLAN

STA 10+00 TO END

PROJECT NO.	
31849	
DISCIPLINE	
CIVIL	
SHEET NAME	
P-2	
SHEET	OF
4	6

NOTES:

FLAGGERS

1. Flaggers, one for each direction, shall be used to control traffic continuously for as long as a one lane operation is in effect. The flaggers shall be able to communicate with each other at all times.

LENGTH OF CLOSURE

2. It is required that the length of closure be kept to a minimum at all times, as directed by the Engineer, with a maximum allowable length of 5000'.

When the ambient temperature exceeds 80 degrees Fahrenheit the Engineer may increase the maximum allowable length of closure to allow for sufficient cooling of new pavement.

The Engineer may shorten the maximum allowable length of closure to relieve excessive traffic backups or to improve traffic operation.

SIGN LOCATION AND SPACING

- 3A. The minimum spacing between work zone signs is shown in Table I. Maximum spacing should not be greater than 1.5 times the distances shown in Table I.
- 3B. Sign spacing should be adjusted to avoid conflict with existing signs. Minimum spacing to existing signs shall be 200' for speeds of 45 mph or less and a minimum of 400' for speeds of 50 mph or greater.
- 3C. The location of the advance warning signs should be adjusted to provide for adequate sight distance for the existing vertical and horizontal roadway alignment.

ADJUSTMENTS FOR SIGHT DISTANCE

4. The location of the flagger station and the advance warning signs should be adjusted to provide for adequate sight distance for the existing vertical and horizontal roadway alignment.

BASIC SIGNING

- 5A. ROAD WORK AHEAD (W20-1) signs shall be provided on entrance ramps or roadways entering the work limits.
- 5B. END ROAD WORK (G20-2) signs are only required for lane closures of more than 1 day. If is intended that these signs be placed on the mainline, on all exit ramps, and on roadways exiting the work limits.
- 5C. Overlapping of signing for adjacent projects should be avoided where the messages could be confusing. Any ROAD WORK AHEAD or END ROAD WORK sign which falls within the limits of another traffic control zone shall be omitted or covered during the period when both projects are active.

SIGNING DETAILS

- 6A. The Advisory Speed (W13-1P) plaque shall be used when specified in the plan.
- 6B. 36" warning signs may be used when the approach speed limit is 40 mph or less.

FLASHING WARNING LIGHTS

7. Type A flashing warning lights shown on the ROAD WORK AHEAD (W20-1) signs and on the LANE CLOSED AHEAD (W20-5) signs are required whenever a night lane closure is necessary.

CONES

- 8A. Cone spacing shall be as follows:
- a) Spacing along the buffer shall be 40' center-to-center.
- b) Spacing along the approach taper shall be 10' center-to-center.
- 8B. Cone sizes shall be as follows:
- a) Cones used for daytime traffic control shall have a minimum height of 28".
- b) Cones used for nighttime traffic control shall have a minimum height of 42".
- 8C. Provisions shall be made to stabilize the cones to prevent them from blowing over.
- 8D. A minimum of two cones shall be used to close the paved shoulder.

(RESERVED FOR FUTURE USE)

- 9A. (intentionally blank)

AREA ILLUMINATION

- 10A. Adequate area illumination of each flagger station shall be provided at night. Use of portable flood lighting is acceptable.
- 10B. To ensure the adequacy of floodlight placement and the elimination of glare, the Contractor and the Engineer shall drive through the worksite each night when the lighting is in place. Light placement and shielding shall be adjusted to the satisfaction of the Engineer.

INTERSECTION / DRIVEWAY ACCESS

11. Within the length of closure, provision shall be made to control traffic entering from intersecting streets and major drives as necessary to prevent wrong-way movements and to keep vehicles off of new pavement not ready for traffic. The Contractor shall:
- a) Place across the closed lane, either three cones or barricades, and/or
- b) Provide an additional flagger at every public street intersection and major driveway.

Cones placed across the closed lane shall be located 25' beyond the projected pavement edges of the driveway or cross highway. For barricades, see Standard Construction Drawing MT-101.60.

Existing STOP signs shall be relocated as necessary to assure proper location for the traffic conditions.

The method of control shall be subject to the approval of the Engineer.

CHIP SEAL OPERATION

12. For chip seal operations, additional signing shall be incorporated in accordance with CMS 422.09.

TABLE I (SIGN SPACING)

ROAD TYPE	DISTANCE BETWEEN SIGNS (FT)		
	A	B	C
Two Lane ≤ 40 MPH	100	100	100
Two Lane 45-50 MPH	350	350	350
Two Lane 55-60 MPH	500	500	500

TABLE II

SPEED LIMIT (MPH)	BUFFER (D) (FT) MIN.
25	155
30	200
35	250
40	305
45	360
50	425
55	495
60	570

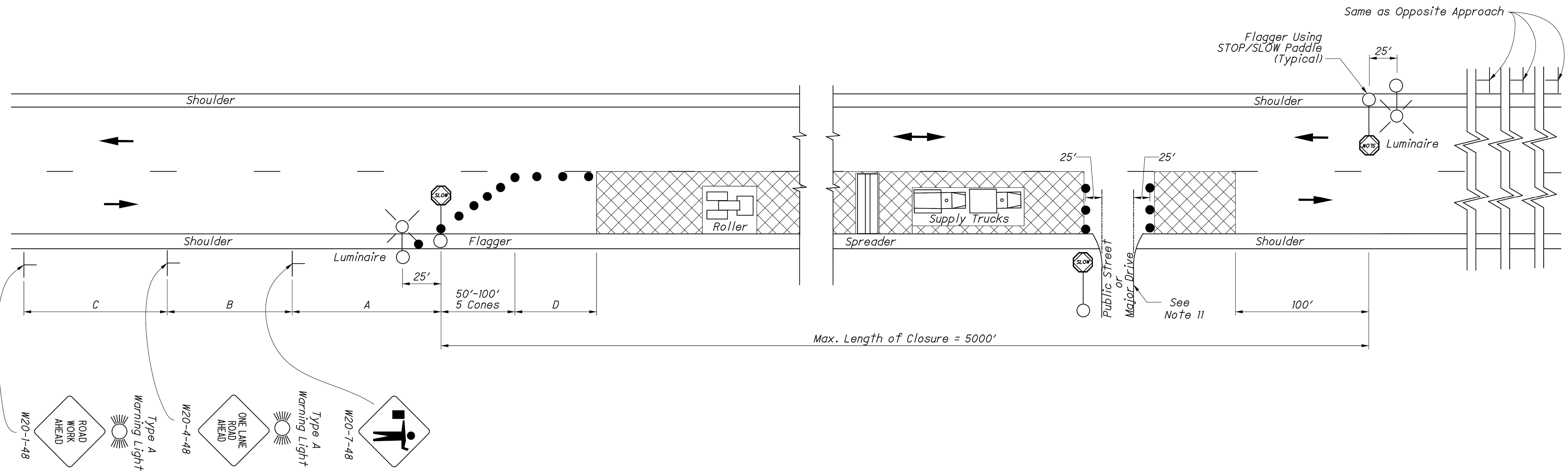

LEGEND

WORK AREA	
CONES	
DIRECTION OF TRAVEL	

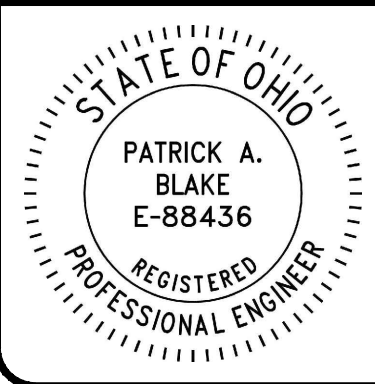

NO	REVISION	DATE

THE VILLAGE OF ORWELL

PENNIMAN ROAD PAVEMENT IMPROVEMENTS

ASHTABULA COUNTY

ORWELL, OH

ISSUED FOR:	BID
ISSUE DATE:	04/24/2025
SCALE:	AS SHOWN
SHEET SIZE:	34x22"
DESIGNED BY:	SNK
CHECKED BY:	PAB

MAINTENANCE OF TRAFFIC

PROJECT NO.	
31849	
DISCIPLINE	
CIVIL	
SHEET NAME	
MOT	
SHEET	OF
5	6

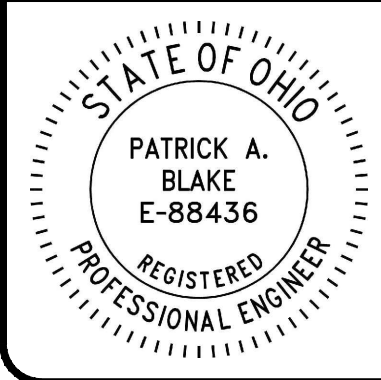
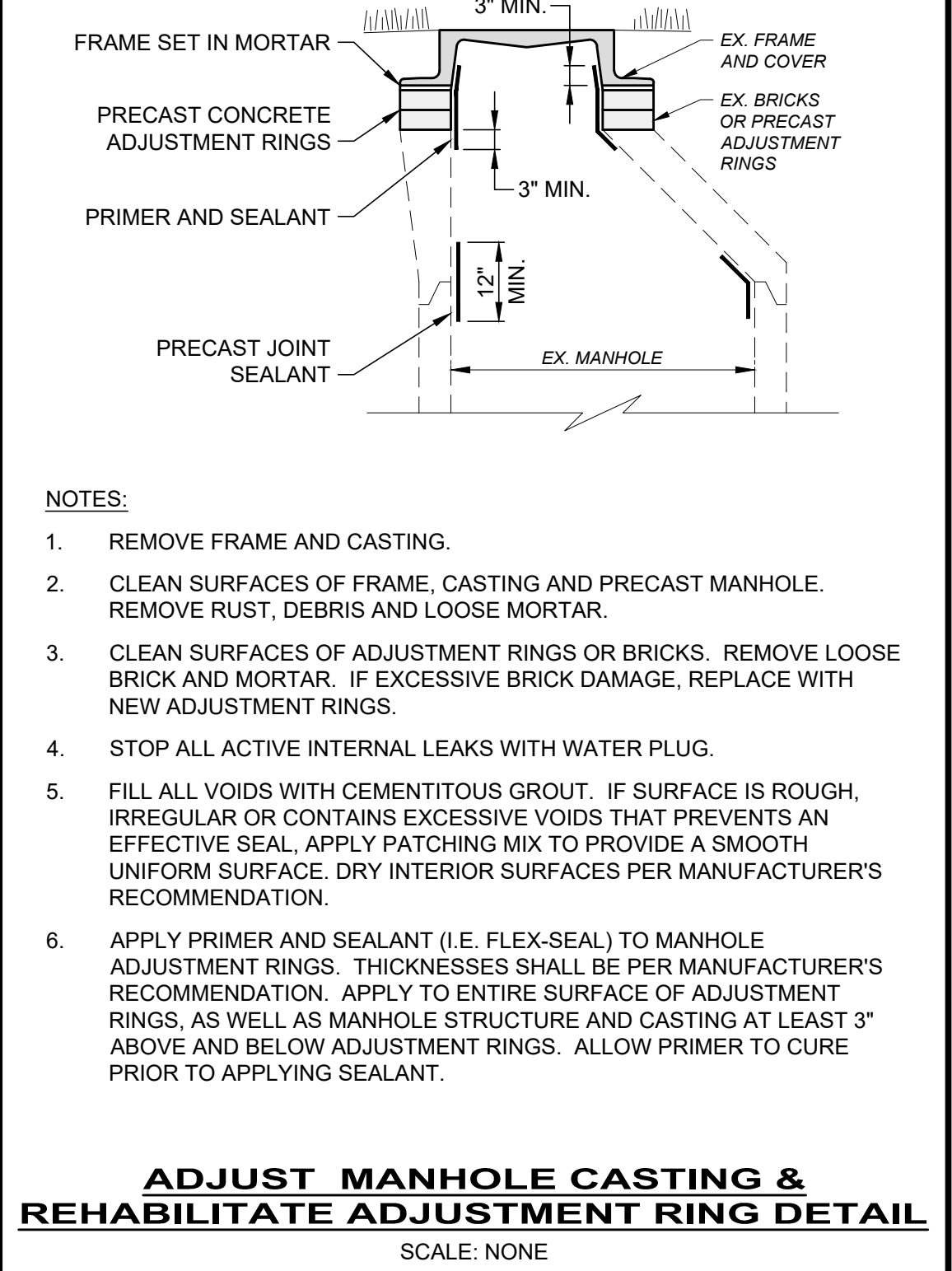
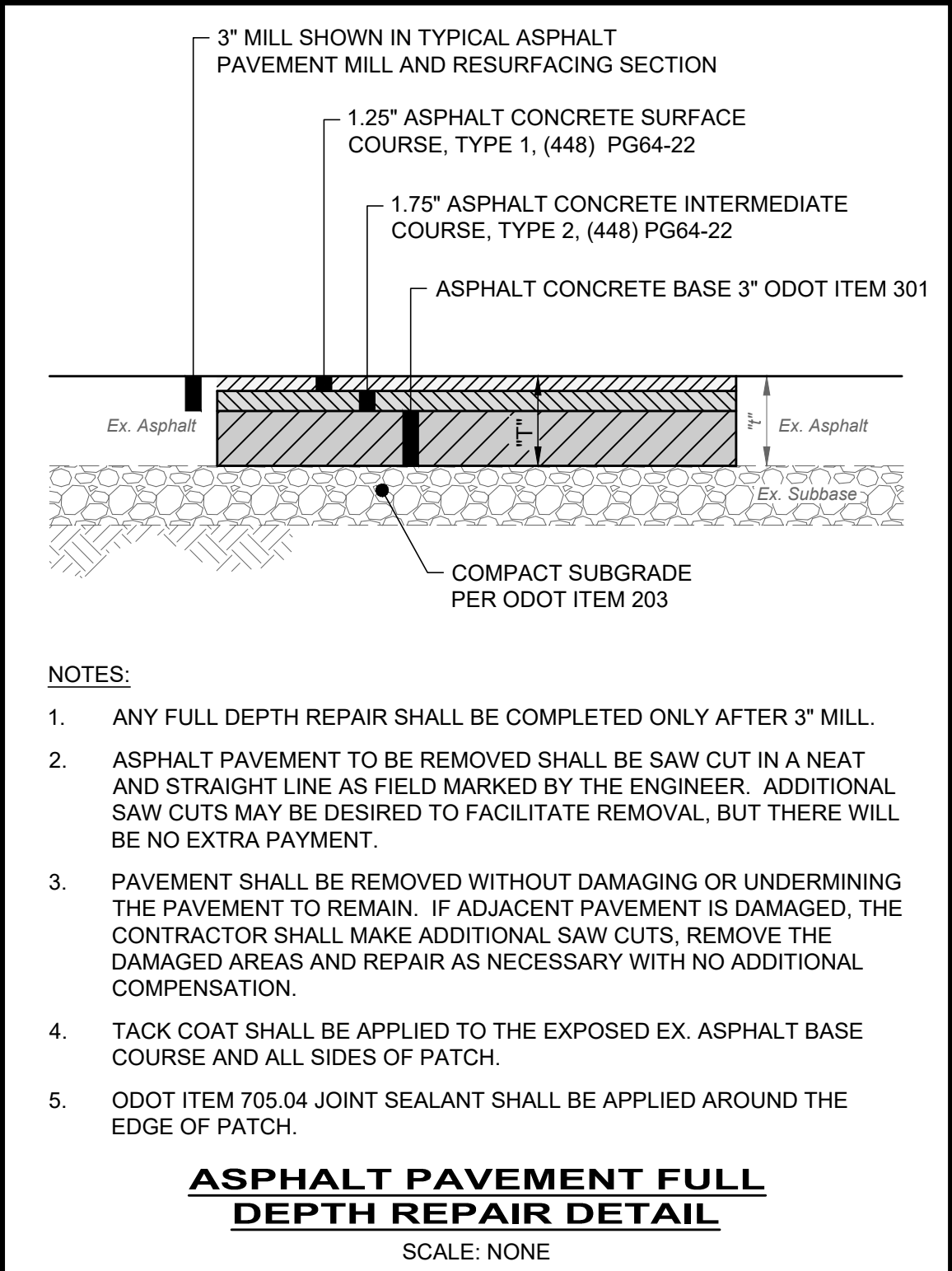
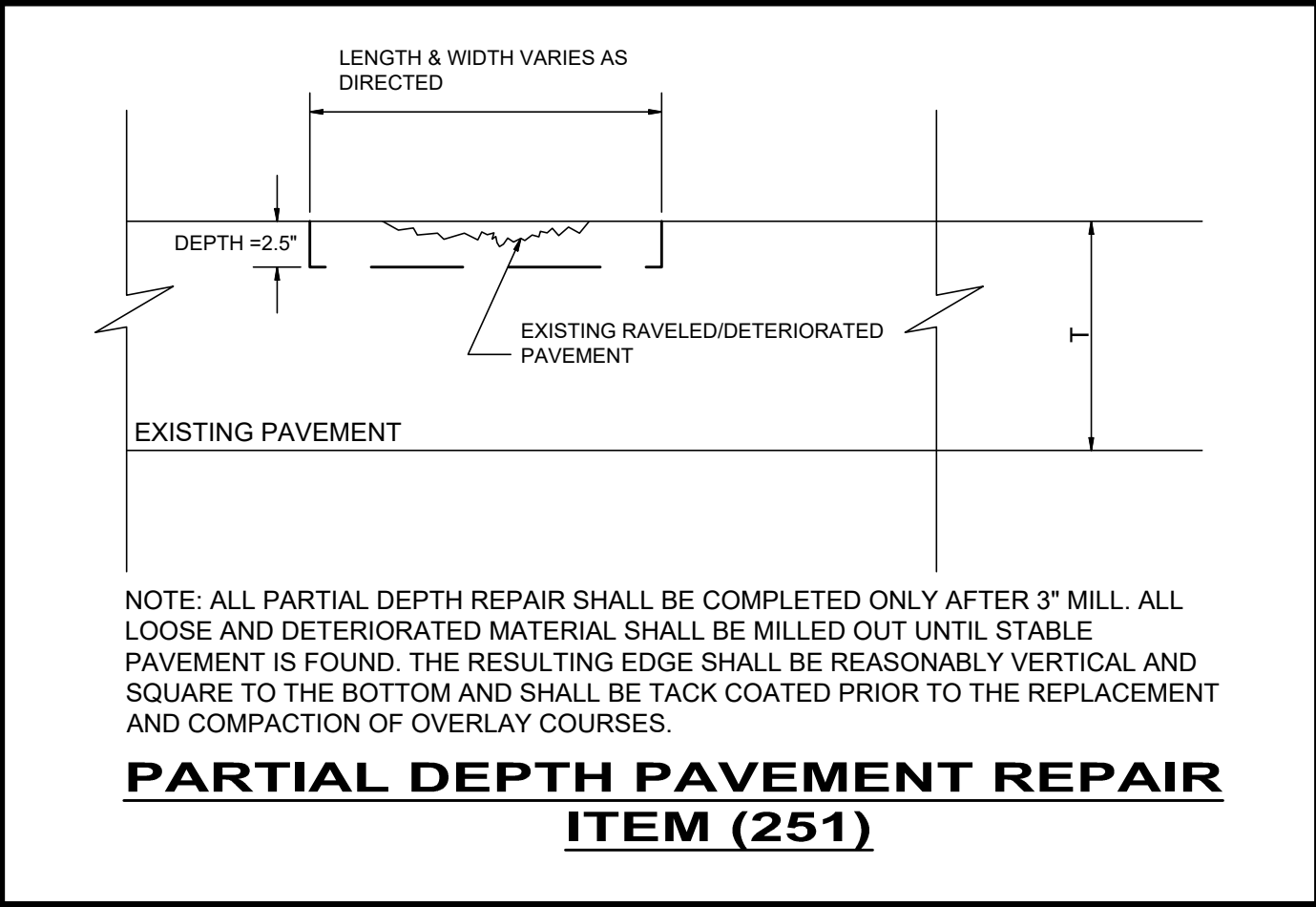
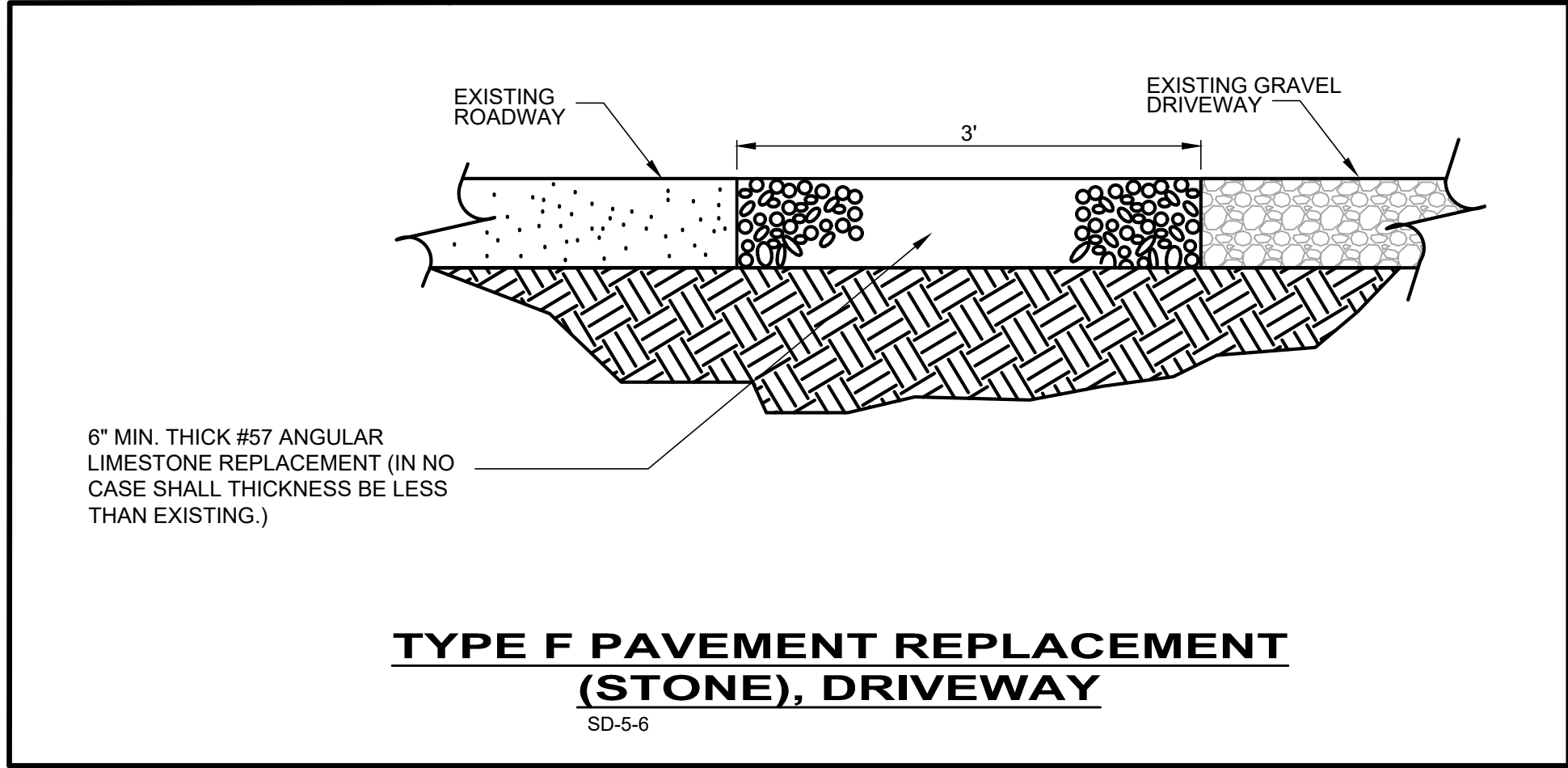
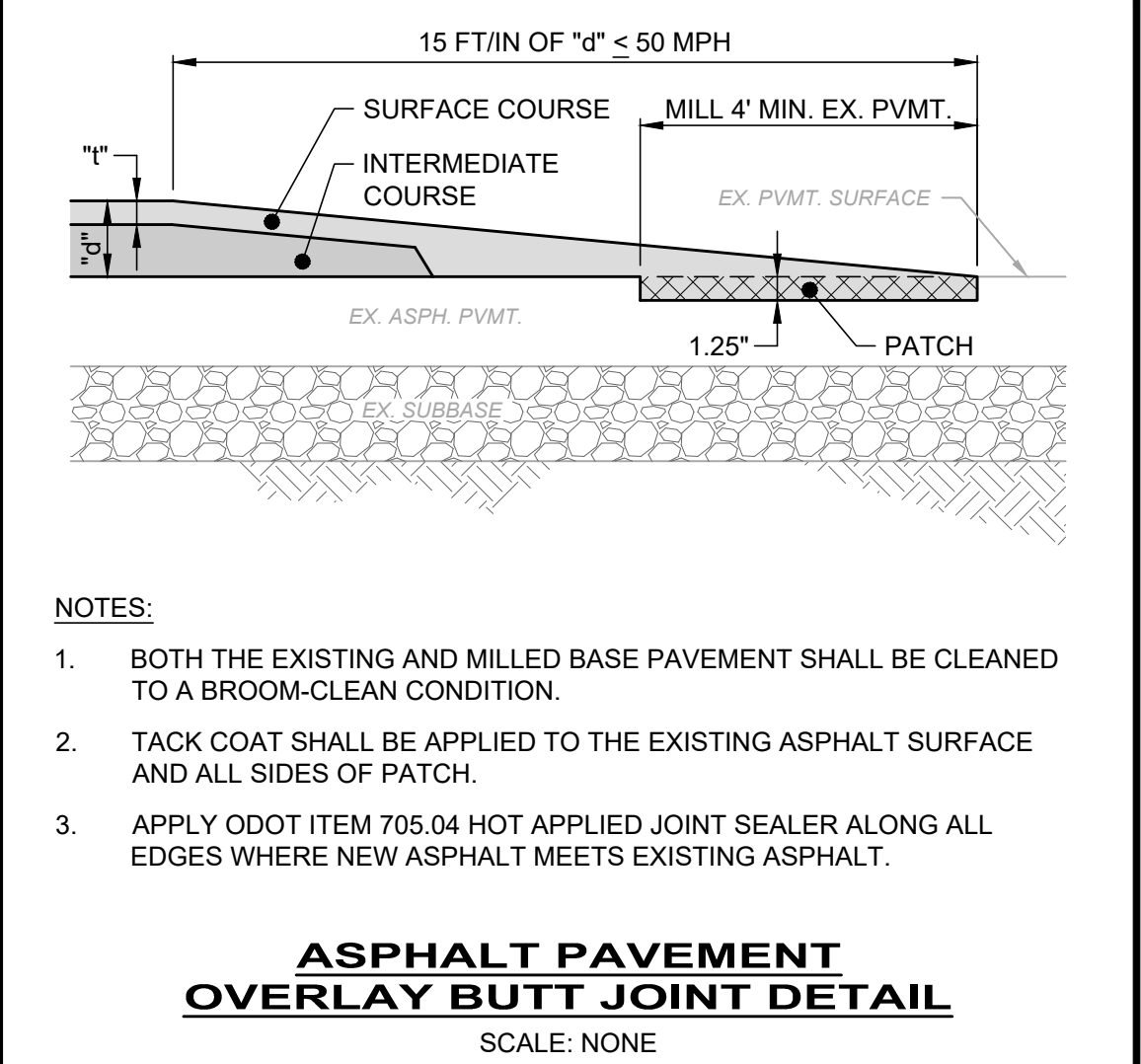
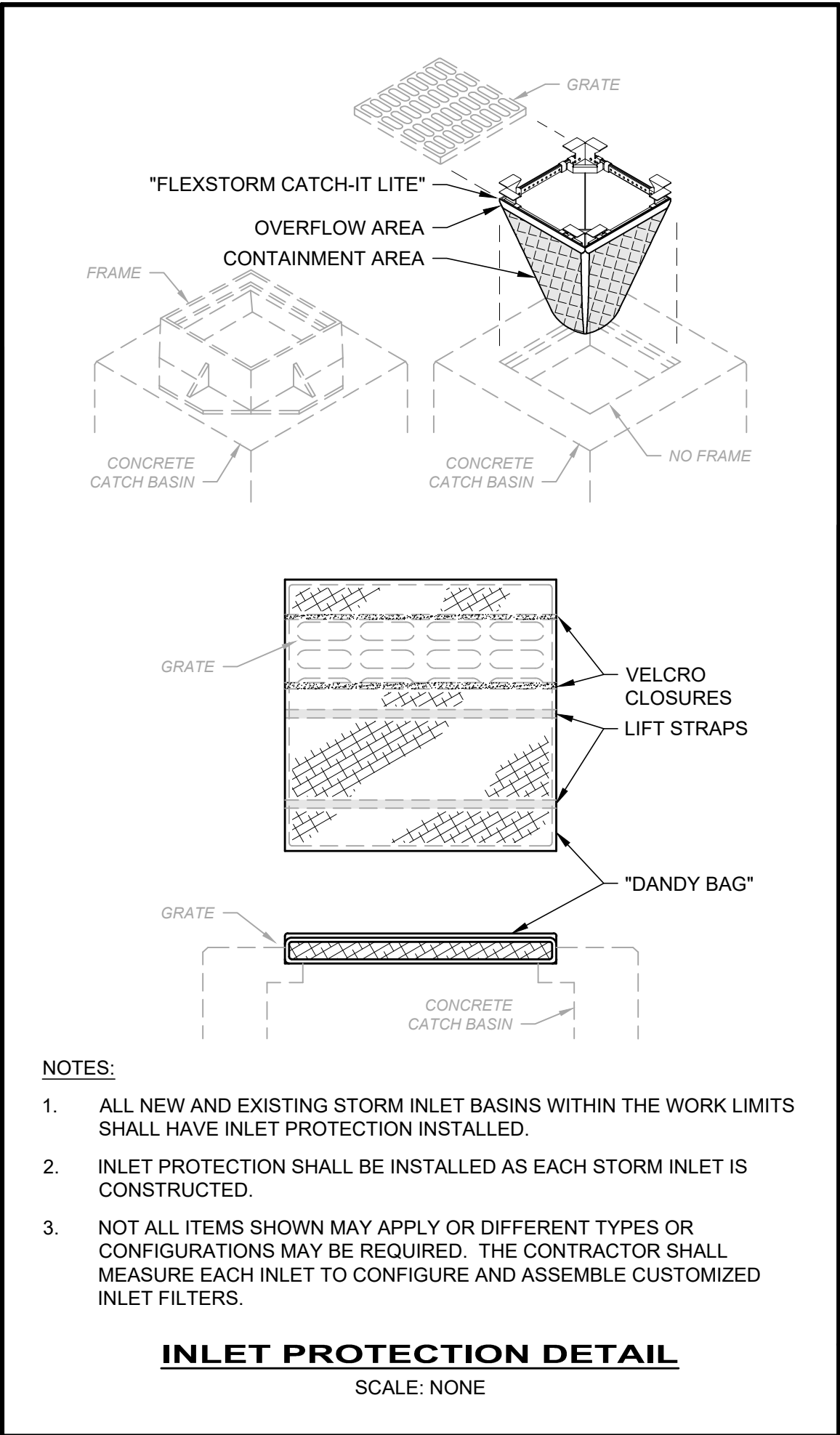
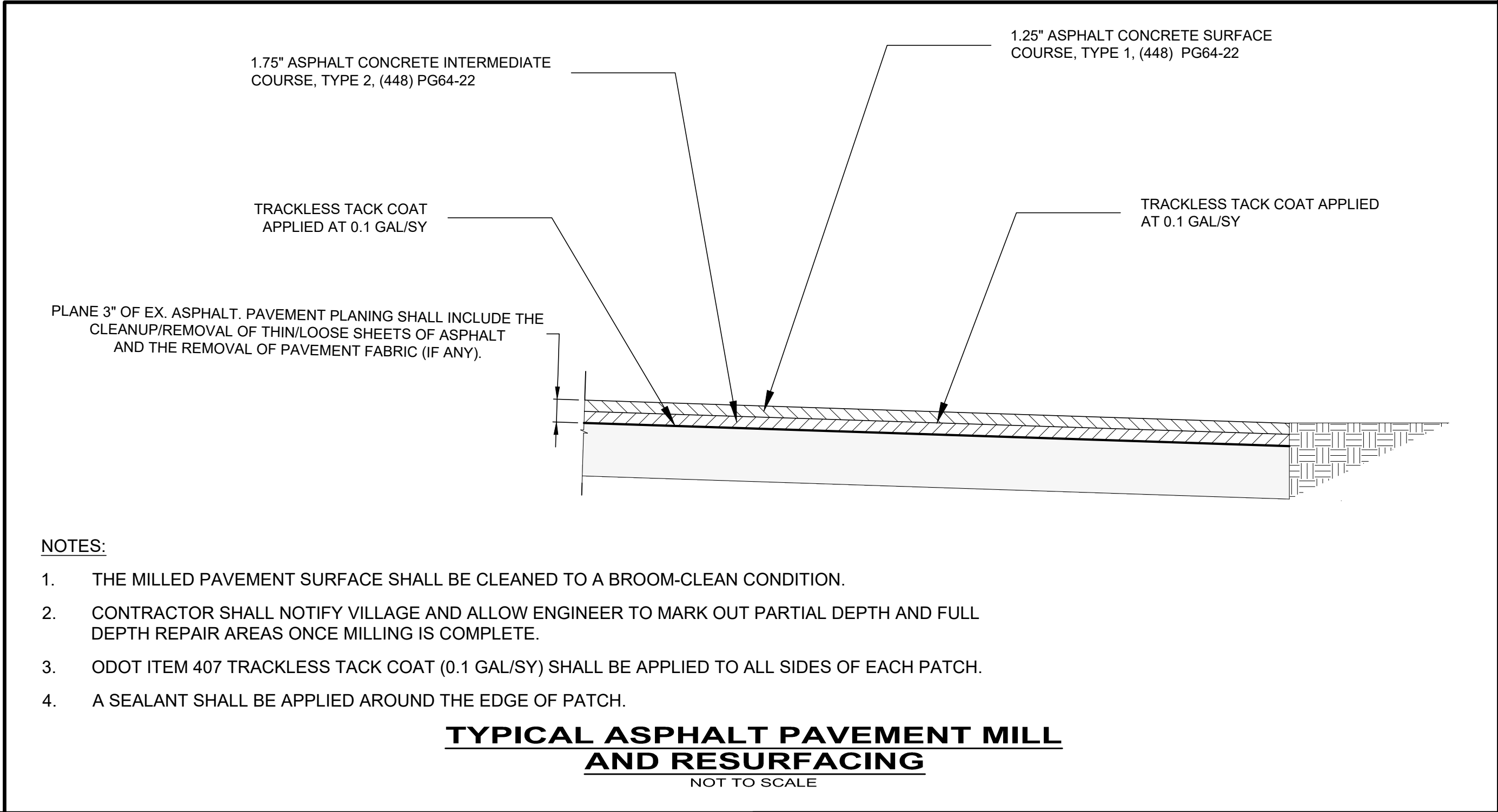

NO	REVISION	DATE

THE VILLAGE OF ORWELL

PENNIMAN ROAD PAVEMENT IMPROVEMENTS

ASHTABULA COUNTY

ORWELL, OH

ISSUED FOR:	BID
ISSUE DATE:	04/24/2025
SCALE:	AS SHOWN
SHEET SIZE:	34x22"
DESIGNED BY:	SNK
CHECKED BY:	PAB

CONSTRUCTION DETAILS

PROJECT NO.	
31849	
DISCIPLINE	
CIVIL	
SHEET NAME	
CD	
SHEET	OF
6	6

PROJECT NO.	
31849	
DISCIPLINE	
CIVIL	
SHEET NAME	
CD	
SHEET	OF
6	6